

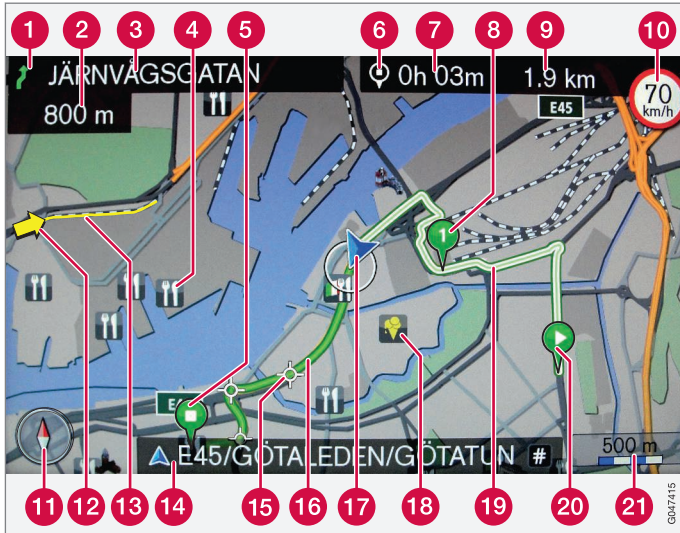

WEB EDITION  
ROAD AND TRAFFIC INFORMATION - RTI



### Text and symbols on screen

- 1 Event at next guidance point
- 2 Distance to next guidance point
- 3 Name of next road/street
- 4 Facility (Restaurant)
- 5 Planned route final destination
- 6 Symbol for destination/final destination
- 7 Calculated arrival time at final destination
- 8 Planned route waypoint
- 9 Calculated remaining distance to destination
- 10 Maximum permitted speed - at car's current position (17) [Not in cars with RSI.]
- 11 Compass
- 12 Traffic information
- 13 Section covered by traffic information
- 14 Current road/street name - at car's current position (17)
- 15 Next guidance point
- 16 Planned route
- 17 The car's current position
- 18 Stored location
- 19 Completed planned route
- 20 Planned route start
- 21 Map scale

Road type	Colour
Motorway	 Orange
Primary road	 Dark grey
Smaller primary road	 Grey
Ordinary road	 Light grey
Local road	 White



## ROAD AND TRAFFIC INFORMATION - RTI



Volvo's navigation system is a traffic information and road navigation system developed by Volvo. The system guides you to a destination and gives information along the route. It informs of situations that can affect the drive, such as accidents, road works and shows alternative routes.

It is possible to create an itinerary, search for facilities along the route, store special places etc. The system displays the car's exact position and in event of a wrong turning always corrects to guide you to the destination.

You will see just how intuitive it is to use. Try it out. In order to get along with the system we recommend that you familiarise yourself with the information in this manual.

By facilitating accessibility and shortening driving distances, Volvo's navigation system contributes to a better environment.

### **License agreement NAVTEQ DATABASE**

For information for the end user - see page 78.





## 01 Quick Guide

Quick start.....	8
------------------	---

# 01



## 02 Get to know your navigation system

Manual.....	12
Before starting.....	14
Overview.....	16
Controls.....	19
Voice recognition.....	22
Keyboard.....	25
DVD disc, screen.....	27
Maps, road types and compass.....	30
Menus.....	32
Menu tree in three levels.....	34

# 02



## 03 Planning your trip

Specify a destination.....	40
Itinerary.....	47
Current position.....	50
Settings.....	51
Simulation.....	60

# 03



**04 Traffic information**

General.....	64
Reading information.....	66
Handling traffic problems.....	68

04



**05 Symbols on the map**

Facilities.....	72
-----------------	----

05



**06 Questions and answers**

Frequently asked questions.....	76
EULA - License agreement.....	78
Copyright.....	80

06



## 07 Alphabetical Index

Alphabetical Index.....	82
-------------------------	----

07



Quick start..... 8





# 01

QUICK GUIDE

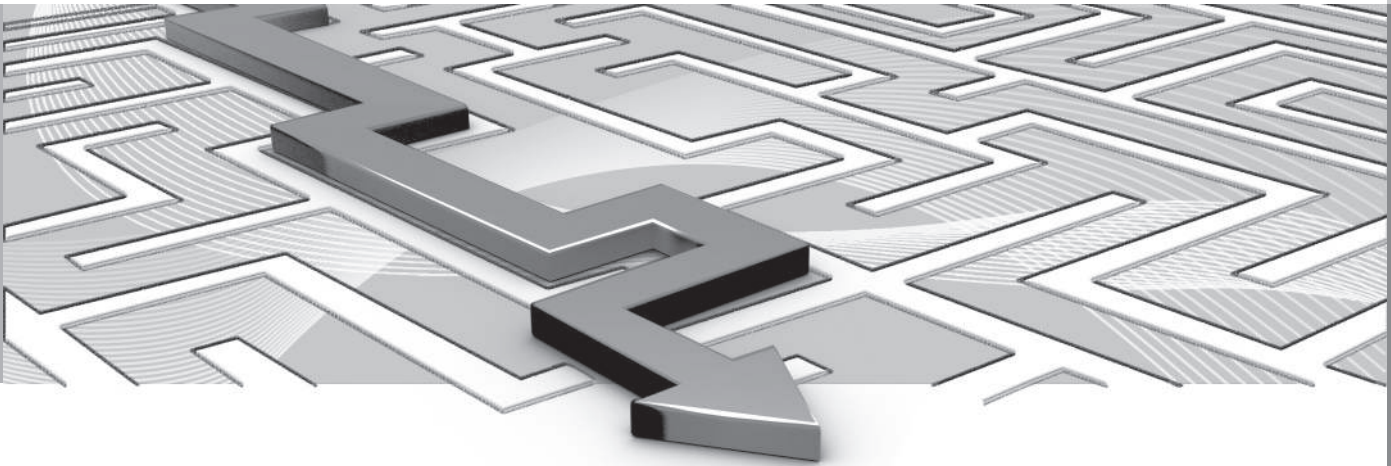



## Quick start

### Activating the system

The car's electrical system must first be activated:

1. Press the remote control key into the ignition switch and activate key position **I** (see the owner's manual for the car).
2. If the navigation system does not start within a few seconds - press the centre console's **NAV** button.

### Disclaimer

When the navigation system is started the display screen shows a text which must be confirmed:

- Press the **OK** button.

For more information, see page 14.

### Controls

Volvo's GPS navigator can be operated in several ways:

- With the steering wheel's right-hand keypad
- With the controls in the centre console
- With a remote control
- With voice recognition.

For a functional description, see page 19.

### Main commands

The steering wheel keypad is used in the following two examples to give guidance to an Address or Facility.



- Scroll/select in the menus with the **Thumbwheel** (1).
- Activate selections with a brief **press** on the **Thumbwheel** (abbreviated in the following example with "+ **OK**").
- Go back in menus and/or undo using **EXIT** (2).

### Centre console controls

If the **centre console keypad** is used instead of the steering wheel keypad then the following applies:

Keypad in steering wheel	Centre console
Turn the <b>Thumbwheel</b>	Turn <b>TUNE</b>
Press the <b>Thumbwheel</b>	Press <b>OK</b>
Press <b>EXIT</b>	Press <b>EXIT</b>

### Guidance to a street address

Step	Display screen/ menu	Action
1	If the display screen does not show a map image, proceed as follows:	Press the centre console button <b>NAV</b> .
2	Map	Press <b>NAV</b> to display the "Shortcuts" menu.
3	Shortcuts menu, see page 32.	Select <b>Set address + OK</b> .
4	<b>Set destination</b>	Select <b>Address + OK</b> .



## Quick start

Step	Display screen/ menu	Action
5	Address:	Select <b>City:</b> + <b>OK</b> .
6	Daisy wheel - see page 25.	Turn the <b>Thumb-wheel</b> to select characters and enter it by clicking <b>OK</b> - a list of options emerges on the display screen.
7	Daisy wheel	Select the appropriate district from the list + <b>OK</b> .
8	Navigation menu	Select <b>Set single destination</b> + <b>OK</b> .
9	Map	Guidance starts - follow the instructions.

The navigation system calculates the route, travel time and distance to the selected desti-

nation. The system provides guidance and instructions on junctions etc.

If there is a deviation from the planned route outline during the journey then the system automatically calculates a new route outline.

### Guidance to a facility (POI)

Step	Display screen/ menu	Action
1	If the display screen does not show a map image, proceed as follows:	Press the centre console button <b>NAV</b> .
2	Map	Press <b>NAV</b> to bring up a menu.
3	Shortcuts menu, see page 32.	Select <b>Set Point Of Interest</b> + <b>OK</b> .
4	<b>Set destination</b>	Select <b>Point of interest (POI)</b> + <b>OK</b> .
5	<b>Point of interest (POI)</b>	Select e.g. <b>Near the car</b> + <b>OK</b> .

Step	Display screen/ menu	Action
6	<b>Latest 5 POI types</b>	Select e.g. <b>All types</b> + <b>OK</b> .
7	<b>All POI types</b>	Select e.g. <b>Airport</b> + <b>OK</b> .
8	<b>Results list</b>	Select the desired option from the list + <b>OK</b> .
9	<b>Navigation menu</b>	Select <b>Set single destination</b> + <b>OK</b> .
10	Map	Guidance starts - follow the instructions.

Manual.....	12
Before starting.....	14
Overview.....	16
Controls.....	19
Voice recognition.....	22
Keyboard.....	25
DVD disc, screen.....	27
Maps, road types and compass.....	30
Menus.....	32
Menu tree in three levels.....	34

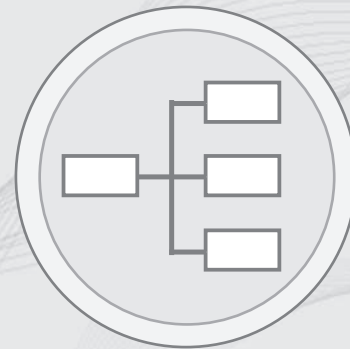

# 02

## GET TO KNOW YOUR NAVIGATION SYSTEM





# 02 Get to know your navigation system

## Manual

### Heading level 1

#### Heading level 2

The content under this heading is part of Heading level 1.

#### Heading level 3

The content under this heading is part of Heading level 2.

#### Heading level 4

The content under this heading is part of Heading level 3.

### General information on the manual

There is a quick guide for the user who wants to get started right away - see page 8.

For a more in-depth description of the operation and options as well as the selection of settings to the destination, the recommendation is to read the manual in combination with practical use.

### Menu options/Search paths

All options that can be selected on the display screen are marked in this manual with slightly larger and grey-shaded text, e.g. **Set destination**.

Search paths in the menu tree are stated as e.g.:

**Set destination → Address → City:**

#### English text

The manual's images are common to all markets and languages so where they contain text it is mainly in English.

In order to facilitate the user's understanding of the images and their menu options with search paths connected to the manual's text, the English word for the image is in brackets immediately after the intended text/phrase in the language of the manual:

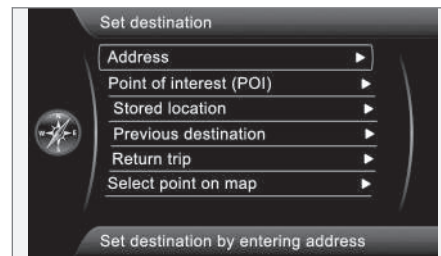

**Set destination → Address**

(Set destination > Address)<sup>1</sup>

### Special text

#### NOTE



#### NOTE

Texts marked with NOTE provide advice or tips to facilitate use of e.g. features and functions.

#### Footnote

There is information in the manual that is added as a footnote at the bottom of the page or in direct association with a table. This

<sup>1</sup> Not in English manuals - but shown here as an example.



information is a supplement to the text to which it refers via the footnote number/letter.

### Options

All types of options/accessories are marked with an asterisk (\*).

In addition to standard equipment, this manual also describes options (factory fitted equipment) and certain accessories (retrofitted extra equipment).

The equipment described in this owner's manual is not available in all cars - they have different equipment depending on adaptations for the needs of different markets and national or local laws and regulations.

In the event of uncertainty over what is standard or an option/accessory - contact a Volvo dealer.

### Changes in the manual

The specifications, design features and illustrations in this owner's manual are not binding.

We reserve the right to make modifications without prior notice.

© Volvo Car Corporation



## 02 Get to know your navigation system

### Before starting

#### General

The Volvo navigation system uses reference system WGS84, which gives longitude and latitude positions.

The car's navigation system can be used without a destination being selected.

#### Map position

Upon start-up, the navigation system shows an on-screen text message, which must be confirmed by pressing the **OK/MENU** button. The text is as follows:

- **This system provides route information to help you reach your destination. Due to road conditions, some recommendations may not be accurate. Obey all traffic laws and drive based on your own good judgement. Always concentrate on your driving by keeping your eyes and mind on the road.**

Then a map of the current geographic area is shown where the car is symbolised by a blue triangle.

#### Settings

The system is supplied with default settings, but starts with the settings last used.

There is a function that resets all settings to default settings simultaneously, see page 58.

#### On/Off

##### On

1. Push the remote control key into the ignition switch.
2. The screen activates automatically in the key position **I** (see the car's manual).
3. Press the centre console's button **NAV** if the navigation system does not start automatically.
4. Press **OK** when the "Start up" text appears on-screen, see previous section "Map mode".

The system may need a few seconds in order to detect the position and movement of the car.

##### Off

The navigation system is shut down when the remote control key is removed from the ignition switch.

The Navigator cannot be switched off manually, but always works in the background after the "Start up" sequence. If the navigation system is not to be switched on:

- Press **EXIT** at the "Start up" sequence, see section "Map mode".



#### NOTE

The navigation system is also available when the engine is switched off. When the battery level gets too low the system switches off.

#### Demo (simulated guidance)

To see how the system works, guidance to an indicated destination can be simulated on-screen - see page 60.





**Before starting**

02



## 02 Get to know your navigation system

### Overview

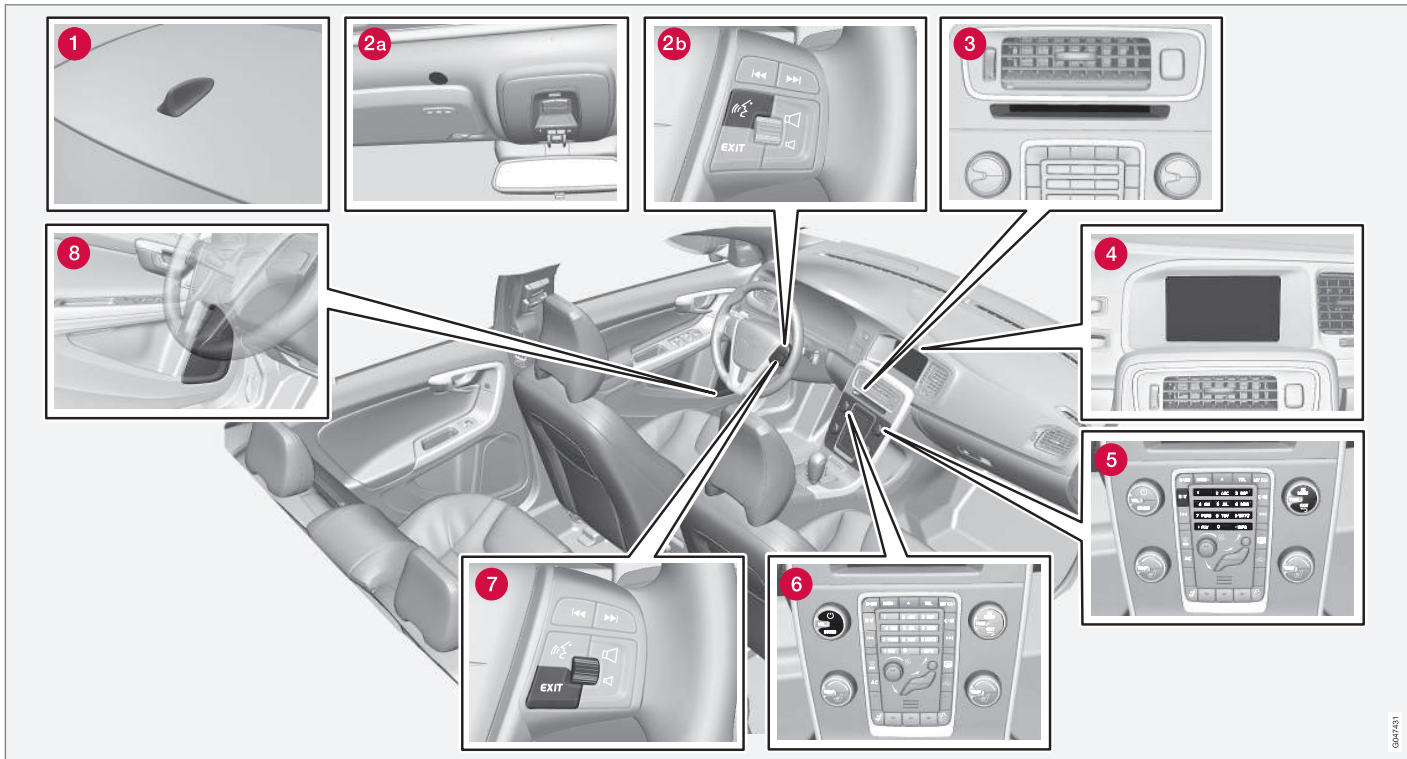

NOTE: The picture is schematic - some details may vary depending on car model and market.

GM17431

### 1 Antenna for GPS

The antenna is integrated into the roof antenna.

### 2 Voice recognition

Some procedures in the Navigation system can also be voice controlled. The microphone (2a) is fitted in the ceiling and the activation button (2b) is located on the right-hand keypad on the steering wheel. For more information, see page 22.

### 3 Main unit

The main unit is fitted in and behind the centre console and includes the following functions:

- Calculating the position of the car
- Calculating the route to the specified destination
- Handling traffic information
- Voice guidance
- DVD player

Receiver for GPS and traffic information (TMC<sup>1</sup>) is integrated into the main unit.

### Positioning

The car's speed sensor and a gyro calculate the current position and the direction of travel of the car using signals from the GPS satellite system.

The advantage of this concept is that the Navigation system registers and calculates the route outline even if the GPS signal is temporarily lost, e.g. when driving through a tunnel.

### Traffic information

TMC<sup>1</sup> is a standardised coding system for traffic information. The receiver automatically searches for the correct frequency. Reception takes place via the FM antenna.

#### NOTE

TMC is not available in all areas/countries. The system's coverage area is under constant construction and updating may sometimes be necessary.

For information about updating map data and software, see page 27.

### 4 Screen

The screen displays maps and provides detailed information on route type, distance, menus etc. For information screen care, see page 28.

### 5 Keypad, centre console

As an alternative to the steering wheel keypad, the centre console's numerical keypad can be used in combination with buttons **OK/MENU**, **TUNE** and **EXIT** to scroll between different menu options, confirm options or go back in menus, see page 19.

### 6 Volume control and IR receiver

Use the audio unit's volume control during ongoing voice messages to adjust the volume, see page 31. The volume can also be adjusted in the menu system.

Point the remote control towards the centre console during use - its IR receiver is located there.

<sup>1</sup> Traffic Message Channel



## 02 Get to know your navigation system

### Overview

#### **7 Keypad, steering wheel**

A keypad is located on the right-hand side of the steering wheel. Use it to scroll between different menu options, to confirm selections or to move back in menus, see page 19.

#### **8 Speakers**

Navigation system audio uses the front loudspeakers.



### General information about controls

The navigation system is operated by controls on the centre console, the steering wheel keypad or using a remote control\*. The three different control unit keypads have common functions but differ in appearance and operation. The design may also vary depending on market.

The system can also be controlled by voice recognition using specific commands - see page 22.

### Centre console

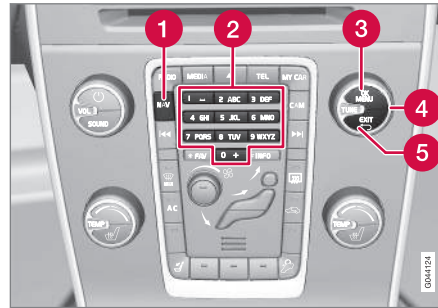

Centre console keypad.

- 1 **NAV** activates the GPS navigator on the display screen. With GPS activated, a quick menu opens/closes, see page 32.
- 2 **Numerical keys** enter information for address and name search, and scroll on the map, see pages 25 and 32.
- 3 Press **OK/MENU** once to confirm or activate a selection. Described in this manual with the "OK button" or "+ OK".
- 4 Turning **TUNE** scrolls between different menu options or zooms when the map image is shown. Described in this manual with the "TUNE knob".
- 5 Press **EXIT** once to go back in the menu structure or undo a selection.

### Steering wheel

The steering wheel's keypad is available in several versions depending on market and selection of audio system.

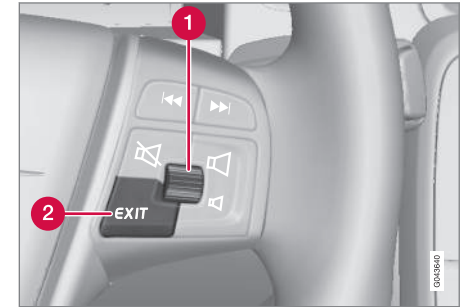

Steering wheel right-hand keypad.

- 1 **Turn** the thumbwheel to scroll between different menu options or zoom when the map image is shown.
- 1 **Press** the thumbwheel to confirm/activate a selection.
- 2 **EXIT** goes back in the menu structure or undoes a selection.



# 02 Get to know your navigation system

## Controls

### Voice recognition

See page 22.

### Remote control

The remote control can be used to control/operate several different functions in the car - only the related navigation system is described here.

- Point the remote control at the centre console during use.

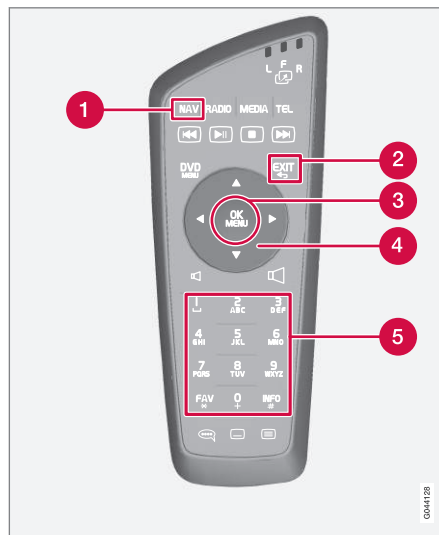

Remote control keypad.

- 1 **NAV** activates the GPS navigator on the display screen. With GPS activated, a quick menu opens/closes, see page 32
- 2 **EXIT** goes back in the menu structure or undoes a selection.
- 3 **OK/MENU** confirms or activates a selection. Described in this manual with the "OK button" or "+ OK".

- 4 **Arrow keys** move the menu cursor.
- 5 **Numerical keys** enter data for address and name search, and scroll on the map.

### NOTE

If the remote control does not work, try replacing with new AA/LR6 batteries first of all.

### WARNING

Store the remote control and other similar objects in one of the storage compartments - in the event of sudden braking or a collision such objects could cause personal injury or material damage.

### Additional information

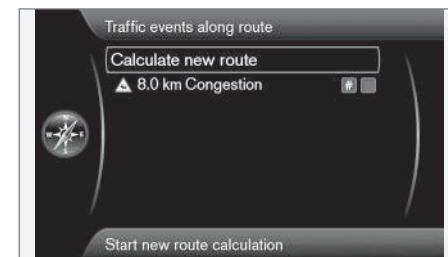

0041128



## Controls

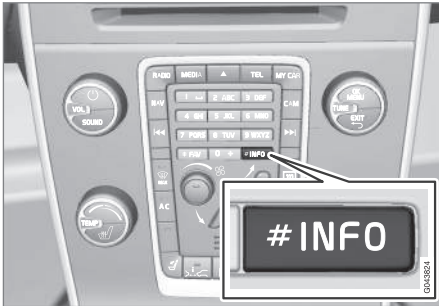

Sometimes there is more information available than can fit on the menu bar - the line then ends with the character: "#".

To view the rest of the information:

- Press the **INFO** button.

## Voice recognition

### General about Voice control

Voice control means that certain functions in the navigation system can be activated by the spoken word.

The Voice commands offer comfort and help the driver to avoid distraction - instead the driver can concentrate on driving and focus attention on the road and traffic situation.

### WARNING

The driver always holds overall responsibility for driving the vehicle in a safe manner and complying with all applicable rules of the road.

The Voice control uses the common microphone of the hands-free system - the driver receives responses to the Voice control through the vehicle's loud speakers.

The microphone is positioned in the ceiling in front of the driver for optimal take-up of the driver's speech - it can however be disturbed by/pick up loud voices from passengers.

### Handling



Keypad in steering wheel.

- 1 Button for voice control

### Activating the system

- A short press on the steering wheel button (1) activates the voice recognition system - a voice command can be given after the tone.

Think of the following when using the voice recognition system:

- For commands - Speak after the tone with a normal voice at a normal tempo
- The car's doors, windows and sunroof must be closed
- Avoid background noise in the passenger compartment.

### NOTE

If the driver is unsure of which command to use, he/she can say "Help" - the system then responds with several different commands which can be used in the current situation.

Voice commands can be disabled by:

- not speaking
- saying "Cancel"
- hold the steering wheel button for Voice recognition depressed for a couple of seconds
- press **EXIT**
- press one of the centre console's buttons **NAV**, **RADIO**, **MEDIA**, **MY CAR** or **CAM**.

### Use the voice command

Entering information in the navigation system using the voice command is very simple because the screen lists the frequently occurring commands to be used in the relevant situation.

### Starting

A voice command is started as follows:





## Voice recognition

1. Press the steering wheel button for Voice control - the display lists examples of possible commands.
2. For example, select "**Navigation**" - wait for the tone and state the word clearly and in normal conversational tone.
3. The screen shifts to the option "**Repeat instruction/Navigation go to address/Itinerary**" - Select and say "**Itinerary**".

Note that greyed out text and text in brackets is **not** included in the spoken command.

**NOTE**

Greyed-out menu bars and options on the screen are temporarily not selectable.

**The command can be given in several ways**

The command "**Navigation go to address**" can be stated as:

- "**Navigation > Go to... > Address**" - Say "**Navigation**", wait for the system response in the form of suitable on-screen options. Continue by saying, for example, "**Go to...**" and conclude with "**Address**".

or

- Say the whole command in one sequence - "**Navigation go to address**".

**Tips**

Some good advice:

- Give a command by first pressing the voice button and then speaking naturally after the tone.
- To respond to the voice recognition system - speak after the tone at the end of the question.
- To interrupt the voice session - press and hold the voice button or press the **EXIT** button.
- The driver can obtain help during a dialogue by saying "**Help**" after a listening tone.
- The dialogue with the system can be speeded up - Interrupt the system's speech with a short press on the button's voice button, wait for a tone and then start talking.
- The voice recognition system asks up to 3 times for an answer. If no answer is given by the driver during this time then the session is concluded.

**Example**

Here are some normal commands:

- **Navigation go to address**
- **Navigation go to POI**
- **Navigation delete next waypoint**

- **Navigation cancel guidance.**

**NOTE**

A complete list of quick commands is available in the **MY CAR** menu - Go to **Settings** → **Voice settings** → **Voice command list** → **Navigation commands**.

**Help functions and settings**

In the menu system **MY CAR** there are programs where the driver can practice the different functions in the voice recognition system. To describe the menu system **MY CAR** - see the car's normal instruction manual.

The better the driver knows the voice recognition system, the more comfortable the driver will be using the functions. Practicing using the integrated practice programs is therefore recommended.

**NOTE**

The exercise programs are only accessible when the car is stationary with the parking brake applied.

**Introduction to voice control**

The program **Voice tutorial** gives the driver step by step instructions in the use of the voice recognition system and is a simple way



# 02 Get to know your navigation system

## Voice recognition

of becoming familiar with the methods of giving commands.

The program can be started in two ways:

- Press the steering wheel button for voice control and say "Voice tutorial".
- or
- Activate the program in **MY CAR** - Go to **Settings** → **Voice settings** → **Voice tutorial**.

### Voice training

The program **Voice training** teaches the voice recognition system to recognise the driver's voice and speech pattern. It is also possible to create a second user profile - an advantage if more than one person is likely to use the car/system regularly.

- The voice training is started in **MY CAR** - Go to **Settings** → **Voice settings** → **Voice training** → **User 1** or **User 2**.



### NOTE

Menu option **Default setting** can only be changed to **User 1** after a lesson on **Voice training** has been completed.

### More settings in MY CAR

- **User profile** - 2 x different user profiles can be set. Go to **Settings** → **Voice**

**settings** → **Voice user setting**. Tick one of the options **Default setting**, **User 1** or **User 2**.

- **Voice volume** - Go to **Settings** → **Voice settings** → **Voice output volume** and select the desired level.

The system's voice volume can also be adjusted using the centre console **TUNE** knob when the system is speaking.

### Language

The voice recognition system is under constant development and at time of printing the following languages were available:

- English (UK)
- English (US)
- French (CAN)
- French (FRA)
- Dutch
- Italian
- Spanish (EU)
- Spanish (US)
- Swedish
- German



### NOTE

The voice recognition system in combination with GPS navigation only works with the languages listed here.

To change the language - Go to **Settings** → **System options** → **Language** and select.



The languages that are included in the voice recognition system have this icon in the language list.

### Language dependent user profile

The voice recognition system only understands the language set in **System options**.

Say that user profile **User 1** is stored by a Swedish speaking driver with the system set in Swedish. If the driver changes the car language to English the user profile **User 1** will no longer be selectable because the system now only understands, and expects English speech - instead the option **Default setting** becomes active.

To improve the system's understanding of the driver's English speech the solution is to teach and store the driver's English speech in **User 2** with the system set to English (to have both variants available) or to replace the Swedish language profile in **User 1** with an English profile.



## Keyboard

## Entering and selecting options



Screen view with text field or optional text.

This navigation system uses a "daisy wheel" to enter specific information, e.g. type of facility, place/town, area/country, address, street or post code.

## Activate an option

After marking a desired function/menu bar using the **thumb wheel** or the **TUNE** knob, press the **thumb wheel/OK** to see the next level of functions/options.

## Enter as follows

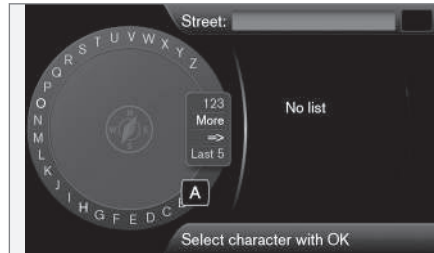

The daisy wheel.

1. Mark a text field.
2. Press **OK** to call up the "daisy wheel":
3. Select the characters using the **thumb wheel/TUNE** knob and enter them by pressing **thumb wheel/OK**.

## Numerical keyboard

Another way of entering characters is using the centre console's buttons **0-9**, **\*** and **#**.

When **9** is pressed, a bar appears with all characters<sup>1</sup> under the buttons, e.g. **W**, **x**, **y**, **z** and **9**. Quick press the move/"loop" cursor through these characters.

- Stop using the cursor on the desired character to select it - the character is shown on the enter line.
- Delete/change using **EXIT**.

## More options



## NOTE

Faded characters cannot be selected in combination with the currently input characters.

In the daisy wheel's inset menu there are further options that have more characters and digits:

- **More** (More) + **OK** - alternative characters appear in the wheel.
- **123** + **OK** - digits appear in the wheel.
- **=>** + **OK** - the cursor moves to the list on the right-hand side of the screen where selections using **OK** can be made.
- **Last 5** (Last 5) + **OK** - lists the most recent searches. Mark one of them + **OK**.

<sup>1</sup> The character for each button may vary depending on market/state/language.



## 02 Get to know your navigation system

### Keyboard

#### List of options

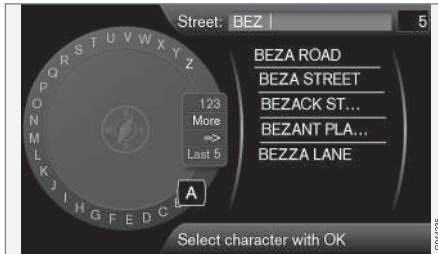

*List that matches entered characters.*

The digit **5** in the screen's top right-hand corner indicates that the list contains 5 possible options that match the entered letters **BEZ**.

#### No list

An empty list and the characters **\*\*\*** in the upper right-hand corner's digit window, mean that the available options with current entered characters are more than 1000 - when the amount is less, the current options are shown automatically.

To reduce the number of options in the list:

- Enter more characters on the text line.



## DVD contents

DVDs with updated map data and related enhanced information are being developed continually. Contact a Volvo dealer for information on the latest issue.

### NOTE

Map data does not have 100 percent coverage in all areas/countries.

The system's coverage area is under constant construction and updating may sometimes be necessary.

See also [www.volvocars.com/navi](http://www.volvocars.com/navi) for further information on maps etc.

## Map areas

The car's map system varies depending on market. The following main maps are available:

- Australia & New Zealand (Pacific)
- Europe
- Hong Kong
- Japan
- China
- Middle East

- North America
- Russia
- South Africa
- South America
- Southeast Asia
- Turkey.

Should you need to modify the navigation system's map area - contact a Volvo dealer for information on how to proceed.

## Updating the map data

When updating, DVDs are used to transfer new information to your car's navigation system. This is done using the car's regular DVD player.

### NOTE

- A number of the Infotainment functions are disabled or reduced during updating.
- Before an update begins - read through the instructions first.

In the event of any questions about updating - contact a Volvo dealer.

## License code

To be able to activate an update, a licence code has to be entered first. This code can be found on the Internet.

1. Open the website<sup>1</sup> "Activate your navigation system".
2. Enter your car's VIN number and the owner's e-mail address in the relevant entry fields, then click to close the website.
3. Note the licence code which is then displayed on screen. This licence code is also sent to the specified e-mail address.

## Updating

How to update the navigation system:

1. Start the engine.
2. Insert the first disc in the DVD player and follow the instructions on screen. An update is often distributed on several discs<sup>2</sup> - insert the discs in the logical/numerical order.

<sup>1</sup> The Internet address from which the licence code is generated comes with the update DVDs.

<sup>2</sup> The number of discs depends on the market.



## 02 Get to know your navigation system

### DVD disc, screen

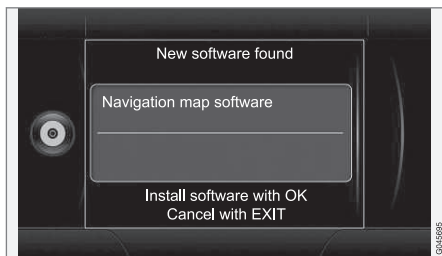

3. The screen shows **New software found** - start the update by pressing **OK**. (Cancel by pressing **EXIT**).
4. The screen shows **Please enter licence code:** - input the licence code using the numeric keypad, see page 19.
5. Follow the instructions on screen, which continuously show the progress of the update and the approximate time remaining.
  - The update has to be enabled once all DVDs have been loaded. This is done by switching off the engine and waiting 5 minutes before restarting. The update is then complete and the navigation system can be used again.

#### NOTE

In certain cases updating map data may also add new functions in the system, which are not described in this manual.

#### Continue an interrupted update

If the update is not complete when the engine is switched off, the process continues from where it left off the next time you start the engine. Proceed as follows to restart an interrupted update:

- If the disc is inserted into the DVD player: Start the engine - the update is resumed automatically. Follow the instructions on screen.
- If the disc is removed: Start the engine and insert the disc into the DVD player - the update is resumed automatically. Follow the instructions on screen.

#### Care of DVD discs

Handle DVD discs with care.

When they are not in use they must be stored in their packaging. Avoid storing them in damp, high temperature, direct sunlight or dusty surroundings.

#### Screen care

Clean the screen with a soft, lint-free rag, lightly moistened with a mild window cleaning agent.

#### IMPORTANT

Do not place any objects in front of the GPS navigator's display screen - the surface could then be scratched. Mobile phones can also interfere with the display screen's function.



DVD disc, screen

02



# 02 Get to know your navigation system

## Maps, road types and compass

1 Finding the motorway

POIs at/on M40 1/2 3

PREMIER INN



2

Tottenham Court Road

102 km Sunset Boulevard

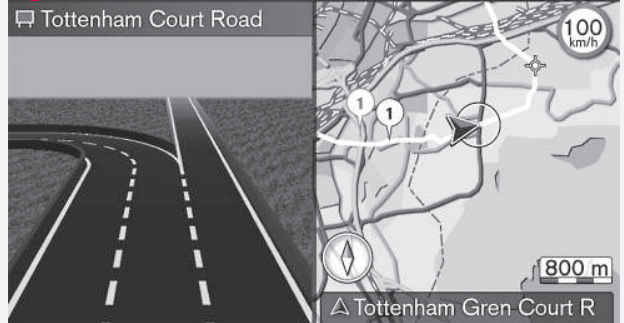

3 5.0 km WESTERN AV...

6h 52m 634 km

70 km/h

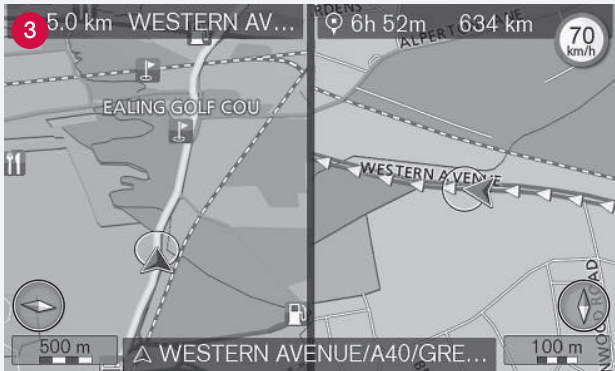

4

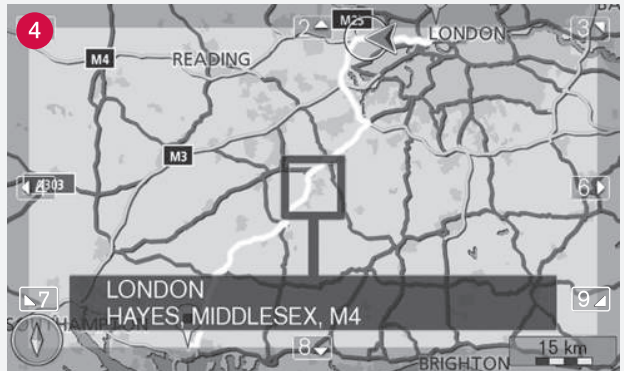

NOTE: The images are schematic - some details may vary depending on software version and market.

0944208

02



## Maps, road types and compass

### Map image of current position

The appearance of the screen image depends on geographic position and the settings made, e.g. map scale, facilities selected for display etc.

Explanations for the text, signs and symbols that may appear on the display are available on the front of the cover.

- 1 POIs along the motorway - see page 42.
- 2 Detailed junction map - the left-hand section of the display screen shows a detailed enlargement of the next junction<sup>1</sup>. The situation is always supplemented with a voice message, see next section.
- 3 Two maps can be selected as display mode. The screen shows the same map image but in two different scales. 2D or 3D display can also be selected - see page 53.
- 4 Scroll mode - see page 32.

<sup>1</sup> This function can be expanded - see page 56.

### Voice guidance

After a destination has been entered and the car approaches a junction or exit, a voice message sounds stating distance and type of the next manoeuvre. At the same time a detailed map of the junction is displayed. The voice guidance message is repeated closer to the junction.

The volume can be adjusted with the audio unit's volume button (during ongoing voice message).

To repeat a message:

- Press twice on the **OK** button.

Also see **Settings** → **Guidance options** → **Voice guidance** - see page 55.

#### NOTE

There is no voice guidance during a current call with a Bluetooth-connected mobile phone.

To select male or female voice and language:

- Go to the menu system in **MY CAR** - see the car's manual. The voice volume can also be adjusted there.

### Compass



The red tip of the compass needle points north and the white end points south.

Go to **Settings** → **Map options** → **Compass** to select a different view or so that the compass is not shown - see page 54.

## Menus

### Menu system

All menus and options are presented in the relevant section of the manual.

#### NOTE

Greyed-out menu bars and options on the screen are temporarily not selectable.

### Shortcuts

After pressing the **NAV** button to start the navigation system, the next press on the **NAV** button will bring up the first menu for the user, with shortcuts to the most frequently used functions.

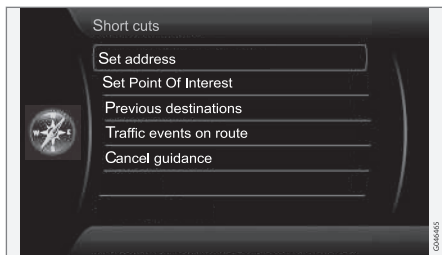

The shortcuts are:

- **Enter address** – see also page 40.
- **Enter facility** – see also page 41.

- **Previous destinations** – see also page 44.
- **Traffic info on the route** – see also page 68.
- **Cancel guidance** – deletes the current itinerary. Also located there is the option **Pause guidance**, see page 33.

### To the shortcuts from map mode

- Press the **NAV** button.

### Main menu

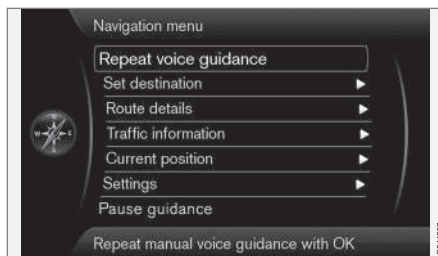

The main menu is located at the top of the navigation system's menu tree.

### To the main menu from map mode

- Press the **OK MENU** button.

### To the main menu from another menu

- Press **NAV** and then **OK MENU**.

or

- Press **EXIT** repeatedly until it is shown.

### Back to the Main menu

Regardless of where the user is in the menu structure, the Main menu can always be accessed by pressing once or more on the **EXIT** button.

### Back to the map

There is an easy way to quickly bring up the map on the screen again, no matter how deep into the menu system the user is:

- Hold in **EXIT** for a few seconds.

### Scroll menu

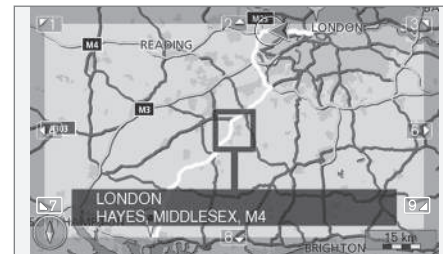

In Scroll mode a crosshair is moved over the map image with the centre console's numerical keys.



### Activating Scroll mode in normal map mode

- Press one of the numerical keys **0-9**.

### Scrolling

- Press one of the numerical digit keys **1-2-3-4-6-7-8-9** - a directional arrow is shown in the margins combined with the number that will be used to scroll the map in the desired direction.

### Zooming out/in

- Turn the **TUNE** knob.

### Exiting from Scroll mode

- Press **EXIT**.

### Crosshair

Press **OK MENU** once to show a menu for the point on the map, which the centre of the crosshair points to:

- **Set single destination** - Deletes any previous destinations in the itinerary, and starts guidance on the map.
- **Add waypoint** - Adds the selected point to the itinerary.
- **POIs nearby** - Allows you to search/view available facilities around the selected location.

- **Read traffic message** - Allows you to view traffic messages<sup>1</sup> around the selected location.
- **Information** - Shows information available about the selected location.
- **Store location** - Allows you to store the selected location in the memory. (Opens the menu **Set destination** → **Stored location** → **Edit** - see page 44).

menu-bar changes to **Resume guidance**. However, the system's car symbol continues to show the car's actual position on the map.

### Resuming guidance

- Select **Resume guidance** + **OK MENU**.

### Pause guidance

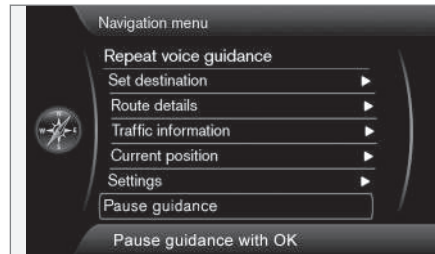

### Pause guidance

With the cursor on **Pause guidance** + **OK MENU** the guidance can be switched off temporarily after which neither visual nor acoustic guidance is given - at the same time the

<sup>1</sup> The service is not available for all areas/markets/states.



# 02 Get to know your navigation system

## Menu tree in three levels

Shown here are three of the menu tree's levels. Several of the menus at level 3 have further submenus - these are described in more detail in each respective section.

The menus are structured as follows:

<b>Menu level 1</b>	
<b>Menu level 2</b>	p. x
Menu level 3	
Menu level 4	

### Menus and functions

<b>Repeat voice guidance</b>	page 31
<b>Set destination</b>	page 40

<b>Address</b>	page 40
Area:	
City:	
Street:	
Number:	
Junction:	
Set single destination	
Add as waypoint	
Information	

<b>Point of interest (POI)</b>	page 41
By name	
Near the car	
Along the route	
Around point on map	
Along the street	
Along the motorway	
MyPOI near the car	
MyPOI around point on map	

<b>Stored location</b>	page 43
Set single destination	
Add as waypoint	
Information	
Edit	
Sort by	
Delete	

<b>Previous destination</b>	page 44
Set single destination	
Add as waypoint	
Information	
Store	
Delete	
Delete all	

<b>Return trip</b>	page 45
Start guidance	
Add as waypoint	
Edit itinerary	

<b>Postcode</b>	page 45
-----------------	---------



## Menu tree in three levels

<b>Latitude &amp; longitude</b>	page 46
<b>Select point on map</b>	page 46
<b>Route details</b>	page 47
<b>Itinerary</b> Start guidance Add another waypoint Edit itinerary	page 47
<b>Avoid</b>	page 48
<b>Next destination</b>	page 48
<b>Route instructions</b>	page 49
<b>Map of entire route</b>	page 49
<b>Map of remaining route</b>	page 49

<b>Start demo</b> or <b>Stop demo</b>	page 60
<b>Traffic information<sup>A</sup></b>	page 64
<b>Read traffic message</b>	page 66
<b>Traffic events on route</b> or <b>Traffic events ahead</b>	page 68
<b>Avoided traffic events</b>	page 68
<b>Current position</b>	page 50
<b>Settings</b>	page 51
<b>Traffic information<sup>A</sup></b> Traffic message	page 51

<b>Route options</b> Route type Route proposals Customise route Route learning Reset route learning	page 51
<b>Map options</b> Map colours Show dual map mode Single map settings Right map settings Left map settings POI on map Show full-screen map POI on map Compass Show current road name Show speed limits <sup>B</sup>	page 53



# 02 Get to know your navigation system

## Menu tree in three levels

02

<b>Guidance options</b>	page 55
Voice guidance	
Voice output volume	
Street names in voice guidance	
Turn-by-turn navigation *	
Time of arrival format	
Always show intersection map	
MyPOI Alert	
<b>System information</b>	page 56
GPS information	
Map version:	
Map loading progress	
<b>Import/edit MyPOI</b>	page 57
<b>Reset navigation settings</b>	page 58

<b>Delete all user data</b>	page 58
<b>Pause guidance</b>	page 33
or	
<b>Resume guidance</b>	

<sup>A</sup> Not available in all areas/markets/states.

<sup>B</sup> Not in cars with Road Sign Information (RSI – Road Sign Information).



Specify a destination.....	40
Itinerary.....	47
Current position.....	50
Settings.....	51
Simulation.....	60





# 03

## PLANNING YOUR TRIP





# 03 Planning your trip

## Specify a destination

### Address

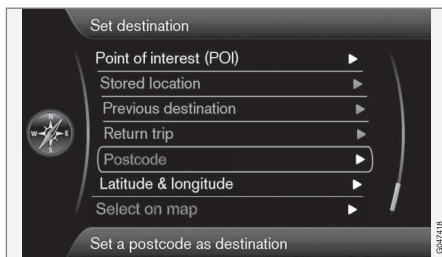
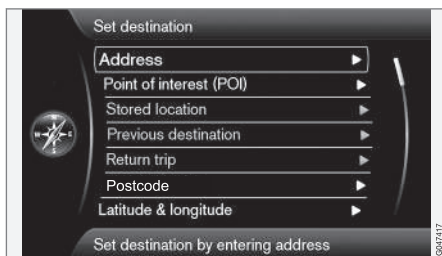

### Set destination → Address

There are several different ways to program a destination.

It is sufficient to simply specify a district/city and start the journey - it leads to the centre of the district/city.

If a destination's latitude and longitude are known then these can be entered.

See page 25 for information on how characters are written/entered into the system's various text fields.

### NOTE

The definition of city or area may vary from country to country and even within the same country. In some cases, it refers to a municipality and in others it refers to a district.

### City or street



*The cursor first rests on **Street**.*

How to search and locate a destination:

1. With the previous image view on the display screen - Press **OK** to activate the preset text box.
2. Enter the street's name **Street**: with the "daisy wheel" (see page 25) and then select a desired **City**:
3. Or **City**: + **OK** and start by entering it.

The following search criteria can be used:

- **Area**: - Enter a country.
- **City**: - Enter a district/city.
- **Postcode**: - Under **City**: the search can also be made using a post code.
- **Street**: - Enter the street address.
- **Number**: - Select one of the street's house numbers.
- **Junction**: - Select a destination based on where the two streets/roads intersect.
- **Set single destination** - Deletes any destinations in the itinerary and starts guidance to the current destination.
- **Add as waypoint** - Select + **OK** to add the address to the itinerary.
- **Information** - Select + **OK** to view information about the selected destination.



## Specify a destination

### More about Information

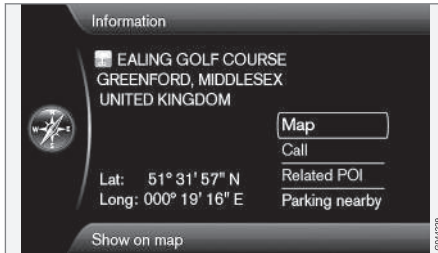

Select an address/street + **OK** - then the following can be selected:

- **Map** - Shows where on the map the location can be found - sometimes with additional information.
- **Call**<sup>1</sup> - Calls the facility if a telephone number is given.
- **Related POI** - Lists the facilities associated with the current/selected facility.
- **Parking nearby** - Lists parking where appropriate around the selected location, with distance.

### Facilities

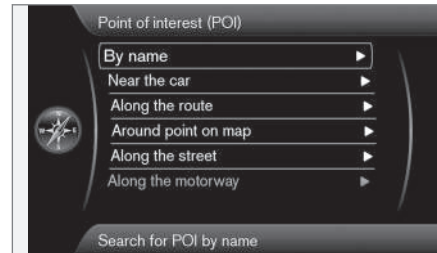

#### Set destination → Point of interest (POI)

The system contains a large number of searchable facilities which can be specified as destinations. The list of desired facilities can be shortened by specifying which facility/facilities the current search relates to:

- Select **Type**: and specify which facilities should be covered by the search (it is the same approach as described on page 54).

To select which facilities should be permanently visible on the map, go to the menu **Settings → POI on map** - see page 54.

All searches are made in the manner described in the previous section **City or street**:

1. Specify **Area:/City:/Type:/Name**..
2. Then select **Set single destination**, **Add as waypoint** or **Information + OK**.

### With name



### By name

In addition to searching with main group, such as Restaurant, the company name of the facility can also be used, e.g. "Peppers Bodega". The procedure is the same as when searching with Address, see page 40.

When searching with **Name**: with e.g. "London Airport", all combinations with "London" will be shown when "Lo" is entered. The more letters you input the more specific the reply.

A search with "Lo" also produces reply alternatives such as "Restaurant Lou Trivalou" for

<sup>1</sup> Requires connected mobile phone.



# 03 Planning your trip

## Specify a destination

example, as alternatives containing several words separated by spaces are also included in the search.

### NOTE

There are subcategories of restaurants to simplify searches.

### Around the car Near the car

Search of facility refers to the area around the car's current position.

### Along the route

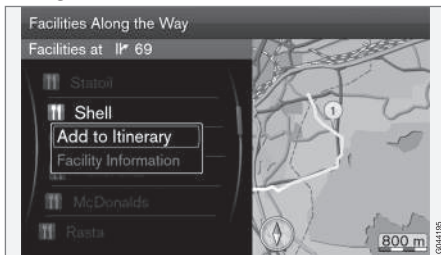

### Along the route

Search of facility refers to the area along the set itinerary.

### Around point on map

#### Around point on map

Search of facility is made with the Scroll function crosshair - see page 32.

- The scroll map is shown - place the crosshair at the desired location + **OK**

### Along the street



### Along the street

Search of facility refers to the area along a specific street/road.

### Along the motorway

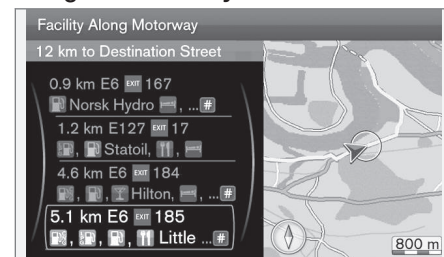

### Along the motorway

This search lists the facilities easy to reach from the motorway, e.g. service stations along the motorway or at the exits.

### NOTE

The car must be on the motorway in question for the list to be available for presentation.



## Specify a destination

## My POI around the car

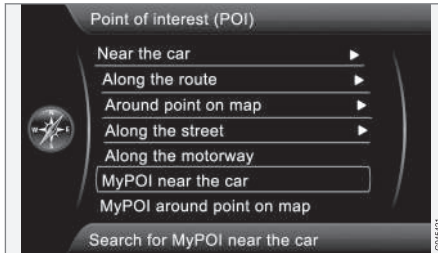

## MyPOI near the car

This function allows facilities that the user has entered into the system - My POI<sup>2</sup> - to be searched for in the area around the car's current position. The search is made within a radius of approx. 32 km.

## NOTE

My POI icons are shown on the map from and including scale "1.0 km" and lower.

## My POI around point on map

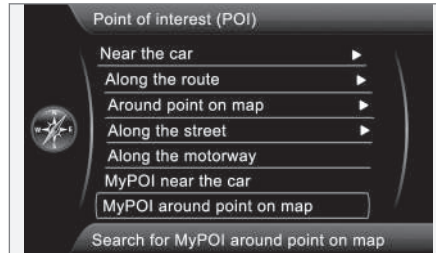

## MyPOI around point on map

Facilities that the user has entered into the system - My POI<sup>2</sup> - are searched for here around the cursor position on the map. The search is made within a radius of approx. 32 km.

The search is made with the Scroll function's crosshair - see page 32.

- The scroll map is shown - position the crosshair on the desired My POI + **OK**

## Stored location

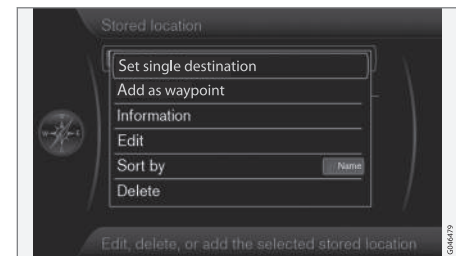

## Set destination → Stored location

The driver can store a large number of his/her own locations in the system. They can then be used to quickly draw up/supplement an itinerary.

## Storing a location

To store a chosen location:

1. Use the Scroll function (see page 32) and select the location to be stored.
2. Press **OK** to display the "crosshair" menu.
3. Select **Store location + OK** - now the location is stored and is included in the list **Stored location**.

<sup>2</sup> For information about how individual facilities (My POI) can be added to the map database - see page 57.



# 03 Planning your trip

## Specify a destination

Mark a stored location in the list + **OK** and choose between the following options/headings:

### Set single destination

#### Set single destination

This option deletes any previous destinations in the itinerary, and starts guidance on the map.

### Add waypoint

#### Add as waypoint

Opens the same window as for **Set destination** → **Address** → **Add as waypoint** - see page 47.

### Information

#### Information

Opens the same window as for **Set destination** → **Address** → **Add as waypoint** → **Information** - see page 41.

### Edit

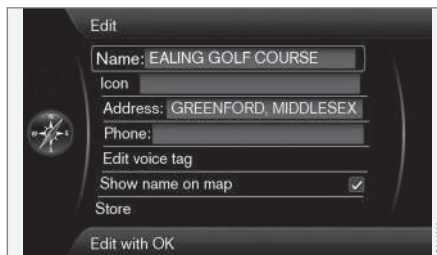

### Edit

Opens selected "Stored location" and allows you to change/update the following:

- **Name** - Enter a name for the location.
- **Icon** - Select the symbol to represent the current location.
- **Address** - Opens the map to adjust the location's geographical position.
- **Phone** - Enter a telephone number.
- **Edit voice tag** - Record own sound<sup>3</sup>. Follow the on-screen instructions.
- **Show name on map** - Untick if the location name is not to be displayed on the map.
- **Store** - Save changes with **OK**.

### Sort by

#### Sort by

Select whether stored locations are to be sorted by:

- **Name**
- **Icon**
- **Distance**
- **Chronological**

### Clear

#### Delete

- Delete a marked stored location.

### Previous destinations

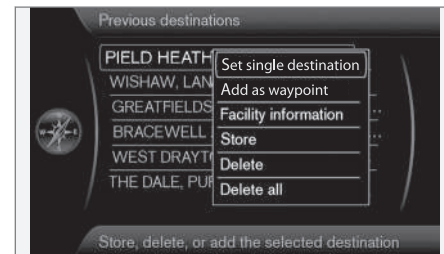

Set destination → Previous destination

<sup>3</sup> Only in combination with audio system "High Performance" or "Premium".



## Specify a destination

Previously used destinations are stored here. Mark one of them and then select between:

- **Set single destination**
- **Add as waypoint**
- **Information**
- **Store** - see more about this option after the next image.
- **Delete**
- **Delete all.**

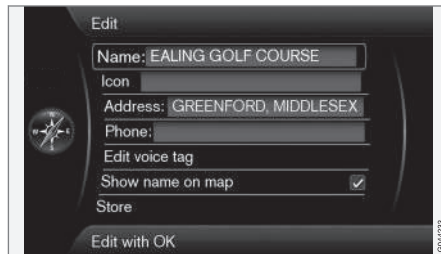

The **Store** option presents this Edit menu.

The **Store** menu option leads to the same Edit menu as for **Stored location** → **Edit**.

For more information - see page 43.

- To add/change information for the destination - Mark **Store** + **OK**.

## Return trip

## Return trip

Goes back to the itinerary starting point. Can be selected anywhere/anytime in the itinerary.

## Post code

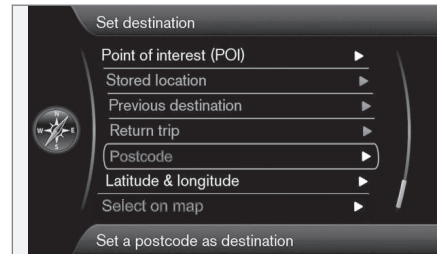

## Set destination → Postcode

Search destination by post code:

1. Highlight **Postcode**: + **OK** to view the "daisy wheel".

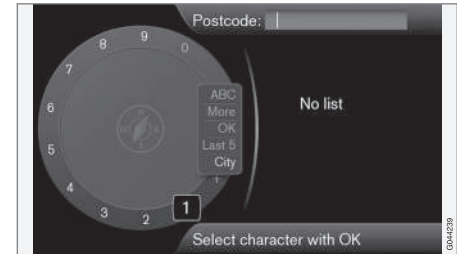

2. Select characters with the **TUNE** knob and type/enter them by pressing **OK**. (Or type/enter characters using the centre console's numerical buttons - see page 25).

## NOTE

Presentation of post code may differ between different markets/areas.



## Specify a destination

### Search via Latitude/Longitude

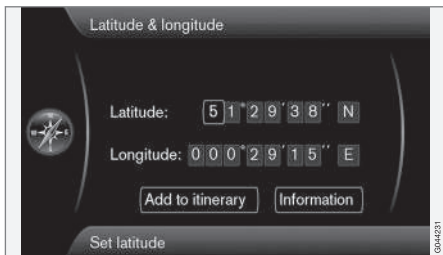

#### Set destination → Latitude & longitude

Select destination with GPS coordinates:

1. Place the cursor on the character to be changed and press **OK** - the character window becomes "active".
2. Enter a digit using the centre console's numerical buttons (or turn **TUNE**) - finish with **OK** or place the cursor on the next character - previous character window is "deactivated".
3. Move the cursor to the next character location to be changed and repeat.
4. With the cursor in both windows to the far right, (or turn **TUNE**) the letters for the cardinal points - **N = 6**, **S = 7**, **W = 9** and **E = 3** are entered.

5. When both coordinates are entered - mark **Add as waypoint + OK** to add the location to the itinerary.

### Add to itinerary Add as waypoint

Add the location of the selected coordinates on the map to the itinerary.

### Information Information

Shows information available about the location.

### Search via point on map

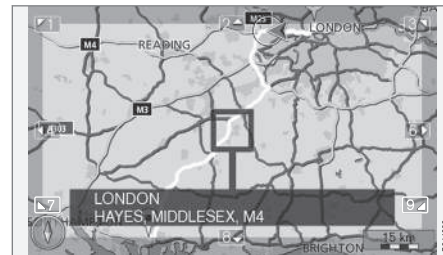
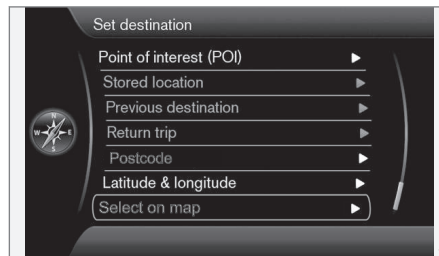

#### Set destination → Select point on map

Shows maps with current location pointed out by a cursor.

- Turn **TUNE** to change the scale.
1. Move the crosshair using the centre console's numerical keys: **[6 MNO]** moves to the right, **[8 TUV]** moves down, etc. - see page 32.
  2. When the desired location has been found - Press **OK**.





## Itinerary

## Menu overview

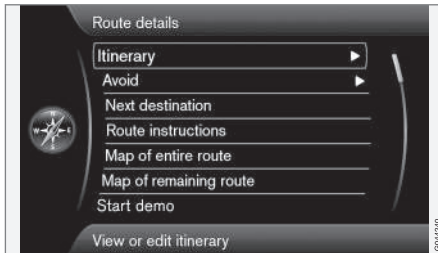

## Route details

The system handles one itinerary at a time with a maximum of 8 intermediate destinations.

The first specified destination is the journey's Final destination - subsequent input destinations are Intermediate destinations.

**i** NOTE

The last added destination will always be Waypoint-1 - the previous Waypoint is raised one step: So "Old" Waypoint-1 will be Waypoint-2, etc.

If a new order is required - Go to **Route details** → **Itinerary**, **Mark a way point** and → **Move in list**.

## Enter an itinerary

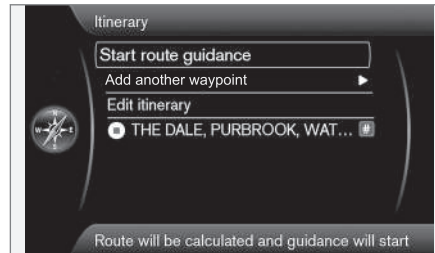

## Route details → Itinerary

Draw up an itinerary with several stops to avoid entering destination after destination during your trip.

One final destination with up to 8 intermediate destinations can be specified.

## Start guidance

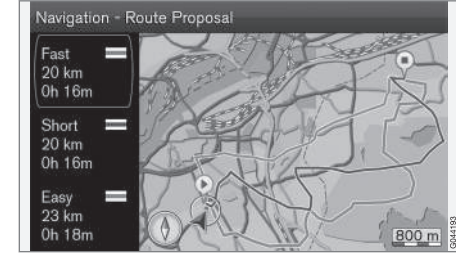

Results with "Route proposal 3" ticked.

Cursor on **Start guidance** + **OK** activates current itinerary.

If the display of 3 alternative itineraries is pre-set then the driver can select one of them, see the menu **Settings** → **Route options** → **Route proposals**, page 52.

**Add waypoint**

Adds an intermediate destination. Gives the same menu as in "**Set destination**" - see page 40.

**Edit itinerary**

Gives the options:



# 03 Planning your trip

## Itinerary

- **Clear itinerary** - deletes the current itinerary.
- **Route options** - opens a shortcut to **Settings** → **Route options** - see page 51.

### Intermediate destinations in the itinerary

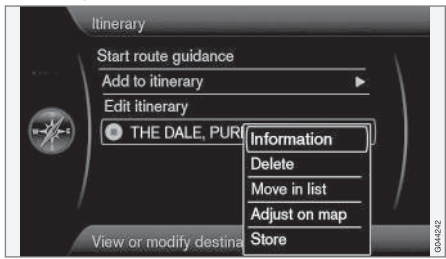

By selecting intermediate destination + **OK** each intermediate destination in the itinerary can be updated.

- **Information** - Full name and address, and Latitude and Longitude. In addition, a facility can be Called up and any Facilities around the location and Car parking in the vicinity can be seen.
- **Delete** - deletes the intermediate destination.
- **Move in list** - changes the order in the itinerary.

- **Adjust on map** - shows the location on the map with a crosshair. Another location there be scrolled forward and selected with **OK**, see more about the Scroll function on page 32.
- **Store** - opens the menu **Set destination** → **Stored location** → **Edit** - see page see page 44).

### Avoid

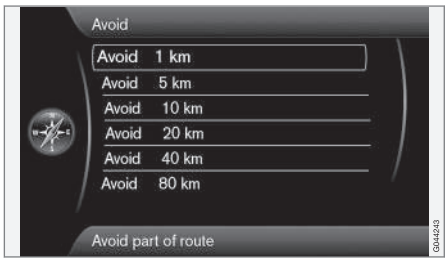

### Route details → Avoid

A distance in the itinerary can be deselected here. The alternative distances are calculated from the car's current position. The system then selects another route.

- Select the desired option + **OK**.

### Next destination

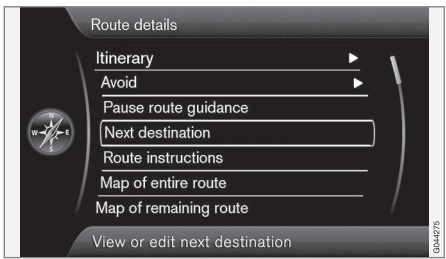

### Route details → Next destination

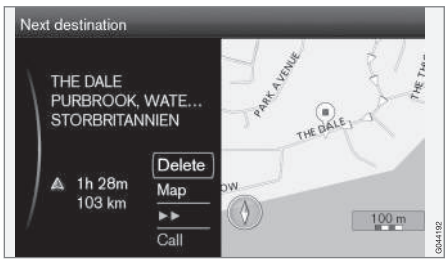

Shows the next intermediate destination's position on the map, name, address, estimated time of arrival and distance there. Also gives the options:

03



## Itinerary

- **Delete** - deletes the current intermediate destination and shows the next one.
- **Map** - shows the position on the map in the Scroll menu, see page 32.
- **>>** - scrolls to the next intermediate destination in the itinerary, in a loop.
- **Call** - calls up the facility if possible.

### Route instructions

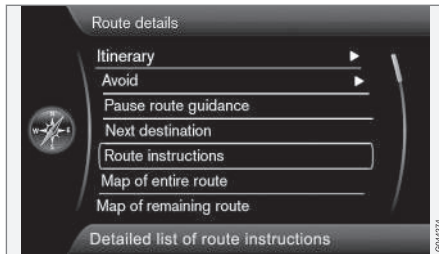

Route details → Route instructions



The itinerary's waypoints are listed here.

### Map of entire route



Route details → Map of entire route

The whole itinerary is shown here - scaled down to fit on the display screen.

Otherwise, the same functions as in the Scroll menu, see page 32.

### Map of the remaining route

Route details → Map of remaining route

Shows screen image similar to the one in the previous section, but here only with the itinerary's remaining distance from the car's current position.

Otherwise, the same functions as in the Scroll menu, see page 32.



# 03 Planning your trip

## Current position

### Where am I?

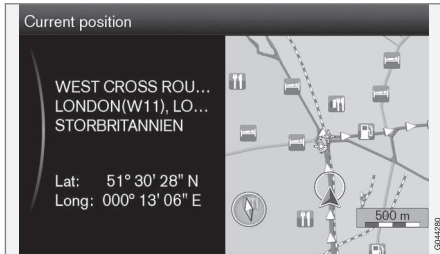

## Current position

Displays a map with the car's current position and information on the location, such as name and coordinates.

03

## Settings

## Traffic information

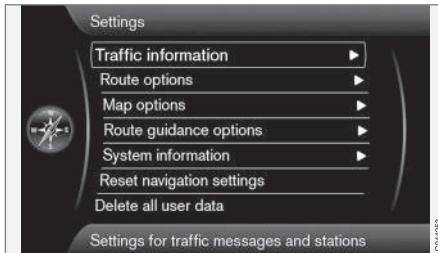

Settings → Traffic information

Further settings that affect traffic information can be made, in addition to those described here - see page 68.

## Traffic message

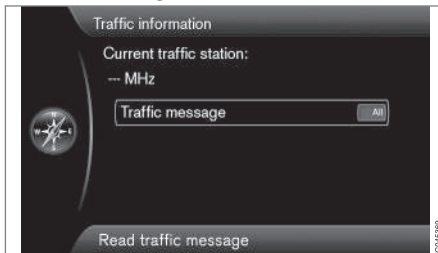

## Traffic message

Certain traffic message sorting can be done here:

- **All** - all reported traffic disruptions appear.
- **Most serious** - indicates, for example, closed roads due to accidents or other large/long-term disruption.
- **None** - indication of traffic problem off.

## NOTE

This setting does not affect the calculation of a route.

## Route options

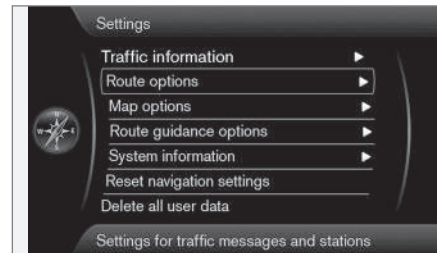

Settings → Route options

## Route type

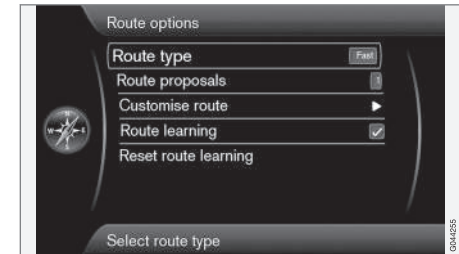

## Route type

Three types of route can be selected here:

- **Fast** - major and fast roads such as e.g. motorways are prioritised. In some cases this is neither the shortest travel time nor route.
- **Short** - short route prioritised. In some cases the route uses minor roads.
- **Easy** - minimum number of junctions and similar traffic systems prioritised.



## Settings

### Route proposals

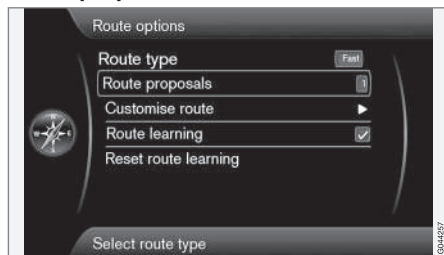

#### Route proposals

At the command **Start guidance** there may be several similar suitable options. Select this if the driver should be asked in case there are several options to choose from:

- Select **1** if the route type shall be selected based on the option under Route type in the previous section.
- Select **3** if the driver shall select between the three route types before guidance is started.

See more information on page 47.

### Customise route

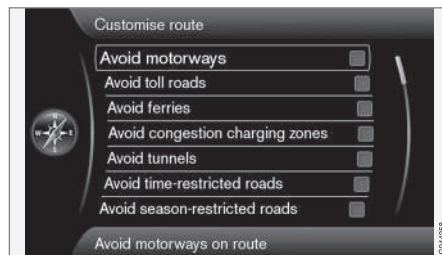

#### Customise route

Here you can deselect certain traffic suggestions. Tick to avoid the following element<sup>1</sup> along the route:

- **Avoid motorways**
- **Avoid toll roads**
- **Avoid ferries**
- **Avoid congestion charging zones**
- **Avoid tunnels**
- **Avoid time-restricted roads**
- **Avoid season-restricted roads**
- **Avoid car trains**
- **Avoid unverified roads**
- **Avoid borders**

**NOTE**

- If an itinerary is entered when these selections are made then there may be a certain delay after an option has been ticked/unticked since the itinerary must be recalculated.
- If tunnels, toll roads and motorways are not selected then these are avoided as far as possible and are only used if no other reasonable alternative is available.

### Route learning

#### Route learning

The basic condition is a stored itinerary. If the driver deviates from the proposed route and takes a different route to the final destination than the system recommends, the system memorises the driver's choice.

If the same itinerary is used again 2 times and the driver repeats the route choice, the system will instead show the path that the driver selected.

Ticked window means that a route that is driven 3 times is stored as route instead of the original route.

<sup>1</sup> Available options vary depending on market/area/state.



## Settings

## Reset route learning

Reset route learning

Erase driving history.

## Map options

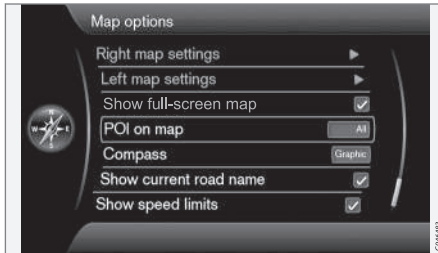
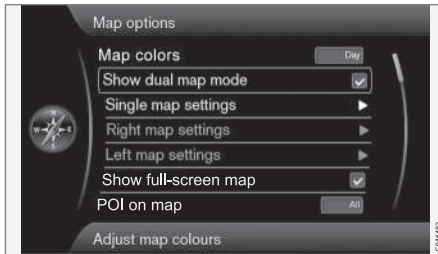

Settings → Map options

## Map colours

## Map colours

Choose between:

- **Automatic** - a light sensor detects whether it is day or night.
- **Day** (in previous image)
- **Night**

## Single map settings

## Single map settings

- **Map orientation** - Select **Heading** or **North**.

**North** - the map always shows North at the top of the screen. The car symbol moves in the relevant direction on the screen.

**Heading** - the car symbol is in the centre and always points up on the screen. The map image rotates under the car symbol in relation to how the road bends.

- **Map view** - Select **2D** or **3D**.

**2D** - car symbol and map image seen at right angles straight from above.

**3D<sup>2</sup>** - car symbol and map image seen obliquely from the side/above.

## Show dual map mode

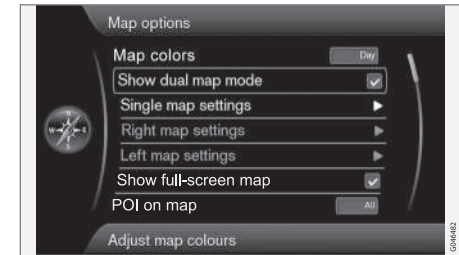

## Show dual map mode

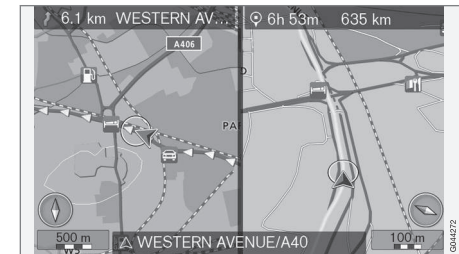

The screen can display the map of the entire image area or the same map view in 2 different scales on each left and right half.

Select by ticking in the box by **Show dual map mode + OK** and **EXIT**.

<sup>2</sup> Only if Map orientation>Heading is selected.



## Settings

### Adjust the map scale in dual map mode

To view both maps with different map scales, they can be adjusted individually as follows:

1. Start from map view mode. Turn the **TUNE** knob to the left and right - one screen half is surrounded by a colour frame.
2. Press **OK** - selected screen half is now "active".
3. Turn the **TUNE** knob to adjust the scale.
4. Press **OK** again - done, the screen half is "deactivated".

### Left map settings

#### Left map settings

- **Map orientation** - Select **Heading** or **North**.
- **Map view** - Select **2D** or **3D**.

### Right map settings

#### Right map settings

Same as for left map - see previous section.

### Show full-screen map

Cursor on **Show full-screen map** + **OK** ticks the function that shows the map image across the whole of the display screen. This removes the information fields in the bottom and top of the screen with information on e.g. passenger compartment temperature.

### Facility on map

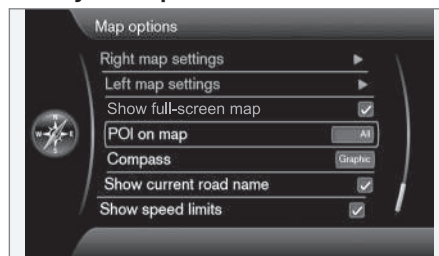

### POI on map

Tick the desired option for how many facilities are to be shown on the map:

- **All** - all facilities appear.
- **None** - no facilities appear.
- **Selected** - A menu with all facilities appears: Tick the facilities that you want to appear on the map.

### **i** NOTE

If a POI category with many symbols on the map is deselected/switched off, more POIs from other categories can be shown/viewed on the screen.

Possible facilities are listed on page 72.

### Compass

#### Compass

Select the type of compass you want to appear on the map image:

- **Graphic**
- **Text** - compass direction (upwards on the display screen) is indicated by a letter, e.g. **N** for "North".
- **None**.

See more information about the compass on page 31.

### Show current road name

Cursor on **Show current road name** + **OK** ticks the function that shows the name of the street/road where car is located in the lower edge of the display screen.

### Show speed limits

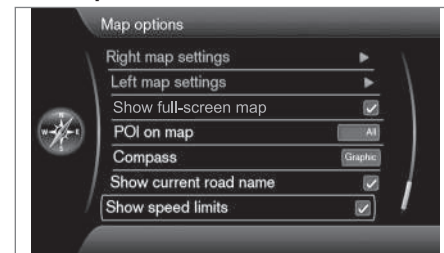





## Settings

Cursor on **Show speed limits** + **OK** ticks the function that shows a traffic sign with the current speed limit in the top right-hand corner of the display screen.

## Cars with Road Sign Information - RSI

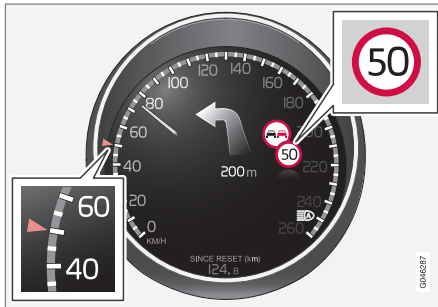

In cars with the function for identifying road signs (Road Sign Information) the current speed limit is only shown on the combined instrument panel - the option to select the display of the speed limit on the map image is not available in these cars.

See the normal owner's manual for the car for more information on RSI.

## Guiding options

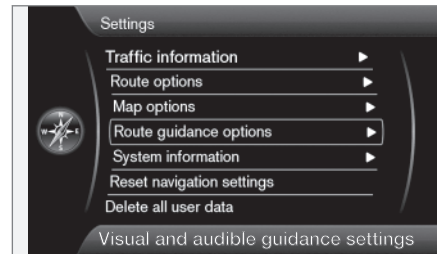

## Settings → Guidance options

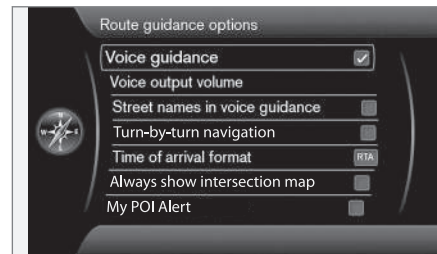
Voice guidance  
Voice guidance

If you want voice guidance - tick option **Voice guidance**. See more information on page 31.

## Voice output volume

## Voice output volume

The option shows a volume control on the screen that can be used to adjust the Voice guidance volume.

- Adjust using the **TUNE** knob + **OK**.

See more information on page 17.

Street names in voice guidance<sup>3</sup>

Cursor on **Street names in voice guidance** + **OK** ticks the function that enables voice guidance information about distance and direction to be complemented with spoken names of streets and roads.

<sup>3</sup> Certain markets and languages.



# 03 Planning your trip

## Settings

### Navigation with Turn-by-turn

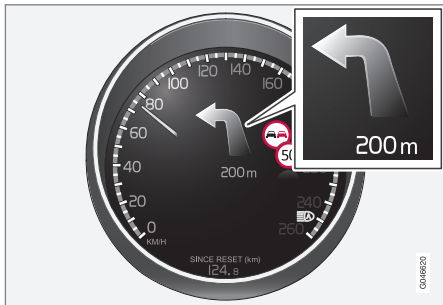

Cursor on **Turn-by-turn navigation** + **OK** ticks the function which means that the next manoeuvre in the itinerary, as well as the distance to it, is shown in the combined instrument panel.

### Time of arrival format

#### Time of arrival format

Select the time to appear on the screen:

- **ETA** - shows the estimated arrival time
- **RTA** - shows the remaining time until arrival.

### Show junction map in other program

The navigation system can work in the background while at the same time the display

screen shows a different program source, e.g. Radio or Phone.

Cursor on **Always show intersection map** + **OK** ticks the function that also shows detailed junction maps on half of the display screen when other sources/programs are in use - see page 31.

### Alarm for My POI

Cursor on **MyPOI Alert** + **OK** ticks the function that enables a preset warning sound to alert when the car approaches a My POI position - see page 57.

### System information

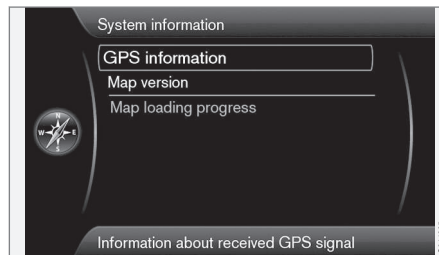

Settings → System information

### GPS information



### GPS information

The screen shows:

- **Number of received satellites:**
- **Received position**
- **Map-matched position**
- **Altitude:**
- The geographic name of the current position.



## Map version



### Map version:

The screen shows:

- **Software version:**
- **Map version:**
- **Map market:**

## Map download status

### Map loading progress

When updating the map database, the progress of the update is shown here. See more information on page 27.

## Import/Edit My POI

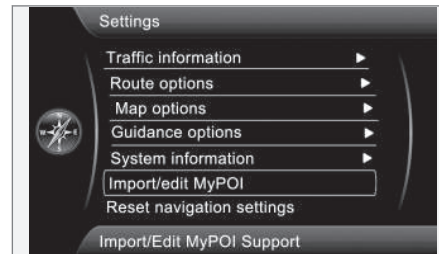

Settings → Import/edit MyPOI

Many companies offer POI files on their Internet pages. Using this function the user can supplement Volvo's map database with facilities from other suppliers.



### NOTE

- Adding POI files to the map database requires a certain amount of computer knowledge!
- File format for POI files and how the files are downloaded from the Internet are determined by the respective manufacturer/distributor. Consequently there is no standardised process for downloading the POI files from the Internet - and for this reason this owner's manual does not show an exact step-by-step description.
- If you have any questions - contact a Volvo dealer.

In order to show the principle for how to download a POI file from the Internet, a simple example follows here with the fictitious company "Department Store" and its stores:

1. Go to the company's page on the Internet and search for the location with its POI file.
2. Select a POI file with the "gpx" format and download it to the computer - if the format is not available then the POI file must be converted to the gpx format<sup>4</sup> after downloading.

<sup>4</sup> There are freeware conversion programs available for download from the Internet.



## Settings

3. Load the POI file "Department Store.gpx" onto a USB memory stick.
4. Then insert the USB memory stick into the car's USB port (under the tunnel console's armrest/hatch) and locate **Settings** → **Import/edit MyPOI** in the menu system.
5. Select **Import + OK** and follow the onscreen instructions.

When the import is complete, some settings can be made for the new My POI group "Department Store":

- the name can be changed
- the map image My POI icon can be replaced (if an icon is included in the imported POI file it automatically becomes the default)
- one of 3 sounds can be selected (to get a warning when the car approaches the My POI icon - see page 56)
- choose whether or not the My POI icon is to be shown on the map.

When all selections have been made, select **Store + OK** to finish, or a new POI group can be imported/edited.

All facilities added are grouped under the heading "My POI".

### NOTE

The type of information permissible for inclusion on the map is stipulated in national legislation. For current information, see [www.volvocars.com/navi](http://www.volvocars.com/navi).

The map database can be complemented with 100 My POI groups or 50 000 My POI locations in GPX 1.1 format.

### NOTE

In addition to all the variants of POI files that can be downloaded from the Internet, Volvo can offer supplementary files for certain markets - contact your local Volvo dealer for information on any possible options.

## Reset navigation settings

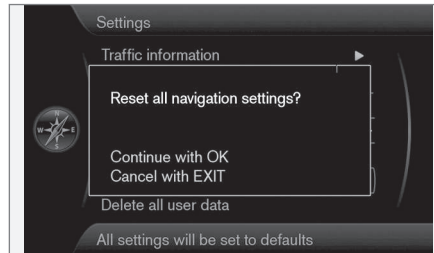

## Settings → Reset navigation settings

This function resets the system to default settings.

The menu option **Settings** → **Reset navigation settings + OK** gives a screen image with the question **Reset all navigation settings?**, **Continue with OK Cancel with EXIT** - press **OK** to reset the settings to default settings or undo with **EXIT**.

## Erase all user information

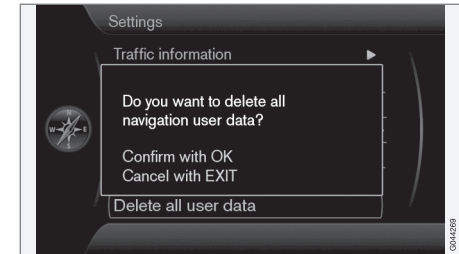

## Settings → Delete all user data

The menu option **Settings** → **Delete all user data + OK** gives a screen image with the question **Do you want to delete all navigation user data?**, **Continue with OK**



### Settings

**Cancel with EXIT** - press **OK** to delete or undo with **EXIT**.

The following settings are deleted with **OK**:

- all stored locations
- history for **Last 5**
- previous destinations
- route learning
- imported My POI data
- changed default settings.



# 03 Planning your trip

## Simulation

### Start demo

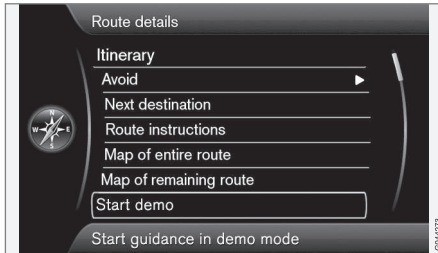

Route details → Start demo

The journey specified in the itinerary is simulated here.

The system shows how the journey to the itinerary's specified destination will be carried out.

To exit the demo run:

- The previous menu option **Start demo** has switched to **Stop demo** - Select + **OK**.

#### NOTE

A destination must be entered in order for the demo to work.

03



General.....	64
Reading information.....	66
Handling traffic problems.....	68



G000000



04

TRAFFIC INFORMATION

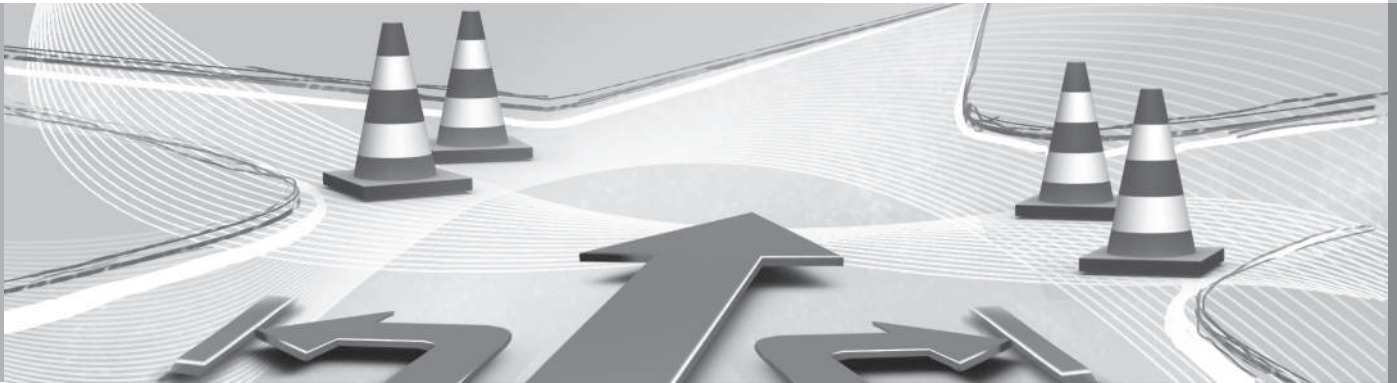



# 04 Traffic information

## General

### Display and reception

Transmitted traffic information is always received and presented - even if no destinations are given.

How traffic information should be presented can be set and changed in **Settings**, see page 51.

The presentation of traffic information also depends on how it is transmitted.

### NOTE

Traffic information is not available in all areas/countries.

The traffic information transmission areas are constantly being expanded.

### Traffic symbols on the map

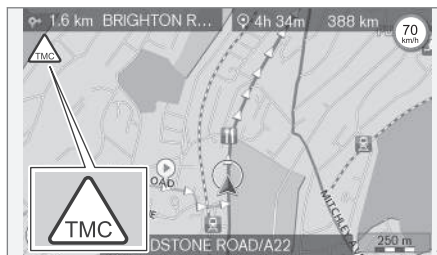



Symbol for traffic message/problems.

When there is at least one traffic message along the itinerary route, a TMC symbol<sup>1</sup> appears in the map's upper left-hand corner.

The **scroll function** (see page 32) can be used to scroll through the traffic problem to see its precise position and nature.

### Point on map

Traffic problems are marked with arrows, lines and frames:

	Traffic with disruption
	Traffic with disruptions in both directions
	Extent

### Marking's colour

Colour of arrows, lines and frames indicates the degree of the disruption:

Black	Closed road
Red	Stationary traffic
Orange	Slow traffic
Yellow	General information

### Type of traffic disruption

Shown here are examples of map symbols<sup>2</sup> that can mark different disruptions in the traffic:

<sup>1</sup> Traffic Message Channel

<sup>2</sup> Map symbols may vary between different markets/states.



	Accident
	Contraflow
	Diversion
	Information
	Narrow road
	Parking information
	Congestion
	Roadwork
	Slippery road
	Other hazard
	Closed road

### Extent



Certain traffic messages also contain information on the extent of the traffic obstruction.

On all scales up to 5 km - except the traffic message symbol, a line the same colour as the direction arrow is shown along the affected route. The length of the line is corresponds to the extent (distance) of the traffic problem.

### Size of area for traffic information

The scale of the map determines how great a quantity of traffic information can be shown - the larger the map area shown on the screen, the more information can be displayed.



## Reading information

### Message



Examples of, with arrows, selected traffic problems and their extent.



When the crosshair is placed over a traffic problem (indicated by an arrow along the road) you'll see a flashing frame with a traffic disruption symbol (e.g. slippery road) on the map.

To take advantage of the symbol's traffic information:

- Press **OK** and select **Traffic information + OK**.

### Traffic information

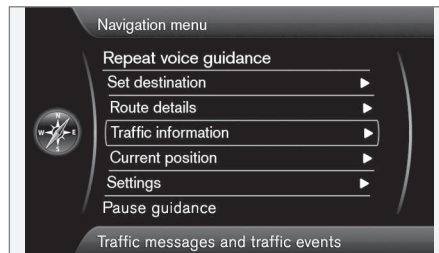

Main menu.

### Traffic information

#### Read traffic message

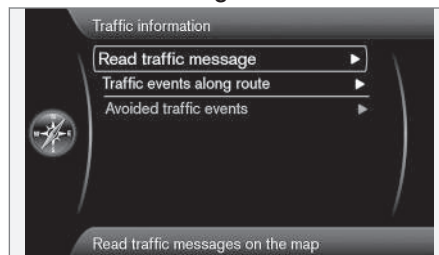

#### Read traffic message

With the cursor on **Read traffic message + OK** the following view is shown:

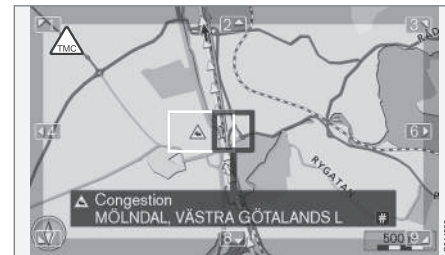

1. Scroll the crosshair to the traffic incident (coloured line/arrow parallel to the affected road section) about which information is required - a road sign with frame starts to flash out on the map.
2. Press **OK** - Following which, information like this is shown:



Detailed information on the traffic problem is linked to the symbol, and to the extent that

**Reading information**

information is available the following is also displayed:

- duration
- restrictions on speed, vehicle width and height
- roads affected.

If there are several traffic problems in the crosshair frame, then the problem closest to the centre of the crosshair is shown first after a pressing **OK** once.

The upper section of the display screen can show e.g. "2/5" which means that the current information is number 2 of a total of 5 messages in the crosshair - the remaining messages can be scrolled to using short presses on **OK**.

- Return to map display with **EXIT**.



## Handling traffic problems

### To avoid traffic problems

#### Traffic problems ahead

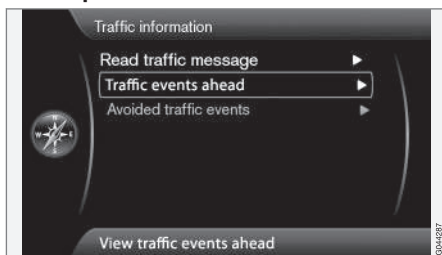

Menu bar 2 *without* itinerary added.

#### Traffic events ahead

Press **OK** on **Traffic events ahead** to list the current traffic problems.

#### Traffic problems along the route

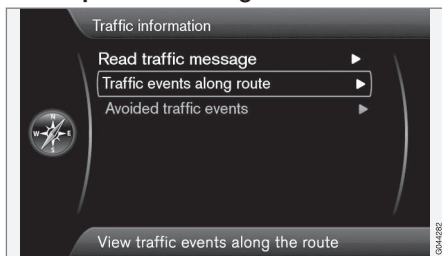

Menu bar 2 *with* itinerary added.

#### Traffic events on route

This is the same menu bar as in the previous section, but **with** an activated itinerary - the menu bar now instead reads **Traffic events on route**. Here the system can be made to guide past the traffic disruption using a different route.

Press **OK** on the selected menu bar to list the traffic problems along the route:

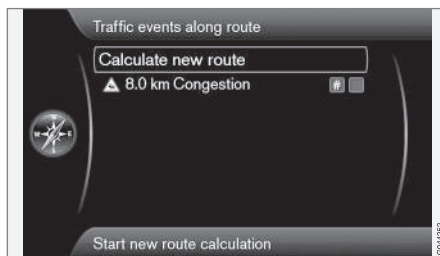

List with 1 disruption on the itinerary's route.

The driver can avoid traffic problems by allowing the system to determine a different route. Proceed as follows:

1. Select/highlight the traffic obstacle to be avoided + **OK** - the traffic problem is ticked.
2. If several obstacles need to be avoided - tick these too. A maximum of 15 can be selected.
3. Then select **Calculate new route** + **OK**.

The system then calculates a route that leads past the ticked traffic disruptions.

To obtain detailed information about a listed traffic problem:

- Select/highlight a traffic problem + **# INFO** - information about the traffic problem is shown.

#### Avoided traffic problems

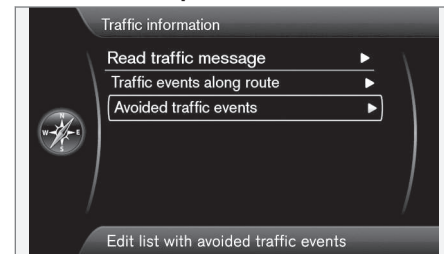

#### Avoided traffic events

Ticked traffic problems from the previous section are listed here.



## Handling traffic problems

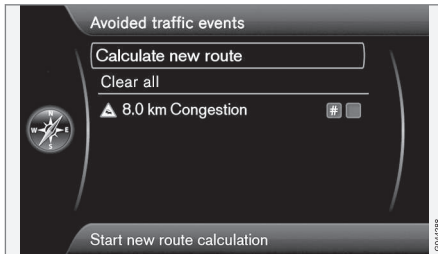

List with 1 editable traffic problem.

The following can be performed:

- **Clear all** - unticks all traffic problems.
- Select/highlight one of the traffic problems + **OK** - the traffic problem is unticked.
- Select/highlight one of the traffic problems + **# INFO** - detailed information with map image is shown on the display screen, see example on next page:



Detailed information - return to the menu using **EXIT**.

- Return to map display with **EXIT** or select **Calculate new route + OK** - the itinerary is adjusted with regard to the changes made.

Facilities..... 72





# 05

## SYMBOLS ON THE MAP





## Facilities

Specify which facilities are to be shown on the map or select **All** or **None** are to be shown - see page 54.

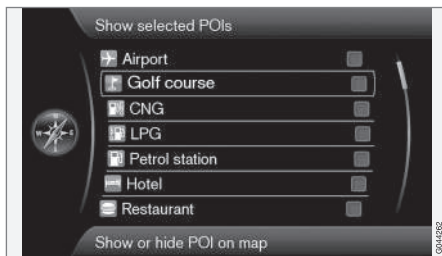

Pre-ticked facilities are shown on the map.

Settings → Map options → POI on map  
→ Selected

Proceed as follows:

- Select/mark facility with the **TUNE** knob - tick/untick using **OK** and close with **EXIT**.

To avoid making the map image difficult to read, the number of facilities that can be viewed simultaneously on the screen is limited - zooming into an area provides an opportunity to view several facilities.

**NOTE**

- The symbol for a facility and the number of facilities may vary between different countries.
- New symbols may appear and others disappear in conjunction with updating the map data - one can scroll through all the POI symbols for the relevant map system under **Settings** in the menu system.

Shown here are examples of symbols for different facilities - they are grouped here according to their function in society:

	Petrol station
	Petrol station with CNG (biogas)
	Petrol station with LPG
	Car wash
	Car workshop
	Car hire
	Motorsport facility

	Volvo dealer
	Parking
	Parking garage
	Parking, large vehicles
	Tourist information
	Historical monument
	Tourist attraction
	Ice skating
	Sport facility
	Exercise facility
	Ski facility
	Cinema
	Amusement park

## Facilities

	Animal park
	Opera Theatre
	Bar Nightclub
	Restaurant
	Restaurant
	Restaurant, Chinese
	Restaurant, seafood
	Fastfood
	Coffee shop
	Shopping Centre
	Dry cleaners
	Kiosk
	Hairdresser

	Rest area
	Camp site
	Hotel
	Conference facility Exhibition grounds
	Train station Commuter railway station
	Airport
	Bus station
	Ferry
	Marina Marina
	Civic building Authority
	University University

	City centre City centre
	Police station
	Fire station
	Library
	Hospital
	Pharmacy
	Bank ATM
	Post office
	Kindergarten School

Frequently asked questions.....	76
EULA - License agreement.....	78
Copyright.....	80



# 06

## QUESTIONS AND ANSWERS

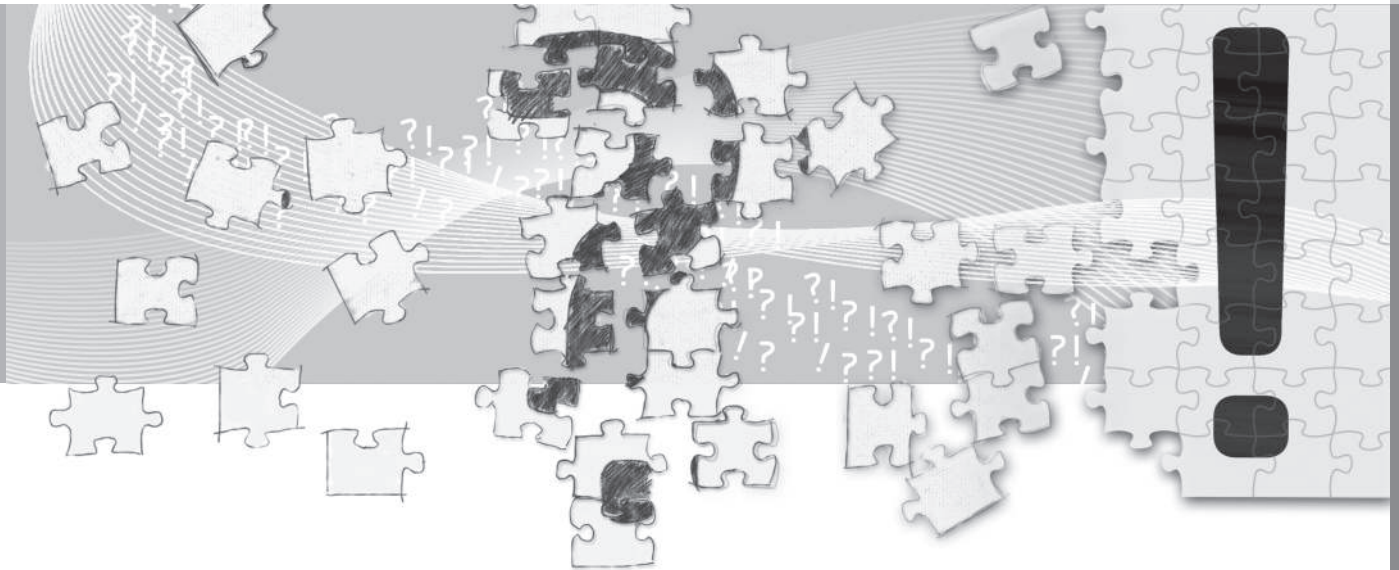



## Frequently asked questions

### **The position of the car on the map is wrong**

The Navigation system shows the position of the car to an accuracy of about 20 metres.

There is a greater chance of error when driving on roads lying parallel to another road, on winding roads, on roads on several levels and after driving a long distance without making any distinctive turns.

High mountains, buildings, tunnels, viaducts, over/underpasses etc. also have a negative affect on the reception of GPS signals, which means that accuracy in calculating the position of the car may decrease.

### **The system does not always calculate the fastest/shortest route**

When calculating a route outline, distance, width of road, type of road, number of right or left turns, roundabouts etc. are all taken into account in order to produce the best theoretical route. A more efficient selection of route may be possible based on experience and knowledge of the area.

### **The system uses toll roads, motorways and ferries even though I chose to avoid them**

For technical reasons, the system can only use major roads when calculating a route outline extending over a long distance.

If you selected to avoid toll roads and motorways, then they are avoided to the greatest possible extent and are only used if there is no other reasonable alternative available.

### **The position of the car on the map is incorrect after transportation**

If the car is transported, for example by ferry or train, or in such a way as to impede the reception of GPS signals, it can take up to 5 minutes before the position of the car is correctly calculated.

### **The position of the car on the map is incorrect after the car battery has been disconnected**

If power has been cut from the GPS antenna, it can take more than 5 minutes for the GPS signals to be received correctly and the position of the car to be calculated.

### **The car symbol on screen behaves erratically after a tyre change**

In addition to the GPS receiver, the car's speed sensor and a gyro assist in calculating the current position and direction of travel of the car. After fitting the spare wheel or changing between summer and winter tyres the system needs to "learn" the size of the new wheels.

In order for the system to work optimally it is recommended to turn the steering wheel to

full lock a few times while driving, in a suitable location.

### **The map image does not correspond with the real situation**

Factors such as the constant expansion and rebuilding of the road network, new traffic regulations constantly being introduced etc. mean that the map database is not always complete.

Continuous development and updating of map data is underway - a Volvo dealer can provide more information.

See also [www.volvocars.com/navi](http://www.volvocars.com/navi) for further information on maps etc.

### **The scale of the map sometimes changes**

There is no detailed map information in certain areas. The system then automatically changes the degree of magnification.

### **The expected menu option is missing**

Check the settings that have been made. Select **Reset navigation settings** to restore the original settings.

If this does not help, select **Delete all user data**.

**Frequently asked questions****The car symbol on screen jumps forwards or spins**

The system may need a few seconds to sense the position and movement of the car before driving off.

Switch off both the system and the engine. Start again, but remain stationary for a while before starting to drive.

**I shall go on a long trip but do not want specify a particular route outline to the cities I plan to travel through - How do I most simply create an itinerary?**

Specify the destination directly on the map using the hairline cross. The system automatically guides you to the final destination even though you are driving beside the intermediate destinations.

**My map information is not up-to-date**

Contact your nearest Volvo Dealer regarding the updating of map data.

See also [www.volvocars.com/navi](http://www.volvocars.com/navi)

**How can I easily check which map version is used?**

See **Settings** → **System information** → **Map version**: for information on version and geographic area covered.



## EULA - License agreement

### Notice to the user

PLEASE READ THIS END USER LICENSE AGREEMENT CAREFULLY BEFORE USING THE NAVTEQ DATABASE.

THIS IS A LICENSE AGREEMENT - AND NOT AN AGREEMENT FOR SALE - BETWEEN YOU AND NAVTEQ EUROPE B.V. FOR YOUR COPY OF THE NAVTEQ NAVIGABLE MAP DATABASE, INCLUDING ASSOCIATED COMPUTER SOFTWARE, MEDIA AND EXPLANATORY PRINTED DOCUMENTATION PUBLISHED BY NAVTEQ (JOINTLY "THE DATABASE"). BY USING THE DATABASE, YOU ACCEPT AND AGREE TO ALL TERMS AND CONDITIONS OF THIS END USER LICENSE AGREEMENT ("AGREEMENT"). IF YOU DO NOT AGREE TO THE TERMS OF THIS AGREEMENT, PROMPTLY RETURN THE DATABASE, ALONG WITH ALL OTHER ACCOMPANYING ITEMS, TO YOUR SUPPLIER FOR A REFUND.

### OWNERSHIP

The Database and the copyrights and intellectual property or neighbouring rights therein are owned by NAVTEQ or its licensors. Ownership of the media on which the Database is contained is retained by NAVTEQ and/or your supplier until after you have paid in full any amounts due to NAVTEQ and/or your supplier pursuant to this Agreement or similar agree-

ment(s) under which goods are provided to you.

### LICENSE GRANT

NAVTEQ grants you a non-exclusive license to use the Database for your personal use or, if applicable, for use in your business' internal operations. This license does not include the right to grant sub-licenses.

### LIMITATIONS ON USE

The Database is restricted for use in the specific system for which it was created. Except to the extent explicitly permitted by mandatory laws (e.g. national laws based on the European Software Directive (91/250) and the Database Directive (96/9)), you may not extract or reutilise substantial parts of the contents of the Database nor reproduce, copy, modify, adapt, translate, disassemble, decompile, reverse engineer any portion of the Database. If you wish to obtain interoperability information as meant in (the national laws based on) the European Software Directive, you shall grant NAVTEQ reasonable opportunity to provide said information on reasonable terms, including costs, to be determined by NAVTEQ.

### TRANSFER OF LICENSE

You may not transfer the Database to third parties, except when installed in the system for which it was created or when you do not

retain any copy of the Database, and provided that the transferee agrees to all terms and conditions of this Agreement and confirms this in writing to NAVTEQ. Multi-disc sets may only be transferred or sold as a complete set as provided by NAVTEQ and not as subset thereof.

### LIMITED WARRANTY

NAVTEQ warrants that, subject to the warnings set out below, for a period of 12 months after acquisition of your copy of the Database, it will perform substantially in accordance with NAVTEQ's Criteria for Accuracy and Completeness existing on the date you acquired the Database; these criteria are available from NAVTEQ at your request. If the Database does not perform in accordance with this limited warranty, NAVTEQ will use reasonable efforts to repair or replace your non-conforming copy of the Database. If these efforts do not lead to performance of the Database in accordance with the warranties set out herein, you will have the option to either receive a reasonable refund of the price you paid for the Database or to rescind this Agreement. This shall be NAVTEQ's entire liability and your sole remedy against NAVTEQ. Except as expressly provided in this section, NAVTEQ does not warrant nor make any representations regarding the use of results of the use of the Database in terms of its cor-



**EULA - License agreement**

rectness, accuracy, reliability, or otherwise. NAVTEQ does not warrant that the Database is or will be error free. No oral or written information or advice provided by NAVTEQ, your supplier or any other person shall create a warranty or in any way increase the scope of the limited warranty described above. The limited warranty set forth in this Agreement does not affect or prejudice any statutory legal rights that you may have under the legal warranty against hidden defects.

If you did not acquire the Database from NAVTEQ directly, you may have statutory rights against the person from whom you have acquired the Database in addition to the rights granted by NAVTEQ hereunder according to the law of your jurisdiction. The above warranty of NAVTEQ shall not affect such statutory rights and you may assert such rights in addition to the warranty rights granted herein.

**LIMITATION OF LIABILITY**

The price of the Database does not include any consideration for assumption of risk of consequential, indirect or unlimited direct damages which may arise in connection with your use of the Database. Accordingly, in no event shall NAVTEQ be liable for any consequential or indirect damages, including without limitation, loss of revenue, data, or use,

incurred by you or any third party arising out of your use of the Database, whether in an action in contract or tort or based on a warranty, even if NAVTEQ has been advised of the possibility of such damages. In any event NAVTEQ's liability for direct damages is limited to the price of your copy of the Database.

**THE LIMITED WARRANTY AND LIMITATION OF LIABILITY, SET FORTH IN THIS AGREEMENT, DO NOT AFFECT OR PREJUDICE YOUR STATUTORY RIGHTS WHERE YOU HAVE ACQUIRED THE DATABASE OTHERWISE THAN IN THE COURSE OF A BUSINESS.**

**WARNINGS**

The Database may contain inaccurate or incomplete information due to the passage of time, changing circumstances, sources used and the nature of collecting comprehensive geographic data, any of which may lead to incorrect results. The Database does not include or reflect information on - inter alia - neighbourhood safety; law enforcement; emergency assistance; construction work; road or lane closures; vehicle or speed restrictions; road slope or grade; bridge height, weight or other limits; road or traffic conditions; special events; traffic congestion; or travel time.

**GOVERNING LAW**

This Agreement shall be governed by the laws of the jurisdiction, in which you reside at the date of acquisition of the Database. Should you at that moment reside outside the European Union or Switzerland, the law of the jurisdiction within the European Union or Switzerland where you acquired the Database shall apply. In all other cases, or if the jurisdiction where you acquired the Database cannot be defined, the laws of the Netherlands shall apply. The courts competent at your place of residence at the time you acquired the Database shall have jurisdiction over any dispute arising out of, or relating to this Agreement, without prejudice to NAVTEQ's right to bring claims at your then current place of residence.



## Copyright

### Austria

© Bundesamt für Eich- und Vermessungswesen.

### France

Source Géoroute® IGN France & BD Carto® IGN France.

### Germany

Die Grundlagendaten wurden mit Genehmigung der zuständigen Behörden entnommen.

### Great Britain

© Based upon Crown Copyright material.

### Greece

Copyright Geomatics Ltd.

### Hungary

Copyright Top-Map Ltd.

### Italy

La Banca Dati Italiana è stata prodotta usando quale riferimento anche cartografia numerica ed al tratto prodotta e fornita dalla Regione Toscana.

### Norway

Copyright © Norwegian Mapping Authority.

### Poland

© EuroGeographics.

### Portugal

Source: IgeoE - Portugal.

### Spain

Información geográfica propiedad del CNIG.

### Sweden

Based upon electronic data © National Land Survey Sweden.

### Switzerland

Topografische Grundlage: © Bundesamt für Landestopographie.



### NOTE

Australia is not covered by this agreement; see special information.

© 2005 - 2014 NAVTEQ All rights reserved.

### Denso



Hereby, DENSO CORPORATION declares that this DN-NS-020 is in compliance with the essential requirements and other relevant provisions of Directive 1999/5/EC.



**A**

---

About	
information on the map disc.....	57
Acoustic signal	
Stored location.....	44
Additional information.....	20
Address	
enter.....	40
Aerial	
location.....	17
Arrow keys.....	20
Audible signal	
stored location.....	44
Automatic notification.....	51
Avoid	
ferries.....	52
motorways.....	52
toll roads.....	52
Avoid stretch of road.....	48

**B**

---

Back to starting point.....	45
Basic functions.....	19

Basic settings.....	14
Battery	
remote control.....	20
Brackets with English text.....	12

**C**

---

Change scale for traffic information.....	65
Changes in the manual.....	13
Compass.....	31
Component positioning, overview.....	16
Crosshair.....	32
Current position on map.....	50

**D**

---

Delete itinerary.....	48
Demo.....	60
Destination	
set.....	40
Distance unit	
ETA.....	56
RTA.....	56

DVD disc	
care.....	28
changing.....	27

**E**

---

English text in brackets.....	12
Enter an itinerary.....	47
Erase user information.....	58
ETA, distance unit.....	56

**F**

---

Facilities	
Symbols.....	72
Facilities as destination.....	41
Factory settings.....	14
Functions	
keypad and remote control.....	20

**G**

GPS information.....	56
GPS receiver.....	17
Guidance.....	47
quick guide.....	8
Guiding options.....	51

**I**

IR receiver and remote control.....	20
-------------------------------------	----

**J**

Junction.....	40
---------------	----

**K**

Keypad.....	20
location.....	17, 18

**L**

Licence code.....	27
Loudspeaker	
location.....	18

**M**

Main unit	
location.....	17
Map	
point on.....	46
Map areas.....	27
Map colour.....	53
Map image.....	30
Map mode.....	14
Map options.....	53
Map scroll.....	32
Map version.....	57
Map view.....	53
Menus/functions.....	34
My POI.....	43, 56, 57

**N**

Next destination in itinerary.....	48
------------------------------------	----

**O**

On/Off.....	14
Overview component location.....	16

**P**

Pause route guidance.....	33
POIs on the map.....	54
Post code	
search.....	45
Propagation.....	65

**R**

Read traffic message.....	51, 66
Reset navigation settings.....	58
Return to default settings.....	58
Return trip.....	45

Road sign information.....	55
Route options.....	52, 55
RSI - Road Sign Information.....	55
RTA, distance unit.....	56

## S

---

Save a location.....	43
Saved destinations.....	44
Scale	
change.....	46, 65
Scrolling.....	32
Search	
post code.....	45
via point on map.....	46
Search paths described in the manual.....	12
Set destination.....	40
Simulation.....	60
Start guidance.....	47
Store a location.....	43
Stored location	
Acoustic signal.....	44
add information.....	44
Stored locations.....	43

Symbols	
facilities.....	72
System activation.....	8
System options.....	56
System settings.....	14

## T

---

TMC receiver.....	17
Traffic information.....	17, 51
broadcast.....	64
Traffic information selection.....	51
Traffic symbols on the map.....	64
Transport of car.....	76
TV screen	
care.....	28

## V

---

Voice commands (Voice control).....	22
Voice control.....	22
Voice guidance.....	31
Volume control of voice messages.....	17

## W

---

Waypoint.....	48
---------------	----



