



WEB EDITION  
SENSUS INFOTAINMENT





## DEAR VOLVO OWNER

THANK YOU FOR CHOOSING VOLVO

We hope you will enjoy many years of driving pleasure in your Volvo. The car has been designed for the safety and comfort of you and your passengers. Volvo is one of the safest cars in the world. Your Volvo has also been designed to satisfy all current safety and environmental requirements.

In order to increase your enjoyment of the car, we recommend that you familiarise yourself with the equipment, instructions and maintenance information contained in this owner's manual.





## 01 Introduction

Introduction.....	7
Volvo Sensus.....	7
Change of ownership for cars with Volvo On Call*.....	8
Information on the Internet.....	9

01



## 02 MY CAR

MY CAR.....	11
MY CAR - search paths.....	12
MY CAR - menu options.....	12
MY CAR - Car settings.....	14
MY CAR - driving support system.....	15
MY CAR - System options.....	16
MY CAR - Voice settings.....	17
MY CAR - Climate settings.....	19
MY CAR Information.....	19

02



## 03 Audio and media

Audio and media.....	21
Audio and media - overview.....	22
Audio and media - operating the system.....	22
Audio and media - menu navigation.....	25
Rear control panel with headphones socket*.....	27
Favourites.....	27
Save as favourite.....	28
Audio and media - audio settings.....	28
Audio and media - general audio settings.....	29
Audio and media - advanced audio settings.....	30
Setting the equaliser.....	30
Setting the audio profile.....	30
Setting the audio volume and automatic volume control.....	31
Radio.....	31
Radio tuning.....	32
Automatic radio tuning.....	32
Radio station list.....	32
Manual radio tuning.....	33
Radio stations as presets.....	34
RDS functions.....	35



Alarms in the event of accidents and disasters.....	35
Traffic information (TP).....	36
Enhanced Other Networks (EON).....	36
News broadcasts.....	36
Radio programme types (PTY).....	37
Searching radio programme types (PTY)..	37
Show radio programme types (PTY).....	38
Volume control for interrupting radio programme types (PTY).....	38
Radio text.....	38
Automatic radio frequency update (AF)....	39
Regional radio programmes (REG).....	39
Scan radio frequencies.....	39
Resetting RDS functions.....	40
Digital radio* (DAB).....	40
Storing channel groups (Ensemble learn).	41
Navigation in channel group list (Ensemble).	41
DAB to DAB link.....	41
Digital radio* (DAB) - wavelength.....	42
Digital radio* (DAB) - subchannel.....	42
Digital radio* (DAB) - resetting.....	42
Media player.....	43



CD/DVD*.....	43
Playback and navigation of CD/DVD* disc.....	44
Playback and navigation of burned discs with audio/video files.....	45
Fast forward/reverse.....	46
Scan disc track or audio file.....	46
Random selection of disc track or audio file.....	46
Playback and navigation of DVD video discs.....	47
Camera angle for playback of DVD video discs.....	48
DivX® Video On Demand.....	48
Picture settings.....	48
Media player - compatible file formats....	49
External audio source via AUX/USB* input.....	49
Connecting an external audio source via AUX/USB* input.....	50
Playback and navigation of external audio source.....	51
Setting the audio volume for external audio source.....	52
Media Bluetooth®* .....	53



Connecting and disconnecting a Bluetooth®* device.....	54
Registering a Bluetooth®* device.....	54
Automatic connection of Bluetooth®* device.....	56
Changing to another Bluetooth®* device..	56
Disconnecting the Bluetooth®* device.....	57
Removing a Bluetooth®* device.....	57
Bluetooth® version information.....	58
Bluetooth® handsfree phone.....	58
Bluetooth® handsfree phone - overview..	59
Making and receiving calls.....	59
Bluetooth® handsfree phone - audio settings.....	60
Phone book.....	61
Phone book - quick search for contacts..	62
Phone book - character table keypad in centre console.....	63
Phone book - searching for contacts.....	63
Phone book - new contact.....	64
Phone book - speed dial numbers.....	65
Phone book - receiving a vCard.....	66
Phone book - memory status.....	66
Phone book - clearing.....	66



Voice recognition* control of a mobile phone.....	67
Language options for voice recognition* control of a mobile phone.....	68
Help functions for voice recognition* control of a mobile phone.....	69
Voice recognition* control of a mobile phone - user setting and voice volume....	69
Voice recognition* control of a mobile phone - voice commands.....	70
Voice recognition* control of a mobile phone - quick commands.....	70
Voice guidance* control of a mobile phone - dialling a number.....	71
Voice recognition* control of a mobile phone - dialling from the call register.....	71
Voice recognition* control of a mobile phone - dialling a contact.....	72
Voice recognition* control of a mobile phone - calling the voice mailbox.....	72
TV*.....	72
Searching TV* channels/Preset list.....	74
TV* - channel management.....	74
Information about the current TV* programme.....	75
Teletext*.....	75
Reception of TV* channel is lost.....	76



Remote control*.....	76
Remote control* - functions.....	77
Remote control* - battery replacement....	78
Multimedia system for rear seat (RSE)*....	79
Multimedia system for rear seat (RSE)* - overview.....	81
Wireless headphones*.....	82
Connecting an external source to RSE....	83
Multimedia system for rear seat (RSE)* - settings.....	84
Audio and media - menu overview.....	87
Menu overview - AM.....	87
Menu overview - FM.....	88
Menu overview - Digital radio (DAB)*.....	89
Menu overview - CD Audio.....	89
Main overview - CD/DVD Data.....	90
Menu overview - DVD Video.....	90
Menu overview - iPod.....	91
Menu overview - USB.....	91
Menu overview - Media Bluetooth.....	92
Menu overview - AUX.....	93
Menu overview - Bluetooth handsfree.....	93
Menu overview - TV.....	94
Menu overview - RSE*.....	95



## 04 Alphabetical Index

Alphabetical Index.....	98
-------------------------	----

# 04



# 01



## INTRODUCTION





## Introduction

*This supplement is a supplement to the normal owner's manual for the car.*

In the event of uncertainty regarding any of the car's functions, consult the owner's manual in the first instance. For answers to additional questions it is recommended to contact a dealer or a representative of Volvo Car Corporation.

The specifications, design features and illustrations in this supplement are not binding. We reserve the right to make modifications without prior notice.

© Volvo Car Corporation

## Owner's Manual in mobile devices



### NOTE

The owner's manual is available for download as a mobile application (applies for certain car models and mobile devices), see [www.volvocars.com](http://www.volvocars.com).

The mobile application also includes video and searchable content and easy navigation between different sections.

## Volvo Sensus

*Volvo Sensus is the heart of your personal Volvo experience. It is Sensus that provides information, entertainment and functions to simplify your ownership.*

# SENSUS

0048166

When you are sitting in your car you want control, and in today's interconnected world, this includes information, communication and entertainment when it is most suitable for you. Sensus covers all our solutions that enable connection\* to the outside world, at the same time providing you with intuitive control over all the car's capabilities.

Volvo Sensus combines and presents many functions in several of the car's systems on the centre console's display screen. With Volvo Sensus the car can be personalised by means of an intuitive user interface. Settings can be made in Car settings, Audio and media, Climate control, etc.

With the centre console buttons and controls or the steering wheel's right-hand keypad\*

\* Option/accessory, for more information, see Introduction.



functions can be activated or deactivated and many different settings can be made.

With a press on **MY CAR** all settings related to the driving and control of the car are presented, such as City Safety, locks and alarm, automatic fan speed, setting the clock, etc.

With a press on the respective function **RADIO, MEDIA, TEL\***, \*, **NAV\*** and **CAM\*** other sources, systems and functions can be activated, e.g. AM, FM, CD, DVD\*, TV\*, Bluetooth\*, navigation\* and park assist camera\*.

For more information about all functions/systems, see the relevant section in the owner's manual or its supplement.

## Overview

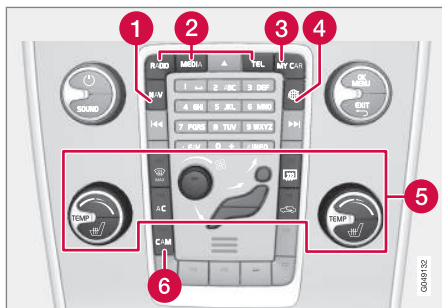

Centre console control panel. The figure is schematic - the number of functions and layout of the

buttons both vary, depending on the equipment selected and the market.

- 1 Navigation\* - **NAV**, see separate supplement.
- 2 Audio and media - **RADIO, MEDIA, TEL\***, see the relevant section in this supplement.
- 3 Car settings - **MY CAR**, see MY CAR (p. 11).
- 4 Internet-connected car - \*, see separate supplement (Sensus Infotainment).
- 5 Climate control system, see the Owner's Manual.
- 6 Park assist camera - **CAM\***, see the Owner's Manual.

## Change of ownership for cars with Volvo On Call\*

If the car is equipped with Volvo On Call, VOC it is important to change the owner of the service.

VOC is a supplemental service that consists of safety, security and comfort services. In the event of change of ownership it is important to change the owner of the service.

### Closing the VOC service

Contact a Volvo dealer in the event of change of ownership in order to close the VOC service.

In the event of change of ownership it is important to reset personal settings in the car to the original factory settings<sup>1</sup>, see Change of ownership.

### Starting the VOC service

It is very important that the VOC service changes owner so that the previous owner's ability to use services in the car is stopped. Contact a Volvo dealer in the event of a change of ownership.

### Related information

- Information on the Internet (p. 9)

<sup>1</sup> Only applies to cars that can be connected to the Internet.

### Information on the Internet

*At [www.volvocars.com](http://www.volvocars.com) there is further information concerning your car.*

*With a personal Volvo ID it is possible to log in to My Volvo which is a personal web page for you and your car.*



*QR code*

A QR code reader is required to read the QR code, which is available as a supplemental program (app) for several mobile phones. The QR code reader can be downloaded from e.g. App Store, Windows Phone or Google Play.

# 02

MY CAR

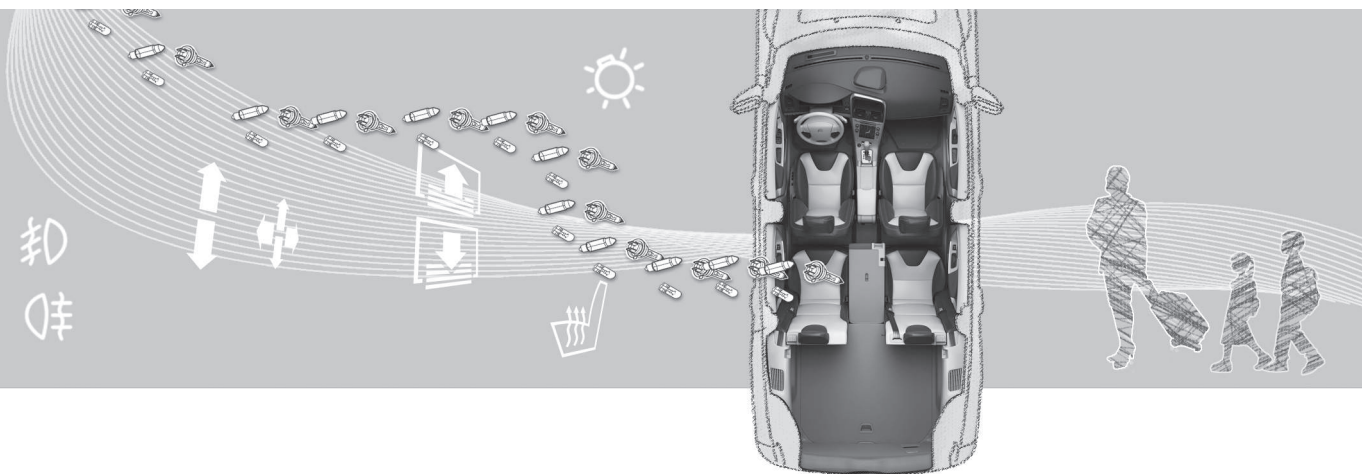



## MY CAR

*MY CAR* is a menu source that handles many of the car's functions, e.g. City Safety, locks and alarm, automatic fan speed, setting the clock, etc.

Certain functions are standard, others are optional - the range also varies depending on the market.

### Operation

Navigation in the menus is carried out using buttons in the centre console or with the steering wheel's right-hand keypad.

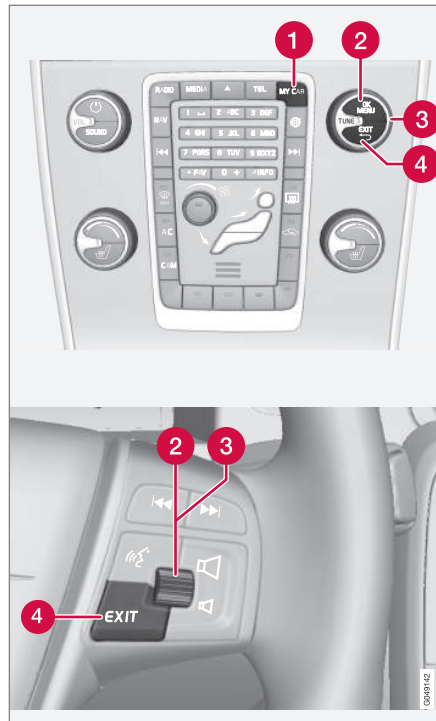

- 1 **MY CAR** - opens the menu system MY CAR.
- 2 **OK/MENU** - press the button in the centre console or the thumbwheel on the steering wheel to select/tick in the high-

lighted menu option or store the selected function in the memory.

- 3 **TUNE** - turn the knob in the centre console or the thumbwheel on the steering wheel to scroll up/down through the menu options.
- 4 **EXIT**

### EXIT functions

Depending on the function the cursor is on when **EXIT** is pressed, and on the menu level, one of the following may occur:

- phone call is rejected
- current function is interrupted
- input characters are deleted
- most recent selections are undone
- leads up in the menu system.

Short and long press may produce varying results.

A long press leads to the highest menu level (main source view), from where all of the car's functions/menu sources can be accessed.



## MY CAR - search paths

*MY CAR is a menu source that handles many of the car's functions, e.g. setting the clock, door mirrors and locks.*

Current menu level is shown at the top right of the centre console's screen. The search paths to the menu system's functions are specified on the form:

**Settings → Car settings → Lock settings → Doors unlock → Driver door, then all.**

The following is an example of how a function can be accessed and adjusted using the steering wheel keypad:

1. Press the centre console button **MY CAR**.
2. Scroll to the desired menu, e.g. **Settings**, with the thumbwheel and then **press** the thumbwheel - a submenu opens.
3. Scroll to the desired menu, e.g. **Car settings** and press the thumbwheel - a submenu opens.
4. Scroll to **Lock settings** and press the thumbwheel - a new submenu opens.
5. Scroll to **Doors unlock** and press the thumbwheel - a submenu of selectable functions opens.

6. Choose between the options **All doors** and **Driver door**, then **all** and press the thumbwheel - a cross is marked in the option's empty box.
7. Exit the programming by backing out of the menus incrementally with short presses on **EXIT** or with one long press.

The procedure is the same for the centre console controls (p. 11): **OK/MENU**, **EXIT** and the **TUNE** knob.

### Related information

- MY CAR (p. 11)
- MY CAR - menu options (p. 12)

## MY CAR - menu options

*MY CAR is a menu source where many of the car's functions can be handled, e.g. setting the clock, door mirrors and locks.*

The following options are available in menu source **MY CAR**:

- **My S60<sup>1</sup>**
- **Trip statistics<sup>2</sup>**
- **DRIVE<sup>3</sup>/Hybrid<sup>2</sup>**
- **Support systems**
- **Settings**

### My S60<sup>1</sup>

**MY CAR → My S60<sup>1</sup>**

The screen shows a grouping of all of the car's driver support systems - these can be activated or deactivated here.

### DRIVE<sup>3</sup>

Parts of the Volvo DRIVE concept are described here, among other things. Select between the following headings:

- **Start/Stop**  
Here there is information about the Start/Stop function.
- **Eco driving guide**

<sup>1</sup> Depending on car model.

<sup>2</sup> Applies to the V60 Plug-in Hybrid.

<sup>3</sup> Applies to the S60, V60, XC60, S80 and V70/XC70.



Available here are tips, advice and a description of the meaning of economical driving.

## Hybrid<sup>2</sup>

### MY CAR → Hybrid

Available here is information on the car's drive systems. Select between the following headings:

- **Power flow**

The screen shows whether the motor or engine is driving the car and how the motive force is flowing.

- **Driving modes**

The car's different drive modes are explained.

- **Eco driving guide**

Available here are tips, advice and a description of the meaning of economical driving.

## Trip statistics<sup>2</sup>

### MY CAR → Trip statistics

The screen shows the history as a bar chart with average consumption of electricity and fuel.

## Driver support system

### MY CAR → Support systems

The screen shows a summary of the current status of the car's driver support systems.

## Settings

### MY CAR → Settings

The menus are structured as follows:

#### Menu level 1

#### Menu level 2

Menu level 3

Menu level 4

Shown here are the 4 first menu levels under **Settings**. Certain functions are standard, others are optional - the range also varies depending on the market.

When selecting whether a function should be activated/**On** or deactivated/**Off** a square is displayed:

**On**: Selected square.

**Off**: Empty square.

- Select **On/Off** with **OK** - then back out of the menu with **EXIT**.

## Menus

- **Car settings**, see MY CAR - Car settings (p. 14)
- **Driver support systems**, see MY CAR - driving support system (p. 15)
- **System options**, see MY CAR - System options (p. 16)
- **Voice settings**, see MY CAR - Voice settings (p. 17)
- **Audio settings**, see Audio and media - operating the system (p. 22)
- **Climate settings**, see MY CAR - Climate settings (p. 19)
- **Favourites (FAV)** - link a normally used function in MY CAR to **FAV** button, see Favourites (p. 27)
- **Volvo On Call**, described in a separate manual.
- **Information**, see MY CAR Information (p. 19)

## Related information

- MY CAR (p. 11)
- MY CAR - search paths (p. 12)

<sup>2</sup> Applies to the V60 Plug-in Hybrid.



## MY CAR - Car settings

Car settings menu option in the MY CAR menu source handles many of the car's functions, e.g. Car key memory and Lock settings for doors.

### Car settings

#### Car key memory

- On
- Off

#### Lock settings

- Automatic door locking
  - On
  - Off

- Doors unlock
  - All doors
  - Driver door, then all

- Keyless entry
  - All doors
  - Any door
  - Doors on same side
  - Both front doors

### Reduced Guard

- Activate once
- Ask when exiting

### Side mirror settings

- Fold mirrors
- Tilt left mirror
- Tilt right mirror

### Light settings

- Door lock confirmation light
  - On
  - Off

- Unlock confirmation light
  - On
  - Off

- Approach light duration
  - Off
  - 30 sec
  - 60 sec
  - 90 sec

- Home safe light duration
  - Off
  - 30 sec
  - 60 sec
  - 90 sec

- Triple indicator
  - On
  - Off

- Temporary LH traffic
  - On
  - Off

or

- Temporary RH traffic
  - On
  - Off

- Active bending lights
  - On
  - Off





Auxiliary lights

On

Off

### Tyre pressure system

Warns if tyre pressure is too low

Calibrate tyre pressure

### Steering wheel force

Low

Medium

High

### Reset car settings

All menus in **Car settings** are given original factory settings.

### Related information

- MY CAR (p. 11)
- MY CAR - driving support system (p. 15)
- MY CAR - System options (p. 16)
- MY CAR - Voice settings (p. 17)
- Audio and media - general audio settings (p. 29)
- MY CAR - Climate settings (p. 19)
- MY CAR Information (p. 19)

## MY CAR - driving support system

*Driving support systems menu option in the MY CAR menu source handles functions such as e.g. Collision warning system and Lane keeping aid.*

### Driver support systems

#### Collision Warning

On

Off

Warning distance

Long

Normal

Short

Warning sound

On

Off

#### Lane Departure Warning

Lane Departure Warning

On

Off

On at start-up

On

Off

Increased sensitivity

On

Off

### Lane Keeping Aid

Lane Keeping Aid

On

Off

Assistance alternatives

Full function

Vibration only

Steering assist only

### Road Sign Information

On

Off



## Speed alert

- On
- Off

## DSTC

- On
- Off

## City Safety

- On
- Off

## BLIS

- On
- Off

## Distance Alert

- On
- Off

## Driver Alert

- On
- Off

### Related information

- MY CAR (p. 11)
- MY CAR - Car settings (p. 14)

- MY CAR - System options (p. 16)
- MY CAR - Voice settings (p. 17)
- Audio and media - general audio settings (p. 29)
- MY CAR - Climate settings (p. 19)
- MY CAR Information (p. 19)

## MY CAR - System options

The system settings menu option in the MY CAR menu source handles functions such as e.g. time and languages.

### System options

#### Time

The combined instrument panel's clock is adjusted here.

#### Time format

- 12 h
- 24 h

#### Screen saver

- On
- Off

The display screen's current content fades out after a period of inactivity and is replaced by a blank screen if this option is selected.

The current screen content returns if any of the display screen's buttons or controls are actuated.

#### Language

Selects language for menu texts.



### Show help text

- On
- Off

Explanatory text for the display screen's current content is shown with this option selected.

### Distance and fuel units

- MPG (UK)
- MPG (US)
- km/l
- l/100km

### Temperature unit

- Celsius
- Fahrenheit

Selects the unit for the display of outside temperature and setting of the climate control system.

### Volume levels

- Voice output volume
- Front park assist volume
- Rear park assist volume
- Phone ringing volume

**(Voice output volume:** Only with Volvo's navigation system\* installed.)

### Reset system options

All menus in **System options** are given original factory settings.

### Related information

- MY CAR (p. 11)
- MY CAR - Car settings (p. 14)
- MY CAR - driving support system (p. 15)
- MY CAR - Voice settings (p. 17)
- Audio and media - general audio settings (p. 29)
- MY CAR - Climate settings (p. 19)
- MY CAR Information (p. 19)

## MY CAR - Voice settings

*The voice settings menu option in the MY CAR menu source manages functions such as voice tutorial and command list for voice recognition.*

### Voice settings

#### Voice tutorial

Spoken information is given here about how the system works.



## Voice command list

### Phone commands

- Phone
- Phone call contact
- Phone dial number

### Navigation commands

- Navigation
- Navigation repeat instruction
- Navigation go to address

### General commands

- Help
- Cancel
- Voice tutorial

The menu options under **Phone commands** show several examples of available voice commands - only with a Bluetooth®-enabled mobile phone installed. For more and detailed information - see Bluetooth®\* handsfree phone - overview (p. 59).

The menu options under **Navigation commands** show several examples of available voice commands - only with Volvo's navigation system\* installed.

## Voice user setting

### Default setting

- User 1
- User 2

Here there is the option to create a second user profile - an advantage if more than one person shall use the car/system regularly. **Default setting** gives factory settings.

## Voice training

- User 1
- User 2

With **Voice training** the voice recognition system is taught to recognise the driver's voice and pronunciation. A number of phrases are presented on the screen for the driver to read aloud. When the system has learnt how the driver talks, the presentation of the phrases stops. Following which e.g. **User 1** can be selected in **Voice user setting** in order that the system shall listen to the right user.

## Voice output volume

A volume control appears on the screen - at which point, proceed as follows:

1. Adjust the volume with the thumb-wheel.
2. Test-listen using **OK**.
3. Use **EXIT** to store the setting and the menu is switched off.

## Voice POI list

### Edit list

The number of facilities is extensive and varies depending on market. Maximum 30 favourite facilities can be stored in this list.

Menu option **Voice POI list** is only shown if Volvo's navigation system\* is installed. For more information on Facilities and Voice recognition, see the separate supplement.

## Related information

- MY CAR (p. 11)
- MY CAR - Car settings (p. 14)
- MY CAR - driving support system (p. 15)
- MY CAR - System options (p. 16)
- Audio and media - general audio settings (p. 29)
- MY CAR - Climate settings (p. 19)
- MY CAR Information (p. 19)



## MY CAR - Climate settings

Climate settings menu option in the MY CAR menu source handles functions such as e.g. fan adjustment and recirculation.

Climate settings
<b>Automatic blower adjustment</b>
Normal
High
Low
<b>Recirculation timer</b>
On
Off
<b>Automatic rear defroster</b>
On
Off
<b>Auto start steering wheel heater</b>
On
Off
<b>Auto start driver seat heater</b>
On
Off

## Interior air quality system

- On
- Off

## Reset climate settings

All menus in **Climate settings** are given original factory settings.

## Related information

- MY CAR (p. 11)
- MY CAR - Car settings (p. 14)
- MY CAR - driving support system (p. 15)
- MY CAR - System options (p. 16)
- MY CAR - Voice settings (p. 17)
- Audio and media - general audio settings (p. 29)
- MY CAR Information (p. 19)

## MY CAR Information

Information menu option in the MY CAR menu source handles functions such as Number of keys and VIN number.

Information
<b>Number of keys</b>
<b>VIN number</b>
<b>DivX® VOD code</b>
<b>Bluetooth software version in car</b>
<b>Map and software version</b>
Only in cars with Volvo's navigation system* - see separate supplement.

## Related information

- MY CAR (p. 11)
- MY CAR - Car settings (p. 14)
- MY CAR - driving support system (p. 15)
- MY CAR - System options (p. 16)
- MY CAR - Voice settings (p. 17)
- Audio and media - general audio settings (p. 29)
- MY CAR - Climate settings (p. 19)

# 03



## AUDIO AND MEDIA





## Audio and media

The audio and media system consists of radio (p. 31), media player (p. 43), TV (p. 72)\* as well as the option to communicate with mobile phone (p. 58)\*. Information is presented on a 5 or 7-inch screen\* in the upper section of the centre console. Functions can be controlled via buttons in the steering wheel, in the centre console below the screen or via a remote control (p. 76)\*. In some cases a mobile phone can also be controlled with voice recognition (p. 67).

If the audio and media system is active when the engine is switched off then it is automatically activated the next time the key is inserted into key position **I** or higher, and it continues with the same source (e.g. radio) as before the engine was switched off (the driver's door must be closed on cars with Keyless systems\*).

The audio and media system can be used for 15 minutes at a time without the remote control key being in the ignition switch by pressing the On/Off button.

When the car is being started the audio and media system is switched off temporarily and continues when the engine has started.

### NOTE

Remove the remote control key from the ignition switch if the infotainment system is used when the engine is switched off. This is to avoid discharging the battery unnecessarily.

### Dolby Digital, Dolby Pro Logic<sup>1</sup>



Made under license from Dolby Laboratories. Dolby Digital, Dolby Pro Logic and the double-D symbol are trademarks of Dolby Laboratories.

### Audyssey MultEQ<sup>1</sup>

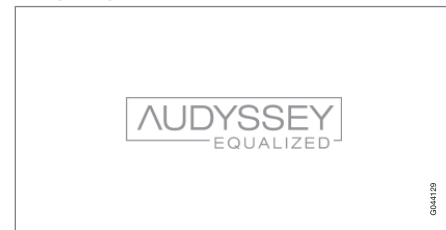

The Audyssey MultEQ system has been used in the development and tuning of the sound to ensure a world-class sound experience.

### Related information

- Audio and media - overview (p. 22)
- Audio and media - operating the system (p. 22)
- Audio and media - menu navigation (p. 25)
- Audio and media - menu overview (p. 87)
- Audio and media - audio settings (p. 28)
- Picture settings (p. 48)
- Favourites (p. 27)

<sup>1</sup> Only applies to Premium Sound Multimedia.



### Audio and media - overview

Overview of the audio and media system's different parts.

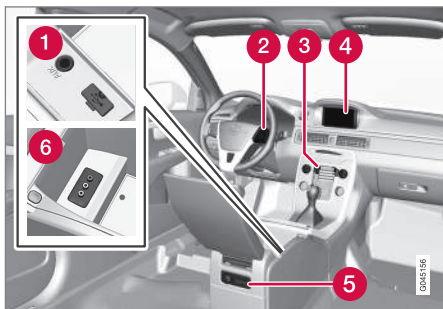

- 1 AUX<sup>3</sup> and USB<sup>4</sup> inputs for external audio sources (p. 49) (e.g. iPod®).
- 2 Steering wheel keypad\*.
- 3 Centre console control panel.
- 4 Display screen. The display screen is available in two sizes: 5 and 7-inch. The manual shows a 7-inch display screen.
- 5 Rear control panel (p. 27) with headphones socket\*.
- 6 A/V-AUX input\*.

<sup>3</sup> Applicable to Performance only

<sup>4</sup> Not applicable to Performance

### Related information

- Audio and media (p. 21)
- Audio and media - operating the system (p. 22)

### Audio and media - operating the system

The audio and media system is controlled from the centre console and partly from the steering wheel buttons. The information is presented on the screen in the upper section of the centre console.



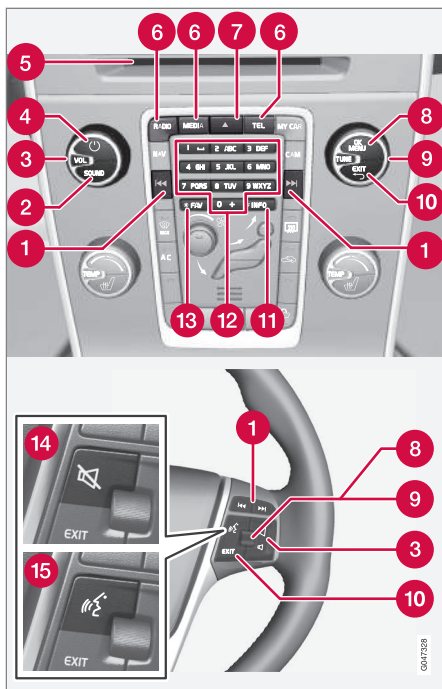

**1 Scroll/fast wind/search** - Short press scrolls between disc tracks, preset radio stations<sup>5</sup> or chapter<sup>6</sup>. A long press fast-winds

disc tracks or searches for the next available radio station.

**2 SOUND** - press for access to audio settings (bass, treble, etc.). For more information, see general audio settings (p. 29) .

**3 VOL** - raise or lower the volume.

**4 ON/OFF/MUTE** - short press starts the system and long press (until the screen is off) switches off. Note that the whole of the Sensus system (including navigation \* and phone functions\*) starts/switches off at the same time. Briefly press to mute the sound (MUTE) or restore the sound if it had been switched off.

**5** Disc insert and eject slot.

**6 Main sources** - press to select the main source (e.g. **RADIO**, **MEDIA**). Last active source is shown (e.g. **FM1**). If you are in **RADIO** or **MEDIA** and press the main source button, a source view is shown. If you are in **TEL\*** or **NAV\*** and press the main source button then a shortcut menu is shown with commonly used menu options.

**7** Disc eject.

**8 OK/MENU** - press the thumbwheel in the steering wheel or the button in the centre console to accept selections in menus. If you

are in the normal view and press **OK/MENU** a menu is shown for the selected source (e.g. **RADIO** or **MEDIA**). Arrow to the right of the screen is shown when there are underlying menus.

**9 TUNE** - turn the thumbwheel in the steering wheel or the knob in the centre console to scroll between disc tracks/folders, radio and TV\* stations, phone contacts\* or navigate between the options on the display screen.

**10 EXIT** - short press leads upwards in the menu system, interrupts current function, interrupts/rejects phone calls or erases entered characters. A long press leads to the normal view or, if already in the normal view, to the highest menu level (main source view). From there you can reach the same main source buttons as those on the centre console (6).

**11 INFO** - If more information than can be shown on the screen is available, press the **INFO** button to see the remaining information.

**12** Preset buttons, input of numbers and letters.

**13 FAV** – shortcut to a favourite setting. The button can be programmed for a commonly

<sup>5</sup> Does not apply to DAB.

<sup>6</sup> Only applies to DVD discs.



## 03 Audio and media



used function (e.g. FM, AUX). For more information, see favourites (p. 27).

**14 MUTE**<sup>7</sup> – press to switch off the radio/media audio or restore the audio if it has been switched off.

**15 Voice recognition**<sup>8</sup> – press to activate voice recognition (for Bluetooth®-connected mobile phone and navigation system\*).

### Related information

- Audio and media - menu navigation (p. 25)
- Audio and media (p. 21)

---

<sup>7</sup> Cars without navigation.

<sup>8</sup> Cars with navigation\*.



### Audio and media - menu navigation

The audio and media system is controlled from the centre console and partly from the

steering wheel buttons. The information is presented on the screen in the upper section of the centre console.

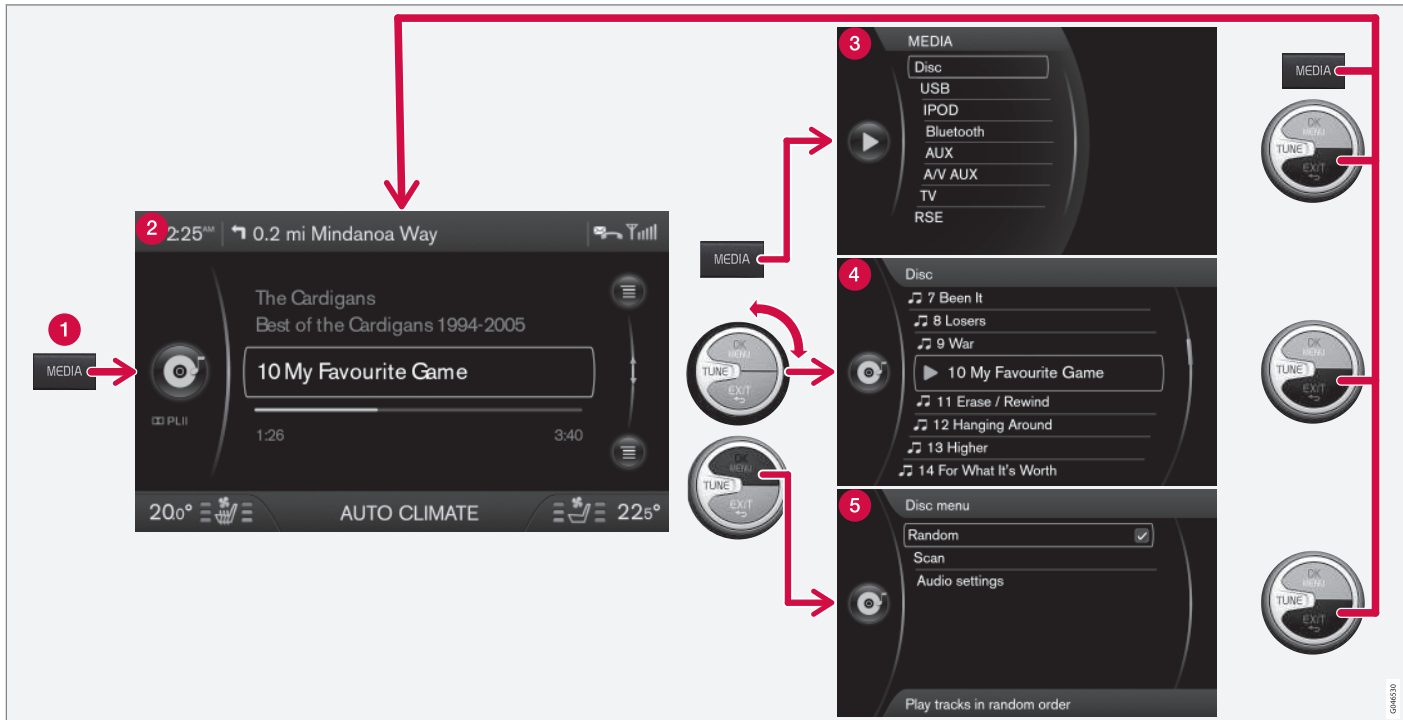

The example shows navigation to different functions when a disc is played back. (1) Main source button, (2) Normal view, (3) Shortcut/Source menu, (4) Quick menu, (5) Source menu.



## 03 Audio and media



Select main source by pressing a main source button (1) (**RADIO**, **MEDIA**, **TEL**). To navigate through the source menus, use the controls **TUNE**, **OK/MENU**, **EXIT** or the main source button (1).

For available functions, see Audio and media - menu overview (p. 87).

### NOTE

If the car is equipped with a steering wheel keypad with a thumbwheel\*, these can be used instead of the controls in the centre console (**TUNE**, **OK/MENU**, **EXIT**), see Audio and media - operating the system (p. 22).

### Menus and views in the display screen

The appearance depends on the source, equipment in the car, settings, etc.

- 1 Main source button** - press to switch the main source or to show the Shortcut/Source menu in the active source.
- 2 Normal view** - normal mode for the source.
- 3 Shortcut/Source menu** - shows commonly used menu options in the main sources, e.g. **TEL** and **MEDIA** (accessed by pressing the active source's main source button (1)).

**4 Quick menu** - fast mode when **TUNE** is turned, e.g. for changing disc tracks, radio station, etc.

**5 Source menu** - for menu navigation (accessed by pressing **OK/MENU**).

### Related information

- Audio and media - operating the system (p. 22)
- Audio and media - menu overview (p. 87)



### Rear control panel with headphones socket\*

It is possible to plug in headphones and listen to separate media, which is selected using the control rear panel.

Headphones with an impedance of 16-32 ohm and sensitivity of 102 dB or higher are recommended for best sound reproduction.

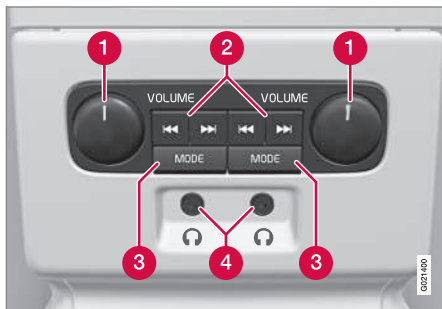

- 1 **VOLUME** – Volume, left and right.
- 2 Scroll/search forward and backward.
- 3 **MODE** - Select between **AM**, **FM1**, **FM2**, **DAB1\***, **DAB2\***, **Disc**, **USB\***, **iPod\***, **Bluetooth\***, **AUX**, **TV\*** and On/Off. Read about connection via AUX or USB\* (p. 50) ® or via Bluetooth (p. 54).
- 4 Headphones sockets (3.5 mm).

### Activate/deactivate

The control panel is activated with **MODE**. Deactivation is possible via a long press on **MODE** or when the engine is switched off.

### Scroll/search forward and backward

Pressing (2) scrolls between disc tracks/audio files or seeks the next available radio station.

### Limitations

The audio source (t.ex. **FM1**, **AM**, **Disc**) being played back through the speakers cannot be controlled from the rear control panel.

In order that an audio source can be selected with **MODE** and listened to it is required that the audio source is available and connected in the car.

### Related information

- Audio and media (p. 21)
- Audio and media - operating the system (p. 22)

### Favourites

Save (p. 28) frequently used functions as favourites. Possible functions that can be saved are within radio, media, reversing camera and menu source **MY CAR** where many of the car's functions are handled, e.g. setting the clock, door mirrors and locks. The function is then accessed easily by pressing the **FAV** button.

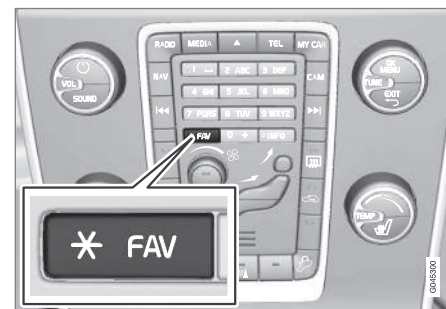

The **FAV** button can be used to save functions that are used frequently so that the function can be started simply by pressing **FAV**. You can select a favourite (e.g. **Equalizer**) for each function in accordance with the following:

In **RADIO** mode:

\* Option/accessory, for more information, see Introduction.



- AM<sup>9</sup>
- FM1/FM2
- DAB1\*/DAB2\*

In **MEDIA** mode:

- DISC
- USB\*
- iPod\*
- Bluetooth\*
- AUX
- TV\*

It is also possible to select and save a favourite for **MY CAR**, **CAM**\* and **NAV**\*. Favourites can also be selected and saved under **MY CAR**.

### Related information

- Audio and media (p. 21)
- MY CAR (p. 11)

### Save as favourite

Save frequently used functions as favourites (p. 27). The function can then be started easily by pressing the **FAV** button (p. 22).

To save a function as a favourite:

1. Select a main source (e.g. **RADIO**, **MEDIA**).
2. Select a wavelength or source (**FM1**, **Disc**, etc.).
3. Press and hold the **FAV** button until the "favourites menu" is shown.
4. Turn **TUNE** to select an option from the list and press **OK/MENU** to save.
  - > When the main source (e.g. **RADIO**, **MEDIA**) is active the saved function is available via a short press on **FAV**.

### Related information

- Audio and media (p. 21)
- MY CAR - Car settings (p. 14)

### Audio and media - audio settings

The audio system is pre-calibrated for optimal sound reproduction, but can be adapted to your needs.

### Setting for optimal sound reproduction

The audio system is pre-calibrated for optimum sound reproduction by means of digital signal processing.

This calibration takes into account loudspeakers, amplifiers, passenger compartment acoustics, listener position etc. for each combination of car model and audio system.

There is also a dynamic calibration that takes into account the position of the volume control, radio reception and vehicle speed.

The controls explained in these operating instructions, e.g. **Bass**, **Treble** and **Equalizer**, are only intended for the user to be able to adapt the sound reproduction according to personal taste.

### Active noise reduction<sup>10</sup>

The car is equipped with an active noise reduction function that suppresses engine noise in the passenger compartment via the audio system. Microphones in the car's roof detect disruptive noise and the audio system sends out anti-noise in order to dampen the noise.

<sup>9</sup> Does not apply to the V60 PLUG-IN HYBRID.

<sup>10</sup> Applies to certain engines.

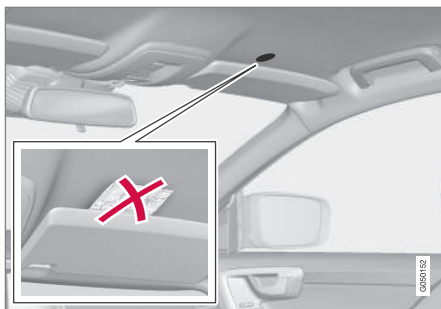

Microphones in the car's roof - location and quantity may vary depending on car model.

#### **i** NOTE

Do not cover the car's microphone; otherwise a rumbling sound from the audio system may be produced.

#### Related information

- Audio and media - general audio settings (p. 29)
- Audio and media - advanced audio settings (p. 30)
- Setting the audio profile (p. 30)

### Audio and media - general audio settings

General audio settings for the audio and media system.

Press the **SOUND** button (p. 22) to access the audio settings menu (**Bass**, **Treble**, etc.). Scroll forward with **SOUND** or **OK/MENU** to your selection (e.g. **Treble**).

Adjust the setting by turning **TUNE** and save the setting with **OK/MENU**.

Continue pressing **SOUND** or **OK/MENU** to access other options:

- **Surround**<sup>11</sup> - Can be set to the On/Off position. When On is selected, the system selects the setting for optimal sound reproduction. Normally **DPLII** and **DPLII** then appear in the display screen. If the recording is made with Dolby Digital technology then playback will take place with this setting, **DIGITAL** then appears in the display screen. When Off is selected, 3-channel stereo is available.
- **Bass** - Bass level.
- **Treble** - Treble level.
- **Fader** - Balance between the front and rear speakers.
- **Balance** - Balance between the left and right-hand speakers.

- **Subwoofer**<sup>\*11</sup> - Bass speaker level.
- **DPL II centre level**<sup>3</sup> channel centre level<sup>11</sup> - Volume for centre speaker.
- **DPL II surround level**<sup>11, 12</sup> - Level for surround.

#### Related information

- Audio and media - operating the system (p. 22)
- Audio and media - menu navigation (p. 25)
- Audio and media - audio settings (p. 28)
- Audio and media - advanced audio settings (p. 30)

<sup>11</sup> Only Premium Sound Multimedia.

<sup>12</sup> Only when Surround is activated.



### Audio and media - advanced audio settings

Adapt the audio settings for radio and media according to your wishes.

The following functions can be adapted:

- Setting the equaliser (p. 30)
- Setting the audio profile (p. 30)
- Setting the audio volume and automatic volume control (p. 31)
- Setting the audio volume for external audio source (p. 52)

#### Related information

- Audio and media - audio settings (p. 28)
- Audio and media - general audio settings (p. 29)

### Setting the equaliser

Set the equaliser<sup>13</sup> and adjust the volume separately for different radio frequencies or TV.

1. Press **OK/MENU** to access **Audio settings** and select **Equalizer**.
2. Select wavelength by turning **TUNE** and confirm with **OK/MENU**.
3. Adjust the audio settings by turning **TUNE** and confirm with **OK/MENU**. Continue in the same way with other wavelengths you want to change.
4. When you have finished with audio settings, press **EXIT** to confirm and return to normal view.

#### Related information

- Audio and media - advanced audio settings (p. 30)
- Audio and media - operating the system (p. 22)
- Audio and media - menu navigation (p. 25)

### Setting the audio profile

Set the audio profile<sup>14</sup> and optimise your audio experience in accordance with your needs.

The sound experience can be optimised for the driver's seat, both front seats or the rear seat. If there are passengers in both the front and rear seats then the option recommended is; both front seats. The options can be selected under **Audio settings** → **Sound stage**.

#### Related information

- Audio and media - audio settings (p. 28)
- Audio and media - operating the system (p. 22)
- Audio and media - menu navigation (p. 25)

<sup>13</sup> Not applicable to Performance

<sup>14</sup> Only Premium Sound Multimedia.





### Setting the audio volume and automatic volume control

Set the audio compensation for excessive noise in the passenger compartment.

The audio system compensates for disrupting noises in the passenger compartment by increasing the volume in relation to the speed of the car. The compensation level can be set to low, medium, high or off. Select the level under **Audio settings** → **Volume compensation**.

#### Related information

- Audio and media - advanced audio settings (p. 30)
- Audio and media - operating the system (p. 22)
- Audio and media - menu navigation (p. 25)

### Radio

It is possible to listen to the AM<sup>15</sup> and FM radio frequencies, and in certain cases also digital radio (DAB) (p. 40)\*.



Controls for radio functions.

For operating the radio, see Operating the system (p. 22) and Menu navigation (p. 25).

#### AM<sup>16</sup>/FM radio

- Radio tuning (p. 32)
- Radio stations as presets (p. 34)
- Scan radio frequencies (p. 39)
- RDS functions (p. 35)
- Radio programme types (PTY) (p. 37)
- Radio text (p. 38)

#### Digital radio\* (DAB)

- Digital radio\* (DAB) (p. 40)
- Storing channel groups (Ensemble learn) (p. 41)
- Navigation in channel group list (Ensemble) (p. 41)
- Radio stations as presets (p. 34)
- Scan radio frequencies (p. 39)
- Radio programme types (PTY) (p. 37)
- Radio text (p. 38)
- DAB to DAB link (p. 41)
- Digital radio\* (DAB) - wavelength (p. 42)
- Digital radio\* (DAB) - subchannel (p. 42)
- Digital radio\* (DAB) - resetting (p. 42)

#### Related information

- Audio and media - menu overview (p. 87)

<sup>15</sup> Does not apply to the V60 PLUG-IN HYBRID.

<sup>16</sup> Does not apply to the V60 PLUG-IN HYBRID.



### Radio tuning

The radio automatically compiles a radio station list (p. 32)<sup>17</sup> of the strongest radio stations whose signals it is currently receiving. It is possible to activate automatic (p. 32)- or manual (p. 33) radio tuning.

#### NOTE



The reception is dependent both on how good the signal strength and signal quality are. The transmission may be disturbed by various factors such as tall buildings or the transmitter being far away. Coverage level can also vary depending on where in the country you are located.

### Related information

- Radio (p. 31)

### Automatic radio tuning

Searches for the next/previous available station.

1. Press **RADIO**, turn **TUNE** until the desired wavelength (e.g. **FM1**) is shown, press **OK/MENU**.
2. Hold in  /  in the centre console (or in the steering wheel keypad\*). The radio searches for the next/previous available station.

### Related information

- Radio tuning (p. 32)
- Manual radio tuning (p. 33)

### Radio station list

The radio automatically compiles a radio station list<sup>18</sup> of the strongest radio stations whose signals it is currently receiving. This enables you to find a station when you drive into an area where you do not know the radio stations and their frequencies.

To go to the list and select a station:

1. Select the desired wavelength (e.g. **FM1**).
2. Turn **TUNE** one step in either direction. This displays the list of all stations in the area. The currently tuned station is indicated with enlarged text in the list.
3. Turn **TUNE** again in either direction to select a station from the list.
4. Confirm your choice by pressing **OK/MENU**.

<sup>17</sup> Does not apply to Performance.

<sup>18</sup> Does not apply to Performance.

**i NOTE**

- The list only shows the frequencies of stations that are currently being received, **not** a complete list of all radio frequencies on the selected wavelength.
- If the signal from the currently received station is weak, this may prevent the radio from updating the station list. If this occurs, press the **INFO** button (while the station list is shown in the display screen) in order to change to manual tuning and set a frequency. If the station list is no longer shown, turn **TUNE** one step in either direction to show the list again, and press **INFO** to switch.

The list disappears from the display screen after a few seconds.

If the station list is no longer shown, turn **TUNE** one step in either direction and press the **INFO** button in the centre console to change to manual tuning (p. 33) (or to return from manual tuning to the function for Station list).

**Related information**

- Radio tuning (p. 32)

**Manual radio tuning**

*The radio automatically compiles a radio station list (p. 32)<sup>19</sup>, but it is possible to perform radio tuning manually.*

The preset from the factory is that the radio shows the station list of the strongest stations in the area when you turn **TUNE**. When the radio station list is shown, press the **INFO** button in the centre console to change to manual tuning. This allows you to select a frequency from the list of all available radio frequencies in the selected wavelength. In other words, if turn **TUNE** one step in a manual search the frequency is changed from e.g. 93.3 to 93.4 MHz, etc.

To manually select a station:

1. Press the **RADIO** button, turn **TUNE** until the desired wavelength (e.g. **FM1**) is shown, press **OK/MENU**.
2. Turn **TUNE** to select a frequency.

**i NOTE**

The preset from the factory is that the radio automatically searches for the stations in the area where you are driving (see section "Radio station list").

But if you have changed over to manual tuning (by pressing the **INFO** button in the centre console when the station list was shown), then the radio remains set in the function for manual tuning the next time you switch on the radio. To change back to the function for "Radio station list", turn **TUNE** one step (to show the complete list of stations) and press the button **INFO**.

Note that if you press **INFO** when the station list is not shown then **INFO** is activated. For more information on this function, see Audio and media - operating the system (p. 22).

**Related information**

- Radio tuning (p. 32)
- Automatic radio tuning (p. 32)

<sup>19</sup> Does not apply to Performance.



## Radio stations as presets

Frequently used radio stations are optimally saved as presets in order to facilitate simple activation.



Station presets.

## AM/FM radio

10 presets can be stored per wavelength (e.g. FM1).

The stored presets are selected using the preset buttons.

1. Tune into a station, see Radio tuning (p. 32).
2. Hold in one of the preset buttons for a few seconds, the sound disappears during this time and returns when the station is stored. The preset button can now be used.

A list of pre-selected channels can be shown in the display screen<sup>20</sup>. The function is activated/deactivated in AM/FM mode under **AM menu** → **Show presets** or **FM menu** → **Show presets**.

## FM radio

10 presets can be stored per wavelength (e.g. FM1).

The stored presets are selected using the preset buttons.

1. Tune into a station, see Radio tuning (p. 32).
2. Hold in one of the preset buttons for a few seconds, the sound disappears during this time and returns when the station is stored. The preset button can now be used.

A list of pre-selected channels can be shown in the display screen<sup>20</sup>. The function is activated/deactivated in FM mode under **FM menu** → **Show presets**.

## Digital radio\* (DAB)

10 station presets can be stored per wavelength. DAB has 2 memories for presets: **DAB1** and **DAB2**. Storage of presets is performed by means of a long press on the desired preset button, for more information

see FM radio above. The stored presets are selected using the preset buttons.

A preset contains one channel but no sub-channels. If a subchannel is being played and a preset is saved then only the main channel is registered. This is because subchannels are temporary. At the next attempt to retrieve the preset, the channel which contained the subchannel will be played. The preset is not dependent on the channel list.

A list of pre-selected channels can be shown in the display screen<sup>20</sup>. The function is activated/deactivated in DAB mode under **DAB menu** → **Show presets**.



## NOTE

The audio system's DAB system does not support all functions in the DAB standard.

## Related information

- Radio tuning (p. 32)
- Audio and media - menu navigation (p. 25)

<sup>20</sup> Only applies to High Performance Multimedia and Premium Sound Multimedia.



## RDS functions

With RDS the radio can automatically change to the strongest transmitter. RDS provides the facility to receive e.g. traffic information (TP) and to search for certain programme types (PTY).

RDS (Radio Data System) links FM transmitters into a network. An FM transmitter in such a network sends information that gives an RDS radio the following functions:

- Automatically switches to a stronger transmitter if reception in the area is poor.
- Searches for programme type, such as traffic information or news.
- Receives text information on current radio programme.

### NOTE

Some radio stations do not use RDS or only selected parts of its functionality.

If a required programme type is located the radio can switch stations interrupting the audio source currently in use. For example, if the CD player is in use, it is paused. The interrupting transmission is played back at a preset volume (p. 38). The radio returns to the previous audio source and volume when the set programme type is no longer broadcast.

The programme functions alarm (**ALARM!**), traffic information (TP), news (**NEWS**), and programme types (PTY) interrupt one another in order of priority, where alarm has the highest priority and programme types has the lowest. For additional programme interruption settings (**EON Distant** and **EON Local**), see EON (p. 36). Press **EXIT** to return to the interrupted audio source, press **OK/MENU** to clear the message.

## Related information

- Alarms in the event of accidents and disasters (p. 35)
- Traffic information (TP) (p. 36)
- Enhanced Other Networks (EON) (p. 36)
- News broadcasts (p. 36)
- Radio programme types (PTY) (p. 37)
- Radio text (p. 38)
- Automatic radio frequency update (AF) (p. 39)
- Regional radio programmes (REG) (p. 39)
- Resetting RDS functions (p. 40)

## Alarms in the event of accidents and disasters

The radio function is used to warn of serious accidents and catastrophes. The message **ALARM!** appears on the display screen when an alarm message is transmitted.

The alarm cannot be temporarily interrupted or deactivated.

## Related information

- RDS functions (p. 35)



### Traffic information (TP)

This function allows traffic information that is broadcast within a set radio station's RDS network to break through.

The symbol **TP** shows that the function is activated. If the preset station can send traffic information then this is shown by **TP** glowing brightly in the display screen, otherwise **TP** will be grey.

- Activate/deactivate in FM mode under **FM menu** → **TP**.

#### TP from selected station/all stations

The radio can only interrupt for traffic information from the selected station or all stations within the RDS network.

- Go in FM mode to **FM menu** → **Advanced settings** → **Set TP favourite** to change.

#### Related information

- RDS functions (p. 35)

### Enhanced Other Networks (EON)

*EON is useful in urban areas with many regional radio stations. It allows the distance between the car and the radio station transmitter to determine when programme functions should interrupt the current audio source.*

- Activate/deactivate in FM mode by selecting one of the options under **FM menu** → **Advanced settings** → **EON**:
- **Local** – interrupts only if the radio station transmitter is close.
- **Distant**<sup>21</sup> – interrupts if the station transmitter is far away, even if there is a lot of static.

#### Related information

- RDS functions (p. 35)

### News broadcasts

This function allows news broadcasts within a set radio station's RDS network to break through.

The symbol **NEWS** shows that the function is active.

- Activate/deactivate in FM mode under **FM menu** → **News settings** → **News**.

#### News from selected station/all stations

The radio can only interrupt for news from the selected station or all stations in the RDS network.

- Go in FM mode to **FM menu** → **News settings** → **Set news favourite** to change.

#### Related information

- RDS functions (p. 35)

<sup>21</sup> Factory settings.



### Radio programme types (PTY)

The PTY function can be used to select one or more radio programme types, such as *Pop Music* and *Serious Classical Music*. After selecting a programme type, navigation only takes place within the channels that are broadcasting that type.

PTY can be selected for FM and DAB radio. The PTY symbol is shown in the screen when the function is active. This function allows programme types broadcast within a set station's RDS network to break through.

#### PTY for FM radio

1. Activate in FM mode by first selecting the programme types under **FM menu** → **Advanced settings** → **PTY settings** → **Select PTY**.
2. Then the PTY function must be activated under **FM menu** → **Advanced settings** → **PTY settings** → **Receive traffic bulletins from other networks**.

Deactivation of the PTY function is performed in FM mode under **FM menu** → **Advanced settings** → **PTY settings** → **Receive traffic bulletins from other networks**. Selected programme types (PTY) are not reset.

Resetting and removing PTY are performed under **FM menu** → **Advanced settings** → **PTY settings** → **Select PTY** → **Clear all**.

#### PTY for DAB radio

Programme type is selected in DAB mode under **DAB menu** → **PTY filtering**. Exit this mode as follows:

- Press **EXIT**.
  - > An indicator is shown in the display screen when PTY is activated.

In some cases DAB radio will exit PTY mode, see DAB to DAB link (p. 41).

#### Related information

- Searching radio programme types (PTY) (p. 37)
- Show radio programme types (PTY) (p. 38)
- Volume control for interrupting radio programme types (PTY) (p. 38)
- RDS functions (p. 35)

### Searching radio programme types (PTY)

This function searches the whole frequency band for the selected radio programme type.

1. In FM mode select one or more PTY under **FM menu** → **Advanced settings** → **PTY settings** → **Select PTY**.
2. Go to **FM menu** → **Advanced settings** → **PTY settings** → **Seek PTY**.

To finish searching, press **EXIT**.

- To continue searching for another broadcast of the selected programme types, press on **◀◀** or **▶▶**.

#### Related information

- Radio programme types (PTY) (p. 37)
- Show radio programme types (PTY) (p. 38)
- RDS functions (p. 35)



### Show radio programme types (PTY)

Some radio stations broadcast information about programme type and programme category. The current station's radio programme type, e.g. *Pop Music and Serious Classical Music*, can be shown in the screen. PTY can be selected for FM and DAB radio.

#### Show radio programme type for FM radio

- Activate/deactivate in FM mode under **FM menu** → **Advanced settings** → **PTY settings** → **Show PTY text**.

#### Show radio programme type for DAB radio

Activate/deactivate in DAB mode under **DAB menu** → **Advanced settings** → **Show PTY text**.

#### Related information

- Radio programme types (PTY) (p. 37)
- Searching radio programme types (PTY) (p. 37)
- RDS functions (p. 35)

### Volume control for interrupting radio programme types (PTY)

The interrupting programme types, e.g. **NEWS** or **TP**, are heard at the volume selected for each respective programme type. If the volume level is adjusted during the programme interruption, the new level is saved until the next programme interruption.

#### Related information

- Radio programme types (PTY) (p. 37)
- RDS functions (p. 35)

### Radio text

Some RDS stations transmit information on programme content, artists, etc. This information may be shown on the display screen<sup>22</sup>. Radio text can be shown for FM and DAB radio.

#### Radio text for FM radio

- Activate/deactivate in FM mode under **FM menu** → **Show radio text**.

#### Radio text for DAB radio

Activate/deactivate in DAB mode under **DAB menu** → **Show radio text**.



#### NOTE

Only one of the functions "**Show radio text**" and "**Show presets**" can be activated at a time. If one of them is activated when the other is already activated, then the previously activated function is deactivated automatically. Both functions can be deactivated.

#### Related information

- RDS functions (p. 35)
- Digital radio\* (DAB) (p. 40)

<sup>22</sup> Only cars with 7-inch screen





### Automatic radio frequency update (AF)

The function selects the strongest transmitter for the set radio station.

In order to find a strong transmitter the function may, in exceptional cases, need to search the entire FM wavelength.

- Activate/deactivate in FM mode under **FM menu** → **Advanced settings** → **Alternative frequency**.

#### Related information

- RDS functions (p. 35)

### Regional radio programmes (REG)

This function causes the radio to continue with a regional radio transmitter even if its signal strength is low.

The symbol **REG** shows that the function is active.

- Activate/deactivate in FM mode under **FM menu** → **Advanced settings** → **REG**.

#### Related information

- RDS functions (p. 35)

### Scan radio frequencies

The function automatically searches for available radio channels and takes into account any programme type filtering (PTY).

When a station is found, it is played for approx. 10 seconds before scanning is resumed. When a station is playing back it is saved as a preset in the usual way, see Radio stations as presets (p. 34).

- To start scanning go in FM/DAB\* mode to **FM menu** → **Scan** or **DAB menu** → **Scan**.
- To start scanning go in FM/AM/DAB\* mode to **FM menu** → **Scan**, **AM menu** → **Scan** or **DAB menu** → **Scan**.



#### NOTE

Scanning stops if a station is saved.

Scanning can also be selected in DAB-PTY mode. In which case only channels of the pre-selected programme type are played.

#### Related information

- Radio programme types (PTY) (p. 37)
- Digital radio\* (DAB) (p. 40)



### Resetting RDS functions

All radio settings can be reset to the original factory settings.

- The reset is carried out in FM mode under **FM menu** → **Advanced settings** → **Reset all FM settings**.

### Related information

- RDS functions (p. 35)

### Digital radio\* (DAB)

DAB (Digital Audio Broadcasting) is a digital broadcasting system for radio. The car supports DAB, DAB+ and DMB.

#### NOTE

Coverage for DAB is not available in all locations. If there is no coverage then the message **No reception** is shown in the display screen.

### Service and Ensemble

- **Service** - Channel, radio channel (only audio services are supported by the system).
- **Ensemble** - A collection of radio channels on the same frequency.

### Related information

- Storing channel groups (Ensemble learn) (p. 41)
- Navigation in channel group list (Ensemble) (p. 41)
- Radio (p. 31)
- Radio stations as presets (p. 34)
- Scan radio frequencies (p. 39)
- Radio programme types (PTY) (p. 37)
- Radio text (p. 38)
- DAB to DAB link (p. 41)
- Digital radio\* (DAB) - wavelength (p. 42)
- Digital radio\* (DAB) - subchannel (p. 42)

- Digital radio\* (DAB) - resetting (p. 42)



### Storing channel groups (Ensemble learn)

*Storage of channel groups (Ensemble learn) for digital radio (DAB).*

When the vehicle is moved to a new broadcasting area, programming of existing channel groups in the area may be necessary.

Programming of channel groups creates an updated list of all available channel groups. The list is not updated automatically.

Programming is carried out in the menu system in DAB mode under **DAB menu** → **Ensemble learn**. Programming can also take place as follows:

1. Turn **TUNE** one step in either direction.
  - > **Ensemble learn** is shown in the list of available channel groups.
2. Press **OK/MENU**.
  - > New programming is started.

Programming can be cancelled with **EXIT**.

### Related information

- Digital radio\* (DAB) (p. 40)
- Navigation in channel group list (Ensemble) (p. 41)

### Navigation in channel group list (Ensemble)

*Navigation in the channel group list (Ensemble) for digital radio (DAB).*

To navigate in and access the channel group list turn **TUNE**. The name of the Ensemble is shown in the upper part of the display screen. When switching to the new Ensemble the name changes to the new one.

- **Service** - Shows channels irrespective of the channel group to which they are allocated. The list can also be filtered using the selection of programme type (**PTY filtering**), see Radio programme types (PTY) (p. 37).

### Related information

- Storing channel groups (Ensemble learn) (p. 41)
- Digital radio\* (DAB) (p. 40)
- Radio programme types (PTY) (p. 37)

### DAB to DAB link

*DAB to DAB linking means that the DAB radio can go from one channel with poor or no reception to the same channel in another channel group with better reception.*

There may be a certain delay when changing channel group. There may be a period of silence between the current channel no longer being available to the new channel becoming available.

The function can be activated/deactivated in DAB mode under **DAB menu** → **Advanced settings** → **DAB linking**.

### Related information

- Digital radio\* (DAB) (p. 40)



### Digital radio\* (DAB) - wavelength

DAB can be transmitted on two wavelengths<sup>23</sup>.

- **Band III** - covers most areas.
- **LBand** - available only in a few areas.

By selecting for example **Band III** on its own, channel programming takes place more quickly than if both **Band III** and **LBand** have been selected. It is not certain that all channel groups will be found. Wavelength selection does not affect the stored memories.

Wavelengths can be deactivated/activated in DAB mode under **DAB menu** → **Advanced settings** → **DAB band**.

#### Related information

- Digital radio\* (DAB) (p. 40)

### Digital radio\* (DAB) - subchannel

Secondary components are usually named subchannels. These are temporary and can contain e.g. translations of the main programme into other languages.

If one or more subchannels are broadcast then the √ symbol is shown to the left of the channel name in the display screen. A subchannel is indicated by the - symbol appearing to the left of the channel name in the display screen.

Press  to access the subchannels.

Subchannels can only be accessed on the selected main channel and not on any other channel without selecting it.

Display of subchannels can be deactivated/activated in **DAB** mode under **DAB menu** → **Advanced settings** → **Sub channels**

#### Related information

- Digital radio\* (DAB) (p. 40)

### Digital radio\* (DAB) - resetting

All DAB settings can be reset to the original factory settings.

- The reset is carried out in DAB mode under **DAB menu** → **Advanced settings** → **Reset all DAB settings**.

#### Related information

- Digital radio\* (DAB) (p. 40)

<sup>23</sup> Not all areas/countries use both wavelengths.



## Media player

The media player can playback audio and video from CD/DVD\* discs and externally connected audio sources via the AUX/USB\* input, or wirelessly stream audio files from external devices via Bluetooth®. Certain media players can show TV\* and have the option to communicate with a mobile phone\* via Bluetooth®.



Controls for the media player.

For operating the media player, see Operating the system (p. 22) and Menu navigation (p. 25).

## Related information

- Audio and media (p. 21)
- Media Bluetooth®\* (p. 53)
- Voice recognition\* control of a mobile phone (p. 67)
- Remote control\* (p. 76)

- Media player - compatible file formats (p. 49)

## CD/DVD\*

Media player (p. 43) can playback pre-recorded and burned CD/DVD<sup>24</sup> discs.

The media player supports and can play the following main types of discs and files:

- Pre-recorded CD discs (CD Audio).
- Burned CD discs with audio and/or video files<sup>24</sup>.
- Pre-recorded DVD video discs<sup>24</sup>.
- Burned DVD discs<sup>24</sup> with audio and/or video files.

For more information about the supported formats, see compatible file formats (p. 49).

## Related information

- Audio and media - operating the system (p. 22)
- Playback and navigation of CD/DVD\* disc (p. 44)
- Playback and navigation of DVD video discs (p. 47)



## 03 Audio and media

### Playback and navigation of CD/DVD\* disc

For basic playback and navigation, see *Operating the system* (p. 22). See below for a more detailed description.

### Starting playback of a disc

Press the **MEDIA** button, turn **TUNE** until **Disc** is displayed, press **OK/MENU**. If there is a disc in the media player then the disc starts playing back automatically, otherwise **Insert disc** is shown in the display screen. Then insert a disc, with text side up. The disc starts to play back automatically.

If a disc with audio/video files is inserted into the player then the disc's folder structure needs to be loaded. Depending on the quality of the disc and the quantity of information there may be a certain delay before playback starts.

### Disc eject

Press the eject button (p. 22) to eject the disc.

A disc remains in the ejected position for about 12 seconds, after which it is inserted back into the player for safety reasons.

### Pause in playback (pause)

When the volume is reduced entirely or MUTE is pressed, the media player is paused. When the volume is increased or MUTE is pressed again, the media player starts. It is also possible to pause via the menu system<sup>25</sup>, press **OK/MENU**, select **Play/Pause**.

#### NOTE

A video film is only shown when the car is stationary. When the car is moving at a speed of over about 8 km/h no picture is shown and **No visual media available while driving** appears on the display screen, although the audio is heard during this time. The picture is shown again as soon as the car's speed falls below about 6 km/h.

#### NOTE

Some audio files that are copy-protected by record companies or privately copied audio files cannot be loaded by the player.

### Related information

- Audio and media - operating the system (p. 22)
- Playback and navigation of burned discs with audio/video files (p. 45)

- Playback and navigation of DVD video discs (p. 47)
- Fast forward/reverse (p. 46)
- Scan disc track or audio file (p. 46)
- Random selection of disc track or audio file (p. 46)
- Media player - compatible file formats (p. 49)

<sup>24</sup> Only applies to High Performance Multimedia and Premium Sound Multimedia.

<sup>25</sup> Does not apply to CD Audio



## Playback and navigation of burned discs with audio/video files



Playback and navigation of burned discs with audio/video files<sup>26</sup>.

### NOTE

A video film is only shown when the car is stationary. When the car is moving at a speed of over about 8 km/h no picture is shown and **No visual media available while driving** appears on the display screen, although the audio is heard during this time. The picture is shown again as soon as the car's speed falls below about 6 km/h.

### NOTE

Some audio files that are copy-protected by record companies or privately copied audio files cannot be loaded by the player.

Audio files have the symbol , video files<sup>26</sup> have the symbol  and folders have the symbol .

When playback of a file is complete the playback of the other files (of the same type) in that particular folder continues. Change<sup>27</sup> of folder takes place automatically when all the files in the current folder have been played back. The system automatically detects and

changes setting when a disc containing only audio files or only video files is loaded into the media player and then plays back these files. However, the system does not change setting if a disc containing a mixture of audio and video files is loaded into the media player, but instead the player continues to play back the previous file type.

### Repeat folder

This function makes it possible to play files in a folder over and over again. When the last file has been played out, playback of the first file starts again.

1. Press **OK/MENU**
2. Turn **TUNE** to **Repeat folder**
3. Press **OK/MENU** to activate/deactivate the function.

### Related information

- Audio and media - operating the system (p. 22)
- Playback and navigation of CD/DVD\* disc (p. 44)
- Playback and navigation of DVD video discs (p. 47)
- Fast forward/reverse (p. 46)
- Scan disc track or audio file (p. 46)
- Random selection of disc track or audio file (p. 46)

- Media player - compatible file formats (p. 49)
- DivX® Video On Demand (p. 48)



<sup>26</sup> Only applies to High Performance Multimedia and Premium Sound Multimedia.



<sup>27</sup> If Repeat folder is activated then this does not take place.



### Fast forward/reverse

It is possible to fast forward/rewind audio and video files.<sup>28</sup>

Hold the button for  /  depressed in order to fast forward/rewind audio or video files forward/backward.

Audio files are fast forwarded/rewound at one speed, while video files can be fast forwarded/rewound at several speeds. Repeatedly press the buttons  /  to increase the fast forward/rewind speed for video files. Release the button to return to viewing at normal speed.

### Related information

- Audio and media - operating the system (p. 22)
- Playback and navigation of CD/DVD\* disc (p. 44)
- Playback and navigation of external audio source (p. 51)

### Scan disc track or audio file

This function plays back the first ten seconds of each disc track/audio file.<sup>29</sup>

To scan selected source:

1. Press **OK/MENU**
2. Turn **TUNE** to **Scan**
  - > The first 10 seconds of each disc track or audio file are played.
3. Cancel the scan with **EXIT**, the disc track or audio file being played back will continue playing.

### Related information

- Audio and media - operating the system (p. 22)
- Playback and navigation of CD/DVD\* disc (p. 44)
- Playback and navigation of external audio source (p. 51)
- Media Bluetooth®\* (p. 53)

### Random selection of disc track or audio file

This function plays the tracks/audio files in random order<sup>30</sup>.

To listen to the tracks/audio files in random order for the selected source:

1. Press **OK/MENU**
2. Turn **TUNE** to **Random**
3. Press **OK/MENU** to activate/deactivate the function.

### Related information

- Audio and media - operating the system (p. 22)
- Playback and navigation of CD/DVD\* disc (p. 44)
- Playback and navigation of external audio source (p. 51)
- Media Bluetooth®\* (p. 53)

<sup>28</sup> Only applies to CD/DVD\* discs, USB and iPod®.

<sup>29</sup> Does not apply to DVD video discs. For externally connected audio sources via the AUX/USB input this only applies to USB and iPod®. Not supported by all mobile phones.

<sup>30</sup> Does not apply to DVD video discs. For externally connected audio sources via the AUX/USB input this only applies to USB and iPod®. Not supported by all mobile phones.





## Playback and navigation of DVD video discs

When playing back a DVD video disc<sup>31</sup> a disc menu may appear on the display screen. The disc menu gives access to additional functions and settings, such as selecting subtitles, language and scene selection.

For basic playback and navigation, see *Operating the system* (p. 22). See below for a more detailed description.

### **i** NOTE

A video film is only shown when the car is stationary. When the car is moving at a speed of over about 8 km/h no picture is shown and **No visual media available while driving** appears on the display screen, although the audio is heard during this time. The picture is shown again as soon as the car's speed falls below about 6 km/h.

## Navigation in the DVD video disc's menu

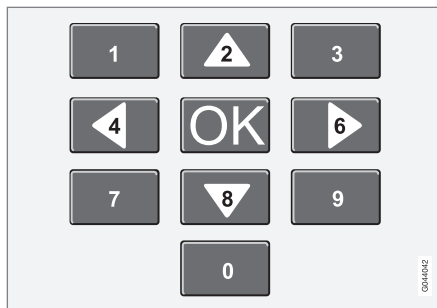

Navigation in the DVD video disc's menu is performed using the number keys in the centre console as illustrated above.

### Changing chapter or title

Turn **TUNE** to access the list of chapters and navigate through them (if the film is being played back then it is paused). Press **OK/MENU** to select the chapter, this also leads back to the original position (if the film was being played back then it is restarted). Press **EXIT** to access the title list.

Titles are selected in the title list by turning **TUNE** and the selection is confirmed with **OK/MENU**, this also leads back to the chapter list. Press **OK/MENU** to activate the selection and return to the start position. Use

**EXIT** to cancel the selection and this leads back to the original position (without any selection being made).

The chapter can also be changed by pressing on **◀◀** / **▶▶** on the centre console or the steering wheel keypad\*.

### Related information

- Audio and media - operating the system (p. 22)
- Playback and navigation of CD/DVD\* disc (p. 44)
- Camera angle for playback of DVD video discs (p. 48)
- Playback and navigation of burned discs with audio/video files (p. 45)
- Fast forward/reverse (p. 46)
- Scan disc track or audio file (p. 46)
- Random selection of disc track or audio file (p. 46)
- Media player - compatible file formats (p. 49)

<sup>31</sup> Only applies to High Performance Multimedia and Premium Sound Multimedia.



### Camera angle for playback of DVD video discs

If the DVD video disc supports it, the function can be used to choose from which camera position a particular scene should be shown<sup>32</sup>.

Go in disc mode to **Disc menu** → **Advanced settings** → **Angle**.

#### Related information

- Audio and media - operating the system (p. 22)
- Playback and navigation of DVD video discs (p. 47)

### DivX® Video On Demand

The media player can be registered to play back files of the type DivX® VOD<sup>33</sup> from CD-/DVD discs, USB or iPod®.

The code for registration can be found in the menu system **MY CAR**, see MY CAR (p. 11).

For more information visit [www.divx.com/vod](http://www.divx.com/vod).

#### Related information

- Audio and media - operating the system (p. 22)
- Playback and navigation of DVD video discs (p. 47)
- Playback and navigation of burned discs with audio/video files (p. 45)
- Playback and navigation of external audio source (p. 51)

### Picture settings<sup>34</sup>

You can adjust the display settings (when the car is stationary) for brightness and contrast.

1. Press **OK/MENU** and select **Image settings**, confirm with **OK/MENU**.
2. Turn **TUNE** to the adjustment option and confirm with **OK/MENU**.
3. Adjust the setting by turning **TUNE** and confirm with **OK/MENU**.

To return to the settings list, press the **OK/MENU** or **EXIT**.

The picture settings can be reset to factory settings with the **Reset** option.

#### Related information

- Audio and media - operating the system (p. 22)
- Audio and media (p. 21)

<sup>32</sup> Applies to High Performance Multimedia and Premium Sound Multimedia.

<sup>33</sup> Applies to High Performance Multimedia and Premium Sound Multimedia.

<sup>34</sup> Applies to High Performance Multimedia and Premium Sound Multimedia.



## Media player - compatible file formats

The media player can play back a variety of file types and is compatible with the formats in the following tables.

### Compatible file formats for CD/DVD\* discs

NOTE	
Dual format, double-sided discs (DVD Plus, CD-DVD format) are thicker than regular CD discs and therefore playback cannot be guaranteed and malfunction may arise.	
If a CD contains a mixture of MP3 and CDDA tracks, all MP3s will be ignored.	

Audio format <sup>A</sup>	CD audio, mp3, wma
Audio format <sup>B</sup>	CD audio, mp3, wma, aac, m4a
Video format <sup>C</sup>	CD video, DVD video, divx, avi, asf

<sup>A</sup> Applies to Performance.

<sup>B</sup> Does not apply to Performance.

<sup>C</sup> Only applies to High Performance Multimedia and Premium Sound Multimedia.

### Compatible file formats via USB connection

Audio and video files in the following table are supported by the system for playback via the USB connection.

Audio format	mp3, wma, aac, m4a
Video format <sup>A</sup>	divx, avi, asf

<sup>A</sup> Only applies to High Performance Multimedia and Premium Sound Multimedia.

### Related information

- Playback and navigation of CD/DVD\* disc (p. 44)
- Playback and navigation of DVD video discs (p. 47)
- Playback and navigation of burned discs with audio/video files (p. 45)
- Playback and navigation of external audio source (p. 51)

### External audio source via AUX/USB\* input

An external audio source, e.g. an iPod® or MP3 player, can be connected (p. 50) to the audio system.



An audio source connected to the USB input can be operated<sup>35</sup> using the car's audio controls. A device connected via the AUX input cannot be controlled via the car.

There is a recess in the right-hand rear edge of the tunnel console where cables can be routed so that the hatch can be closed without cables being pinched.

An iPod® or MP3 player with rechargeable batteries is recharged (when the ignition is on or the engine is running) if the device is plugged into the USB connection.

<sup>35</sup> Only applies to the media source connected via the USB connection.



## 03 Audio and media



### USB memory

To facilitate the use of a USB memory stick, only store music files on it. It takes a lot longer for the system to load storage media that contains anything other than compatible music files.

#### **i** NOTE

The system supports mobile media compliant with USB 2.0 and the FAT32 file system and can handle 1000 folders with a maximum of 254 subfolders/files in every folder. The top level, which can handle up to 1000 subfolders/files, is an exception to this.

#### **i** NOTE

When using a longer model USB memory stick the use of a USB adapter cable is recommended. This is to avoid mechanical wear to the USB input and the connected USB memory stick.

### USB hub

It is possible to connect a USB hub to the USB connection and thereby connect multiple USB devices simultaneously. Selection of USB device is made in **USB** mode under **USB menu** → **Select USB device**.

### MP3 player

Many MP3 players have their own file systems that are not supported by the audio sys-

tem. For use in the system, an MP3 player must be set in **USB Removable device/ Mass Storage Device** mode.

### iPod®

An iPod® is charged and supplied with power by the USB connection\* via the player's connection cable.

#### **i** NOTE

The system only supports the playback of audio files from iPod®.

#### **i** NOTE

When an iPod® is used as audio source, the car's infotainment system has a menu structure that is similar to the iPod® player's own menu structure.

### Related information

- Audio and media - operating the system (p. 22)
- Playback and navigation of external audio source (p. 51)
- Setting the audio volume for external audio source (p. 52)

### Connecting an external audio source via AUX/USB\* input

An external audio source, e.g. an iPod® or MP3 player, can be connected to the audio system via any of the connections in the centre console.



Connection points for external audio sources.

To connect the audio source:

1. Press **MEDIA**, turn **TUNE** to the required audio source **USB**, **iPod** or **AUX**, press **OK/MENU**.
  - > If USB is selected then **Connect USB** is shown in the display screen.
2. Connect your audio source to one of the connections in the centre console's storage compartment (see previous illustration).



The text **Reading USB** is shown in the display screen when the system is loading the storage media's file structure. Depending on the file structure and number of files there may be some delay before loading is finished.

#### NOTE

The system supports most iPod® models produced in 2005 or later.

#### NOTE

To prevent damage to the USB connection, this is shut off if the USB connection is short-circuited or if a connected USB unit is taking too much power (this may happen if the unit connected does not meet the USB standard). The USB connection is reactivated automatically the next time the ignition is turned on, unless the fault persists.



#### Related information

- External audio source via AUX/USB\* input (p. 49)
- Playback and navigation of external audio source (p. 51)

### Playback and navigation of external audio source

*Playback and navigation of external audio source*<sup>36</sup>.

*For basic playback and navigation, see Operating the system (p. 22). See below for a more detailed description.*

Audio files have the symbol , video files<sup>37</sup> have the symbol  and folders have the symbol .

When playback of a file is complete the playback of the other files (of the same type) in that particular folder continues. Change<sup>38</sup> of folder takes place automatically when all the files in the current folder have been played back. The system automatically detects and changes setting when a device containing only audio files or only video files is connected to the USB port and then it plays back these files. However, the system does not change setting if a device containing a mixture of audio and video files is connected to the USB port, but instead the player continues to play back the previous file type.

### Search function<sup>36</sup>

The keypad on the control panel in the centre console can be used to find a filename in the current folder.

The search function is accessed either by turning **TUNE** (to access the folder structure) or by pressing one of the letter keys. As a letter or character in a search string is entered you get closer to your search target.

Start playback of a file by pressing **OK/MENU**.

### Repeat folder<sup>39</sup>

This function makes it possible to play files in a folder over and over again. When the last file has been played out, playback of the first file starts again.

1. Press **OK/MENU**
2. Turn **TUNE** to **Repeat folder**
3. Press **OK/MENU** to activate/deactivate the function.

### Pause

When the volume is reduced entirely or **MUTE** is pressed, the media player is paused. When the volume is increased or **MUTE** is pressed again, the media player starts. It is also possi-

<sup>36</sup> Only applies to USB and iPod®.

<sup>37</sup> Applies to High Performance Multimedia and Premium Sound Multimedia.

<sup>38</sup> If Repeat folder is activated then this does not take place.

<sup>39</sup> Only applies to USB.



## 03 Audio and media



ble to pause via the menu system<sup>40</sup>, press **OK/MENU**, select **Play/Pause**.

### Related information

- Connecting an external audio source via AUX/USB\* input (p. 50)
- External audio source via AUX/USB\* input (p. 49)
- Fast forward/reverse (p. 46)
- Scan disc track or audio file (p. 46)
- Random selection of disc track or audio file (p. 46)
- Media player - compatible file formats (p. 49)
- DivX® Video On Demand (p. 48)

### Setting the audio volume for external audio source

*Set the volume for an external audio source (p. 49). If the volume is too high or too low then the quality of the sound may deteriorate.*

If an external audio source (e.g. an MP3 player or iPod®) is connected to the AUX input then the audio source that is connected can have a different volume than the audio system's internal volume (e.g. radio). Correct this by adjusting the volume of the input:

1. Press the **MEDIA** button and turn **TUNE** to **AUX** and wait a few seconds or press **OK/MENU**.
2. Press **OK/MENU** and then turn **TUNE** to **AUX input volume**. Confirm with **OK/MENU**.
3. Turn **TUNE** to adjust the volume for the AUX input.

### Related information

- Audio and media - advanced audio settings (p. 30)
- Audio and media - operating the system (p. 22)
- Audio and media - menu navigation (p. 25)



### NOTE

If the external audio source's volume is too high or too low, the quality of the sound may deteriorate. The audio quality may also be impaired if the player is charged while the infotainment system is in AUX mode. In which case, avoid charging the player via the 12 V socket.

<sup>40</sup> Does not apply to iPod®



## Media Bluetooth®\*

The car's media player is equipped with Bluetooth®<sup>41</sup> and can wirelessly play streaming audio files from external devices with Bluetooth®, such as mobile phones and PDAs.



Media Bluetooth® functions, controls overview.

The device must first be registered and connected to the car (p. 54).

Navigation and control of the audio can be carried out via the centre console buttons or via the steering wheel keypad\*. In some external devices it is also possible to change tracks from the device.

To play back the audio the car's media player must first be set in **Bluetooth** mode.

When a mobile phone is connected to the car, it is also possible to remotely control a selection of the mobile phone's functions, see Bluetooth® handsfree phone (p. 58). Switch between the main sources **TEL** and **MEDIA** to operate each one's functions.

### **i** NOTE

The Bluetooth® media player must support the Audio/Video Remote Control Profile (AVRCP) and Advanced Audio Distribution Profile (A2DP). The player should use AVRCP version 1.3, A2DP 1.2. Otherwise some functions may not work.

Not all mobile phones and external media players available in the market are fully compatible with the Bluetooth® function in the car's media player. Volvo recommends that you contact an authorised Volvo dealer for information on compatible phones and external media players.

### **i** NOTE

The car's media player can only play the audio files via the Bluetooth® function.

### Related information

- Audio and media - operating the system (p. 22)
- Connecting and disconnecting a Bluetooth®\* device (p. 54)

- Scan disc track or audio file (p. 46)
- Random selection of disc track or audio file (p. 46)

<sup>41</sup> Applies to High Performance, High Performance Multimedia and Premium Sound Multimedia.



### Connecting and disconnecting a Bluetooth®\* device

The car is equipped with Bluetooth®<sup>42</sup> and can wirelessly communicate with other Bluetooth® devices after registration and connection (p. 54).

A maximum of ten Bluetooth® devices can be registered. Registration is performed once per device. After registration the device no longer needs to be activated as visible/searchable.

When the Bluetooth® function is active and the last device connected is in range it is connected automatically to the car. When the car searches for the last device connected its name is shown in the display screen. To connect to another device, press **EXIT** and select change device (p. 56).

When the Bluetooth® device is out of range of the car it is automatically disconnected. It is also possible to manually disconnect (p. 57) a device. If you want to deregister a Bluetooth® device from the car, select Removing a Bluetooth®\* device (p. 57). The car will then not locate the device automatically.

It is possible to have two Bluetooth® devices connected simultaneously. One phone and one media device, which it is possible to switch between (p. 56). It is also possible to

call with the phone and simultaneously stream audio files.

### Related information

- Audio and media - operating the system (p. 22)
- Media Bluetooth®\* (p. 53)
- Bluetooth® handsfree phone (p. 58)

### Registering a Bluetooth®\* device

*It is possible to have two Bluetooth® devices connected simultaneously. One phone and one media device, which it is possible to switch between. It is also possible to call with the phone and simultaneously stream audio files.*

A maximum of ten Bluetooth® devices can be registered. Registration is performed once per device. After registration the device no longer needs to be activated as visible/searchable.



### NOTE

If the phone's operating system is updated then it is possible that the registration of the phone is interrupted. In which case, disconnect the phone, see Removing a Bluetooth®\* device (p. 57) and then reconnect it.

Connecting an external device takes place in different ways depending on whether or not the device has been connected previously. The connection options below presume that this is the first time the device is being connected (registered) and that no other device is connected. The connection options show the connection of a phone. Connecting a media device (p. 53) is performed in the same way,

<sup>42</sup> Applies to High Performance, High Performance Multimedia and Premium Sound Multimedia.





although it starts from the main source **MEDIA**.

There are two possible ways of connecting devices, either search for the external device from the car, or search for the car from the external device. If one option does not work then try with the other.

If you are not already in the normal view for the phone, press **TEL** in the centre console.

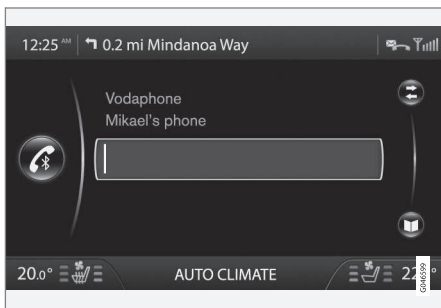

Example of normal view for phone.

### Alternative 1 - search for the external device via the car's menu system

1. Make the external device searchable/visible via Bluetooth®, see the external device's manual or [www.volvocars.com](http://www.volvocars.com).

2. Press **OK/MENU** and follow the instructions on the display screen.
  - > The external device is now connected to the car and can be controlled from the car.

If connection failed, press **EXIT** twice and connect the device as described under Alternative 2.

### Alternative 2 - Search for the car with the Bluetooth® function of the external device.

1. Make the car searchable/visible via Bluetooth®. Turn **TUNE** to **Phone settings**, confirm with **OK/MENU**, select **Discoverable** and confirm with **OK/MENU**.
2. Select **My Volvo Car** on the screen of the external device and follow the instructions.
3. Enter a PIN code in the external device and then select to connect.
4. Press **OK/MENU** and enter the same PIN code via the car keypad in the centre console.

Once the external device is connected, its Bluetooth® name appears on the car's display screen and the unit can be controlled from the car.

### Related information

- Audio and media - operating the system (p. 22)
- Connecting and disconnecting a Bluetooth®\* device (p. 54)



## Automatic connection of Bluetooth®\* device

When a Bluetooth® device is registered (p. 54) in the car the last external device connected is connected automatically when it is within range.

When the Bluetooth® function is active and the last device connected is in range it is connected automatically. When the car searches for the last device connected its name is shown in the display screen. If the last connected device is not available then the system will try to connect an earlier device.

To connect to another device, press **EXIT**, select to connect a new device (p. 54) or change to another already registered device (p. 56).

### Related information

- Audio and media - operating the system (p. 22)
- Connecting and disconnecting a Bluetooth®\* device (p. 54)

## Changing to another Bluetooth®\* device

It is possible to change from a connected device to another one if there are several devices in the car. The device must first have been registered (p. 54) to the car.

### Changing media device

1. Check that the external device is searchable/visible via Bluetooth®, see the manual for the external device.
2. Press **MEDIA**, select **Bluetooth** and then **Change device**.
  - > The car searches for previously connected devices. The external devices detected are specified with their respective Bluetooth® name in the display screen.
3. Select the device to be connected.
  - > Connection of the external device takes place.

### Changing phone

1. Check that the external device is searchable/visible via Bluetooth®, see the manual for the external device.

2. Press **TEL** and then select **Change phone**.
  - > The car searches for previously connected devices. The external devices detected are specified with their respective Bluetooth® name in the display screen.
3. Select the device to be connected.
  - > Connection of the external device takes place.

### Related information

- Audio and media - operating the system (p. 22)
- Connecting and disconnecting a Bluetooth®\* device (p. 54)



### Disconnecting the Bluetooth®\* device

When the Bluetooth® device is out of range of the car it is automatically disconnected. It is also possible to disconnect a phone manually.

When the mobile phone has been disconnected an ongoing call can be continued by using the mobile phone's built-in microphone and speaker.

The handsfree function is deactivated when the engine is switched off and the door is opened<sup>43</sup>.

If you want to deregister a Bluetooth® device from the car, select Removing a Bluetooth® device (p. (p. 57)). The car will then not locate the device automatically.

### Manual disconnection of phone

The phone can be manually disconnected in phone mode under **Phone menu** → **Disconnect phone**.



#### NOTE

Even when your mobile phone has been manually disconnected, some mobile phones may automatically couple up to the last handsfree unit connected, e.g. when a new call begins.

### Related information

- Audio and media - operating the system (p. 22)
- Connecting and disconnecting a Bluetooth® device (p. 54)
- Media Bluetooth® (p. 53)
- Bluetooth® handsfree phone (p. 58)

### Removing a Bluetooth®\* device

If you do not want a Bluetooth® device registered to the car any longer then it is possible to remove (deregister) it from the car. The car will then not locate the device automatically.

### Removing a media device

Press **MEDIA**, select **Bluetooth** → **Remove Bluetooth device**. Turn **TUNE** to select the device to be removed, confirm with **OK/MENU**.

### Removing a phone

Press **TEL**, select **Phone menu** → **Remove Bluetooth device**. Turn **TUNE** to select the device to be removed, confirm with **OK/MENU**.

### Related information

- Audio and media - operating the system (p. 22)
- Connecting and disconnecting a Bluetooth® device (p. 54)
- Media Bluetooth® (p. 53)
- Bluetooth® handsfree phone (p. 58)

<sup>43</sup> Only Keyless Drive.



## Bluetooth® version information

Show the car's current Bluetooth® version.

The car's current Bluetooth® version can be seen from the main sources **MEDIA** or **TEL**:

- **Bluetooth menu** → **Bluetooth software version** in car.
- **Phone menu** → **Phone settings** → **Bluetooth software version** in car.

## Related information

- Audio and media - operating the system (p. 22)
- Bluetooth® handsfree phone (p. 58)
- Media Bluetooth®\* (p. 53)

## Bluetooth® handsfree phone

A mobile phone equipped with Bluetooth® can be connected wirelessly to the car<sup>44</sup>.



Phone functions, controls overview.

The device must first be registered and connected to the car (p. 54).

The audio and media system acts as hands-free, with the facility to remotely control a selection of the mobile phone's functions. The mobile phone can be operated by its own keys irrespective of whether or not it is connected.

When a mobile phone is connected to the car, it is also possible to stream audio files from the phone or another Bluetooth®-connected media device, see Media Bluetooth®\* (p. 53). Switch between the main sources

**TEL** and **MEDIA** to operate each one's functions.

## NOTE

Only a selection of mobile phones are fully compatible with the handsfree function. Volvo recommends that you seek assistance from an authorised Volvo dealer for information on compatible phones.

## Activate

A short press on **TEL** activates/searches last connected phone. If a phone is already connected, and **TEL** is pressed, a shortcut menu is shown with commonly used menu options for the phone. The  symbol indicates that a phone is connected.

## To call

1. Make sure that the  symbol appears at the top of the display screen and that the handsfree function is in phone mode.
2. Dial either the desired number or the speed dial number (p. 65). Or in normal view turn **TUNE** to the right to access the phone book, and to the left for the call register for all calls. For information on the phone book, see Phone book (p. 61).
3. Press **OK/MENU**.

The call is interrupted with **EXIT**.

<sup>44</sup> Applies to High Performance, High Performance Multimedia and Premium Sound Multimedia.



### Related information

- Audio and media - operating the system (p. 22)
- Bluetooth® handsfree phone - overview (p. 59)
- Connecting and disconnecting a Bluetooth® device (p. 54)
- Making and receiving calls (p. 59)
- Bluetooth® handsfree phone - audio settings (p. 60)
- Bluetooth® version information (p. 58)

### Bluetooth® handsfree phone - overview

System overview for Bluetooth® handsfree phone.

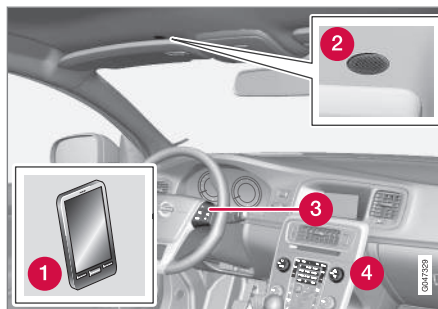

System overview

- 1 Mobile phone
- 2 Microphone
- 3 Steering wheel keypad
- 4 Control panel in centre console

### Related information

- Audio and media - operating the system (p. 22)
- Bluetooth® handsfree phone (p. 58)
- Connecting and disconnecting a Bluetooth® device (p. 54)

### Making and receiving calls

Functions for handling phone calls.

#### Incoming call

- Press **OK/MENU** to answer the call, even if the audio system is in e.g. **RADIO** or **MEDIA** mode.

Refuse or end with **EXIT**.

#### Automatic answer

The automatic answer function means that calls are accepted automatically.

- Activate/deactivate in phone mode under **Phone menu** → **Call options** → **Auto answer**.

#### In call menu

Press **OK/MENU** during an ongoing call to access the following functions:

- **Mute** - audio system microphone is muted.
- **Mobile phone** - the call is transferred from handsfree to the mobile phone. For some mobile phones the connection is interrupted. This is normal. The handsfree function asks if you want to reconnect.
- **Dial number** - option to call a third party using the number keys (current call set in standby).

#### Call lists

The call lists are copied to the handsfree function at each new connection and are then



updated during the connection. In normal view, turn to the left with **TUNE** to see the call register for **All calls** .

In phone mode it is possible to see all the call lists under **Phone menu** → **All calls**:

- **All calls**
- **Missed calls**
- **Answered calls**
- **Dialled calls**
- **Call duration**



### NOTE

Certain mobile phones show a list of the last dialled numbers in reverse order.

### Voice mailbox

In normal view a speed dial number for the voice mailbox can be programmed in and then accessed later via a long press on **1**.

Voice mailbox number is changed in phone mode under **Phone menu** → **Call options** →

**Vicemail number** → **Change number**. If there is no number stored then this menu can be reached with one long press on **1**.

### Related information

- Audio and media - operating the system (p. 22)
- Voice recognition\* control of a mobile phone - dialling a contact (p. 72)

- Voice recognition\* control of a mobile phone - dialling from the call register (p. 71)
- Voice recognition\* control of a mobile phone - calling the voice mailbox (p. 72)
- Bluetooth® handsfree phone (p. 58)
- Bluetooth® handsfree phone - audio settings (p. 60)
- Phone book (p. 61)

### Bluetooth® handsfree phone - audio settings

*It is possible to adjust the call volume, audio system volume and ring signal volume, and change the ring tone.*

### Phone call volume

The phone call volume can only be changed during a call. Use the steering wheel keypad\* or turn the **VOL** control.

### Audio system volume

Providing there is no ongoing call taking place, the audio system volume is controlled as usual by turning **VOL**.

If an audio source is active during an incoming call then it can be muted automatically. Activate/deactivate in phone mode under **Phone menu** → **Phone settings** → **Sounds and volume** → **Mute radio/media**.

### Ring volume

In phone mode go to **Phone menu** → **Phone settings** → **Sounds and volume** → **Ring volume** and adjust by turning **VOL**. Press **OK/MENU** to hear the audio volume. Press **EXIT** to save.

### Ring signals

The handsfree function has integrated ring signals that can be selected in phone mode under **Phone menu** → **Phone settings** →



Sounds and volume → Ring signals → Ring signal 1 etc.

### NOTE

For some mobile phones, the ringtone on the phone connected will not be switched off when one of the inbuilt signals for the handsfree system is used.

In order to select the connected phone's ring signal<sup>45</sup>, go in phone mode to **Phone menu** → **Phone settings** → **Sounds and volume** → **Ring signals** → **Mobile phone ring signal**.

### Related information

- Audio and media - operating the system (p. 22)
- Bluetooth® handsfree phone (p. 58)

### Phone book

*There are two phone books. These are combined in the car and are shown as a single phone book.*

- The car downloads the mobile phone's phone book and only displays this phone book when the mobile phone from which this phone book was downloaded is connected.
- The car also has a built-in phone book. This contains all the contacts stored in the car irrespective of which phone was connected when saving them. These contacts are visible for all users, regardless of the mobile phone that is connected to the car. If a contact is saved in the car then the symbol  is shown in front of the contact in the phone book.

### NOTE

Changes made from the car to a record in the mobile phone's telephone book will result in a new record in the car's telephone book, i.e. changes will not be saved to the phone. From the car, this will now look like you have double records, with different icons. Note also that when a short-cut number is saved or a change to a contact is made, this will result in a new record in the car's phone book.

All use of the phone book requires that the  symbol appears at the top of the display screen and that the handsfree function is in phone mode.

The audio and media system stores a copy of each registered mobile phone's phone book. The phone book can be copied automatically to the audio and media system during each connection.

- Activate/deactivate the function in phone mode under **Phone menu** → **Phone settings** → **Download phone book**.

If the phone book contains a ringing caller's contact information then this is shown in the display screen.

### Related information

- Audio and media - operating the system (p. 22)
- Bluetooth® handsfree phone (p. 58)
- Phone book - quick search for contacts (p. 62)
- Phone book - character table keypad in centre console (p. 63)
- Phone book - searching for contacts (p. 63)
- Phone book - new contact (p. 64)
- Phone book - speed dial numbers (p. 65)

<sup>45</sup> Not supported by all mobile phones.



- Phone book - receiving a vCard (p. 66)
- Phone book - memory status (p. 66)
- Phone book - clearing (p. 66)

### Phone book - quick search for contacts

*In normal view turn **TUNE** to the right to show a list of contacts.*

Turn **TUNE** to select and press **OK/MENU** to call.

Under the name of the contact is the phone number that is selected by default. If the symbol > appears to the right of the contact then there are several phone numbers stored for the contact. Press **OK/MENU** to show the numbers. Change and dial a number other than that selected by default by turning **TUNE**. Press **OK/MENU** to dial.

Search in the list of contacts by using the centre console's keypad to key in the start of the contact's name. For the function of the buttons, see Phone book - character table keypad in centre console (p. 63).

The list of contacts can also be accessed from normal view by pressing and holding the button on the centre console's keypad with the letter that the contact searched for starts with. For example, a long press on the button for **6** gives instant access to that part of the list where the contacts with the letter **M** are located.

### Related information

- Audio and media - operating the system (p. 22)
- Bluetooth® handsfree phone (p. 58)

- Phone book (p. 61)





### Phone book - character table keypad in centre console

Character table of possible characters for use in the phone book.

Key	Function
1	Space . , - ? @ : ; / ( ) 1
2 ABC	A B C Ä Å Æ À Ç 2
3 DEF	D E F È É 3
4 GHI	G H I Ì 4
5 JKL	J K L 5
6 MNO	M N O Ö Ø Ñ Ò 6
7 PQRS	P Q R S 7
8 TUV	T U V Ü Û 8
9 WXYZ	W X Y Z 9
* FAV	Shift between upper and lower case letter.

Key	Function
0 +	+ 0 p w
# INFO	# *

#### Related information

- Audio and media - operating the system (p. 22)
- Bluetooth® handsfree phone (p. 58)
- Phone book (p. 61)

### Phone book - searching for contacts

Searching for contacts in the phone book (p. 61).

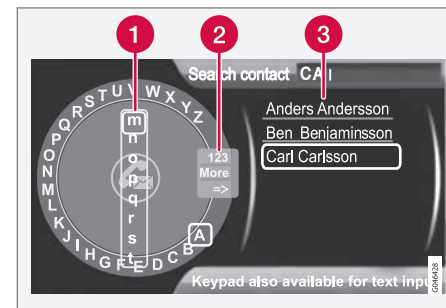

Search contacts using the text wheel.

- 1 Character list
- 2 Changing the input mode (see following table)
- 3 Phone book

To search for or edit a contact, go in phone mode to **Phone menu** → **Phone book** → **Search**.

#### **i** NOTE

There is no text wheel for High Performance, so **TUNE** cannot be used there to input characters: only the digit and letter buttons on the control panel in the centre console can be used for this.



## 03 Audio and media



1. Turn<sup>46</sup> **TUNE** to the desired letter, press **OK/MENU** to confirm. The number and letter buttons on the control panel in the centre console can also be used.
2. Continue with the next letter and so on. The result of the search is shown in the phone book (3).
3. To change the input mode to numbers or special characters, or to go to the phone book, turn **TUNE** to one of the options (see explanation in the table below) in the list for changing the input mode (2), press **OK/MENU**.

03

<b>123/ABC</b>	Change between letters and numbers with <b>OK/MENU</b> .
<b>More</b>	Change to special characters with <b>OK/MENU</b> .
<b>=&gt;</b>	Leads to the phone book (3). Turn <b>TUNE</b> to select a contact, press <b>OK/MENU</b> to see the saved numbers and other information.

A short press on **EXIT** deletes an input character. A long press on **EXIT** will clear all entered characters.

By pressing a number key in the centre console when the text wheel is shown (see previ-

ous illustration), a new character list (1) is shown in the screen. Continue repeatedly pressing the number key to the desired letter and then release. Continue with the next letter and so on. When a button is depressed the entry is confirmed when another button is depressed.

To enter a number, hold in the corresponding number key.

### Related information

- Audio and media - operating the system (p. 22)
- Bluetooth<sup>®</sup> handsfree phone (p. 58)

### Phone book - new contact

Create new contact in the phone book.

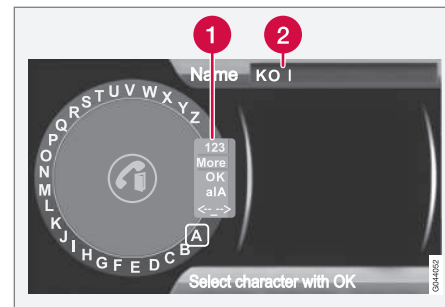

Entering letters for New contact.

- 1 Changing the input mode (see following table)
- 2 Input field

New contacts can be added in phone mode under **Phone menu** → **Phone book** → **New contact**.



### NOTE

There is no text wheel for High Performance, so **TUNE** cannot be used there to input characters: only the digit and letter buttons on the control panel in the centre console can be used for this.

<sup>46</sup> Only applies to High Performance Multimedia and Premium Sound Multimedia.



1. When the **Name** row is selected, press **OK/MENU** to reach the input mode (illustration above).
2. Turn<sup>47</sup> **TUNE** to the desired letter, press **OK/MENU** to confirm. The number and letter buttons on the control panel in the centre console can also be used.
3. Continue with the next letter and so on. The name entered is shown in the input field (2) in the display screen.
4. To change the input mode to numbers, special characters, change between uppercase/lowercase letters, etc., turn **TUNE** to one of the options (see explanation in the following table) in the list (1) and then press **OK/MENU**.

When the name has been fully entered, select **OK** in the list on the display screen (1) and press **OK/MENU**. Now continue with the telephone number in the same way as above.

When the telephone number has been entered, press **OK/MENU** and select a telephone number type (**Mobile phone**, **Home**, **Work** or **General**). Press **OK/MENU** to confirm.

When all details have been filled in, select **Save contact** in the menu to save the contact.

123/ABC	Change between letters and numbers with <b>OK/MENU</b> .
More	Change to special characters with <b>OK/MENU</b> .
OK	Save and go back to <b>Add contact</b> with <b>OK/MENU</b> .
a A	Change between uppercase and lowercase letters with <b>OK/MENU</b> .
<- ->	Press <b>OK/MENU</b> , the cursor moves to the input field (2) at the top of the display screen. The cursor can now be moved, with <b>TUNE</b> , to the appropriate place to e.g. insert new letters or delete with <b>EXIT</b> . To be able to insert new letters first go back to the input mode, by pressing <b>OK/MENU</b> .

#### Related information

- Audio and media - operating the system (p. 22)
- Bluetooth® handsfree phone (p. 58)
- Phone book (p. 61)

#### Phone book - speed dial numbers

Store as speed dial number in the phone book (p. 61) in order to easily dial a number or a contact.

Use phone mode to add speed dial numbers under **Phone menu** → **Phone book** → **Speed dial**.

Dialling with speed dial numbers can be performed in phone mode using the number keys on the keypad in the centre console, by pressing a number key and then pressing **OK/MENU**. If there is no contact stored on the speed dial number then an option is shown to save a contact to the selected speed dial number.

#### Related information

- Audio and media - operating the system (p. 22)
- Bluetooth® handsfree phone (p. 58)

<sup>47</sup> Only applies to High Performance Multimedia and Premium Sound Multimedia.



### Phone book - receiving a vCard

Receiving electronic business cards (vCard) to the car's phone book (p. 61).

It is possible to receive a vCard to the car's phone book from other mobile phones (other than the one currently connected to the car). In order to allow this the car is set to visible mode for Bluetooth®. The function is activated in phone mode under **Phone menu** → **Phone book** → **Receive vCard**.

#### Related information

- Audio and media - operating the system (p. 22)
- Bluetooth® handsfree phone (p. 58)

### Phone book - memory status

Show phone book (p. 61) memory status.

Memory status of the car's phone book and the connected mobile phone's phone book can be seen in phone mode under **Phone menu** → **Phone book** → **Memory status**.

#### Related information

- Audio and media - operating the system (p. 22)
- Bluetooth® handsfree phone (p. 58)

### Phone book - clearing

Clear the car's built-in phone book (p. 61).

The car's phone book can be deleted, this is carried out in phone mode under **Phone menu** → **Phone book** → **Clear phone book**.

#### NOTE

Deleting the car's telephone book only deletes contacts in the car's telephone book. Contacts in the mobile phone's phone book are not deleted.

#### Related information

- Audio and media - operating the system (p. 22)
- Bluetooth® handsfree phone (p. 58)



## Voice recognition\* control of a mobile phone

Voice recognition<sup>48</sup> allows the driver to voice-activate certain functions in a Bluetooth®-connected mobile phone or in Volvo's navigation system.

### NOTE

- The information in this section describes the use of voice commands to control a **mobile phone connected using Bluetooth®**. For detailed information on using a Bluetooth®-connected mobile phone, see Bluetooth® handsfree phone (p. 58).
- The Volvo navigation system has a separate supplement which contains more information on voice recognition and voice commands to control the system.

Voice commands offer convenience and help the driver to avoid being distracted, and instead concentrate on driving and focus attention on the road and traffic conditions.

### WARNING

The driver always holds overall responsibility for driving the vehicle in a safe manner and complying with all applicable rules of the road.

The voice recognition system allows the driver to voice-activate certain functions of a Bluetooth®-connected mobile phone and in Volvo's navigation system\*, while the driver can keep his/her hands on the steering wheel at the same time. The input data are in dialogue form with spoken commands from the user and verbal replies from the system. The voice recognition system uses the same microphone as the Bluetooth® handsfree system (see Bluetooth®\* handsfree phone - overview (p. 59)) and the voice recognition system's replies come via the car's speakers.

## Getting started with voice recognition



Steering wheel keypad.

- 1 Button for voice recognition

Before voice commands to a mobile phone can be used the mobile phone must be paired and connected via Bluetooth® handsfree. If a telephone command is given and no mobile phone is paired, then the system will provide information about this. For information on registering and connecting a mobile phone, see Registering a Bluetooth®\* device (p. 54).

- Press the button for voice recognition (1) in order to activate the system and initiate a dialogue with voice commands. The system will then display commonly used commands in the display screen in the centre console.

<sup>48</sup> Only applies to vehicles equipped with Volvo's navigation system .



## 03 Audio and media



Keep the following things in mind when you use the voice recognition system:

- For a command - speak after the tone, with normal voice at normal speed.
- Do not speak while the system is replying (the system cannot understand commands during this time).
- The car's doors, windows and sunroof\* must be closed.
- Avoid background noise in the passenger compartment.

### NOTE

If the driver is unsure of which command to use, he (she) can say "Help" - the system then responds with a few different commands which can be used in the current situation.

Voice commands can be disabled by:

- saying "Cancel"
- not speaking
- a long press on the steering wheel button for Voice recognition
- Press **EXIT** or another main source button (e.g. **MEDIA**).

### Related information

- Audio and media - operating the system (p. 22)
- Bluetooth®\* handsfree phone - overview (p. 59)

- Connecting and disconnecting a Bluetooth®\* device (p. 54)
- Language options for voice recognition\* control of a mobile phone (p. 68)
- Help functions for voice recognition\* control of a mobile phone (p. 69)
- Voice recognition\* control of a mobile phone - user setting and voice volume (p. 69)
- Voice recognition\* control of a mobile phone - voice commands (p. 70)

### Language options for voice recognition\* control of a mobile phone

Possible language options for voice recognition control (p. 67)\* of a mobile phone are selected in the menu system **MY CAR**, see **MY CAR - Voice settings** (p. 17).



Language list.

Voice recognition is not possible for all languages. Languages available for voice recognition are marked with an icon in the language list - . Changing the language is performed in the menu system **MY CAR**, see **MY CAR** (p. 11).

### Related information

- Audio and media - operating the system (p. 22)



### Help functions for voice recognition\* control of a mobile phone

Help functions are available to help you become familiar with the system and the facility to teach the voice recognition system your voice and your accent.

- **Instructions:** A function that helps you get familiar with the system and the procedure for giving commands.
- **Voice training:** A function that enables the voice recognition system to learn to know your voice and your accent. The function provides an opportunity to voice train two user profiles.

The help functions can be accessed by pressing the **MY CAR** button on the control panel in the centre console and then turning **TUNE** to the desired menu option.

#### Instructions

The instructions can be started in two ways:

#### NOTE

This instruction and voice training can only be started when the car is parked.

- Press the button for voice recognition (p. 22) and say "Voice tutorial".
- Activate the instructions in the menu system **MY CAR** under **Settings** → **Voice settings** → **Voice tutorial**. For a descrip-

tion of the menu system, see MY CAR (p. 11).

The instructions are divided into 3 lessons, which take around 5 minutes in total to complete. The system starts with the first lesson. To skip a lesson and go to the next one, press the button for voice recognition and say "Next". Go back to the previous lesson by saying "Previous".

Exit the instructions by means of a long press on the button for voice recognition.

#### Voice training

The system displays up to fifteen phrases for you to say. Voice training can be started in the menu system **MY CAR** under **Settings** → **Voice settings** → **Voice training**. Select between **User 1** or **User 2**. For a description of the menu system, see MY CAR (p. 11).

After voice training has been completed, remember to set your user profile under **Voice user setting**.

#### Related information

- Audio and media - operating the system (p. 22)
- Voice recognition\* control of a mobile phone (p. 67)

### Voice recognition\* control of a mobile phone - user setting and voice volume

User profile and voice volume can be set in the menu system MY CAR (p. 11).

- **User setting** - Two user profiles can be set, the function is activated in the menu system **MY CAR** under **Settings** → **Voice settings** → **Voice user setting**. Select between **User 1** or **User 2**. For a description of the menu system, see MY CAR (p. 11).
- **Voice volume** - Can be changed in the menu system **MY CAR** under **Settings** → **Voice settings** → **Voice output volume**. For a description of the menu system, see MY CAR (p. 11).

#### Related information

- Audio and media - operating the system (p. 22)
- Voice recognition\* control of a mobile phone (p. 67)



### Voice recognition\* control of a mobile phone - voice commands

*It is possible to use voice recognition to control the mobile phone with predefined voice commands.*

The driver initiates a dialogue with voice commands by pressing the button for voice recognition (p. 67).

Once a dialogue has been started, commonly used commands will be shown in the display screen. Greyed-out text or text within brackets is not included in the spoken command.

When the driver becomes accustomed to the system, he/she can speed up the command dialogue and skip the prompts from the system, by briefly pressing the button for voice recognition.

### Commands can be given in several ways

The command "Phone call contact" can be pronounced as e.g.:

- "Phone > Call contact" - Say "Phone", wait for the system's reply, and then continue by saying "Call contact."

or

- "Phone call contact" - Say the whole command in one sequence.

### Related information

- Audio and media - operating the system (p. 22)
- Voice recognition\* control of a mobile phone (p. 67)

### Voice recognition\* control of a mobile phone - quick commands

*Voice recognition\* control of a mobile phone can be performed with a number of predefined quick commands.*

Quick commands for the phone can be found in the menu system **MY CAR** under **Settings** → **Voice settings** → **Voice command list** → **Phone commands** and **General commands**. For a description of the menu system, see MY CAR (p. 11).

### Related information

- Audio and media - operating the system (p. 22)
- Voice recognition\* control of a mobile phone - voice commands (p. 70)





### Voice guidance\* control of a mobile phone - dialling a number

*How to describe a number to control a mobile phone using voice recognition.*

The system understands the numbers **0** (zero) to **9** (nine). These numbers can be pronounced individually, in groups of several numbers at a time, or the whole number all at once. Numbers greater than **9** (nine) cannot be handled by the system, e.g. **10** (ten) or **11** (eleven) are not possible.

The following is an example of a dialogue with voice commands. The system's reply will vary depending on the situation.

#### The user starts the dialogue by saying:

Phone > call number

or

Phone call number

#### System reply

Number?

#### User action

Start saying the numbers (as individual units, i.e. six-eight-seven, etc.) in the phone number. If you say several numbers and pause, the system will repeat them, and then say "Continue".

Continue to say the numbers. When finished, finish the command by saying "Call".

- You can also change the number by saying the commands "Correct" (which deletes the last spoken group of numbers) or "Delete" (which deletes the whole spoken phone number).

#### Related information

- Audio and media - operating the system (p. 22)
- Voice recognition\* control of a mobile phone - voice commands (p. 70)

### Voice recognition\* control of a mobile phone - dialling from the call register

*Use voice recognition with the mobile phone to dial from the call register.*

The following dialogue allows you to make a phone call from one of your mobile phone's call registers.

#### The user starts the dialogue by saying:

Phone > call from the call register

or

Phone call from the call register

Continue by responding to the system's prompts.

#### Related information

- Audio and media - operating the system (p. 22)
- Voice recognition\* control of a mobile phone - voice commands (p. 70)



## Voice recognition\* control of a mobile phone - dialling a contact

Use voice recognition with the mobile phone to dial a contact.

The following dialogue allows you to call your pre-defined contacts in the mobile phone.

### The user starts the dialogue by saying:

Phone > call contact

or

Phone call contact

Continue by responding to the system's prompts.

Consider the following when you call a contact:

- If there are several contacts with similar names, they will be presented in the display in the numbered rows and the system prompts you to select a row number.
- If there are more rows in the list than can be displayed simultaneously, saying "Down" allows you to scroll down in the list (and saying "Up" allows you to scroll up in the list).

### Related information

- Audio and media - operating the system (p. 22)
- Voice recognition\* control of a mobile phone - voice commands (p. 70)

## Voice recognition\* control of a mobile phone - calling the voice mailbox

Use voice recognition with a mobile phone to call the voice mailbox.

The following dialogue allows you to call your voice mailbox to check if you have received any messages. The phone number for your voice mailbox must be registered in the Bluetooth® function, see Making and receiving calls (p. 59).

### The user starts the dialogue by saying:

Phone > call voice mailbox

or

Phone call voice mailbox

Continue by responding to the system's prompts.

### Related information

- Audio and media - operating the system (p. 22)
- Voice recognition\* control of a mobile phone - voice commands (p. 70)

## TV\*

The TV picture is only shown when the car is stationary. When the car is moving at a speed over approx. 6 km/h the picture disappears, although the audio is heard during this time. The picture reappears when the car has stopped.



TV functions, control overview.

For basic operation, see Audio and media - operating the system (p. 22) and Menu navigation (p. 25).



### NOTE

This system only supports TV broadcasts in the countries that broadcast in MPEG-2 or MPEG-4 format and follow the DVB-T standard. The system does not support analogue broadcasts.

**i NOTE**

The TV picture is only shown when the car is stationary. When the car is moving at a speed over about 6 km/h the picture disappears, **No visual media available while driving** appears on the display screen, although the audio is heard during this time. The picture reappears when the car has stopped.

Cars with RSE do not shut off the rear screens.

**i NOTE**

The reception is dependent both on how good the signal strength and signal quality are. The transmission may be disturbed by various factors such as tall buildings or the TV transmitter being far away. Coverage level can also vary depending on where in the country you are located.

**! IMPORTANT**



A TV licence is required for this product in some countries.

**Watch TV**

- Press **MEDIA**, turn **TUNE** until **TV** is shown in the display, press **OK/MENU**.
  - > A search starts and after a short while the most recently used channel is shown.

**Changing channel**

It is possible to change channel as follows:

- Turn **TUNE**, a list of all available channels in the area is shown. If any of these channels is already saved as a preset then its preset number is shown to the right of the channel name. Continue turning **TUNE** to reach the desired channel and press **OK/MENU**.
- By pressing the preset buttons (0-9).
- Via a short press on the  /  buttons the next available channel in the area is shown.

**i NOTE**

If the car has been moved within the country, for example, from one city to another, it is not certain that the presets are available at the new location as the frequency range may have changed. Then do another search and save a new preset list; see Save available TV channels as presets (p. 74).

**i NOTE**

If no reception is available on the preset buttons, it may be because the car is at a location other than where the scan of TV channels was run, for example, if the car was driven from Germany to France. A new selection of country and a new search may then need to be carried out.

**Related information**

- Searching TV\* channels/Preset list (p. 74)
- TV\* - channel management (p. 74)
- Information about the current TV\* programme (p. 75)
- Teletext\* (p. 75)
- Picture settings (p. 48)
- Reception of TV\* channel is lost. (p. 76)



### Searching TV\* channels/Preset list

After a search of TV channels the available channels are saved in a preset list.

1. Press TV mode on **OK/MENU**.
2. Turn **TUNE** to **TV menu** and press **OK/MENU**.
3. Turn **TUNE** to **Select country** and press **OK/MENU**.
  - > If one or more countries have previously been selected then they are shown in a list.
4. Turn **TUNE** to either **Other countries** or one of the previously selected countries. Press **OK/MENU**.
  - > A list of all available countries is shown.
5. Turn **TUNE** to the desired country (e.g. Sweden) and press **OK/MENU**.
  - > An automatic scan for available TV channels starts, this scan takes a little while. During this time the figure for each channel found and added as a preset is shown. When the scan is complete a message is shown and the picture is shown. A preset list (max. 30 presets) has now been created and is available. To change channel, see Changing channel (p. 72).

The scan and preset storage can be cancelled with **EXIT**.

### Related information

- Audio and media - operating the system (p. 22)
- TV\* (p. 72)
- TV\* - channel management (p. 74)

### TV\* - channel management

*The preset list can be edited. You can change the order of the channels that are shown in the preset list. A TV channel can have more than one place in the preset list. The TV channel positions can also vary in the preset list.*

To change the order in the preset list, go in TV mode to **TV menu** → **Reorganise presets**.

1. Turn **TUNE** to the channel you want to move in the list and confirm with **OK/MENU**.
  - > The selected channel is highlighted.
2. Turn **TUNE** to the new location in the list and confirm with **OK/MENU**.
  - > The channels change places with each other.

After the preset channels (max. 30) come all the other channels available in the area. It is possible to move a channel up to a place in the preset list.

### Save the available TV channels as presets

If the car has been moved within the country, for example, from one city to another, it is not certain that the presets are available at the new location as the frequency range may have changed. In which case, carry out another scan and save a new preset list.

1. Press TV mode on **OK/MENU**.



2. Turn **TUNE** to **TV** menu and press **OK/MENU**.
3. Turn **TUNE** to **Autostore** and press **OK/MENU**.
  - > An automatic scan for available TV channels starts, this scan takes a little while. During this time the figure for each channel found and added as a preset is shown. When the scan is complete a message is shown and the picture is shown. A preset list (max. 30 presets) has now been created and is available. To change channel, see Changing channel (p. 72).

### Scanning the TV channels

This function automatically scans through the frequency range for all channels available in the area where you are. When a channel is found, it is shown for approx. 10 seconds before scanning is resumed. Scanning is stopped with **EXIT**, then the channel that you just watched continues to be shown. Scanning does not affect the preset list.

Activate scanning in TV mode under **TV** menu → **Scan**.

### Related information

- Audio and media - operating the system (p. 22)
- TV\* (p. 72)
- Searching TV\* channels/Preset list (p. 74)

### Information about the current TV\* programme

Press the **INFO** button (p. 22) in order to display information about the current programme, the next programme and its start time.

If the **INFO** button is pressed once more then additional information on the current programme can sometimes be displayed, such as start and end times and a brief description of the current programme.

To return to the TV picture, wait several seconds or press **EXIT**.

### Related information

- Audio and media - operating the system (p. 22)
- TV\* (p. 72)

### Teletext\*

It is possible to look at Teletext.

Proceed as follows:

1. Press the  button on the remote control.
2. Enter the page number (3 digits) with the number keys (0-9) to select page.
  - > The page is shown automatically.

Enter new page number, or press the remote control buttons ◀ / ▶ to go to the next page.

Return to TV screen with **EXIT** or by pressing the  button on the remote control.

It is also possible to control the teletext with the coloured buttons on the remote control.

### Related information

- Audio and media - operating the system (p. 22)
- TV\* (p. 72)
- Remote control\* (p. 76)



### Reception of TV\* channel is lost.

If the reception for the TV channel that is being shown disappears then the picture will freeze. When the reception returns the display starts again.

If the reception for the TV channel that is being shown disappears then the picture will freeze. Shortly after this a message appears informing that the reception has been lost for the current TV channel, and a new search for the channel continues. When the reception returns the display of the TV channel starts immediately. It is possible to change channel at any time when the message is shown.

If the message **Reception lost, searching** is shown then this is because the system has detected that there is no reception for all TV channels. One possible reason may be that a border has been crossed and that the system is set to the wrong country. In which case, change to the right country in accordance with Searching TV\* channels/Presets list (p. 74).

### Related information

- Audio and media - operating the system (p. 22)
- TV\* (p. 72)

### Remote control\*

The remote control can be used for all functions in the audio and media system. The remote control's buttons have the same functions as the buttons in the centre console or steering wheel keypad\*.



1 Corresponds to **TUNE** in the centre console.

When using the remote control, first press the remote control's button **L F R** to position **F**. Then aim the remote control at the IR

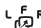

receiver, which is located to the right of the **INFO** button (p. 22) in the centre console.

If the car is fitted with rear display screens\* and you want to operate one of these, select the required display screen with the button  on the remote control. Then aim the remote control at the IR receiver for the screen to be operated, see Multimedia system for rear seat (RSE)\* - overview (p. 81).

### WARNING

Keep loose objects such as mobile phones, cameras, remote controls for accessories, etc. in the glove compartment or other compartments. Otherwise they may injure people in the car in the event of sudden braking or a collision.

### NOTE





Do not expose the remote control to direct sunlight (e.g. on the instrument panel) - otherwise problems may arise with the batteries.





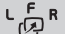

### Related information

- Audio and media - operating the system (p. 22)
- Remote control\* - functions (p. 77)
- Remote control\* - battery replacement (p. 78)

### Remote control\* - functions

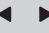
Possible functions to be controlled using the remote control.

Key	Function
	Change between: L = Rear left display screen* F = Front display screen R = Rear right display screen*
<b>NAV</b>	Change to navigation*
<b>RADIO</b>	Change to radio source (e.g. FM1)
<b>MEDIA</b>	Change to media source ( <b>Disc</b> , <b>TV*</b> etc.)
<b>TEL</b>	Change to Bluetooth® hands-free*
	Scroll/fast rewind, change track/song
	Play/pause
	Stop
	Scroll/fast forward, change track/song
<b>DVD MENU</b>	Menu

Key	Function
<b>EXIT</b> 	To previous, cancels function, deletes input characters
	Navigate up/down
	Navigate right/left
<b>OK MENU</b>	Confirm selection or go to the menu system for the selected source
	Volume, decrease
	Volume, increase
0-9	Preset channels, number and letter input
<b>FAV</b> *	Shortcuts for favourite setting
<b>INFO</b> #	Information about the current programme, song, etc. Also used when there is more information available than can be shown in the display screen
	Selection of language for soundtrack



Key	Function
	Subtitles, selection of language for text
	Teletext*, On/Off

### Related information

- Audio and media - operating the system (p. 22)
- Remote control\* (p. 76)

### Remote control\* - battery replacement

*How to replace the batteries in the remote control for the audio and media system.*

#### NOTE

Battery life is normally 1-4 years and depends on how much the remote control is used.

The remote control is powered by four batteries of the AA/LR6 type.

Take along extra batteries for a long journey.

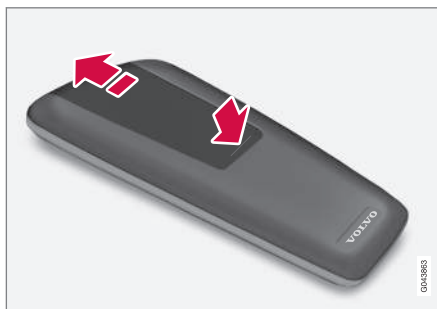

1. Push down the catch on the battery cover and slide the battery cover in the direction of the infrared lens.
2. Remove the used batteries, turn the new batteries in accordance with the symbols in the battery compartment and fit them.
3. Refit the cover.



#### NOTE

Be sure to dispose of the exhausted batteries in an environmentally safe manner.

### Related information

- Remote control\* (p. 76)





### Multimedia system for rear seat (RSE)\*

*The RSE system is a system for rear-seat entertainment that makes it possible to e.g. watch video, play music, listen to the radio, watch TV\* or connect other external devices (e.g. a games console).*

The RSE system is fully integrated with the car's audio and media system and can be used simultaneously with other functions in the audio and media system.

When the rear seat passengers are using e.g. A/V-AUX or watching TV\* while listening with headphones (p. 82) the driver and front seat passenger can still use the car's radio or media player. However, only one disc at a time can be played in the media player. It is possible to play back music from e.g. an iPod® or steaming audio files via Bluetooth®.

The RSE system can be controlled from the front screen (parental control).

It is possible to display or play back various media from different sources on each screen. It is also possible to display or play back media from the same source on one or more of the display screens (front, right rear and left rear). It is not possible to play back video from USB while a CD or DVD disc is being played back.

#### IMPORTANT

When loading luggage and large objects in the vehicle, ensure that sufficient space is left for the TV screens in the head restraints, so that the TV screens are not scratched or damaged. Cover the TV screens with appropriate covering material during loading.

#### NOTE

The TV screens and remote control do not work at very low or high temperatures - they only "come alive" after the climate control system has created an acceptable operating temperature in the passenger compartment.

#### NOTE

Clean the lens on the IR receiver regularly with a damp cloth, a dirty lens affects remote control function.

#### Power consumption, key positions

The system can be activated in key position I or II and while the engine is running. When the car is being started the film stops temporarily and continues when the engine has started. For information about key positions, see the Owner's Manual.

#### NOTE

For prolonged use (more than 10 minutes) with the engine switched off, the capacity of the vehicle's battery may fall to such a low level that it is not possible to start the engine.

In this case a message will be displayed on the screen.

#### To activate the system

The RSE system can be activated from either the front or rear screen.

From the front display screen, press **MEDIA**, turn **TUNE** and select **RSE**, confirm with **OK/MENU**.

From the rear display screen, by means of pressing the On/Off button on the rear display screen and then pressing **MEDIA** or **RADIO** on the remote control, turn **TUNE** and select a source (e.g. **Disc**), confirm selection with

**OK**  
**MENU**

#### Menus

The RSE menus are operated both from the front screen, and from either of the rear screens. From the front display screen it is possible to both activate a source for a rear display screen, and to make certain settings for the two rear display screens.

The menus for RSE are controlled with the remote control (p. 76) or via the front control



## 03 Audio and media



panel. For information on possible menu options and settings, see Menu overview - RSE\* (p. 95).

For general operation of the audio and media system, see Operating the system (p. 22) and Menu navigation (p. 25).

### Remote control

The RSE system is equipped with a remote control (p. 76) . Using this it is possible to control the functions for each display screen. The remote control can also be used to control other functions in the audio and media system, even from the rear seat.

### Related information

- Multimedia system for rear seat (RSE)\* - overview (p. 81)
- Connecting an external source to RSE (p. 83)
- Multimedia system for rear seat (RSE)\* - settings (p. 84)



## Multimedia system for rear seat (RSE)\* - overview

Overview of the RSE system's associated parts.

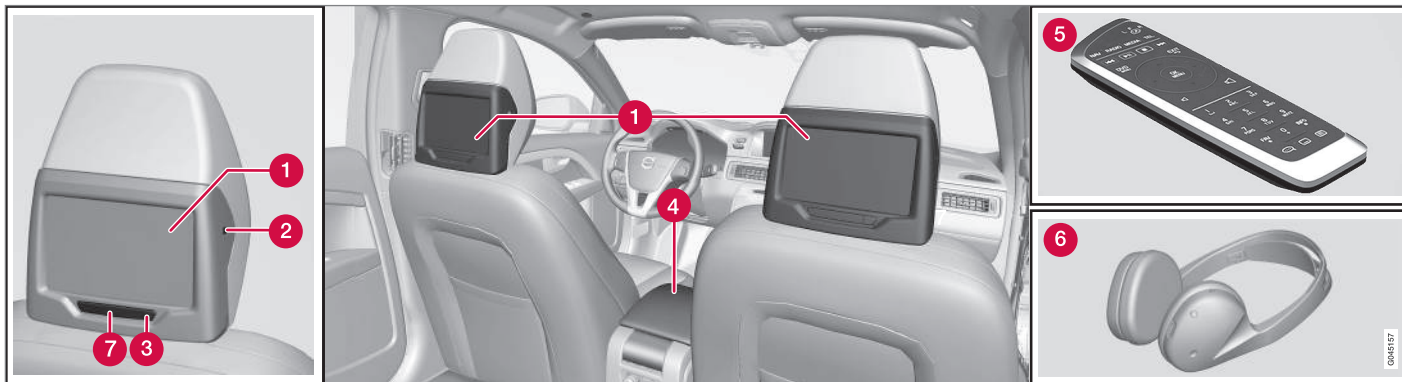

- 1 Display
- 2 Headphones socket
- 3 On/Off button
- 4 Connecting an external source to RSE (p. 83)
- 5 Remote control\* (p. 76)
- 6 Wireless headphones\* (p. 82)
- 7 IR receiver/transmitter

### Related information

- Multimedia system for rear seat (RSE)\* (p. 79)



## Wireless headphones\*

Wireless headphones\* for the RSE system.

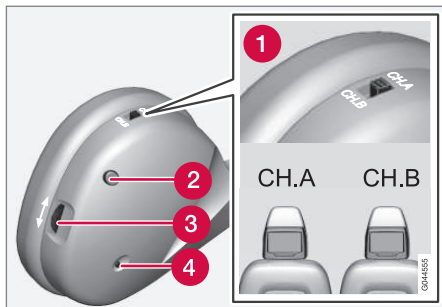

- 1 Control for channel A (**CH.A**) or channel B (**CH.B**)
- 2 On/Off button
- 3 Volume
- 4 Indicator lamp On/Off

The RSE system includes two wireless headphones.

The wireless headphones are activated with the On/Off button (2), an indicator lamp illuminates (4). Select **CH.A** (channel A) or **CH.B** (channel B) using the control (1). Adjust the volume using the volume control (3).

The headphones are automatically switched off after about 3 minutes if they are not used.

## Headphones socket

It is possible to connect external headphones via the headphones socket (3.5 mm) on the side of the head restraints, see overview illustration (p. 81). The volume is controlled using the remote control (p. 76).

## Battery replacement in wireless headphones

The headphones are powered by two batteries of the AAA model.

Take along extra batteries for a long journey.

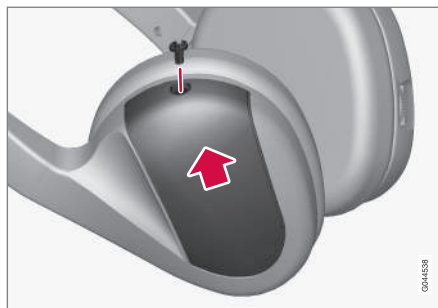

Wireless headphones.

1. Unscrew the screw and detach the battery cover.
2. Remove the used batteries, turn the new batteries in accordance with the symbols in the battery compartment and insert them.
3. Fit the cover and screw in the screw.

## Environmental care

Be sure to dispose of the exhausted batteries in an environmentally safe manner.

## Related information

- Multimedia system for rear seat (RSE)\* (p. 79)



## Connecting an external source to RSE

Connecting an external source via the A/V-AUX input for playback via the RSE system.

### A/V-AUX input, Electrical socket 12 V

The input allows you to connect other equipment. Always follow the instructions included with the external equipment, or from the manufacturer or reseller, when connecting. Equipment connected via the A/V-AUX input can use the display screens, wireless headphones, headphones sockets and the car's speakers.

#### **i** NOTE

The customer is responsible that equipment connected to the A/V-AUX input or headphones socket does not cause interference in the vehicle's RSE system.

### Connection via A/V-AUX input



The A/V-AUX input is located under the armrest in the tunnel console.

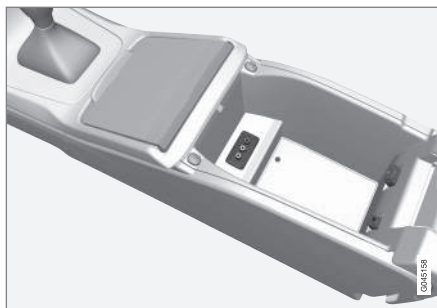

The A/V-AUX input is located under the armrest in the tunnel console.

1. Connect the video cable to the yellow socket.

2. Connect the left-hand audio cable to the white socket and the right-hand one to the red socket.
3. Connect the power cable to the electrical socket if your equipment is designed for 12 V.

Always follow the instructions for the external equipment when connecting.

There is a recess in the right-hand rear edge of the tunnel console where cables can be routed so that the hatch can be closed without cables being pinched.

For electrical socket location, see 12 V sockets in the Owner's Manual.

### Playing back audio/video via the A/V-AUX input

1. Switch on the rear display screen by means pressing the On/Off button on the display screen.
2. Aim the remote control at the IR receiver on the display screen and press **MEDIA**, turn **TUNE** to **A/V AUX**, confirm selection with **OK/MENU**.
3. Switch on the connected device and press **PLAY** or equivalent on the connected device.

### Input volume

The input volume is adjusted in the menu under **A/V AUX input volume**.



## Related information

- Multimedia system for rear seat (RSE)\* (p. 79)
- Multimedia system for rear seat (RSE)\* - overview (p. 81)
- Multimedia system for rear seat (RSE)\* - settings (p. 84)

## Multimedia system for rear seat (RSE)\* - settings

*Settings for playback, screen, audio and video.*

The RSE menus are operated both from the front screen, and from either of the rear screens. From the front display screen it is possible to both activate a source for a rear display screen, and to make certain settings for the two rear display screens.

The menus for RSE are controlled with the remote control (p. 76) or via the front control panel. For information on possible options and settings, see Menu overview - RSE\* (p. 95).

RSE system is operated just as any other sound and media system, see Operating the system (p. 22) and Menu navigation (p. 25).

### Settings from the front display screen

#### • Selection of source in the rear screens

From the front display screen it is possible to select the source (what shall be displayed or played back) for the right and left-hand rear display screens respectively. It is possible to select the same source for both or different sources for the right and left-hand display screens respectively.

1. Press **MEDIA**, turn **TUNE** to scroll down to **RSE** on the display screen, confirm selection with **OK/MENU**.
2. Turn **TUNE** to select the right, left-hand or both display screens, and confirm with **OK/MENU**.
3. Turn **TUNE** to select **RADIO**, **MEDIA** (or **RSE settings**). Press **OK/MENU** to confirm.
4. Turn **TUNE** to the desired source (e.g. **Disc**) and confirm with **OK/MENU**. The selected source will start automatically (if e.g. a disc is in the media player).

Cancel and go back with **EXIT**.

Remote control (p. 76) can also be used for settings.

#### • Parental control for the TV\*

It is possible to set a permitted age limit for the TV, so that only programmes for the appropriate age can be viewed. The setting is activated for both display screens.

Activate under **RSE settings** → **TV parental control**, in accordance with points 2-4 above in the section "Selection of source in rear screens". Select between **Age 0-6**, **Age 7-13**, **Age 14-18** and **No parental control**.

#### • Audio off

It is possible to mute the two rear screens from the front screen. The function is activated under **RSE settings** → **Mute**, in



accordance with points 2-4 above in the section "Selection of source in rear screens".

- **Display screen off**

It is possible to switch off the video for the two rear display screens from the front display screen. The function is activated under **RSE settings** → **Display off**, in accordance with points 2-4 above in the section "Selection of source in rear screens".

Press one of the remote control's numeric keys (**0 - 9**) to switch on the display screen again. The display screen is also switched to the **On** mode when the ignition is switched on.

- **Switching off the remote control (front)**

It is possible to switch off the IR receiver for the front display screen, which means that the remote control cannot be used for the front display screen. The function is activated under **RSE settings** → **Disable remote control (front)**, in accordance with points 2-4 above in the section "Selection of source in rear screens".

### Display screen settings<sup>50</sup> rear display screen

When playing back video files and displaying TV\* a pop-up menu is available by means of

pressing  on the remote control. The pop-up menu has different content depending on what is being played back or displayed.

- **Day/Night mode**

The display screen can be set in three different modes for different light conditions. Choose between **Auto**, **Day** and **Night**.

Press  on the remote control and change the mode under **Day/Night mode** on the display screen.

- **Picture settings**

You can adjust the settings for brightness, contrast, shade and colour.

Press  on the remote control and change the mode under **Image settings** on the display screen.

- **Display format**

It is possible to choose between display formats **Normal**, **Zoom** and **Screen fit**.

**Normal** - The image is shown in its normal mode (normally 4:3 or 16:9 format).

**Zoom** - Full screen used but parts of the image are cut off.

**Screen fit** - Full screen used but image proportions may be slightly distorted.

Unless otherwise stated the image is displayed in the screen format **Normal**.

Press  on the remote control and change the mode under **Screen format** on the display screen.

- **Source menu**

What is shown in the pop-up menu for the source menu depends on what is being played back or displayed, it can be e.g. **CD/DVD data menu** or **USB menu**.

- **DVD disc's menu<sup>51</sup>**

If a DVD Video disc is played back then this menu option is shown in the pop-up menu.

### Menu settings from the rear display screen

- Random selection of disc track or audio file (p. 46)<sup>52</sup>
- Repeat folder - is possible for CD/DVD discs (p. 51) and USB (p. 45)
- DivX® Video On Demand (p. 48)<sup>53</sup>
- USB hub (p. 49)

<sup>50</sup> Only available for playing back video files and displaying TV\*.

<sup>51</sup> Only applies to DVD video discs.

<sup>52</sup> Applies to CD-Audio, CD/DVD discs, USB and iPod®.

<sup>53</sup> Applies to CD/DVD discs and USB.



# 03 Audio and media



## TV settings

- Searching TV\* channels/Preset list (p. 74)
- Save the available TV channels as presets (p. 74)
- Scanning the TV channels (p. 74)

## Music, video, radio and TV\*

### • Playing back music

It is possible to play back music from disc tracks/audio files via the car's media player, USB port/AUX input or via streaming audio files from a Bluetooth®-connected phone.

### NOTE

The system only supports one iPod® user at a time in the navigation mode (playlist).

Read more about media player (p. 43), USB/AUX (p. 49) and Media Bluetooth®\* (p. 53).

1. Switch on the wireless headphones, select **CH.A** for left-hand screen or **CH.B** for right-hand screen.
2. Aim the remote control at the IR receiver on the display screen and press **MEDIA**, turn **TUNE** to desired source (**Disc**, **USB**, **AUX** etc.), confirm selection with .
3. Insert a CD disc in the car's media player or connect an external audio source via the car's USB port/AUX input or via Bluetooth®.

## Playback and navigation in playlists

Rotate the scroll wheel on the remote control to access the playlist/folder structure. either gives confirmation of subfolder selection or starts playing back the selected disc track/audio file. It is also possible to play back the disc track/audio file using on the remote control and change the disc tracks/audio file using / . Stop playback using .

For more information, see Media player (p. 43).

### • Watching video

It is possible to watch video from disc tracks/video files via the car's media player or USB port.

Read more about media player (p. 43) and USB/AUX (p. 49).

1. Switch on the wireless headphones, select **CH.A** for left-hand screen or **CH.B** for right-hand screen.
2. Aim the remote control at the IR receiver on the display screen and press **MEDIA**, turn **TUNE** to desired source (**Disc** or **USB**), confirm selection with .
3. Insert a DVD disc in the car's media player or connect an external source via the car's USB port.

## Playback and navigation

Play back disc track/video file using on the remote control and change disc track/video file using / . Stop playback using .

Read more about playback and navigation of DVD Video (p. 47), CD/DVD\* disc (p. 44) or external audio source (p. 51).

## Fast forward/reverse

Start fast forward/rewind by means of a long press on the buttons / . Then increase fast forward/rewind speed by short presses the buttons. Audio files are fast forwarded/rewound at one speed, while video files can be fast forwarded/rewound at four different speeds. Fast forward/rewind is stopped by pressing , or the equivalent opposite / button.

### • Listening to radio

It is possible to listen to radio via the car's radio.

1. Switch on the wireless headphones, select **CH.A** for left-hand screen or **CH.B** for right-hand screen.
2. Aim the remote control at the IR receiver on the screen and press **RADIO**, turn **TUNE** to desired source (**AM**, **FM1**, **DAB1\*** etc.), confirm selection with .
3. Select a station with one of the preset buttons (**0 - 9**) on the remote control or





press / , the radio will search for the next/previous available station.

Read more about Radio (p. 31).

#### • **Watching TV\***

It is possible to watch TV via the car's media player.

1. Switch on the wireless headphones, select **CH.A** for left-hand screen or **CH.B** for right-hand screen.
2. Aim the remote control at the IR receiver on the display screen and press **MEDIA**, turn **TUNE** to **TV**, confirm selection with .
3. Select a channel with one of the preset buttons (**0 - 9**) on the remote control or press / , the next/previous channel available in the area is displayed.

Read more about TV\* (p. 72).

#### **Related information**

- Menu overview - RSE\* (p. 95)
- Multimedia system for rear seat (RSE)\* (p. 79)

### **Audio and media - menu overview**

*Overview of possible options and settings in the audio and media system menus.*

#### **RADIO**

- AM (p. 87)<sup>54</sup>
- FM (p. 88)
- DAB (p. 89)

#### **MEDIA**

- CD Audio (p. 89)
- CD/DVD Data (p. 90)
- DVD Video (p. 90)
- iPod (p. 91)
- USB (p. 91)
- Media Bluetooth (p. 92)
- AUX (p. 93)
- TV (p. 94)
- Multimedia system for rear seat (RSE) (p. 95)

#### **TEL**

- Bluetooth handsfree (p. 93)

#### **Related information**

- Audio and media - operating the system (p. 22)
- Audio and media - menu navigation (p. 25)

### **Menu overview - AM**

*Overview of possible options and settings for AM radio.*

Main menu AM <sup>A</sup>	See page
<b>Show presets</b> See footnote <sup>B</sup>	(p. 34)
<b>Scan</b>	(p. 39)
<b>Audio settings</b> See footnote <sup>C</sup>	(p. 30)
Sound stage See footnote <sup>D</sup>	(p. 30)
Equalizer See footnote <sup>E</sup>	(p. 30)
Volume compensation	(p. 31)
Reset all audio settings	(p. 29)

<sup>A</sup> Does not apply to the V60 PLUG-IN HYBRID.

<sup>B</sup> Only applies to High Performance Multimedia and Premium Sound Multimedia.

<sup>C</sup> The menu options for audio settings are the same for all audio sources.

<sup>D</sup> Only applies to Premium Sound Multimedia.

<sup>E</sup> Does not apply to Performance.

<sup>54</sup> Does not apply to the V60 PLUG-IN HYBRID.



## Related information

- Audio and media - menu overview (p. 87)
- Audio and media - menu navigation (p. 25)

## Menu overview - FM

Overview of possible options and settings for FM radio.

Main menu FM1/FM2	See page
TP	(p. 36)
Show radio text	(p. 38)
Show presets See footnote <sup>A</sup>	(p. 34)
Scan	(p. 39)
News settings	(p. 36)
<b>Advanced settings</b>	
REG	(p. 39)
Alternative frequency	(p. 39)
EON	(p. 36)
Set TP favourite	(p. 36)
PTY settings	(p. 37)

Reset all FM settings	(p. 40)
<b>Audio settings</b>	(p. 29)
Sound stage See footnote <sup>B</sup>	(p. 30)
Equalizer See footnote <sup>C</sup>	(p. 30)
Volume compensation	(p. 31)
Reset all audio settings	(p. 29)

<sup>A</sup> Only applies to High Performance Multimedia and Premium Sound Multimedia.

<sup>B</sup> Only applies to Premium Sound Multimedia.

<sup>C</sup> Does not apply to Performance.

## Related information

- Audio and media - menu overview (p. 87)
- Audio and media - menu navigation (p. 25)



### Menu overview - Digital radio (DAB)\*

Overview of possible options and settings for DAB radio\*.

Main menu DAB1*/DAB2*	See page
<b>Ensemble learn</b>	(p. 41)
<b>PTY filtering</b>	(p. 37)
Turn off PTY filtering	(p. 37)
<b>Show radio text</b>	(p. 38)
<b>Show presets</b> See footnote <sup>A</sup>	(p. 34)
<b>Scan</b>	(p. 39)
<b>Advanced settings</b>	
DAB linking	(p. 41)
DAB band	(p. 42)
Sub channels	(p. 42)
Show PTY text	(p. 37)

Reset all DAB settings	(p. 42)
<b>Audio settings</b>	(p. 29)
Sound stage See footnote <sup>B</sup>	(p. 30)
Equalizer See footnote <sup>C</sup>	(p. 30)
Volume compensation	(p. 31)
Reset all audio settings	(p. 29)

<sup>A</sup> Only applies to High Performance Multimedia and Premium Sound Multimedia.

<sup>B</sup> Only applies to Premium Sound Multimedia.

<sup>C</sup> Does not apply to Performance.

#### Related information

- Audio and media - menu overview (p. 87)
- Audio and media - menu navigation (p. 25)

### Menu overview - CD Audio

Overview of possible options and settings for CD Audio.

Main menu CD Audio (Disc menu)	See page
<b>Random</b>	(p. 46)
<b>Scan</b>	(p. 46)
<b>Audio settings</b>	(p. 29)
Sound stage See footnote <sup>A</sup>	(p. 30)
Equalizer See footnote <sup>B</sup>	(p. 30)
Volume compensation	(p. 31)
Reset all audio settings	(p. 29)

<sup>A</sup> Only applies to Premium Sound Multimedia.

<sup>B</sup> Does not apply to Performance.

#### Related information

- Audio and media - menu overview (p. 87)
- Audio and media - menu navigation (p. 25)



# 03 Audio and media

## Main overview - CD/DVD Data

Overview of possible options and settings for CD/DVD Data.

Main menu CD/DVD <sup>A</sup> Data (Disc menu)	See page
<b>Play</b>	(p. 44)
<b>Pause</b>	(p. 44)
<b>Stop</b>	(p. 44)
<b>Random</b>	(p. 46)
<b>Repeat folder</b>	(p. 45)
<b>Change subtitles</b>	(p. 44)
<b>Change audio track</b>	(p. 44)
<b>Scan</b>	(p. 46)
<b>Audio settings</b>	(p. 29)
Sound stage See footnote <sup>B</sup>	(p. 30)
Equalizer See footnote <sup>C</sup>	(p. 30)

Volume compensation	(p. 31)
Reset all audio settings	(p. 29)

<sup>A</sup> Only applies to High Performance Multimedia and Premium Sound Multimedia.

<sup>B</sup> Only applies to Premium Sound Multimedia.

<sup>C</sup> Does not apply to Performance.

### Related information

- Audio and media - menu overview (p. 87)
- Audio and media - menu navigation (p. 25)

## Menu overview - DVD Video

Overview of possible options and settings for DVD Video.

Main menu DVD <sup>A</sup> Video (Disc menu)	See page
<b>DVD disc menu</b>	(p. 47)
<b>Play/Pause/Continue</b>	(p. 47)
<b>Stop</b>	(p. 47)
<b>Subtitles</b>	(p. 47)
<b>Audio tracks</b>	(p. 47)
<b>Advanced settings</b>	
Angle	(p. 48)
DivX <sup>®</sup> VOD code	(p. 48)
<b>Audio settings</b>	(p. 29)
Sound stage	(p. 30)
Equalizer	(p. 30)



Volume compensation	(p. 31)
Reset all audio settings	(p. 29)

<sup>A</sup> Only applies to High Performance Multimedia and Premium Sound Multimedia.

### Pop-up menu<sup>A</sup> video and TV\*

Press **OK/MENU** when a video file is being played back or TV\* is being shown in order to access the pop-up menu.

<b>Image settings</b>	(p. 48)
<b>Source menu</b> See footnote <sup>B</sup>	(p. 25)
<b>DVD disc menu</b> See footnote <sup>C</sup>	(p. 47)
<b>DVD disc TOP menu<sup>C</sup></b>	(p. 47)

<sup>A</sup> Only applies when playing back videos or displaying TV.

<sup>B</sup> What is shown in the pop-up menu for the source menu depends on what is being played back or displayed, it can be e.g. CD/DVD data menu or USB menu.

<sup>C</sup> Only applies to DVD video discs.

### Related information

- Audio and media - menu overview (p. 87)
- Audio and media - menu navigation (p. 25)

### Menu overview - iPod

Overview of possible options and settings for iPod®.

Main menu iPod <sup>A</sup>	See page
<b>Random</b>	(p. 46)
<b>Scan</b>	(p. 46)
<b>Audio settings</b>	(p. 29)
Sound stage See footnote <sup>B</sup>	(p. 30)
Equalizer See footnote <sup>C</sup>	(p. 30)
Volume compensation	(p. 31)
Reset all audio settings	(p. 29)

<sup>A</sup> Does not apply to Performance.

<sup>B</sup> Only applies to Premium Sound Multimedia.

<sup>C</sup> Does not apply to Performance.

### Related information

- Audio and media - menu overview (p. 87)
- Audio and media - menu navigation (p. 25)

### Menu overview - USB

Overview of possible options and settings for USB.

Main menu USB <sup>A</sup>	See page
<b>Play</b>	(p. 51)
<b>Pause</b>	(p. 51)
<b>Stop</b>	(p. 51)
<b>Random</b>	(p. 46)
<b>Repeat folder</b>	(p. 51)
<b>Select USB device</b>	(p. 49)
<b>Change subtitles</b>	(p. 51)
<b>Change audio track</b>	(p. 51)
<b>Scan</b>	(p. 46)
<b>Audio settings</b>	(p. 29)
Sound stage See footnote <sup>B</sup>	(p. 30)
Equalizer See footnote <sup>C</sup>	(p. 30)



Volume compensation	(p. 31)
Reset all audio settings	(p. 29)

- A Does not apply to Performance.
- B Only applies to Premium Sound Multimedia.
- C Does not apply to Performance.

### Related information

- Audio and media - menu overview (p. 87)
- Audio and media - menu navigation (p. 25)

### Menu overview - Media Bluetooth

Overview of possible options and settings for Media Bluetooth®.

Main menu Media Bluetooth <sup>A</sup>	See page
Random	(p. 46)
Change device	(p. 56)
Remove Bluetooth device	(p. 57)
Scan	(p. 46)
Bluetooth software version in car	(p. 58)
Audio settings	(p. 29)
Sound stage See footnote <sup>B</sup>	(p. 30)
Equalizer See footnote <sup>C</sup>	(p. 30)

Volume compensation	(p. 31)
Reset all audio settings	(p. 29)

- A Does not apply to Performance.
- B Only applies to Premium Sound Multimedia.
- C Does not apply to Performance.

### Related information

- Audio and media - menu overview (p. 87)
- Audio and media - menu navigation (p. 25)



## Menu overview - AUX

Overview of possible options and settings for AUX.

Main menu AUX	See page
AUX input volume	(p. 52)
Audio settings	(p. 29)
Sound stage See footnote <sup>A</sup>	(p. 30)
Equalizer See footnote <sup>B</sup>	(p. 30)
Volume compensation	(p. 31)
Reset all audio settings	(p. 29)

<sup>A</sup> Only applies to Premium Sound Multimedia.

<sup>B</sup> Does not apply to Performance.

## Related information

- Audio and media - menu overview (p. 87)
- Audio and media - menu navigation (p. 25)

## Menu overview - Bluetooth handsfree

Overview of possible options and settings for Bluetooth<sup>®</sup> handsfree.

Main menu Bluetooth <sup>®</sup> handsfree <sup>A</sup> (Phone menu)	See page
All calls	(p. 59)
All calls	(p. 59)
Missed calls	(p. 59)
Answered calls	(p. 59)
Dialled calls	(p. 59)
Call duration	(p. 59)
Phone book	(p. 61)
Search	(p. 63)
New contact	(p. 64)
Speed dials	(p. 65)
Receive vCard	(p. 66)

Memory status	(p. 66)
Clear phone book	(p. 66)
Change phone	(p. 56)
Remove Bluetooth device	(p. 57)
Phone settings	
Discoverable	(p. 54)
Sounds and volume	(p. 60)
Download phone book	(p. 61)
Bluetooth software version in car	(p. 58)
Call options	
Auto answer	(p. 59)
Voicemail number	(p. 59)
Disconnect phone	(p. 57)

<sup>A</sup> Does not apply to Performance.



## Related information

- Audio and media - menu overview (p. 87)
- Audio and media - menu navigation (p. 25)

## Menu overview - TV

Overview of possible options and settings for TV\*.

Main menu TV*	See page
Select country	(p. 74)
Reorganise presets	(p. 74)
Autostore	(p. 74)
Scan	(p. 74)
Audio settings	(p. 30)
Sound stage See footnote <sup>A</sup>	(p. 30)
Equalizer See footnote <sup>B</sup>	(p. 30)
Volume compensation	(p. 31)
Reset all audio settings	(p. 29)

<sup>A</sup> Only applies to Premium Sound Multimedia.

<sup>B</sup> Does not apply to Performance.

Pop-up menu <sup>A</sup> *video and TV*	See page
Press <b>OK/MENU</b> when a video file is being played back or TV* is being shown in order to access the pop-up menu.	
Image settings	(p. 48)
Source menu See footnote <sup>B</sup>	(p. 25)
DVD disc menu See footnote <sup>C</sup>	(p. 47)
DVD disc TOP menu <sup>C</sup>	(p. 47)

<sup>A</sup> Only applies when playing back videos or displaying TV.

<sup>B</sup> What is shown in the pop-up menu for the source menu depends on what is being played back or displayed, it can be e.g. CD/DVD data menu or USB menu.

<sup>C</sup> Only applies to DVD video discs.

## Related information

- Audio and media - menu overview (p. 87)
- Audio and media - menu navigation (p. 25)





## Menu overview - RSE\*

Overview of possible menu options and settings in the RSE system.

### RSE menus front screen

To access the menu **RSE** must first be selected under **MEDIA** via the front display screen. Then press **OK/MENU** to access the menu. Turn **TUNE** to the desired selection and confirm with **OK/MENU**. Remote control (p. 76) and steering wheel keypad can also be used.

It is possible to make settings for either right or left-hand display screen or both display screens.

**Left RSE screen menu, Right RSE screen menu and Both RSE screen menus:**

Power off/Power on

RADIO

MEDIA

RSE settings

Mute

Display off

Disable remote control (front)

TV parental control

Reset all RSE settings

### Pop-up menu RSE<sup>55</sup>

Press **OK/MENU** on the remote control (p. 76) when a video file is being played back or the TV\* is being shown in order to access the pop-up menu. Menu selections are made using the scroll wheel and the buttons on the remote control.

Screen format

Image settings

Day/Night mode

Source menu<sup>56</sup>

DVD disc menu<sup>57</sup>

### RSE menus rear screens

Press **OK/MENU** on the remote control (p. 76) when a source (e.g. **Disc**) is selected in order to access the RSE menus for the rear screen.

Menu selections are made using the scroll wheel and the buttons on the remote control.

**RADIO**

Menu valid for **AM, FM1, FM2, DAB1\*** and **DAB2\***:

Day/Night mode

Display off

Reset all RSE settings

**MEDIA**

### RSE CD Audio menu

#### Disc menu

Random

Day/Night mode

Display off

Reset disc settings

### RSE CD/DVD Data menu

#### Disc menu

Random

Repeat folder

DivX® VOD code

Day/Night mode

Display off

Reset disc settings

<sup>55</sup> Only applies when playing back videos or displaying TV\*.

<sup>56</sup> What is shown in the pop-up menu for the source menu depends on what is being played back or displayed, it can be e.g. CD/DVD data menu or USB menu.

<sup>57</sup> Only applies to DVD video discs.



# 03 Audio and media



## RSE DVD Video menu

### DVD Video Menu

- DVD disc menu
- Subtitles
- Audio tracks
- Advanced settings
- Day/Night mode
- Display off
- Reset disc settings

## RSE USB menu

### USB menu

- Random
- Repeat folder
- DivX® VOD code
- Select USB device
- Day/Night mode
- Display off
- Reset USB settings

## RSE AUX menu

### AUX menu

- AUX input volume
- Day/Night mode
- Display off
- Reset AUX settings

## RSE A/V-AUX menu

### A/V AUX menu

- A/V AUX input volume
- Day/Night mode
- Display off
- Reset AUX settings

## RSE iPod menu

### iPod menu

- Random
- Day/Night mode
- Display off
- Reset iPod settings

## RSE Bluetooth® menu

### Bluetooth menu

- Random
- Day/Night mode
- Display off
- Reset Bluetooth settings

## RSE TV menu\*

### TV menu

- Select country
- Autostore
- Scan
- Day/Night mode

Display off

Reset TV settings

## Related information

- Audio and media - menu overview (p. 87)
- Audio and media - menu navigation (p. 25)
- Multimedia system for rear seat (RSE)\* (p. 79)



**A**

A/V-AUX input.....	83
Alarm for accidents and disasters.....	35
Audio	
headphones socket.....	27
rear control panel.....	27
settings.....	28
surround.....	21, 29
Audio and media	
introduction.....	21
manage the system.....	22
menu overview.....	87
menus.....	25
overview.....	22
Audio profile.....	30
audio system	
functions.....	28
overview.....	22
Audio system.....	21
Audio volume.....	22
external audio source.....	52
phone.....	60
phone/media player.....	60
ring signal, phone.....	60
speed/noise compensation.....	31
AUX input.....	22, 49

**B**

Battery	
headphones.....	82
remote control.....	78
Bluetooth®	
handsfree.....	58
media.....	53
microphone off.....	59
streaming audio.....	53
transfer call to mobile.....	59

**C**

Calls	
incoming.....	58
operation.....	58
CD.....	43
Controls	
centre console.....	22

**D**

DAB Radio.....	31, 40
Digital radio (DAB).....	40
DVD.....	43

**E**

Equalizer.....	30
----------------	----

**H**

Headphones	
battery replacement.....	82
wireless.....	82
Headphones socket.....	27, 81, 82

**I**

Image settings.....	48
Infotainment system	
source buttons.....	22
voice control.....	67
Infotainment system (Audio and media)....	21
iPod®, connection.....	50

**K**

Keypad in the steering wheel.....	22
-----------------------------------	----

**M**

---

Making calls.....	58
Media, Bluetooth®.....	53
Media player.....	31, 43
compatible file formats.....	49
Menu navigation audio and media.....	25
Menu navigation RSE.....	79
Microphone.....	59
Mobile phone	
connect.....	54
handsfree.....	58
register phone.....	54
voice control.....	67
MY CAR.....	11, 12, 14, 15, 16, 17, 19

**N**

---

News broadcasts.....	36
----------------------	----

**P**

---

Phone	
connect.....	54
handsfree.....	58
incoming call.....	58

making calls.....	58
phone book.....	61
phone book, shortcut.....	61
receiving a call.....	59
register phone.....	54
voice control.....	67

**R**

---

Radio.....	31
DAB.....	31, 40
Radio programme types (PTY).....	37
RDS.....	35
Rear control panel	
audio system.....	27
Rear display screens.....	81
Rear-seat entertainment.....	79
Remote control.....	76
battery replacement.....	78
RSE - Rear Seat Entertainment system.....	79

**S**

---

Sensus.....	7
Signal input, external.....	22, 49

Steering wheel	
keypad.....	22
surround.....	21, 29

**T**

---

Traffic information (TP) .....	36
TV.....	72

**U**

---

USB, connection.....	50
USB input.....	49

**V**

---

Voice control, mobile phone.....	67
Volvo Sensus.....	7

**W**

---

Wireless headphones.....	82
--------------------------	----





