



XC90

QUICK GUIDE WEB EDITION



WELCOME TO THE GLOBAL FAMILY OF VOLVO OWNERS!

Getting to know your new vehicle is an exciting experience. This Quick Guide provides a brief overview of the most common features and functions in your Volvo.

However, for the most up-to-date and detailed descriptions and instructions, as well as important warnings and other information not included in this folder, please refer to your Owner's Manual.

An asterisk (*) indicates optional equipment.



For additional information, contact Customer Service:

U.S.A.: 1-800-458-1552 www.volvocars.us

Canada: 1-800-663-8255 www.volvocars.ca

REMOTE KEY



- LOCK** Locks the doors, fuel filler door, tailgate and arms the alarm.
- UN-LOCK** Unlocks the doors, fuel filler door, and tailgate^A and disarms the alarm.
-  Unlocks (but does not open) the tailgate.
-  Approach lighting illuminates lights in door mirrors, cabin, footwells, license plates. Turn signals and parking lights illuminate.
-  "Panic" alarm.
– Press and hold for approx. 5 seconds to sound the alarm. Turn off alarm by pressing the unlock/lock button twice.

^A Automatic relock occurs if no door/tailgate is opened within 2 minutes after unlock.

The key blade can be used to lock/unlock the glove compartment.

COLD START



NOTE

After cold starts, your engine will idle at a higher speed for a short time to bring the engine to normal operating temperature as quickly as possible, enabling the emission control system to function optimally.

AUTOSTART



Depress the brake pedal. Turn the key to position **III** and release it. The engine will start automatically.

WIPERS AND RAIN SENSOR*

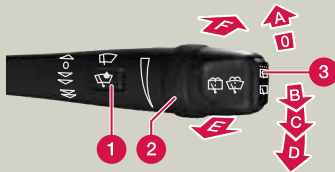

- 1** Rain sensor **On/Off** with the lever in the **0** position.
- 2** Turn to adjust intermittent wiper speed or rain sensor sensitivity where applicable.
- 3** Tailgate wiper – normal/interval.

- A** Single wiper sweep.
- O** Off
- B** Intermittent wipers. Turn (2) to adjust interval.
- C** Normal wiper speed.
- D** High wiper speed.
- E** Windshield and headlight washer.
- F** Tailgate washer.
-  A green LED in button 1 illuminates when the rain sensor is switched on.

LIGHTING PANEL



0 Headlights off. High beam flash only.

Parking lights.

Headlights: turn off when ignition is switched off, high/low beams.

Display & instrument panel lighting.

Fuel filler door unlock.

Press to turn on^A the LED DRL (Daytime Running Lights) function.

Rear fog light (driver's side only).

A → High beam flash.

B → Toggle between high/low beams, home safe lighting.

^A The headlight switch must first be turned to the position.

DRIVER'S DOOR CONTROL PANEL



L R Adjusting the door mirrors. Select **L** or **R**. Adjust with the control.

1 → Open/close a window partially.

2 → Open/close a window fully.

Locks/unlocks all doors, fuel filler door and tailgate.

Lockout switch for rear windows.

PARKING BRAKE



APPLYING THE PARKING BRAKE

1. Press firmly on the brake pedal and then press the parking brake pedal (1).
2. Release the brake pedal. If the vehicle rolls, press the parking brake pedal again.
3. Park – put the gear selector in P.

Releasing the parking brake

1. Press firmly on the brake pedal and then pull the handle (2) – the parking brake pedal will come up.
2. Release the brake pedal.

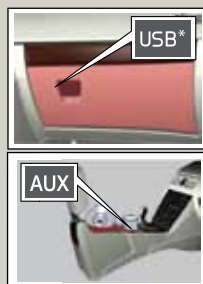
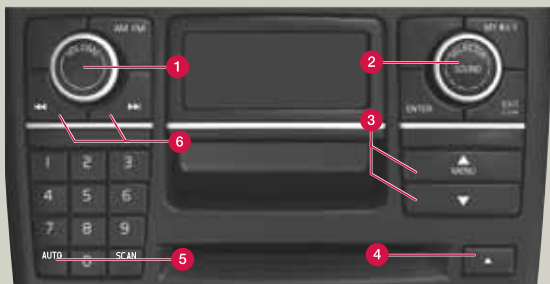

- 1** Press to turn on/off. Turn to adjust volume.
- 2** Sound settings: Press to select e.g., **BASS**, **TREBLE**, etc. – turn to adjust. Sound source: Turn to select e.g., **CD**, SiriusXM™ satellite radio*, Bluetooth® streaming audio or the AUX/USB sockets^A.

CD PLAYER^B

- 3** CD select^C. Press 1–6.
- 4** Press to eject current CD. Press and hold to eject all CDs.^C
- 6** Change tracks.

^A AUX/USB sockets for e.g., mp3 player. Set the devices's volume to medium for best sound quality. An iPod® connected to the USB socket will also be charged.

^B CDs containing files in mp3 and WMA formats can also be played.

^C Optional CD changer only.

RADIO

- 5** Autostore stations by pressing for 2 seconds. **AUTOSTORE** is displayed during the search. The 10 strongest stations are stored. Press **0–9** to select a station.
- 6** Search for stations with left/right arrows. Store up to 20 stations by pressing and holding one of the preset buttons **0–9** in **FM1** and **0–9** in **FM2**, until the stored station is confirmed in the display

HD RADIO

HD radio reception is subject to coverage limitations. See your Owner's Manual for details.

REFUELING



Hang the fuel filler cap on the hook while refueling.

BLIND SPOT INFORMATION SYSTEM (BLIS)*



If the BLIS indicator lights illuminate occasionally even when there are no other vehicles in the blind area, this may be caused by light reflected from a wet road surface, the vehicle's own shadow against a large, light, smooth surface, or sunlight directly in the camera when the sun is low on the horizon.

In the event of a fault, **BLIND SPOT SYST. SERVICE REQUIRED** will be displayed. See the Owner's Manual for other BLIS-related messages.

ELECTRONIC CLIMATE CONTROL (ECC)*

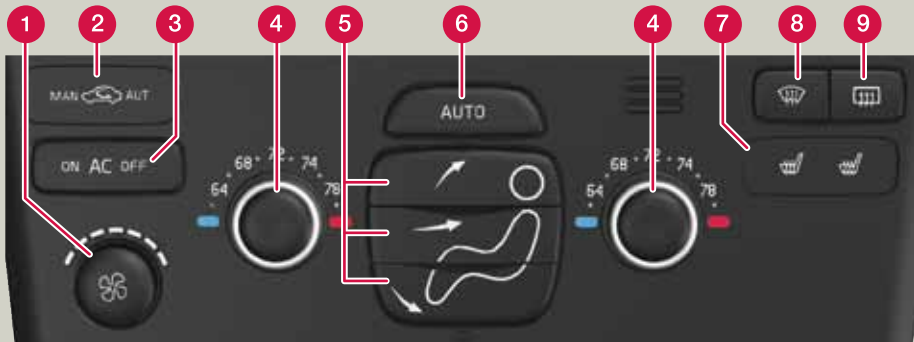

AUTOMATIC CONTROL

In **AUTO** mode, ECC controls all functions automatically and makes driving more pleasant with optimal air quality.

- 4 Turn to individually set the desired temperature on the driver's and passenger's sides. The selected temperature will be shown in the display.
- 6 Press **AUTO** to maintain automatic cabin temperature, balanced airflow and other settings.

MANUAL CONTROL

- 1 **Blower speed.**
- 2 **Recirculation/Interior air quality sensor*** on or off
- 3 **Air conditioning** on or off to cool the cabin and defog the windows.
- 5 **Air distribution.** Direct airflow to the floor, panel vents, windshield, etc.
- 7 **Front seat heating*** on or off.
- 8 **Max. defroster** to quickly defog the windshield and side windows.
- 9 **Heated** rear window and door mirrors. Direct airflow to the floor, panel vents, windshield, etc.

INTEGRATED BOOSTER CUSHION



RAISING

- 1. Pull the handle at the front of the cushion forward.
- 2. Lift the rear edge of the cushion and using both hands, push the cushion rearward and downward until it locks in place. Move the seat belt latch to the side if necessary.

LOWERING

- 1. Pull the handle at the front of the cushion forward.
- 2. Pull the cushion forward and press the center section down until the cushion locks in place.

The booster cushion must be fully pressed down before the backrest can be folded down.

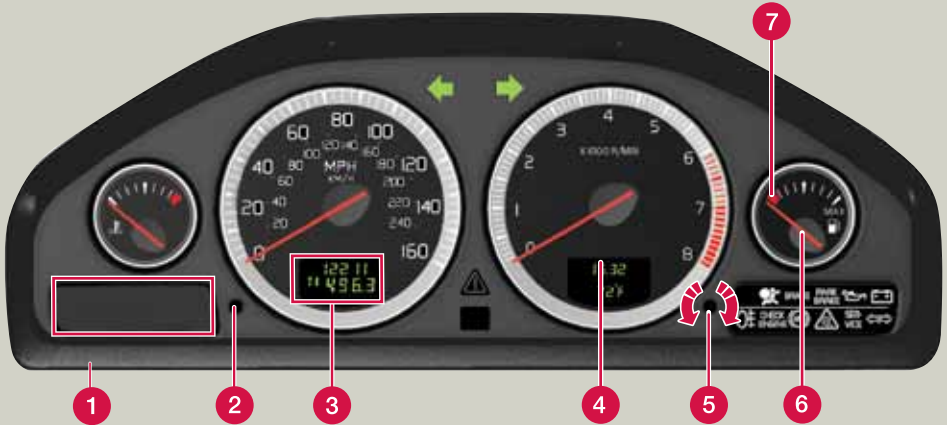

- 1 Trip computer display**, select information with (9).
- 2 A short press** toggles between T1 & T2. **A long press** resets the displayed odometer.
- 3 Display row 1:** Odometer
Display row 2: Two separate trip odometers, T1 & T2.
- 4 Display row 1:** Clock.
Display row 2: Ambient temperature.
- 5 Set the clock:** Turn clockwise/counter-clockwise as far as possible and hold to set the time (4).
- 6 Fuel gauge.**
- 7 Low fuel level indicator**
When the symbol illuminates, refuel as soon as possible.



- 8 Press** to display or erase a message.
- 9 Turn** to show trip computer information alternatives.
- 10 A short press** resets the current function. **A long press** resets all functions.

NOTE

The display text **MILES TO EMPTY TANK** is an approximation, based on recent average fuel consumption.



 **Yellow symbol:** caution - take the action shown in the display.

Red symbol: warning - stop safely **as soon as possible** and take the action shown in the display.

 Low oil pressure, stop safely and check the oil level^A.

BRAKE  Brake failure warning light, stop safely. Check brake fluid level^A.

 DSTC stability system, flashes when the system is working.

^A Have the vehicle towed if the symbol remains illuminated.

ACCESSING THE THIRD ROW OF SEATS



TILTING THE OUTBOARD BACKRESTS IN THE SECOND ROW OF SEATS:

1. Pull up the handle (1), tilt the backrest forward and move the seat forward.
2. To return the seat, pull up the handle (1) and return the backrest to the upright position.

CAR CARE



Hand washing is gentler on the paint than an automatic car wash. Since the paint on a new vehicle may take several months to harden completely, we recommend washing the vehicle by hand during this period. Use clean water, a suitable car washing detergent and a sponge. Keep in mind that dirt or grit on the sponge can scratch the paint.

GROCERY BAG HOLDER



TURN SIGNALS



- A** Lane-change sequence, three flashes.
- B** Full turn sequence.

STEERING WHEEL ADJUSTMENT



WARNING

Never adjust the steering wheel while driving.

TIRE PRESSURE MONITORING SYSTEM (TPMS)

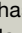

When a low tire pressure warning message (**LOW TIRE PRESS. CHECK TIRES** or **VERY LOW TIRE PRESSURE**) has been displayed and the tire pressure warning light () has illuminated, one or more tires has low inflation pressure.

Check the inflation pressure of all four tires with a tire pressure gauge as soon as possible and pump the tire(s) with low pressure to the recommended inflation pressure.

Refer to the inflation pressure tables in the chapter "Wheels and tires" in the Owner's Manual.

ADJUSTING THE POWER SEAT

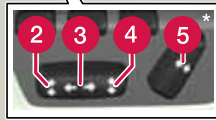

- 1 Adjusts lumbar support.
- 2 Raises/lowers the front edge of the seat cushion.
- 3 Moves the seat forward/rearward.
- 4 Raises/lowers the seat.
- 5 Backrest tilt.

REMOTE KEY AND THE POWER SEAT

Each of the remote keys can be used by different drivers to store the driver's seat position in the following way:

- Adjust the seat to your preferences.
- Lock the vehicle by pressing the lock button on the remote key that you normally use. This stores the seat's current position in that remote key's memory^A.
- Unlock the vehicle (by pressing the unlock button on the **same** remote key) and open the driver's door. The driver's seat will automatically move to the position stored in the remote key (if the seat has been moved since you left it).

^A This setting does not affect the separate power seat memory. Consult your owner's manual for detailed information.

STORAGE SPACES

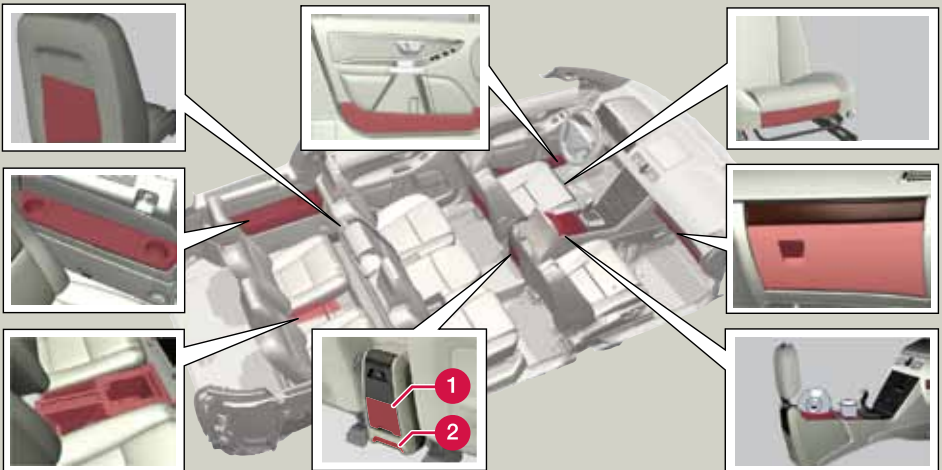

- 1 Rear seat cup holders.
- 2 Control for lifting out the center console (not available on models with the optional Rear Seat Entertainment system).