



**V60 PLUG-IN
HYBRID**





QUICK GUIDE WEB EDITION



WELCOME TO YOUR NEW VOLVO!

This folder contains a selection of the most common functions in your particular car. The owner's manual and other manuals contain important information with all warnings and safety instructions.

The following symbols mean:

-  Different parts are pointed out in the overview images.
-  Instructions step-by-step.
-  It is particularly important to read the owner's manual.
-  Important information, warnings and safety instructions that must be read are listed on the last page.

Options are marked with an asterisk *.

In addition, learn more about your particular car at www.volvocars.com

01 Your hybrid car

- Drive modes
- Charging
- Preconditioning
- Mobile application

02 Starting and driving

- Remote control key
- Starting and switching off the engine
- Parking brake
- Keyless key system*
- Wipers

03 Driver support in your car

- BLIS*
- Pedestrian protection*

04 Your driving environment

- Adjusting the seat
- Adjusting the steering wheel
- Sunroof*

05 Functions in your car

- Climate system controls
- Headlamp control
- Combined instrument panel
- Infotainment system
- Phone*
- External audio device
- Buttons in the centre console
- Settings in the menu system

06 Tips

- Car care
- Opening all windows
- Storage spaces
- AUX/USB* and 12 V sockets



The car is powered by two motors - one electric and one diesel.

Different drive modes can be selected as desired. A "wrong" drive mode cannot be selected - a computer controls and switches to another drive mode if necessary, depending on what is optimal based on the combination of driveability and fuel economy, amongst other things.

1 SAVE

Charges the hybrid battery before an expected need for electric drive, e.g. urban driving. Press **PURE** when urban driving begins.

2 AWD

All-wheel drive is activated. Primarily intended for low speed in slippery driving conditions when better grip and traction are required.

3 POWER

Both the engine and the electric motor drive the car, which has sportier behaviour and faster response to acceleration.

4 HYBRID

This is the car's preset drive mode. Both the engine and the electric motor are used - either individually or in parallel, and a computer determines what is most appropriate in each case.

5 PURE

The car is powered by the electric motor. The diesel engine starts automatically when the battery needs charging.

Where is the charging cable located? 01

The charging cable is located in the storage compartment under the cargo area's floor hatch.



How do I open and close the hatch for the charging input socket? 01

- 1 Press in the rear section of the hatch and release.
- 2 Fold out the hatch.
- 3 Pull away the cover for the charging input socket and secure it to the inside of the hatch.

Close the hatch for the charging input socket in reverse order.



How do I start charging? 01

- 1 Connect the charging cable to the 230 V electrical socket.
- 2 Check that the switch is **ON**.
- 3 Increase/decrease the charging current on the control unit. The higher the current the shorter the charging time.
- 4 Connect the charging cable to the car.

Press the button for Approach lighting on the remote control key - the combined instrument panel then shows the remaining charging time. Charge status indicated via the charging input socket's lamps and the Volvo On Call* mobile app.



How do I stop charging?

01



- 1 Unlock the car with the remote control key.
- 2 Detach the charging cable from the car.
- 3 Detach the charging cable from the 230 V electrical socket.
- 4 Refit the charging cable in the storage space under the cargo area's floor hatch.

How does the control unit for the charging cable work?

01

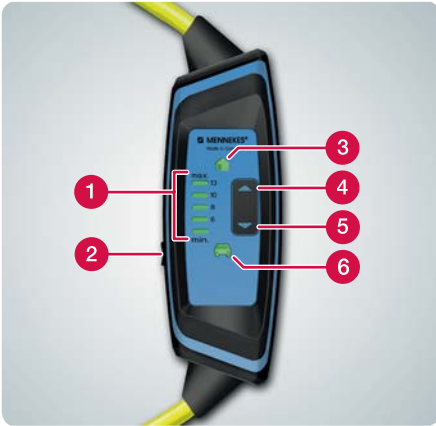

- 1 Illuminated symbol: Indicates selected charging current.
- 2 Switch **ON/OFF**.
- 3 Lit symbol: Cable connected to 230 V.
- 4 Increases the charging current.
- 5 Decreases the charging current.
- 6 Lit symbol: Cable connected to the car.



What do the lamps for the charging input socket show?

01



White constant: Guide light

Yellow constant: Waiting mode

Green short flashes: Charging of low charge battery

Green long flashes: Charging of well-charged battery

Green constant: Charging complete

Blue: Timer switched on

Red: Error



Preconditioning is mainly used to optimise the car's electric drive system prior to a planned departure. The function heats/cools the passenger compartment and is activated via direct start in the combined instrument panel, the remote control key or Volvo On Call* mobile app.

Activate via the combined instrument panel:

- 1 Press **OK** on the left-hand stalk switch.
- 2 Turn the thumbwheel to **Preconditioning** and press **OK**.
- 3 Select between **Direct start**, **Timer**, **Park outside** or **Parking inside** (can only be activated if the car is charged with the charging cable). Confirm with **OK**.

Activating via the remote control key:

- Press the button for approach lighting for approx. 2 seconds. The indicator lamp emits a couple of short flashes followed by a constant glow when preconditioning is active.



For more information on activation via mobile phone, see the Volvo On Call manual*.



What can I do with the Volvo On Call* app?



The Volvo On Call mobile application can be used anytime and anywhere. With a single touch of a button on the mobile phone the car can be located and locked remotely, amongst other things, the combined instrument panel and charge status can be checked, and preconditioning can be set.

The mobile application is updated continuously. For more information, see the Volvo On Call manual*.



How does the remote control key work? 02

- 1 Unlocks the doors and boot lid and disarms the alarm*.
- 2 Locks doors and boot lid and arms the alarm.
- 3 Approach light duration.
- 4 Only unlocks the boot lid.
- 5 Information* about the car.
- 6 Panic function

The remote control key can store settings including door mirrors and driver's seat*.



What do the remote control key indicator lamps* show? 02

- 1 Green light: The car is locked.
 - 2 Yellow light: The car is unlocked.
 - 3 Red light: The alarm has been triggered.
- Flashing alternating red light: Alarm triggered less than 5 minutes ago.



How do I start the engine? 02

Ensure that the charging cable has been removed before starting the car.

- 1 Press the remote control key into the ignition switch.
- 2 Fully depress the brake pedal.
- 3 Briefly press the **START/STOP ENGINE** button and release. The electric motor is running when the figures in the speedometer or tachometer and side gauge are illuminated.





- 1 Briefly press the **START/STOP ENGINE** button - the engine stops. The electric motor is switched off when the digits in the speedometer or tachometer and side gauge have extinguished.
- 2 Take the remote control key out from the ignition switch.

**To apply**

- 1 Depress the foot brake pedal.
- 2 Press the control **PUSH LOCK/PULL RELEASE** - the combined instrument panel's warning symbol starts to flash. Once there is a constant glow the parking brake is applied.
- 3 Release the foot brake pedal.

To disengage

- 1 Depress the foot brake pedal.
- 2 Pull the control **PUSH LOCK/PULL RELEASE**.



The key can remain in your pocket for example the whole time.

Lock and arm the alarm (see illustration)

- Touch the rear section of one of the outer door handles or press lightly on the smaller of the tailgate's two rubberised buttons.

Unlock and disarm the alarm

- Grip a door handle and open the door in the usual way or press lightly on the larger of the tailgate's two rubberised buttons.



How do I start the windscreen wipers and rain sensor*?

02



Move the lever downward to start the windscreen wipers and upward for a single sweep.

- 1 Rain sensor On/Off.
- 2 Regulates the sensor sensitivity or the intermittent delay.
- 3 Wiper, rear window - intermittent/normal.

What does BLIS do*?

03



Blind Spot Information System advises about vehicles in the blind spot and rapidly approaching vehicles.

- BLIS is activated when the engine is started and can be deactivated/reactivated by pressing the button.



How does the pedestrian protection work*?

03



The car has Collision Warning with Auto Brake & Pedestrian Detection, which can warn, brake and/or stop for vehicles and pedestrians.

The function is only an aid and does not work in all situations – for example, it does not see pedestrians who are shorter than 80 cm or who are partially obscured.



It is important to understand this function thoroughly.



- 1 Raise/lower the front of the seat cushion.
- 2 Raise/lower seat.
- 3 Move the seat forward/backward.
- 4 Tilt the backrest.
- 5 Store settings for power seat*.
- 6 Memory buttons for power seat.

Store setting:

Hold the button depressed to store settings while depressing one of the memory buttons.



Seat settings can also be stored in the remote control key*.



- 1 Release the catch.
- 2 Adjust the steering wheel forward/backward and up/down.
- 3 Lock the steering wheel.



How does the sunroof* work?

04



- A Automatic maximum opening.
- B Manual opening.
- C Manual closing.
- D Automatic maximum closing.
- E Opening ventilation position.
- F Closing ventilation position.



How do I regulate the temperature?

05



- 1 Turn for individual temperature in the left/right-hand area of the passenger compartment. The screen shows the selected temperature.
- 2 Press **AUTO** for automatic control of air distribution and other functions. The screen shows **AUTO CLIMATE**.



How do I defrost the windscreen?

05

- 1 Press to activate the windscreen's electric heating* - symbol (1) in the screen illuminates.
- 2 The next press also activates maximum air flow against the windscreen and side windows - symbols (1) and (2) illuminate.
- 3 The next press switches off both of the functions - no symbol illuminates.

Without electric heating: Press to activate/deactivate the air flow.



How does the headlamp control's auto mode work?

05



The daytime running lights automatically switch between daytime running lights and dipped beam. Main beam can be activated when dipped beam is switched on. Active high beam (AHB)* that dims and activates main beam automatically, or adapts the main beam pattern to traffic conditions, can be used. Tunnel detection* is activated.



What functions are shown in the combined instrument panel?

05



- 1 The hybrid battery gauge is shown with the Hybrid theme. Bubbles are shown when the electric motor generates power for the battery.
- 2 Current charging level.
- 3 Active drive mode.
- 4 The symbol is lit when the diesel engine is running.
- 5 Hybrid guide. Shows the limit for the diesel engine starting or stopping. Acceleration (large pointer) in relation to available electric motor output (small pointer).

How is the trip computer operated?

05

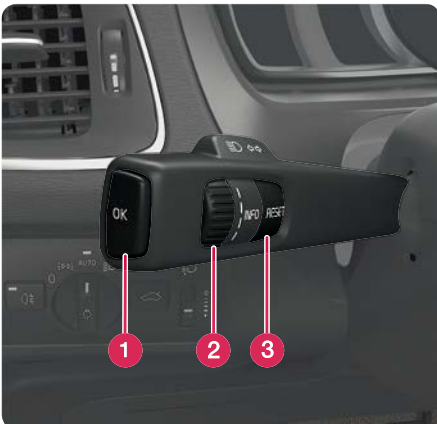

- 1 **OK** opens the trip computer's menu, activates the selected option and extinguishes messages.
- 2 Thumbwheel scrolls between the trip computer options.
- 3 **RESET** resets data in the selected trip computer step and goes back in the menu structure.





How do I reset the trip meter?

05

- 1 Give two presses on the left-hand stalk switch **RESET** button.
- 2 Angle forward trip meter T1 or T2 with the thumbwheel.
- 3 Give a long press on **RESET** to reset to zero.



How does the gear shift indicator work*?

05

The gear shift indicator's arrows advise when it is appropriate to engage a higher or lower gear in order to obtain optimum driving economy. The illustration shows the digital* combined instrument panel.

Analogue combined instrument panel.



How do I change the combined instrument panel's appearance?

05

Different themes can be selected with the digital* combined instrument panel, such as Hybrid or Eco.

To change the theme:

- 1 Press the left-hand stalk switch's **OK** button when the engine is running.
- 2 Turn the lever's thumbwheel in order to select menu option **Themes**.
- 3 Turn the thumbwheel to select a theme and press **OK** to confirm.



The theme is stored in the remote control key*.





How does the range/"km to empty tank" work? 05

The combined instrument panel shows an estimation of the possible driving distance based on previous driving conditions and remaining fuel quantity.

No guaranteed range remains when "...km" is shown. Refuel as soon as possible. The illustration shows the digital* combined instrument panel.



Analogue combined instrument panel.



How do I navigate in the infotainment system? 05

- 1 Press **RADIO**, **MEDIA**, **MY CAR**, **NAV*** or **TEL*** to select main source.
- 2 Press **OK/MENU** or the thumbwheel* in the steering wheel to access the selected source's main menu.
- 3 Turn **TUNE** or the thumbwheel* to navigate in the menus.
- 4 Press **OK/MENU** or the thumbwheel* to make a selection in the menus.

Briefly press **EXIT** to go back in the menu system, cancel a function or delete entered characters.

Give a long press on **EXIT** to go back to normal view, or to go from normal view to the main source view.



Tips:

To go to the shortcut menu in the NAV or TEL mode, press once on **NAV** or **TEL**. Press again to go back to normal view.





How do I switch on and off Infotainment system?

05

- 1 Give a short press to activate the system.
- 2 Give a long press (until the screen switches off) in order to switch off.

To switch off the sound (MUTE): Give a short press - the next press reactivates.



How do I connect a Bluetooth® phone?

05

- 1 Press **TEL*** in the centre console.
- 2 Make the external device searchable/visible via Bluetooth®.
- 3 Press **OK/MENU** and follow the instructions on the screen. The device is now connected and can be controlled from the car.

In future the phone will be connected to the car automatically.

If the connection fails.



How do I make a call?

05

- 1 Press **TEL*** in the centre console.
- 2 Enter the required number or turn the thumbwheel on the steering wheel downward in order to access the phone book, and upward for the call register.
- 3 Press the thumbwheel to dial.

The call is interrupted with a press on **EXIT**.

For more ways to make a call with the phone.





How do I answer the phone*?

05

- Press the thumbwheel to accept incoming calls.

The call is rejected/interrupted with a press on **EXIT**.



For more ways to answer the phone.



How do I connect an external audio device?

05

- 1 Connect an external device via AUX input or USB* port in the centre console.
- 2 Press **MEDIA**.
- 3 Turn **TUNE** to the desired audio source.
- 4 Press **OK/MENU**.



For other connections of an external device.



How do I set a GPS* destination?

05

- 1 Press **NAV** to start the navigation system.
- 2 Press once again on **NAV** and select **Enter address** with **OK/MENU**.
- 3 Enter a search criterion/search criteria using the "daisy wheel" or the centre console's numeric keypad.
- 4 Then select **Set single destination** or **Add as waypoint** and press **OK/MENU**.

For more information and market deviations, see the RTI manual*.



How do I store a function with the FAV button?

05

- 1 Select a main source (e.g. **RADIO**, **MEDIA**).
- 2 Select source (e.g. **AM**, **DISC**).
- 3 Press and hold **FAV** depressed until the "favourites menu" appears.
- 4 Turn **TUNE** to select an option from the list and press **OK/MENU** to save.

When the main source is active, the stored favourite is accessible by means of a short press on **FAV**.



What settings can be made in the menu system?

05

MY CAR handles many of the car's functions, e.g. settings for clock, door mirrors and locks.

See the earlier heading "How do I navigate in the infotainment system?" for which buttons to use.



How do I set the clock?

05

- 1 Navigate to **Settings > System settings > Time** in **MY CAR**.
- 2 Press **OK/MENU** to activate the box for hour. Turn **TUNE** in order to set the hour and press **OK/MENU** to deactivate.
- 3 Turn **TUNE** in order to select the box for minute and press **OK/MENU**. Turn **TUNE** in order to set the minute and press **OK/MENU** to deactivate.
- 4 Turn **TUNE** to select **OK** and press **OK/MENU**.



How should I wash the car??

06

Handwashing is gentler on the paintwork than an automatic car wash. The paintwork is also more sensitive when it is new. For this reason, handwashing is recommended during the first few months with a new car.

Use clean water and a washing sponge. Remember that dirt and grit can scratch the paintwork.



How should I clean the leather upholstery*?

06

Leather requires regular care in order to maintain appearance. For this reason, the leather upholstery should be treated using the Volvo Leather Care kit 1-4 times per year. The Volvo Leather Care kit is available for purchase from a Volvo dealer.



How do I open all windows simultaneously?

06

- Press the remote control key's unlock button for at least 4 seconds to open all windows simultaneously.

Where are the storage spaces located? 06

Shown here are some of the car's storage spaces.



The owner's manual shows the location of more storage spaces.



Where are the AUX/USB* and 12 V sockets located? 06

The remote control key must be at least in key position **I** in order for the 12 V sockets* in the passenger compartment to work. The 12 V socket* in the cargo area is always live.



How do I start charging?



Check that the 230 V socket has adequate power supply for charging electric vehicles. The charging current is adapted via the charging cable's control unit to an intensity (between 6–16 A, depending on market) that is such that the 230 V socket is not overloaded.

How does the control unit for the charging cable work?



Never use an extension cable. Only charge the car from approved sockets. The ground fault breaker in the charging cable's control unit protects the car, but there may be a risk of overloading the 230V mains power circuit.

How do I activate preconditioning?



For Park, outside the fuel-driven heater emits exhaust gases, but not for Parking inside. In the event of direct start of preconditioning, Volvo recommends activation via the remote control key or mobile phone.

How do I start the engine?



After a cold start the idling speed is high irrespective of outside temperature. It is part of Volvo's efficient emissions system. During cold starting, certain diesel engines have a delayed start due to preheating.

When the engine is started under normal conditions the car's electric drive motor is prioritised. The diesel engine remains switched off. However, there are situations where the diesel engine starts instead, e.g. when the temperature is too low or if the hybrid battery needs to be charged.

How does the Keyless* key system work?



The use of gloves may prevent the Keyless function in the door handles.

What does BLIS do*?



BLIS is a supplement - not a substitute for a safe driving style and the use of rearview and door mirrors. BLIS not work in sharp bends. BLIS does not work when the car is reversing.

How does the pedestrian protection work*?



The function cannot detect all pedestrians in all situations and does not see, for example, partially obscured pedestrians, people in clothing that hides their body contour or pedestrians shorter than 80 cm. The driver is always responsible that the vehicle is driven in a correct manner and with a safety distance adapted to the speed.

How do I adjust the seat?



Adjust the driving position of the driver's seat correctly before setting off - never while driving. Make sure that the seat is in locked position in order to prevent personal injury in the event of sudden braking or an accident.

How do I adjust the steering wheel?



Adjust the steering wheel (after adjusting the seat) before setting off - never while driving.

How does the sunroof* work?



Children, other passengers or objects may be trapped by the sunroof's moving parts. Always operate the sunroof with caution. Take the remote control key with you when leaving the car.

How does the range/"km to empty tank" work?



A degree of incorrect indication may occur if the driving style is changed.

How should I clean the leather upholstery*?



Some coloured clothing (e.g. jeans and suede garments) may discolour the upholstery. Never use strong solvents - they could damage the upholstery.

Where are the AUX/USB* and 12 V sockets located?



Maximum current take-off is 10 A (120 W) in each socket.