

SENSUS INFOTAINMENT

VÄLKOMMEN!

We hope you will enjoy many years of driving pleasure in your Volvo. The car has been designed for the safety and comfort of you and your passengers. Volvo is one of the world's safest passenger vehicles. Your Volvo is also designed to meet applicable safety and environmental requirements.

In order to increase your enjoyment of your Volvo, we recommend that you read this supplement as well as the instructions and maintenance information in the owner's manual. The owner's manual is also available as a mobile app (Volvo Manual) and on the Volvo Cars support site (support.volvocars.com).

TABLE OF CONTENTS

INTRODUCTION

Introduction	6
Volvo Sensus	6
Digital owner's manual in the car	7
Change of ownership	10
Volvo Cars support site	10
Volvo ID	11

MY CAR

MY CAR	14
MY CAR - search paths	15
MY CAR - menu options	15
MY CAR - vehicle settings	17
MY CAR - driving support system	19
MY CAR - System options	21
MY CAR - Voice settings	22
MY CAR - Climate settings	22
MY CAR - Internet settings	23
MY CAR Information	24

AUDIO AND MEDIA

Audio and media	26
Audio and media - overview	27
Audio and media - operating the system	28
Symbols in the screen	32
Favourites	33
Audio and media - audio settings	33
Audio and media - general audio settings	34
Audio and media - advanced audio settings*	35
Setting the equaliser	36
Setting the audio volume and automatic volume control	36
Radio	36
Radio tuning	37
Automatic radio tuning	37
Radio station list	38
Manual radio tuning	38
Radio stations as presets	38
Radio Data System functions (RDS)	39
Alarms in the event of accidents and disasters	40
Traffic information (TP)	40
Radio programme types (PTY)	41
Volume control for interrupting RDS-functions	41
Radio text	41

Automatic radio frequency update (AF)	42	Automatic connection of Bluetooth® device	55	Apps	73
Digital radio (DAB)*	42	Changing to another Bluetooth® device	56	Web browser	75
Digital radio (DAB)* - subchannel	42	Disconnecting the Bluetooth® device	56	TV*	77
DAB to DAB* link	43	Removing a Bluetooth® device	57	TV* channels/preset list	79
Media player	43	Bluetooth® handsfree phone	57	TV* - playback options	79
CD/DVD	44	Bluetooth® handsfree phone - overview	58	Information about the current TV* programme	79
Fast forward/reverse	45	Making and receiving calls	59	Teletext*	80
Random playback order of disc tracks or audio files	45	Bluetooth® handsfree phone - audio settings	60	Reception of TV* channel is lost.	80
Media search	45	Phone book	60	Remote control*	80
Playback and navigation of DVD video discs	47	Phone book - quick search for contacts	61	Remote control* - functions	81
Camera angle for playback of DVD video discs	48	Phone book - searching for contacts	61	Remote control* - battery replacement	82
Picture settings	48	Voice recognition	63	Audio and media - menu overview	83
Hard disk drive (HDD)	48	Language options for voice recognition	64	Menu overview - AM	84
Media player - compatible file formats	49	Help functions for voice recognition	64	Menu overview - FM	84
External audio source via AUX/USB input	50	Voice recognition - settings	65	Menu overview - Digital radio (DAB)*	85
Connecting an external audio source via AUX/USB input	52	Voice recognition - voice commands	65	Menu overview - CD/DVD Audio	85
Setting the audio volume for external audio source	52	Voice recognition - quick commands	66	Menu overview - DVD Video	86
Media Bluetooth®	53	Voice recognition - mobile phone	66	Menu overview - hard disk drive (HDD)	87
Connecting and disconnecting a Bluetooth® device	53	Voice recognition - radio	67	Menu overview - iPod®	87
Registering a Bluetooth® device	54	Voice recognition - multimedia	68	Menu overview - USB	88
		Internet-connected car	69	Menu overview - Media Bluetooth®	88
		Car modem*	71	Menu overview - AUX	89
				Menu overview - Bluetooth® handsfree	89

Menu overview - web browser	90
Menu overview - TV*	91
Licenses - audio and media	92
Type approval - audio and media	95

INTERNET MAP

Internet map	98
Internet map - operation	98
Internet map - character wheel and keyboard	99
Internet map - text and symbols on the screen	100
Internet map - scroll menu	101
Internet map - enter destination	102
Internet map - points of interest (POI) symbols	104
Internet map - detailed route information	105
Internet map - route overview	106
Internet map - route options	106
Internet map - map options	107

ALPHABETICAL INDEX

Alphabetical Index	109
--------------------	-----

INTRODUCTION

Introduction

This supplement is a supplement to the normal owner's manual for the car.

In the event of uncertainty regarding any of the car's functions, consult the owner's manual in the first instance. For answers to additional questions it is recommended to contact a dealer or a representative of Volvo Car Corporation.

The specifications, design features and illustrations in this supplement are not binding. We reserve the right to make modifications without prior notice.

© Volvo Car Corporation

Options/accessories

All types of option/accessory are marked with an asterisk: *.

In addition to standard equipment, the supplement also describes options (factory fitted equipment) and certain accessories (retrofitted extra equipment).

The equipment described in the supplement is not available in all cars - they have different equipment depending on adaptations for the needs of different markets and national or local laws and regulations.

In the event of uncertainty over what is standard or an option/accessory, contact a Volvo dealer.

Owner's Manual in mobile devices



i NOTE

The Owner's manual is available for download as a mobile application (applies for certain car models and mobile devices), see www.volvocars.com.

The mobile application also includes video and searchable content and easy navigation between different sections.

Volvo Sensus

Volvo Sensus is the heart of the personal Volvo experience and connects you with the car and outside world. Sensus provides information, entertainment and assistance when it is needed. Sensus consists of intuitive functions that both enhance the car journey and simplifies ownership of the car.



An intuitive navigation structure makes it possible to receive relevant support, information and entertainment when it is necessary, without distracting the driver.

Sensus covers all the car's solutions that enable connection* to the outside world and provides you with intuitive control over all the car's capabilities.

Volvo Sensus combines and presents many functions in several of the car's systems on the centre console's screen. With Volvo Sensus the car can be personalised by means of an intuitive user

interface. Settings can be made in Car settings, Audio and media, Climate control, etc.

With the centre console buttons and controls or the steering wheel's right-hand keypad* functions can be activated or deactivated and many different settings can be made.

With a press on **MY CAR** all settings related to the driving and control of the car are presented, such as City Safety, locks and alarm, automatic fan speed, setting the clock, etc.

With a press on the respective function **RADIO**, **MEDIA**, **TEL***, **NAV*** and **CAM**¹ other sources, systems and functions can be activated, e.g. AM, FM, CD, DVD*, TV*, Bluetooth®*, navigation* and park assist camera*.

For more information about all functions/ systems, see the relevant section in the owner's manual or its supplement.

Overview

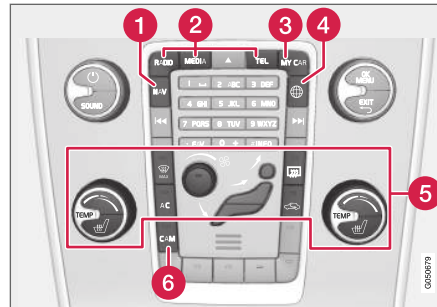

Control panel in centre console. The figure is schematic - the number of functions and layout of the buttons both vary, depending on the equipment selected and the market.

- 1 Navigation* - **NAV**, see separate supplement (Sensus Navigation).
- 2 Audio and media - **RADIO**, **MEDIA**, **TEL***, see the relevant section in this supplement.
- 3 Function settings - **MY CAR**, see MY CAR (p. 14).
- 4 Internet-connected car - **NAV***, see the respective section in this supplement².
- 5 Climate control system, see the Owner's Manual.
- 6 Park assist camera - **CAM**¹, see the Owner's Manual.

Digital owner's manual in the car

The owner's manual can be read on the screen in the car³. The content is searchable and it is easy to navigate between different sections.

Open the digital owner's manual - press the **MY CAR** button in the centre console, press **OK/MENU** and select **Owner's manual**.

For basic navigation, see Operating the system. See below for a more detailed description.



Owner's manual, start page.

There are four options for finding information in the digital owner's manual:

¹ Applies to certain car models.

² Information only available if the car is equipped with this function.

INTRODUCTION

- ◀ • **Search** - Search function for finding an article.
- **Categories** - All articles sorted into categories.
- **Favourites** - Quick access to favourite-bookmarked articles.
- **Quick Guide** - A selection of articles for common functions.

Select the information symbol in the lower right-hand corner in order to obtain information about the digital owner's manual.

i NOTE

The digital owner's manual is not available while driving.

Search

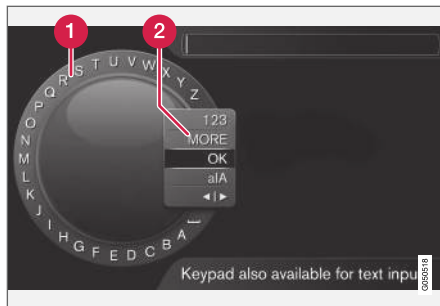

Searching using the character wheel.

- 1** Character list.
- 2** Changing the input mode (see following table).

Use the character wheel to enter a search term, e.g. "seatbelt".

1. Turn **TUNE** to the desired letter, press **OK/MENU** to confirm. The number and letter buttons on the control panel in the centre console can also be used.
2. Continue with the next letter and so on.

3. To change the input mode to numbers or special characters, or to perform a search, turn **TUNE** to one of the options (see explanation in the following table) in the list for changing the input mode (2), press **OK/MENU**.

123/ABC	Change between letters and numbers with OK/MENU .
MORE	Change to special characters with OK/MENU .
OK	Perform the search. Turn TUNE to select a search result article, press OK/MENU to go to the article.
a A	Changes between lowercase and uppercase letters with OK/MENU .
◀ ▶	Changes from the character wheel to the search field. Move the cursor with TUNE . Delete any misspelling with EXIT . To return to the character wheel, press OK/MENU . Note that the digit and letter buttons on the control panel can be used for editing in the search field.

³ Applies to certain car models.

Enter with the numerical keyboard



Numerical keyboard.

Another way of entering characters is to use the centre console's buttons **0-9**, ***** and **#**.



When e.g. **9** is pressed, a bar appears with all characters⁴ under the button, e.g. **W**, **x**, **y**, **z** and **9**. Quick presses on the button move the cursor through these characters.

- Stop with the cursor on the desired character in order to select it - the character is shown on the enter line.
- Delete/undo using **EXIT**.

To enter a number, hold in the corresponding number key.

Categories

The articles in the owner's manual are structured into main categories and subcategories. The same article can be in several appropriate categories in order to be found more easily.

Turn **TUNE** to navigate in the category tree and press **OK/MENU** to open a category - selected  - or article - selected . Press **EXIT** to go back to the previous view.

Favourites

Located here are the articles that are saved as favourites. To select an article as a favourite, see the heading "Navigating in an article" below.

Turn **TUNE** to navigate in the favourite list and press **OK/MENU** to open an article. Press **EXIT** to go back to the previous view.

Quick Guide

Located here is a selection of articles for getting to know the car's most common functions. The articles can also be accessed via categories, but are collected here for quick access.

Turn **TUNE** to navigate in the Quick Guide and press **OK/MENU** to open an article. Press **EXIT** to go back to the previous view.

Navigating in an article

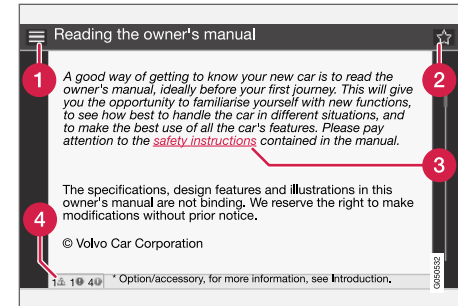

- 1 Home** - leads to the start page for the owner's manual.
- 2 Favourite** - adds/removes an article as a favourite. You can also press the **FAV** button in the centre console to add/remove an article as a favourite.
- 3 Highlighted link** - leads to linked article.
- 4 Special texts** - if the article contains warnings, important or note texts then an associated symbol is shown here as well as the number of such texts in the article.

Turn **TUNE** to navigate between the links or scroll in an article. When the screen has scrolled to the start/end of an article the home and favourite options are accessed by scrolling a further step up/down. Press **OK/MENU** to activate

⁴ The character for each button may vary depending on market/country/language.

- ◀◀ the selection/highlighted link. Press **EXIT** to go back to the previous view.

Related information

- Volvo Cars support site (p. 10)

Change of ownership

In the event of change of ownership it is important to reset all user data and system settings to the original factory settings.

To restore factory settings press **MY CAR** in the centre console, then **OK/MENU** and select **Settings → Reset to factory settings**.

User data is reset (e.g. for apps, web browser) and personal settings in menus (for example climate settings, vehicle settings) receive the original factory settings.

For cars with Volvo On Call* the personal settings stored in the car are cleared. To unsubscribe from the Volvo On Call subscription, see Buying or selling a car with Volvo On Call.

Related information

- MY CAR - menu options (p. 15)
- Volvo ID (p. 11)

Volvo Cars support site

More information on your car is available on the Volvo Cars website and support site.

Support on the Internet

Go to support.volvocars.com or use the QR code below to visit the page. The support page is available for most markets.



QR code that leads to the support page.

The information on the support page is searchable and can also be subdivided into different categories. Available here is support for options related to e.g. Internet connected services and functions, Volvo On Call*, the navigation system* and apps. Video and step-by-step instructions explain different procedures, e.g. how the car is connected to the Internet via a mobile phone.

Downloadable information from the support page

Maps

For cars equipped with Sensus Navigation*, there is the facility to download maps from the support page.

Apps

For selected Volvo models from model year 2014 and 2015, the owner's manual is available in the form of an app. The Volvo On Call* app can also be accessed from here.

Owner's manuals from previous model years

Owner's manuals from previous model years are available here in PDF format. The Quick Guide and supplement can also be accessed from the support page. Select car model and model year in order to download the publication required.

Contact

On the support page there is contact information for customer support and the nearest Volvo dealer.

Log in to the Volvo Cars website

Create a personal Volvo ID and log in to www.volvocars.com. Once you are logged in you can get an overview of service, agreements and warranties, amongst other things. There is also information here about accessories and software adapted for your car model.

Volvo ID

Volvo ID provides access to a wide range of personalized Volvo services⁵ online.

Examples of services:

- In an Internet-connected car* - Certain functions and services require that you have registered your car to a personal Volvo ID, for example to be able to send a new address from a map service on the Internet directly to the car.
- Volvo On Call* - Volvo ID is used when logging in to the Volvo On Call app.

Advantages of Volvo ID

- One user name and one password to access online services, i.e. only one username and one password to remember.
- When changing the username/password for a service (e.g. Volvo On Call) it will also be changed automatically for other services.

Create a Volvo ID

To create a Volvo ID you need to enter a personal e-mail address. Then follow the instructions in the e-mail message that is automatically sent to the specified address in order to complete the registration. It is possible to create a Volvo ID via one of the following services:

- Volvo Cars website - Go to www.volvocars.com and log in⁶ at the icon, top right. Select Create Volvo ID.
- For an Internet-connected car* - Enter your e-mail address in the app that requires Volvo ID and follow the instructions. Alternatively, press the Connect button  in the centre console twice and select **Apps → Settings** and follow the instructions.
- Volvo On Call* - Download the latest version of the Volvo On Call app. Choose to create a Volvo ID from the start page, enter e-mail address and follow the instructions.

Related information

- Volvo Cars support site (p. 10)
- Apps (p. 73)
- Internet-connected car (p. 69)
- Change of ownership (p. 10)

⁵ The services available may vary over time and vary depending on equipment level and market.

⁶ Available in certain markets.

MY CAR

MY CAR

MY CAR is a menu source that handles many of the car's functions, e.g. City Safety™, locks and alarm, automatic fan speed, setting the clock, etc.

Certain functions are standard, others are optional - the range also varies depending on the market.

Operation

Navigation in the menus is carried out using buttons in the centre console or with the steering wheel's right-hand keypad*.

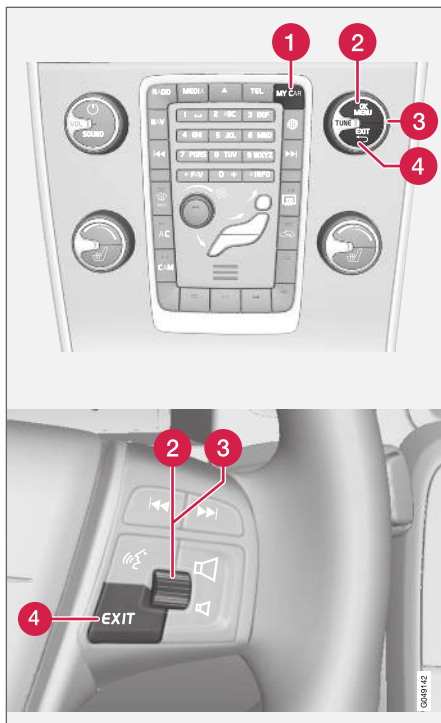

Control panel in centre console and steering wheel keypad. The figure is schematic - the number of functions

and layout of the buttons both vary, depending on the equipment selected and the market.

- 1 **MY CAR** - opens the menu system MY CAR.
- 2 **OK/MENU** - press the button in the centre console or the thumbwheel on the steering wheel to select/tick in the highlighted menu option or store the selected function in the memory.
- 3 **TUNE** - turn the knob in the centre console or the thumbwheel on the steering wheel to scroll up/down through the menu options.
- 4 **EXIT**

EXIT functions

Depending on the function the cursor is on when **EXIT** is depressed briefly, and on which menu level, one of the following may occur:

- phone call is rejected
- current function is interrupted
- input characters are deleted
- most recent selections are undone
- leads up in the menu system.

A long press on **EXIT** leads to the normal view for MY CAR or if you are in the normal view, to the highest menu level (main source menu).

MY CAR - search paths

MY CAR is a menu source that handles many of the car's functions, e.g. setting the clock, door mirrors and locks.

Current menu level is shown at the top of the centre console's screen. The search paths to the menu system's functions are specified on the form:

Settings → Vehicle settings → Lock settings → Doors unlock → Driver door, then all.

The following is an example of how a function can be accessed and adjusted using the steering wheel keypad:

1. Press the centre console button **MY CAR**.
2. Press the thumbwheel.
3. Scroll to the desired menu, e.g. **Settings**, with the thumbwheel and then press the thumbwheel - a submenu opens.
4. Scroll to the desired menu, e.g. **Vehicle settings** and press the thumbwheel - a submenu opens.
5. Scroll to **Lock settings** and press the thumbwheel - a new submenu opens.
6. Scroll to **Doors unlock** and press the thumbwheel - a drop-down menu containing selectable options opens.

7. Scroll between the options **All doors** and **Driver door, then all** with the thumbwheel and press the thumbwheel - the option is selected.
8. Exit the programming by backing out of the menus incrementally with short presses on **EXIT** or with one long press.

The procedure is the same for the centre console controls (p. 14): **OK/MENU**, **EXIT** and the **TUNE** knob.

Related information

- MY CAR (p. 14)
- MY CAR - menu options (p. 15)

MY CAR - menu options

MY CAR is a menu source where many of the car's functions can be handled, e.g. setting the clock, door mirrors and locks.



Example of normal view for MY CAR.

Press **MY CAR** in the centre console to go to normal view for MY CAR. Normal view shows the status of some of the car's driver support systems in the upper part of the screen along with the status of the Start/Stop* function in the lower part of the screen.

Pressing **OK/MENU** accesses the menu source **My Car** where the following options are available:

- **My S60¹**
- **Trip statistics**

¹ Depending on car model.

- ◀ ● **Drive-E²/Hybrid³**
- **Tyre pressure**
- **Settings**
- **Service & repair**
- **Owner's manual**

My S60¹

My Car → My S60¹

The screen shows a grouping of all of the car's driver support systems - these can be activated or deactivated here.

Trip statistics

My Car → Trip statistics

The screen shows the history as a bar chart with average consumption of electricity³ and fuel.

Drive-E²

My Car → Drive-E

Parts of the Volvo Drive-E concept are described here, among other things. Select from among the following headings:

- **Start/Stop**
Here there is information about the Start/Stop function.
- **ECO driving guide**

Tips, advice and a description of what it means to drive economically can be found here.

Hybrid³

My Car → Hybrid

Information on the car's drive system is found here. Select from among the following headings:

- **Power flow**
The screen shows whether the motor or engine is driving the car and how the motive force is flowing.
- **Driving modes**
The car's different drive modes are explained.
- **ECO driving guide**
Tips, advice and a description of what it means to drive economically can be found here.

Tyre pressure

My Car → Tyre pressure

The screen shows information about the car's tyre pressure monitoring - the system can be activated or deactivated here.

Settings

My Car → Settings

The menus are structured as follows:

Menu level 1

Menu level 2

Menu level 3

Menu level 4

Shown here are the 4 first menu levels under **Settings**. Certain functions are standard, others are optional - the range also varies depending on the market.

When selecting whether a function should be activated/**On** or deactivated/**Off** a square is displayed:

On: Selected square.

Off: Empty square.

- Select **On/Off** with **OK** - then back out of the menu with **EXIT**.

² Applies to the V40, V40 Cross Country, S60, S60L, V60, V60 Cross Country, XC60.

³ Applies to the V60 Twin Engine and S60L Twin Engine.

¹ Depending on car model.

Menus under settings

- **Vehicle settings**, see MY CAR - vehicle settings (p. 17)
- **Driver support system**, see MY CAR - driving support system (p. 19)
- **System options**, see MY CAR - System options (p. 21)
- **Voice control settings**, see MY CAR - Voice settings (p. 22)
- **Climate settings**, see MY CAR - Climate settings (p. 22)
- **Internet settings**, see MY CAR - Internet settings (p. 23)
- **Volvo On Call**, see digital owner's manual.
- **FAV key options** - link a normally used function in MY CAR to **FAV** button, see Favourites (p. 33)
- **Information**, see MY CAR Information (p. 24)
- **Reset to factory settings** - all user data is reset and all settings in all menus receive the factory settings.

Service and repair

My Car → Service & repair

Here there is service and workshop information for the car as well as information about booked service appointments.

Owner's manual

My Car → Owner's manual

The screen shows the digital owner's manual (p. 7).

Related information

- MY CAR (p. 14)
- MY CAR - search paths (p. 15)

MY CAR - vehicle settings

The vehicle settings menu option in the MY CAR menu source handles many of the car's functions, e.g. car key memory and lock settings for doors.

Vehicle settings

Car key memory

On

Off

Lock settings

Automatic door locking

On

Off

Doors unlock

All doors

Driver door, then all



Keyless entry unlock	Ask when exiting	Approach light duration
All doors unlock	On	Off
Any door	Off	30 sec
Doors on same side		60 sec
Both front doors	Side mirror settings	90 sec
Audible confirmation	Fold mirrors when locking	Home safe light duration
On	On	Off
Off	Off	30 sec
Door lock confirmation light	Tilt left mirror on reverse gear	60 sec
On	On	90 sec
Off	Off	Triple indicator
Unlock confirmation light	Tilt right mirror on reverse gear	On
On	On	Off
Off	Light settings	Daytime running lights
Reduced Guard	Interior light	On
Activate reduced guard	Floor lights	Off
On	Ambiance lights	
Off	Ambiance colours	

Temporary LH traffic

On

Off

or

Temporary RH traffic

On

Off

Active bending lights

On

Off

Auxiliary Lights

On

Off

Active main beam

On

Off

Cornering lights

On

Off

Tyre pressure

Tyre monitor

Calibrate tyre pressure

Tyre monitoring

On

Off

Steering force level

Low

Medium

High

Speed in infotainment display

On

Off

Reset vehicle settings

All menus in **Vehicle settings** are given original factory settings.

Related information

- MY CAR (p. 14)
- MY CAR - menu options (p. 15)

MY CAR - driving support system

Driving support systems menu option in the MY CAR menu source handles functions such as e.g. Collision warning system and Lane keeping aid.

Driver support system

Collision warning

Collision warning

On

Off

Warning distance

Short

Normal

Long

Warning sound

On

Off

Lane Departure Warning



Lane Departure Warning

On
Off

On at startup

On
Off

Increased sensitivity

On
Off

Lane Keeping Aid

Lane Keeping Aid

On
Off

Assistance mode

Full function
Steering assist only
Vibration only

Road sign information

Road sign information

On
Off

Speed alert

On
Off

ESC OFF

On
Off

City Safety

On
Off

BLIS

On
Off

Distance alert

On
Off

Driver Alert

On
Off

Related information

- MY CAR (p. 14)
- MY CAR - menu options (p. 15)

MY CAR - System options

The system settings menu option in the MY CAR menu source handles functions such as e.g. time and languages.

System options

Time settings

The combined instrument panel's clock is adjusted here.

24 hour clock

On

Off

Summer time

Auto

On

Off

Auto time

On

Off

Location

Language

Selects language for texts in the screen and the combined instrument panel.

Language: Driver display

Selects language for texts in the combined instrument panel.

Distance and fuel units

MPG(US)

MPG(UK)

km/l

l/100km

Temperature unit

Celsius

Fahrenheit

Selects the unit for the display of outside temperature and setting of the climate control system.

Screen saver

On

Off

The screen's current content fades out after a period of inactivity and is replaced by a blank screen if this option is selected.

The current screen content returns if any of the screen's buttons or controls are actuated.

Show help text

On

Off

Explanatory text for the screen's current content is shown with this option selected.

Reset system options

All menus in **System options** are given original factory settings.

Related information

- MY CAR (p. 14)
- MY CAR - menu options (p. 15)

MY CAR - Voice settings

The voice settings menu option in the MY CAR menu source manages functions such as voice tutorial and command list for voice recognition.

Voice control settings	See
Tutorial	(p. 64)
Command list Global commands Navigation commands Radio commands Media commands Phone commands Navigation commands only applies if Volvo's navigation system* is installed.	(p. 66)
User setting Default Trained user	(p. 65)

Speaker adaptation	(p. 64)
Read out speed Fast Medium Slow	(p. 65)

Related information

- MY CAR (p. 14)
- MY CAR - menu options (p. 15)

MY CAR - Climate settings

Climate settings menu option in the MY CAR menu source handles functions such as e.g. fan adjustment and recirculation.

Climate settings
Auto fan Normal High Low
Recirculation timeout On Off
Auto rear defrost On Off
Auto driver seat heater On Off
Auto steering wheel heater On Off

Interior air quality system

- On
- Off

Reset climate settings

All menus in **Climate settings** are given original factory settings.

Related information

- MY CAR (p. 14)
- MY CAR - menu options (p. 15)

MY CAR - Internet settings

The Internet settings menu option in the MY CAR menu source handles functions such as e.g. Bluetooth® and Wi-Fi.

Internet settings	See
Connect through	(p. 69), (p. 71), (p. 54) and (p. 69)
Car modem	
Bluetooth	
Wi-Fi	
None	
Car modem	(p. 71)
Data usage	
Network operator	
Data roaming	
Lock SIM card	
Change SIM card PIN	
Access Point Name	
Bluetooth	(p. 54)
Wi-Fi	(p. 69)
Car Wi-Fi hotspot	(p. 71)

Car Wi-Fi hotspot

- On
- Off

Name

Password

Related information

- MY CAR (p. 14)
- MY CAR - menu options (p. 15)

MY CAR Information

Information menu option in the MY CAR menu source handles functions such as Number of keys and VIN number.

Information

Number of keys

VIN number

Related information

- MY CAR (p. 14)
- MY CAR - menu options (p. 15)

AUDIO AND MEDIA

Audio and media

The audio and media system consists of radio (p. 36), media player (p. 43), TV* (p. 77) and the option to communicate with the mobile phone (p. 57), which in some cases can be controlled with voice recognition (p. 63). It is possible to connect the car to the Internet (p. 69) to e.g. stream audio via apps (p. 73).

Information is presented on a 7-inch screen in the upper section of the centre console. Functions can be controlled via buttons in the steering wheel, in the centre console below the screen or via remote control* (p. 80). The number of speakers and amplifiers depends on which audio system the car is equipped with.



If the audio and media system is active when the engine is switched off then it is automatically activated the next time the key is inserted into key position I or higher, and it continues with the

same source (e.g. radio) as before the engine was switched off (the driver's door must be closed on cars with Keyless systems*).

The audio and media system can be used for 15 minutes at a time without the remote control key being in the ignition switch by pressing the On/Off button.

When the car is being started the audio and media system is temporarily switched off and continues when the engine has started.

i NOTE

Remove the remote control key from the ignition switch if the audio and media system is being used when the engine is switched off. This is to avoid discharging the battery unnecessarily.

Gracenote®



Gracenote, Gracenote logo and logotype, "Powered by Gracenote" and Gracenote MusicID

are either registered trademarks or trademarks of Gracenote, Inc. in the USA and/or other countries.

Dolby Digital, Dolby Pro Logic*



Made under license from Dolby Laboratories. Dolby, Pro Logic, MLP Lossless and the double-D symbol are trademarks of Dolby Laboratories.

Dirac Live



Dirac Live technology has been used in the development and tuning of the sound in order to ensure a world-class sound experience. Dirac

Live and the D-symbol are registered trademarks of Dirac Research AB.

Related information

- Audio and media - audio settings (p. 33)

Audio and media - overview

Overview of the audio and media system's different parts.

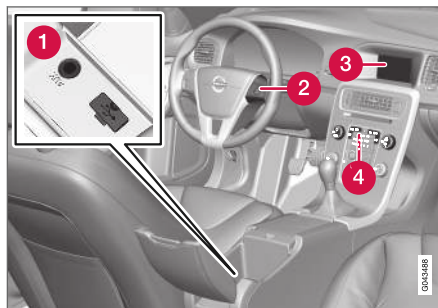

- 1 AUX and USB inputs¹ for external audio sources (p. 50) (e.g. iPod®).
- 2 Steering wheel keypad.
- 3 7-inch screen. The appearance in the screen can be changed and follows the combined instrument panel's settings, see the owner's manual.
- 4 Centre console control panel.

¹ AUX only applies to certain models.

Audio and media - operating the system

The audio and media system is controlled from the centre console, with steering wheel buttons, voice recognition (p. 63) or remote control* (p. 80). The information is presented on the screen in the upper section of the centre console.

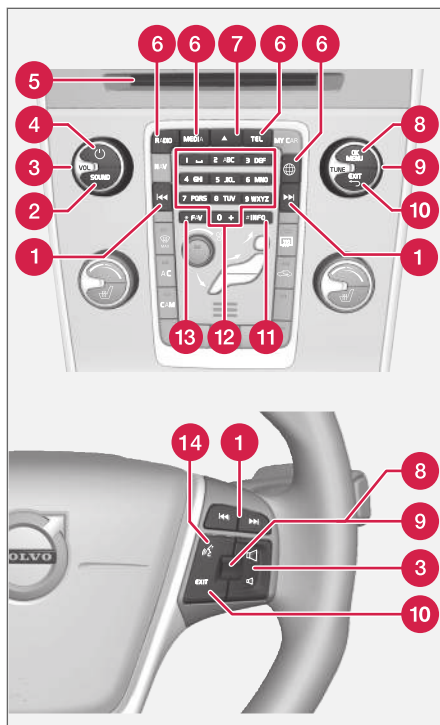

1 Scroll/fast wind/search – Short press scrolls between disc tracks, preset radio sta-

tions² or chapter³. A **long press** fast-winds disc tracks or searches for the next available radio station.

- 2** **SOUND** - press for access to audio settings (bass, treble, etc.). For more information, see general audio settings (p. 34).
- 3** **VOL** - raise or lower the volume.
- 4** **ON/OFF/MUTE** – **short press** starts the system and **long press** (until the screen is off) switches off. Note that the whole of the Sensus system (including navigation* and phone functions) starts/switches off at the same time. Briefly press to mute the sound (MUTE) or restore the sound if it had been switched off.
- 5** Disc insert and eject slot.
- 6** **Main sources** – press to select the main source (e.g. **RADIO**, **MEDIA**). Last active source is shown (e.g. **FM** for radio). If you are in a source and press the main source button, a shortcut menu is shown.
- 7** **▲** - disc eject. A disc remains in the ejected position for about 12 seconds, after which it is inserted back into the player for safety reasons.
- 8** **OK/MENU** - press the thumbwheel in the steering wheel or the button in the centre

² Does not apply to DAB (Digital Audio Broadcasting).

³ Only applies to DVD discs.

console to accept selections in menus. If you are in the normal view and press **OK/MENU** a menu is shown for the selected source (e.g. **RADIO** or **MEDIA**). Arrow to the right of the screen is shown when there are underlying menus.

9 TUNE - turn the thumbwheel in the steering wheel or the knob in the centre console to scroll between disc tracks/folders, radio and

TV* stations, phone contacts or navigate between the options on the display screen.

- 10 EXIT** – **short press** leads upwards in the menu system, interrupts current function, interrupts/rejects phone calls or erases entered characters. A **long press** leads to the normal view or if already in the normal view, to the highest menu level (main source menu) which is the same as the main source buttons in the centre console (6).
- 11 INFO** - If more information than can be shown on the screen is available, press the

INFO button to see the remaining information.

- 12 Preset buttons** – input of numbers and letters.
- 13 FAV** - in certain sources it is possible to link a function to the **FAV** button. A linked function is then activated simply by pressing the **FAV** button, see Favourites (p. 33).
- 14 Voice recognition** – press to activate voice recognition.



◀ Menus

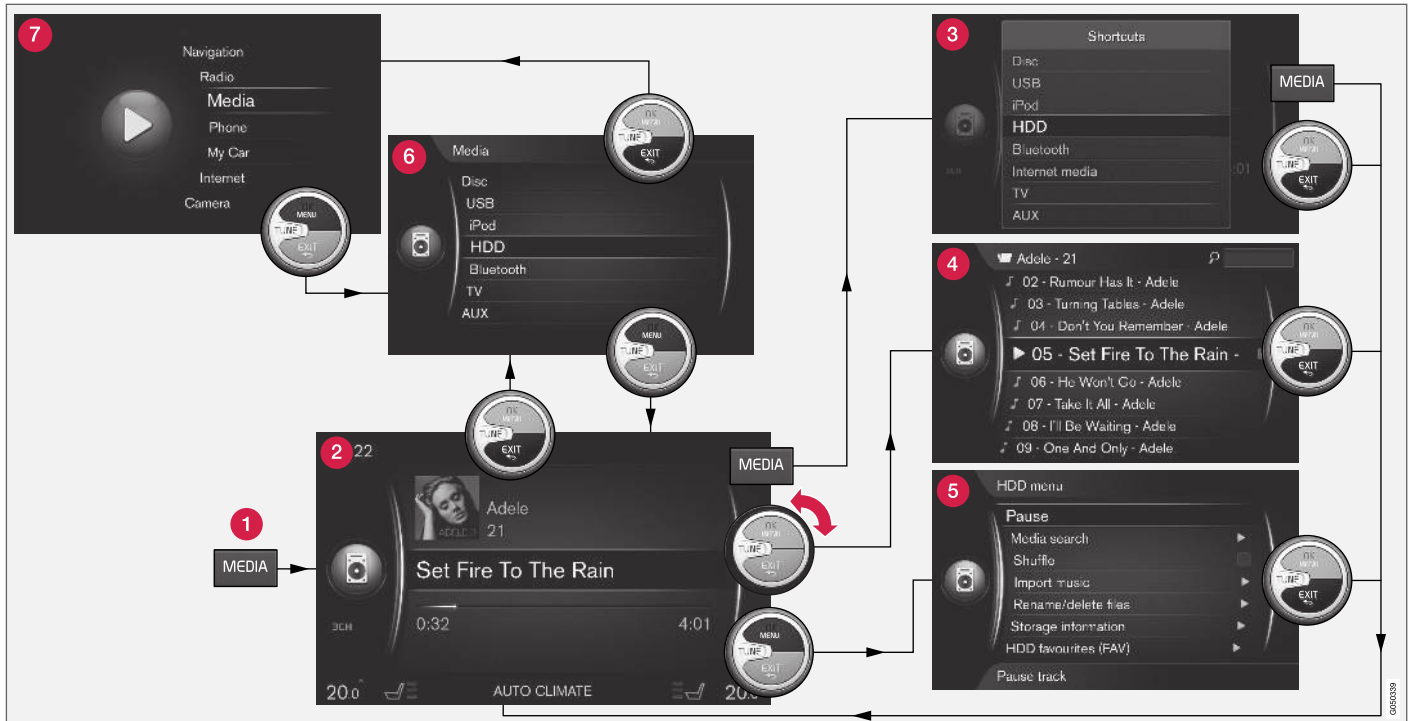

The example shows navigation to different functions when the media is played from the car's hard disc drive.

- 1 **Main source button** – press to change the main source or to show the shortcut menu in the active source.
- 2 **Normal view** – normal mode for the source.
- 3 **Shortcut menu** – shows frequent menu selections.
- 4 **Quick menu** – fast mode when **TUNE** is turned, e.g. for changing disc tracks, radio station, etc.
- 5 **Source menu** – functions and settings in the active source.
- 6 **Source selection menu⁴** – shows the sources that can be selected.
- 7 **Main source menu** – displays main sources, which can also be selected with the main source keypad (1).

Appearance depends on source, equipment in the car, settings, etc.

Select main source by pressing a main source button (1) (e.g. **RADIO, MEDIA**). To navigate through the source menus, use the controls **TUNE, OK/MENU, EXIT** or the main source button (1).

If the text in a menu bar is light grey then it is not possible to select this option. This may be because the function is not available in the car, that the source is not active or connected, or does not contain anything.

For available functions, see Audio and media - menu overview (p. 83).

⁴ Only available in those main sources that have several sources.

Symbols in the screen

Overview of the symbols that can be shown in the screen's activity/status field.

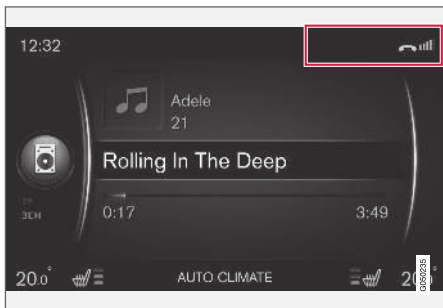

Activity/status field.

The activity/status field shows what the ongoing activities are, and in some cases their status. Not all activity/status symbols are shown all the time due to the limited space in the field.

Symbol	Specification
	Connects to the Internet via Bluetooth®.
	Connected to the Internet via Bluetooth®.
	Not connected to the Internet via Bluetooth®.

Symbol	Specification
	Connects to the Internet via Wi-Fi.
	Connected to the Internet via Wi-Fi.
	Not connected to the Internet via Wi-Fi.
	Connects to the Internet via car modem* ^A . The bars show the signal strength in the mobile phone network and the type of connection is shown below the bars.
	Connects to the Internet via car modem* ^A .
	Not connected to the Internet via car modem* ^A .
	Car modem* ^A connected to the Internet via roaming (for use within networks abroad).
	The symbol is shown when the car's location is transmitted.
	Phone connected to the car.

Symbol	Specification
	Missed call.
	Call in progress.
	Unread text message.
	Microphone switched off.
	Audio muted (MUTE).
	SOS service* ^A active.
	ON CALL service* ^A active.

^A Only cars with Volvo On Call.

Related information

- Internet-connected car (p. 69)
- Bluetooth® handsfree phone (p. 57)

Favourites

Link a frequently used function to the **FAV** button. It is possible to link a function within each respective source in the main sources of radio, media, MY CAR and the web browser (in an Internet-connected car). The linked function is then activated simply by pressing **FAV**.

Link favourite

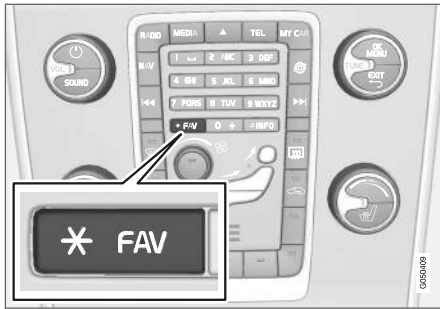

1. Select a main source (e.g. **RADIO**, **MEDIA**).
2. Select the source (e.g. **AM**, **Bluetooth**).
3. In the source's normal view, press **OK/MENU** and select the FAV menu.

Alternatively long press on **FAV** button, until the menu is shown.

4. Select a function in the menu item to link to **FAV**.
 - > When the source (e.g. AM, Bluetooth®) is active the saved function is available via a short press on **FAV**.

Related information

- Audio and media (p. 26)
- MY CAR (p. 14)
- Radio (p. 36)
- Media player (p. 43)
- Internet-connected car (p. 69)

Audio and media - audio settings

The audio system is pre-calibrated for optimal sound reproduction, but can be adapted to your needs.

Setting for optimal sound reproduction

The audio system is pre-calibrated for optimum sound reproduction by means of digital signal processing.

This calibration takes into account loudspeakers, amplifiers, passenger compartment acoustics, listener position etc. for each combination of car model and audio system.

There is also a dynamic calibration that takes into account the position of the volume control, radio reception and vehicle speed.

The controls explained in this owner's manual, e.g. **Bass**, **Treble** and **Equalizer**, are only intended for the user to be able to adapt the sound reproduction according to personal taste.

Audio quality when streaming audio from the Internet

The amount of data transferred is dependent on the services or apps that are used in the car. For example streaming audio can require large amounts of data which requires a good connection and good signal strength.

In some apps it is possible to set the audio quality. Selecting a high audio quality can increase loading time and cause breaks in the sound. In

- ◀◀ order to ensure a consistent sound experience it is recommended to select a lower audio quality.

Related information

- Internet-connected car (p. 69)

Audio and media - general audio settings

General audio settings for the audio and media system.

Press **SOUND** to access the audio settings menu (**Bass**, **Treble**, etc.). Turn **TUNE** to scroll to your selection (e.g. **Treble**) and press **OK/MENU** in order to select.

Adjust the setting by turning **TUNE** and save the setting with **OK/MENU**. Note that the audio volume can only be adjusted within a comfortable range. When a function is active (e.g. navigation system) the audio volume can be adjusted by turning **VOL** to min/max position.

Continue turning **TUNE** in order to access other options:

- **Premium sound*** - Advanced audio settings (p. 35).
- **Bass** - Bass level.
- **Treble** - Treble level.
- **Fader** - Balance between the front and rear speakers.
- **Balance** - Balance between the left and right-hand speakers.
- **Equalizer** - Volume level for different wavelengths (p. 36).
- **Navigation volume** - The volume of the navigation system* system voice.

- **Voice control volume** - The volume of the voice recognition (p. 63) system voice.
- **Ringtone volume** - The volume of the car's ring signal for a connected mobile phone (p. 57).
- **Park assist volume** - The volume for parking assistance*.
- **Cross Traffic Alert-vol.** - The volume for the CTA system*.
- **Volume compensation** - Audio compensation for excessive noise in the passenger compartment (p. 36).
- **Reset audio settings** - Restores the audio settings to factory settings.

Related information

- Audio and media - operating the system (p. 28)

Audio and media - advanced audio settings*

Adapt the audio settings for radio and media according to your wishes.

All the advanced audio settings are accessed by pressing **SOUND** in order to access the audio settings menu. Turn **TUNE** to scroll to **Premium sound*** and press **OK/MENU**.

Sound stage

The sound experience can be optimised for different parts of the car. The sound profile can be set for **Driver seat**, **Rear seats** or **Whole car**.

1. Turn **TUNE** to scroll to **Sound stage** and press **OK/MENU**.
2. Select sound profile by turning **TUNE** and confirm with **OK/MENU**.

Surround

The surround system can be set to the On/Off position. When On is selected, the system selects the setting for optimal sound reproduction. Normally **DPL II** and **PLII** are then shown in the screen. If the recording is made with Dolby Digital technology then playback will take place with this setting, **DIGITAL** is then shown in the screen. When Off is selected, 3-channel stereo is available.

1. Turn **TUNE** to scroll to **Surround** and press **OK/MENU**.

2. Surround can be set in On/Off mode by pressing **OK/MENU**

The surround level can be set separately if On is selected.

1. Turn **TUNE** to scroll to the level setting and confirm with **OK/MENU**.
2. Select surround level by turning **TUNE** and confirm with **OK/MENU**.

Bass speaker

The volume level for the subwoofer can be set separately.

1. Turn **TUNE** to scroll to **Subwoofer** and press **OK/MENU**.
2. Select volume level by turning **TUNE** and confirm with **OK/MENU**.

Centre speaker

The volume level for the centre speaker can be set separately. If surround is in On mode then **DPL II centre level** is set, otherwise **3 channel centre level** is set.

1. Turn **TUNE** to scroll to **Centre** and press **OK/MENU**.
2. Select volume level by turning **TUNE** and confirm with **OK/MENU**.

Related information

- Audio and media - operating the system (p. 28)
- Setting the equaliser (p. 36)
- Setting the audio volume and automatic volume control (p. 36)
- Setting the audio volume for external audio source (p. 52)

Setting the equaliser

Set the equaliser and adjust the volume separately for different radio frequencies or TV.

1. Press **SOUND** to access the audio settings menu. Turn **TUNE** to scroll to **Equalizer** and press **OK/MENU**.
2. Select wavelength by turning **TUNE** and confirm with **OK/MENU**.
3. Adjust the audio setting by turning **TUNE** and confirm with **OK/MENU** or undo the command using **EXIT**. Continue in the same way with other wavelengths to be changed.
4. When the audio setting is complete, press **EXIT** button to confirm and return to normal view.

Related information

- Audio and media - advanced audio settings* (p. 35)
- Audio and media - operating the system (p. 28)

Setting the audio volume and automatic volume control

Set the audio compensation for excessive noise in the passenger compartment.

The audio system compensates for disrupting noises by increasing the volume in relation to the speed of the car. The compensation level can be set to **Low**, **Medium**, **High** or **Off**.

1. Press **SOUND** to access the audio settings menu. Turn **TUNE** to **Volume compensation** and press **OK/MENU**.
2. Select level by turning **TUNE** and confirm with **OK/MENU**.

Related information

- Audio and media - advanced audio settings* (p. 35)
- Audio and media - operating the system (p. 28)

Radio

It is possible to listen to the AM⁵ and FM radio frequencies, and in certain cases also digital radio (DAB)* (p. 42).

In an Internet-connected car (p. 69) it may be possible to listen to Internet radio, see Apps (p. 73).



Controls for radio functions.

For radio operation, read how the system is operated and menu navigation (p. 28).

It is possible to link certain functions to the **FAV** button. A linked function is then activated simply by pressing the **FAV** button, see Favourites (p. 33).

⁵ Does not apply to the V60 Twin Engine and S60L Twin Engine.

AM⁵/FM radio

- Radio tuning (p. 37)
- Radio stations as presets (p. 38)
- Radio Data System functions (RDS) (p. 39)

Digital radio (DAB)*

- Digital radio (DAB)* (p. 42)
- Digital radio (DAB)* - subchannel (p. 42)
- DAB to DAB* link (p. 43)
- Radio stations as presets (p. 38)
- Radio Data System functions (RDS) (p. 39)

Internet radio

- Apps (p. 73)

Related information

- Menu overview - AM (p. 84)
- Menu overview - FM (p. 84)
- Menu overview - Digital radio (DAB)* (p. 85)

Radio tuning

Radio tuning can be set to automatic or manual.

For automatic radio tuning (p. 37) a radio station list (p. 38) is automatically compiled from the frequency signals that the radio is receiving at the time.

Radio tuning can take place automatically or manually:

1. In the normal view for the FM source, press **OK/MENU** and select **Tune station by**.
2. Turn **TUNE** to **Station list** or **Manual tuning** and select with **OK/MENU**.

NOTE





The reception is dependent both on how good the signal strength and signal quality are. The transmission may be disturbed by various factors such as tall buildings or the transmitter being far away. Coverage level can also vary depending on where in the country you are located.

Automatic radio tuning

The radio automatically collates a radio station list (p. 38) that the automatic radio tuning uses.

If automatic radio tuning is set (p. 37) it can be tuned in normal view and in the station list.

Radio tuning in normal view

1. **Short press** - in the normal view for the FM source on  /  in the centre console (or steering wheel keypad).
 - > Radio switches to previous/next stored station.
2. **Long press** - in the normal view for the FM source on  /  in the centre console (or steering wheel keypad).
 - > Radio switches to previous/next available station.

Radio tuning in the station list

1. In the normal view for the FM source, turn **TUNE, FM station list** is shown.
2. Turn **TUNE** to a station and select using **OK/MENU**.

Switch between automatic and manual radio tuning (p. 38) in the station list by pressing **INFO** in the centre console.

⁵ Does not apply to the V60 Twin Engine and S60L Twin Engine.

Radio station list

The radio automatically compiles a station list of the radio stations within the area that are transmitting the strongest signals. This enables you to find a station when you drive into an area where you do not know the radio stations and their frequencies.

The automatic radio tuning (p. 37) uses the compiled station list.

i NOTE

The list only shows the frequencies of stations that are currently being received, **not** a complete list of all radio frequencies on the selected wavelength.

Manual radio tuning

The radio automatically compiles a radio station list (p. 38), but it is possible to perform manual radio tuning.

If manual radio tuning is set (p. 37) it can be tuned in normal view and in the frequency list.

Radio tuning in normal view

1. **Short press** - in the normal view for the FM source on **◀◀** / **▶▶** in the centre console (or steering wheel keypad).
 - > Radio switches to previous/next stored station.
2. **Long press** - in the normal view for the FM source on **◀◀** / **▶▶** in the centre console (or steering wheel keypad).
 - > Radio switches to previous/next available station.

Radio tuning in the frequency list

1. In the normal view for the FM turn **TUNE, FM tuning** is shown.
2. Turn **TUNE** to a frequency and select using **OK/MENU**.

Switch between manual and automatic radio tuning (p. 37) in the frequency list by pressing **INFO** in the centre console.

Radio stations as presets

Frequently used radio stations are optimally saved as presets in order to facilitate simple activation.



Station presets.

AM⁶/FM radio

10 presets can be stored per wavelength (e.g. AM).

The stored presets are selected using the preset buttons.

1. Tune into a station, see Radio tuning (p. 37).
2. Hold one of the preset buttons depressed for a few seconds. The preset button can now be used.

⁶ Does not apply to the V60 Twin Engine and S60L Twin Engine.

A list of pre-selected channels can be shown in the display screen.

- To activate/deactivate, in the normal view for the AM/FM source, press **OK/MENU** and select **Show → Presets**.

Digital radio (DAB)*

10 presets can be stored per wavelength. Storage of presets is performed by means of a long press on the desired preset button, for more information see AM/FM radio above. The stored presets are selected using the preset buttons.

A preset contains one channel but no subchannels. If a subchannel is being played and a preset is saved then only the main channel is registered. This is because subchannels are temporary. At the next attempt to retrieve the preset, the channel which contained the subchannel will be played. The preset is not dependent on the channel list.

A list of pre-selected channels can be shown in the display screen.

- To activate/deactivate, in the normal view for the DAB source, press **OK/MENU** and select **Show → Presets**.

i NOTE

The audio system's DAB system does not support all functions in the DAB standard.

Radio Data System functions (RDS)

With RDS the radio can automatically change to the strongest transmitter. RDS provides the facility to receive e.g. traffic information (TP) and to search for certain programme types (PTY).

RDS links FM transmitters into a network. An FM transmitter in such a network sends information that gives an RDS radio the following functions:

- Automatically switches to a stronger transmitter if reception in the area is poor⁷.
- Search for programme category, e.g. programme types⁸ or traffic information.
- Reception of text information on current radio programme⁹.

i NOTE

Some radio stations do not use RDS or only selected parts of its functionality.

If a required programme type is located the radio can switch stations interrupting the audio source currently in use. For example, if the CD player is in use, it is paused. The interrupting transmission is played back at a preset volume. The radio returns to the previous audio source and volume when the set programme type is no longer broadcast.

The programme functions alarm, traffic information (TP) and programme types (PTY) interrupt one another in order of priority, where alarm has the highest priority and programme types has the lowest. Press **OK/MENU** to return to the interrupted audio source and still listen to the message. Press **EXIT** in order to cancel the message and return to the interrupted audio source.



◀◀ Related information

- Alarms in the event of accidents and disasters (p. 40)
- Traffic information (TP) (p. 40)
- Volume control for interrupting RDS-functions (p. 41)
- Radio programme types (PTY) (p. 41)
- Radio text (p. 41)

Alarms in the event of accidents and disasters

The radio function is used to warn of serious accidents and catastrophes. The message **ALARM!** appears in the screen when an alarm message is transmitted.

The alarm can be temporarily interrupted, but not deactivated.

Related information

- Radio Data System functions (RDS) (p. 39)

Traffic information (TP)

This function allows traffic information that is broadcast within a set radio station's RDS network to break through.

The **TP** symbol is shown when the function is activated. If any station in the list can send traffic information then this is shown by **TP** illuminating in the screen, otherwise **TP** will be grey

- To activate/deactivate, in the normal view for the FM source, press **OK/MENU** and select **TP**.

Related information

- Radio Data System functions (RDS) (p. 39)

⁷ Applies to FM radio.

⁸ Applies to DAB* radio.

⁹ Applies to FM and DAB* radio.

Radio programme types (PTY)

One or more radio programme types, such as pop and classical music can be selected for DAB*-radio. After selecting a programme type navigation only occurs among the channels transmitting that type.

1. To select programme type, in the normal view for the DAB source, press **OK/MENU** and select **Programme type (PTY) filtering**.
2. Turn **TUNE** to the programme type that is to be marked/unmarked.
3. Mark/unmark the programme type with **OK/MENU**.
4. When the desired programme types are selected, leave the menu system using **EXIT**.

PTY symbol is shown in the screen when the function is active.

In some cases DAB radio will exit PTY mode, see DAB to DAB* link (p. 43).

Related information

- Radio Data System functions (RDS) (p. 39)

Volume control for interrupting RDS-functions

The interrupting RDS-functions, e.g. alarm or traffic information (TP), are heard at the volume selected for each respective programme type. If the volume level is adjusted during the programme interruption, the new level is saved until the next programme interruption.

Related information

- Radio Data System functions (RDS) (p. 39)
- Alarms in the event of accidents and disasters (p. 40)
- Traffic information (TP) (p. 40)

Radio text

Some RDS stations transmit information on programme content, artists, etc. This information may be shown on the display screen. Radio text can be shown for FM and DAB* radio.

- To activate/deactivate, in the normal view for the FM/DAB source, press **OK/MENU** and select **Show**.

Related information

- Radio Data System functions (RDS) (p. 39)
- Digital radio (DAB)* (p. 42)

Automatic radio frequency update (AF)

The function automatically selects the best frequency for the set radio station and can be activated for FM radio.

In order to find the best frequency the function may, in exceptional cases, need to search the entire FM wavelength.

If the set radio station is saved as preset (p. 38) then the function does not change frequency even if automatic radio frequency update is activated.

To activate/deactivate automatic radio frequency updating:

1. In the normal view for the FM source, press **OK/MENU**.
2. Select **Alternative frequency**.

Digital radio (DAB)*

DAB (Digital Audio Broadcasting) is a digital broadcasting system for radio (p. 36). The car supports DAB, DAB+ and DMB.

NOTE

Coverage for DAB is not available in all locations. If there is no coverage then the message **No reception** is shown in the display screen.

Related information

- Radio stations as presets (p. 38)
- Radio programme types (PTY) (p. 41)
- Radio text (p. 41)
- Digital radio (DAB)* - subchannel (p. 42)
- DAB to DAB* link (p. 43)
- Menu overview - Digital radio (DAB)* (p. 85)

Digital radio (DAB)* - subchannel

Secondary components are usually named subchannels. These are temporary and can contain e.g. translations of the main programme into other languages.

If one or more subchannels are broadcast then the **√** symbol is shown to the left of the channel name in the display screen. A subchannel is indicated by the - symbol appearing to the left of the channel name in the display screen.

Turn **TUNE** to access the subchannels.

Subchannels can only be accessed via the main channel. To access other subchannels, select a different main channel.

DAB to DAB* link

DAB to DAB linking means that the DAB radio can go from one channel with poor or no reception to the same channel in another channel group with better reception.

There may be a certain delay when changing channel group. There may be a period of silence between the current channel no longer being available to the new channel becoming available.

- To activate/deactivate, in the normal view for the DAB source, press **OK/MENU** and select **DAB-DAB linking**.

Media player

The media player can playback audio and video from CD/DVD discs and externally connected audio sources via the AUX/USB input¹⁰ or wirelessly stream audio files (p. 53) from external devices via Bluetooth®. Certain media players can show TV* and have the option to communicate with a mobile phone (p. 57) via Bluetooth®.

It is possible to copy music from a disc/USB¹¹ to the car's hard disc drive (HDD) (p. 48).

In an Internet-connected car (p. 69) it may be possible to listen to Internet radio, audio books and use music service, see Apps (p. 73).



Controls for the media player.

For basic information on playback and navigation, read how the system is operated and menu navigation (p. 28).

It is possible to link certain functions to the **FAV** button. A linked function is then activated simply by pressing the **FAV** button, see Favourites (p. 33).

Gracenote MusicID®

Gracenote MusicID® is the industry standard for music recognition. The technology is used to identify and deliver covers and music information for CD discs, digital music files on storage media and music services on the Internet.

Related information

- Audio and media (p. 26)
- Voice recognition - mobile phone (p. 66)
- Remote control* (p. 80)
- Media player - compatible file formats (p. 49)

¹⁰ AUX only applies to certain models.

¹¹ Depending on market.

CD/DVD

Media player (p. 43) can play back pre-recorded and burned CD/DVD discs.

The media player supports and can play the following main types of discs and files:

- Pre-recorded CD/DVD discs (CD/DVD Audio).
- Pre-recorded DVD-Video discs (DVD Video).
- Burned CD-/DVD discs with audio files.

For more information about the supported formats, see compatible file formats (p. 49).

A disc may contain a maximum of 5000 files (including playlists) in order to be playable.

NOTE

Some audio files that are copy-protected by record companies or privately copied audio files cannot be loaded by the player.

It is possible to copy music from disc¹² to the car's hard disk drive (HDD) (p. 48) and then play it back from there.

It is possible to link certain functions to the **FAV** button. A linked function is then activated simply by pressing the **FAV** button, see Favourites (p. 33).

For basic information on playback and navigation, read how the system is operated and menu navigation (p. 28). See below for a more detailed description.

Playback and navigation of CD/DVD Audio

In the normal view for the disc source, press **OK/MENU** and turn **TUNE** to access the disc's track structure. Navigate in the structure by turning **TUNE**.

Start playback of a track by pressing **OK/MENU**.

Playback and navigation of burned CD/DVD discs

If a disc with audio/video files is inserted into the player then the disc's folder structure needs to be loaded. Depending on the quality of the disc and the quantity of information there may be a certain delay before playback starts.

In the normal view for the disc source, press **OK/MENU** and turn **TUNE** to access the disc's folder structure or to browse the categories. Navigate in the structure by turning **TUNE**, select folder using **OK/MENU** and go back in the structure using **EXIT**.

Start playback of a file by pressing **OK/MENU**.

When the playback of a file is finished the playback of the other files in the same folder continues. Folder change takes place automatically

when all files in the current folder have been played back.

Playback and navigation of DVD Video

To manage DVD Video, see Playback and navigation of DVD video discs (p. 47).

Media search

There is the option to search for music in your devices. The search scans through USB, disc and the hard disk drive. Read more about the search function (p. 45).



Related information



- Audio and media - operating the system (p. 28)
- Fast forward/reverse (p. 45)
- Random playback order of disc tracks or audio files (p. 45)
- Menu overview - CD/DVD Audio (p. 85)
- Menu overview - DVD Video (p. 86)

¹² Certain markets.

Fast forward/reverse

It is possible to fast forward/rewind audio and video files¹³.

Hold the button for  /  depressed in order to fast forward/rewind audio or video files forward/backward.

Audio files are fast forwarded/rewound at one speed, while video files can be fast forwarded/rewound at several speeds. Repeatedly press the buttons  /  to increase the fast forward/rewind speed for video files. Release the button to return to viewing at normal speed.

Related information

- Audio and media - operating the system (p. 28)

Random playback order of disc tracks or audio files

This function plays the tracks/audio files in random order¹⁴.

To listen to the tracks/audio files in random order for the selected source:

1. Press **OK/MENU** in the normal view for the selected source
2. Turn **TUNE** to **Shuffle**
3. Press **OK/MENU** to activate/deactivate the function.

Related information

- Audio and media - operating the system (p. 28)
- Media Bluetooth® (p. 53)

Media search

There is the option to search for music in your devices. The search seeks through USB (p. 50), disc (p. 44) and hard disc drive (p. 48).

Media search is available from the normal view for the sources **Disc**, **USB** and **HDD**.

To start the search, in the normal view for the source, press **OK/MENU** and select **Media search**.

Search function

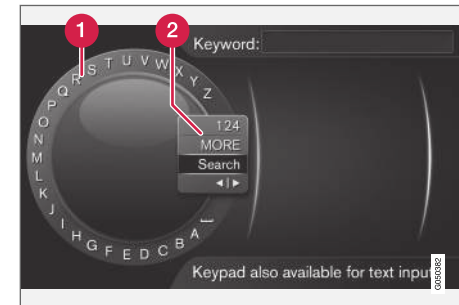

Searching using the character wheel.

- 1 Character list
- 2 Changing the input mode (see following table).

¹³ Only applies to CD/DVD* discs, USB and iPod®.

¹⁴ Does not apply to DVD video discs. For externally connected audio sources via the AUX/USB input this only applies to USB and iPod®. Not supported by all mobile phones.

◀◀ Use the character wheel to enter search terms.

1. Turn **TUNE** to the desired letter, press **OK/MENU** to confirm. The number and letter buttons on the control panel in the centre console can also be used.

To change the input mode to numbers or special characters, or to go to the results list, turn **TUNE** to one of the options (see explanation in the following table) in the list for changing the input mode (2), press **OK/MENU**.

2. Continue with the next letter and so on.
3. When you are satisfied with your search term, select **Search**.
 - > Search is carried out. The result is shown and grouped in the following categories: artist, album, track, genre, year and composer.
4. Turn **TUNE** to a category, press **OK/MENU**.
5. Turn **TUNE** in order to select a media, press **OK/MENU** to start playback.

123/ABC	Change between letters and numbers with OK/MENU .
MORE	Change to special characters with OK/MENU .

Search	Carry out media search.
◀ ▶	Changes from the character wheel to the Keyword: field. Move the cursor with TUNE . Delete any misspelling with EXIT . To return to the character wheel, press OK/MENU . Note that the digit and letter buttons on the control panel can be used for editing in the Keyword: field.

A short press on **EXIT** deletes an input character. A long press on **EXIT** will clear all entered characters.

Enter with the numerical keyboard



Numerical keyboard.

Another way of entering characters is to use the centre console's buttons **0-9**, * and #.

When e.g. **9** is pressed, a bar appears with all characters¹⁵ under the buttons, e.g. **W, x, y, z** and **9**. Quick presses on the button move cursor through these characters.

- Stop with the cursor on the desired character in order to select it - the character is shown on the enter line.
- Delete/change using **EXIT**.

To enter a number, hold in the corresponding number key.

¹⁵ The character for each button may vary depending on market/country/language.

Playback and navigation of DVD video discs

When playing back a DVD video disc a disc menu may appear on the display screen. The disc menu gives access to additional functions and settings, such as selecting subtitles, language and scene selection.

For basic information on playback and navigation, read how the system is operated and menu navigation (p. 28). See below for a more detailed description.

i NOTE

A video film is only shown when the car is stationary. There will be no picture when the car is moving and **Video unavailable at this speed** is shown on the screen, but the audio continues to be played back. The picture returns when the car is almost stationary.

Navigation in the DVD video disc's menu

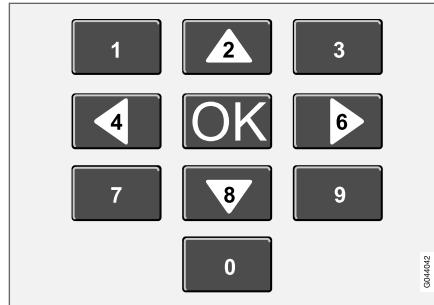

Navigation in the DVD video disc's menu is performed using the number keys in the centre console as illustrated above.

Changing chapter or title

Turn **TUNE** to access the list of chapters and navigate through them (if the film is being played back then it is paused). Press **OK/MENU** to select the chapter, this also leads back to the original position (if the film was being played back then it is restarted). Press **EXIT** to access the title list.

Titles are selected in the title list by turning **TUNE** and the selection is confirmed with **OK/MENU**, this also leads back to the chapter list. Press **OK/MENU** to activate the selection and return to the start position. Use **EXIT** to cancel

the selection and this leads back to the original position (without any selection being made).

The chapter can also be changed by pressing on **⏮** / **⏭** in the centre console or the steering wheel keypad.

Related information

- Audio and media - operating the system (p. 28)
- Camera angle for playback of DVD video discs (p. 48)
- Fast forward/reverse (p. 45)
- Random playback order of disc tracks or audio files (p. 45)
- Media player - compatible file formats (p. 49)

Camera angle for playback of DVD video discs

If the DVD video disc supports it, the function can be used to choose from which camera position a particular scene should be shown.

- In the normal view for the disc source, press **OK/MENU** and select **Advanced settings** → **Angles**.

Related information

- Audio and media - operating the system (p. 28)

Picture settings

The display settings can be adjusted when the car is stationary.

Adjusting brightness and contrast:

1. In playback mode, press **OK/MENU** and select **Image settings**, confirm with **OK/MENU**.
2. Turn **TUNE** to the adjustment option and confirm with **OK/MENU**.
3. Adjust the setting by turning **TUNE** and confirm with **OK/MENU**.

To return to the settings list, press the **OK/MENU** or **EXIT**.

Related information

- Audio and media - operating the system (p. 28)
- Audio and media (p. 26)

Hard disk drive (HDD)

It is possible to copy music from disc/USB¹⁶ to the car's hard disk drive (HDD) and then play it back from there.

For information about the supported formats, see compatible file formats (p. 49).

For basic information on playback and navigation, read how the system is operated and menu navigation (p. 28). See below for a more detailed description.

Copying music to the hard disk drive

Folders have the symbol .

1. In the normal view for the hard disk drive source, press **OK/MENU** and select to copy **From disc/From USB**.
2. Select what to copy, and then **Continue**.
3. **Select destination** for the location of copied music, and select **Start importing to selected folder**.
 - > **Importing music from disc/Importing music from USB**

Do not remove the disc/USB memory before the transfer has been confirmed - **Music files imported**.

¹⁶ Depending on market.

i NOTE

When copying from USB the music files that are not located in folders will not appear, i.e. if they are located in the root. These tracks can be imported by selecting to import **All tracks**, or by downloading the files into folders.

The system can copy music that is up to 8 levels deep in subfolders.

File formats that can be copied to the hard disc drive

CD-/DVD discs: mp3, wma, aac.

USB: mp3, mp4, wma, aac, m4a, m4b.

Rename/delete folder or file

1. In the normal view for the hard disk drive source, press **OK/MENU** and select **Rename/delete files**.
2. Select the folder or file, press **OK/MENU** and select **Rename** or **Delete**.
3. Use the character wheel to enter the new name and then **Save**.

It is not possible to rename a file to exactly the same name as another file. The system would then keep the old name.

Playback and navigation

It is possible to link certain functions to the **FAV** button. A linked function is then activated simply

by pressing the **FAV** button, see Favourites (p. 33).

Playback order

Playback is in accordance with the list order. To mix the playback order, in the normal view for the hard disk drive source, press **OK/MENU** and select **Shuffle**.

Media search

There is the option to search for music in your devices. The search scans through USB, disc and the hard disk drive. Read more about the search function (p. 45).

Storage information

To view the capacity and usage of the hard disk drive, in the normal view for the hard disk drive source, press **OK/MENU** and select **Storage information**.

Related information

- Media player (p. 43)
- Menu overview - hard disk drive (HDD) (p. 87)

Media player - compatible file formats

The media player can play back a variety of file types and is compatible with the formats in the following tables.

Compatible file formats for CD/DVD discs**i NOTE**

Dual format, double-sided discs (DVD Plus, CD-DVD format) are thicker than regular CD discs and therefore playback cannot be guaranteed and malfunction may arise.

If a CD contains a mixture of MP3 and CDDA tracks, all MP3s will be ignored.

Audio format	CD audio, mp3, wma, aac, m4a
Video format	DVD Video

Compatible file formats via USB connection

Audio and video files in the following table are supported by the system for playback via the USB connection.

Audio format	mp3, mp4, wma, aac, m4a, m4b
Video format	-

◀◀ **Audio specifications for MP3 file format**

Format	kHz	kbps
MPEG-1/Audio	32	32-320 ^A
	44.1	32-320 ^A
	48	32-320 ^A
MPEG-2/Audio	16	8-160
	22.05	8-160
	24	8-160
MPEG-2.5/Audio	8	8-64
	11.025	8-64
	12	8-64

^A Does not apply to 144 kbps.

Audio specifications for .wma file format

For the file to be played back, the following criteria must be met:

WMA version	8x, 9x, 10x, Pro
-------------	------------------

Audio specifications for .aac file format

For the file to be played back, the following criteria must be met:

Audio format	MPEG-2 and MPEG-4
Audio sampling rate	8-96 kHz
Audio channels (ch)	1ch and 2ch

Audio specifications for .wav file format

An iPod can be used to play back the .wav file format.

For the file to be played back, the following criteria must be met:

Audio sampling rate	Up to 44.1 kHz
Audio channels (ch)	1ch and 2ch
Audio bit rate	16 kbps for 1ch

The .wav file format also supports the PCM format.

Related information

- Audio and media - operating the system (p. 28)
- CD/DVD (p. 44)
- External audio source via AUX/USB input (p. 50)
- Hard disk drive (HDD) (p. 48)

External audio source via AUX/USB input

An external audio source, e.g. an iPod® or MP3 player, can be connected (p. 52) to the audio system.



An iPod® or MP3 player with rechargeable batteries is recharged (when the ignition is on or the engine is running) if the device is plugged into the USB connection.

It is possible to copy music from USB¹⁷ to the car's hard disk drive (HDD) (p. 48) and then play it back from there.

For basic information on playback and navigation, read how the system is operated and menu navigation (p. 28). See below for a more detailed description.

¹⁷ Certain markets.

It is possible to link certain functions to the **FAV** button. A linked function is then activated simply by pressing the **FAV** button, see Favourites (p. 33).

Playback and navigation

An audio source connected to the USB input can be operated using the car's audio controls. A device connected via the AUX input¹⁸ cannot be controlled via the car.

In the normal view for the audio source, turn **TUNE** to enter the folder structure or to search in categories. Navigate in the structure by turning **TUNE**, select folder using **OK/MENU** and go back in the structure using **EXIT**.

Start playback of a file by pressing **OK/MENU**.

When the playback of a file is finished the playback of the other files in the same folder continues. Folder change takes place automatically when all files in the current folder have been played back.

Media search

There is the option to search for music in your devices. The search scans through USB, disc and the hard disk drive. Read more about the search function (p. 45).

USB memory

To facilitate the use of a USB memory, only store music files on it. It takes a lot longer for the system to load storage media that contains anything other than compatible music files.

NOTE
The system supports mobile media compliant with USB 2.0 and the FAT32 file system.

NOTE
When using a longer model USB memory stick the use of a USB adapter cable is recommended. This is to avoid mechanical wear to the USB input and the connected USB memory stick.

Technical specifications

Maximum number of files	15000
Maximum number of folders	1000
Maximum number of folder levels	8
Maximum number of playlists	100
Maximum number of items in a playlist	1000
Subfolders	No limit

MP3 player

Many MP3 players have their own file systems that are not supported by the audio system. For use in the system, an MP3 player must be set in **USB Removable device/Mass Storage Device** mode.

iPod®

NOTE
The system only supports the playback of audio files from iPod®.

NOTE
The iPod® source must be used (not USB) to start playback.
When an iPod® is used as audio source, the car's audio and media system has a menu structure that is similar to the iPod® player's own menu structure.

Related information

- Setting the audio volume for external audio source (p. 52)
- Media player - compatible file formats (p. 49)
- Audio and media - menu overview (p. 83)

¹⁸ AUX only applies to certain models.

Connecting an external audio source via AUX/USB input

An external audio source, e.g. an iPod® or MP3 player, can be connected to the audio system via any of the connections in the centre console.



Connection points for external audio sources.

To connect the audio source:

1. Connect your audio source to one of the connections in the centre console's storage compartment (see illustration).
2. In the normal view for the media source, press **MEDIA**, turn **TUNE** to the desired audio source **USB**, **iPod** or **AUX**¹⁹ and press **OK/MENU**.

The text **Reading USB** is shown in the screen when the system is loading the storage media's

file structure. Depending on the file structure and number of files there may be some delay before loading is finished.

i NOTE

The system supports most iPod® models produced in 2005 or later.

i NOTE

To prevent damage to the USB connection, this is shut off if the USB connection is short-circuited or if a connected USB unit is taking too much power (this may happen if the unit connected does not meet the USB standard). The USB connection is reactivated automatically the next time the ignition is turned on, unless the fault persists.

Related information

- External audio source via AUX/USB input (p. 50)

Setting the audio volume for external audio source

Set the volume for an external audio source (p. 50). If the volume is too high or too low then the quality of the sound may deteriorate.

If an external audio source (e.g. an MP3 player or iPod®) is connected to the AUX input²⁰ the audio source connected may have a volume different from the internal volume of the audio system (e.g. radio). Correct this by adjusting the volume of the input: In the normal view for the AUX source, press **OK/MENU**, select **AUX input** and then volume setting **Standard** or **Boost**.

i NOTE

If the external audio source's volume is too high or too low, the quality of the sound may deteriorate. The audio quality may also be impaired if the player is charged while the audio and media system is in AUX mode. In which case, avoid charging the player via the 12 V socket.

Related information

- Audio and media - advanced audio settings* (p. 35)
- Audio and media - operating the system (p. 28)

¹⁹ AUX only applies to certain models.

* Option/accessory.

Media Bluetooth®

The car's media player is equipped with Bluetooth® and can wirelessly play streaming audio files from external devices with Bluetooth®, such as mobile phones and PDAs.

The device must first be registered and connected to the car (p. 54).

For basic information on playback and navigation, read how the system is operated and menu navigation (p. 28). See below for a more detailed description.

It is possible to link certain functions to the **FAV** button. A linked function is then activated simply by pressing the **FAV** button, see Favourites (p. 33).

Playback and navigation

Navigation and control of the audio can be carried out via the centre console buttons or via the steering wheel keypad. In some external devices it is also possible to change tracks from the device.

When a mobile phone is connected to the car it is also possible to remotely control a selection of the mobile phone's functions, see Bluetooth® handsfree phone (p. 57). Change between the main sources **TEL** and **MEDIA** to manage each one's functions.

NOTE

The Bluetooth® media player must support the Audio/Video Remote Control Profile (AVRCP) and Advanced Audio Distribution Profile (A2DP). The player should use AVRCP version 1.3, A2DP 1.2. Otherwise some functions may not work.

Not all mobile phones and external media players available in the market are fully compatible with the Bluetooth® function in the car's media player. Volvo recommends that you contact an authorised Volvo dealer for information on compatible phones and external media players.

NOTE

The car's media player can only play the audio files via the Bluetooth® function.

Related information

- Random playback order of disc tracks or audio files (p. 45)
- Menu overview - Media Bluetooth® (p. 88)

Connecting and disconnecting a Bluetooth® device

The car is equipped with Bluetooth® and can wirelessly communicate with other Bluetooth® devices after registration and connection (p. 54).

A maximum of 15 Bluetooth® devices can be registered. Registration is performed once per device. After registration the device no longer needs to be visible/searchable, but only has Bluetooth® activated.

When the Bluetooth® function is active and the last device connected is in range it is automatically connected to the car when it is started. The name of the connected device is shown in the source's normal view. To connect to another device, press **OK/MENU** and select change device (p. 56).

When the Bluetooth® device is out of range of the car it is automatically disconnected. To manually disconnect a device - deactivate Bluetooth in the device. If you want to deregister a Bluetooth® device from the car, select Removing a Bluetooth® device (p. 57). The car will then not search for the device automatically.

It is possible to have two Bluetooth® devices connected simultaneously. One phone  and one

²⁰ AUX only applies to certain models.

media device , which you can switch between (p. 56).



Phone connected as both phone and as media device.

Related information

- Audio and media - operating the system (p. 28)
- Media Bluetooth® (p. 53)
- Bluetooth® handsfree phone (p. 57)

Registering a Bluetooth® device

It is possible to have two Bluetooth® devices connected simultaneously. One phone and one media device, which you can switch between. It is also possible to call with the phone and simultaneously stream audio files. It is possible to connect the car to the Internet (p. 69) via the mobile phone's Internet connection.

A maximum of 15 Bluetooth® devices can be registered. Registration is performed once per device. After registration the device no longer needs to be visible/searchable, but only has Bluetooth® activated.

NOTE

If the phone's operating system is updated then it is possible that the registration of the phone is interrupted. In which case, disconnect the phone, see Removing a Bluetooth® device (p. 57) and then reconnect it.

Connecting an external device takes place in different ways depending on whether or not the device has been connected previously. The connection options below presume that this is the first time the device is being connected (registered) and that no other device is connected. The connection options show the connection of a phone. Connecting a media device (p. 53) is per-

formed in the same way, but starting from the main source **MEDIA**.

There are two possible ways of connecting devices, either search for the external device from the car, or search for the car from the external device. If one option does not work then try with the other.

If you are not already in the normal view for the phone, press **TEL** in the centre console.



Example of normal view for the phone.

Alternative 1 - search for the external device via the car's menu system

1. Make the external device searchable/visible via Bluetooth®, see the external device's manual or www.volvocar.com.

2. In the normal view for the phone source, press **OK/MENU** and select **Search new phone** (for media device **Search new device**).
 - > The car will now search for available Bluetooth® devices, which can take approx. one minute.
3. Select the Bluetooth® device to be connected from the list, press **OK/MENU**.
4. Check that the specified number code in the car matches that in the external device. In which case, choose to accept in both places.
5. Choose to accept or reject any options for contacts and messages in the phone.
 - > The external device is now connected.

If the connection failed, press **EXIT** and connect the device as described under Alternative 2.

Alternative 2 - Search for the car with the Bluetooth® function of the external device

1. In the normal view for the phone source, press **OK/MENU**, select **Make car discoverable** and confirm with **OK/MENU**.
2. Search with the external device for Bluetooth® devices.
 - > The device will now search for available Bluetooth® devices, which can take approx. one minute.

3. Select the car's name on the external device's screen.
4. Check that the specified number code in the car matches that in the external device. In which case, choose to accept in both places.
5. Choose in the phone to accept or reject any options for phone contacts and messages.
 - > The external device is now connected.

When the external device is connected, the external device's Bluetooth® name is shown in the car's display screen and the device can be controlled from the car.

Related information

- Audio and media - operating the system (p. 28)
- Connecting and disconnecting a Bluetooth® device (p. 53)

Automatic connection of Bluetooth® device

When the Bluetooth® function is active and the last device connected is in range it is connected automatically. If the last connected device is not in range, the system attempts to connect a device previously registered (p. 54) in the car.

To connect to another device, press **EXIT**, select to connect a new device (p. 54) or change to another already registered device (p. 56).

Related information

- Audio and media - operating the system (p. 28)
- Connecting and disconnecting a Bluetooth® device (p. 53)

Changing to another Bluetooth® device

It is possible to change from a connected device to another one if there are several devices in the car. The device must first have been registered (p. 54) to the car.

Changing media device

1. Check that the external device has Bluetooth® activated, see the external device's manual.
2. In the normal view for the Bluetooth® media source, press **OK/MENU** and select **Change device**.
 - > The car searches for previously connected devices. The external devices detected are specified with their respective Bluetooth® name in the display screen.
3. Select the device to be connected.
 - > Connection of the external device takes place.

Changing phone

1. Check that the external device has Bluetooth® activated, see the external device's manual.

2. In the normal view for the phone source, press **OK/MENU** and select **Change phone**.
 - > The car searches for previously connected devices. The external devices detected are specified with their respective Bluetooth® name in the display screen.
3. Select the device to be connected.
 - > Connection of the external device takes place.

Related information

- Audio and media - operating the system (p. 28)
- Connecting and disconnecting a Bluetooth® device (p. 53)

Disconnecting the Bluetooth® device

When the Bluetooth® device is out of range of the car it is automatically disconnected.

When the mobile phone has been disconnected an ongoing call can continue by using the mobile phone's built-in microphone and speaker.

The handsfree function is deactivated when the engine is switched off and the door is opened²¹.

To deregister a Bluetooth® device from the car, see Removing a Bluetooth® device (p. 57). The car will then not search for the device automatically.

Related information

- Audio and media - operating the system (p. 28)
- Connecting and disconnecting a Bluetooth® device (p. 53)
- Media Bluetooth® (p. 53)
- Bluetooth® handsfree phone (p. 57)

²¹ Only Keyless Drive.

Removing a Bluetooth® device

It is possible to remove (deregister) a Bluetooth® device from the car. The car will then not locate the device automatically.

Removing a media device

In the normal view for the Bluetooth® media source, press **OK/MENU** and select **Change device** → **Delete device**.

Removing a phone

In the normal view for the phone source, press **OK/MENU** and select **Change phone** → **Delete device**.

Related information

- Audio and media - operating the system (p. 28)
- Connecting and disconnecting a Bluetooth® device (p. 53)
- Media Bluetooth® (p. 53)
- Bluetooth® handsfree phone (p. 57)

Bluetooth® handsfree phone

A mobile phone equipped with Bluetooth® can be connected wirelessly to the car.



Phone functions, controls overview.

The device must first be registered and connected to the car (p. 54).

The audio and media system acts as handsfree, with the facility to remotely control a selection of the mobile phone's functions. The mobile phone can still be operated with its own keys when it is connected to the car.

When a mobile phone is connected to the car, it is also possible to simultaneously stream audio files from the phone or other Bluetooth®-connected media device, see Media Bluetooth®

(p. 53). Change between the main sources **TEL** and **MEDIA** to manage each source's functions.

i NOTE

Only a selection of mobile phones are fully compatible with the handsfree function. Volvo recommends that you seek assistance from an authorised Volvo dealer for information on compatible phones.

Activate

A short press on **TEL** activates last connected phone. If a phone is already connected, and **TEL** is pressed, a shortcut menu is shown with commonly used menu options for the phone. The  symbol indicates that a phone is connected.

To call

1. Make sure that the  symbol appears at the top of the screen and that the handsfree function is in phone mode.
2. Dial the number required, or in normal view turn **TUNE** to the right to access the phone book (p. 60) and to the left for the call register (p. 59) for all calls.
3. Press **OK/MENU** to call the selected contact or number from the call register.

The call is interrupted with **EXIT**.

◀ Reading a text message²²

The car mirrors the connected mobile phone's text messages.

If a connected telephone receives a text message the symbol  is shown at the top of the screen.

1. Press **TEL** and then press **OK/MENU** in order to access **Phone menu**.
2. Turn **TUNE** to **Messages** and press **OK/MENU**.
3. Turn **TUNE** to the message to be read out and press **OK/MENU**.
> The message is shown on the screen.
4. Pressing **OK/MENU** accesses the message menu with options to e.g. allow the system voice to read out the message²³, call the sender of the message or delete the message.

If the main source **TEL** is already active then a pop-up menu with new messages is shown on the screen. Pressing **OK/MENU** shows the selected message while the system voice reads it out at the same time²⁴. The reading is interrupted with **EXIT**.

The pop-up menu and the notification sound can be switched off under **Phone menu** → **Message notifications**.

NOTE

To show the connected mobile phone's messages in the car, mirroring must be accepted in the mobile phone when it is connected. Depending on the mobile phone, this can be activated by means of the following:

- a pop-up box or a notification is shown and accepted in the phone.
- accept sharing of information in the phone's settings for the Bluetooth® connection to the car.

In some cases it may be a requirement that the mobile phone is disconnected and reconnected to the car in order for mirroring to be activated.

Related information

- Bluetooth® handsfree phone - audio settings (p. 60)
- Menu overview - Bluetooth® handsfree (p. 89)

Bluetooth® handsfree phone - overview

System overview for Bluetooth® handsfree phone.

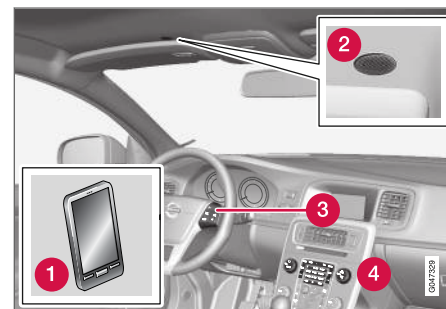

System overview

- 1 Mobile phone
- 2 Microphone
- 3 Steering wheel keypad
- 4 Centre console control panel

²² Not supported by all mobile phones.

²³ Applies to certain markets.

²⁴ Applies to certain markets.

Related information

- Audio and media - operating the system (p. 28)
- Connecting and disconnecting a Bluetooth® device (p. 53)

Making and receiving calls

Functions for handling phone calls.

Incoming call

- Press **OK/MENU** to answer incoming call. The function is active even if the audio system is in e.g. **RADIO** or **MEDIA** mode.

Refuse or end with **EXIT**.

In call menu

In the normal view for the phone source, one press on **OK/MENU** during the current call gives access to the following functions:

- **Mobile phone** - the call is transferred from handsfree to the mobile phone. For some mobile phones the connection is interrupted. This is normal. The handsfree function asks if you want to reconnect.
- **Mute microphone** - audio system microphone is muted.
- **Dial number** - option to call a third party using the number keys (current call set in standby).

Call register

The call register is mirrored in the handsfree function at each new connection and is then updated during the connection. In the normal view for the phone source, turn **TUNE** to the left to see the call register.

In the normal view for the phone source, you can see the call register for the connected phone by pressing **OK/MENU** and then selecting **Call list**.

i NOTE

To show the connected mobile phone's call register in the car, mirroring must be accepted in the mobile phone when it is connected. Depending on the mobile phone, this can be activated by means of the following:

- a pop-up box or a notification is shown and accepted in the phone.
- accept sharing of information in the phone's settings for the Bluetooth® connection to the car.

In some cases it may be a requirement that the mobile phone is disconnected and reconnected to the car in order for mirroring to be activated.

Related information

- Audio and media - operating the system (p. 28)
- Voice recognition - mobile phone (p. 66)
- Bluetooth® handsfree phone (p. 57)
- Bluetooth® handsfree phone - audio settings (p. 60)
- Phone book (p. 60)

Bluetooth® handsfree phone - audio settings

It is possible to adjust the call volume, audio system volume and ring signal volume.

Phone call volume

The phone call volume can only be changed during a call. Use the steering wheel keypad or turn the **VOL** control.

Audio system volume

Providing there is no ongoing call taking place, the audio system volume is controlled as usual by turning **VOL**.

If an audio source is active on receipt of an incoming call then it is muted automatically.

Ring signal volume

The ring signal volume can be changed by pressing the **SOUND** button, turning **TUNE** to **Ringtone volume** and pressing **OK/MENU**. Adjust the ring signal volume by turning **TUNE** and save the setting with **OK/MENU**.

Ring signals

The handsfree-function's built-in ring signal is used for incoming calls.

NOTE

For certain mobile phones the connected mobile phone's ring signal is not switched off, and is then used at the same time as the handsfree system's built-in signal.

Related information

- Audio and media - operating the system (p. 28)
- Bluetooth® handsfree phone (p. 57)

Phone book

The car mirrors the connected mobile phone's phone book and only shows this phone book when the mobile phone is connected.

All use of the phone book requires that the  symbol appears at the top of the display screen and that the handsfree function is in phone mode.

If the phone book contains a ringing caller's contact information then this is shown in the display screen.

NOTE

To show the connected mobile phone's phone book in the car, mirroring must be accepted in the mobile phone when it is connected. Depending on the mobile phone, this can be activated by means of the following:

- a pop-up box or a notification is shown and accepted in the phone.
- accept sharing of information in the phone's settings for the Bluetooth® connection to the car.

In some cases it may be a requirement that the mobile phone is disconnected and reconnected to the car in order for mirroring to be activated.

Related information

- Audio and media - operating the system (p. 28)
- Bluetooth® handsfree phone (p. 57)

Phone book - quick search for contacts

In the normal view for the phone source, turn **TUNE** to the right to show a list of contacts.

Turn **TUNE** to select and press **OK/MENU** to call.

Under the name of the contact is the phone number that is selected by default. If the symbol ▼ appears to the right of the contact then there are several phone numbers stored for the contact. Press **OK/MENU** to show the numbers. Change and dial a number other than that selected by default by turning **TUNE**. Press **OK/MENU** to dial.

Search in the list of contacts by using the centre console's keypad to key in the start of the contact's name. For the function of the buttons, see Phone book - searching for contacts (p. 61).

Related information

- Audio and media - operating the system (p. 28)
- Bluetooth® handsfree phone (p. 57)

Phone book - searching for contacts

Searching for contacts in the phone book (p. 60).

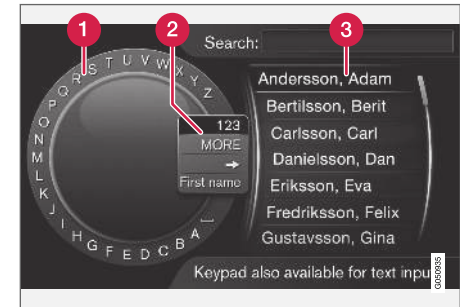

Searching using the character wheel.

- 1 Character list
- 2 Changing the input mode (see following table)
- 3 Phone book

To search for a contact, in the normal view for the phone source, press **OK/MENU** and select **Contacts**.

1. Turn **TUNE** to the required letter, press **OK/MENU**. The number and letter buttons on the control panel in the centre console can also be used.

- 2. Continue with the next letter. The result of the search is shown in the phone book (3).
- 3. To change the input mode to numbers or special characters, or to go to the phone book, turn **TUNE** to one of the options (see explanation in the table below) in the list for changing the input mode (2), press **OK/MENU**.

123/ABC	Change between letters and numbers with OK/MENU .
MORE	Change to special characters with OK/MENU .
=>	Leads to the phone book (3). Turn TUNE to select a contact, press OK/MENU to see the saved numbers and other information.
First name/ Last name	Changes the sort order in the phone book.

A short press on **EXIT** deletes an input character. A long press on **EXIT** will clear all entered characters.

Enter with the numerical keyboard



Numerical keyboard.

Another way of entering characters is to use the centre console's buttons **0-9**, ***** and **#**.

When e.g. **9** is pressed, a bar appears with all characters²⁵ under the buttons, e.g. **W, x, y, z** and **9**. Quick presses on the button move cursor through these characters.

- Stop with the cursor on the desired character in order to select it - the character is shown on the enter line.
- Delete/change using **EXIT**.

To enter a number, hold in the corresponding number key.

Related information

- Audio and media - operating the system (p. 28)
- Bluetooth® handsfree phone (p. 57)

²⁵ The character for each button may vary depending on market/country/language.

Voice recognition

Voice recognition allows the driver to voice-activate certain functions in the multimedia system, in the radio, in a Bluetooth®-connected mobile phone or in Volvo's navigation system*.

Voice commands allow the driver to concentrate on driving and focus attention on the road and traffic situation.

⚠ WARNING

The driver always holds overall responsibility for driving the vehicle in a safe manner and complying with all applicable rules of the road.

The voice recognition system allows the driver to voice-activate certain functions in the multimedia system, in the radio, in a Bluetooth®-connected mobile phone or in Volvo's navigation system*, while the driver can keep his/her hands on the steering wheel at the same time.

Voice recognition control takes place in dialogue form with spoken commands from the user and verbal response from the system.

The voice recognition system uses the same microphone as the Bluetooth® handsfree system, see Bluetooth® handsfree phone - overview (p. 58), and the voice recognition system's replies come via the car's speakers.

Getting started with voice recognition



Steering wheel keypad.

1 Button for voice recognition

- Press the button for voice recognition (1) in order to activate the system and initiate a dialogue with voice commands. The system will then display commonly used commands in the screen in the centre console.

Keep the following things in mind when you use the voice recognition system:

- For a command - speak after the tone, with normal voice at normal speed.
- Do not speak while the system is replying (the system cannot understand commands during this time).
- Avoid background noise in the passenger compartment by keeping doors, windows and the sunroof* closed.

i NOTE

If the driver is unsure of which command to use, he/she can say "Help" - the system then responds with several different commands which can be used in the current situation.

Voice recognition can be disabled by:

- saying "Cancel"
- Press **EXIT** or another main source button (e.g. **MEDIA**).

Volume

Voice recognition system volume is adjusted using the centre console's **VOL** control when the system is speaking.

Connecting a mobile phone

Before voice commands to a mobile phone can be used the mobile phone must be registered and connected via Bluetooth® handsfree. If a telephone command is given and no mobile phone is connected then the system will provide information about this. For information on registering and connecting a mobile phone, see Registering a Bluetooth® device (p. 54).

Language options for voice recognition

Possible language options for voice recognition (p. 63) are selected in the menu system MY CAR.

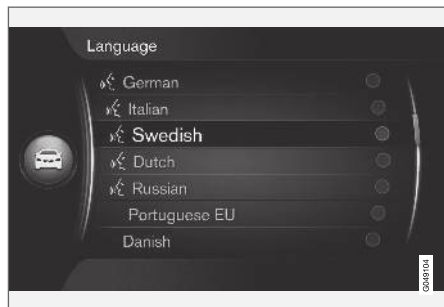

Language list.

Voice recognition is not possible for all languages. Languages available for voice recognition are marked with an icon in the language list - . Changing the language is performed in the menu system MY CAR (p. 14).

NOTE

Changing the language for voice recognition is not possible without also changing the language for whole the menu system.

Help functions for voice recognition

Help functions are available to help you become familiar with the voice recognition system (p. 63) and to give you the opportunity to teach the system your voice and your accent.

- **Voice tutorial:** A function that helps you get familiar with the system and the procedure for giving commands.
- **Voice training:** A function that enables the voice recognition system to learn to know your voice and your accent. The function provides an opportunity to voice train one user profile.
- **Brief instructions:** A function that reads out brief instructions about how the system works.



NOTE

Voice recognition instructions and voice training can only be started when the car is parked.

Voice tutorial

The instructions can be started in the normal view for MY CAR (p. 14) by pressing **OK/MENU** and then selecting **Settings → Voice control settings → Tutorial**.

The instructions are divided into 3 lessons, which take approximately 5 minutes in total to com-

plete. The system starts with the first lesson. To skip a lesson and go to the next one, press . Go back to the previous lesson by pressing .

End the instructions by pressing **EXIT**.

Voice adaptation

The system displays a number of phrases for you to say. Voice adaptation can be started in the normal view for MY CAR by pressing **OK/MENU** and then selecting **Settings → Voice control settings → Speaker adaptation**.

After voice adaptation has been completed, remember to select the profile (p. 65) **Trained user** under **User setting**.

Note that if a different language option for voice recognition (p. 64) is selected, then new voice training is required.

Brief instructions

The system reads out brief instructions for voice recognition. The instructions are started by pressing the button for voice recognition (p. 63) and saying "**Brief instructions**".

Voice recognition - settings

Several settings for the voice recognition system (p. 63) can be made.

- **User setting** - Voice profile can be set in the normal view for MY CAR (p. 14) by pressing **OK/MENU** and then selecting **Settings** → **Voice control settings** → **User setting**. Select between **Default** or **Trained user**. **Trained user** can only be selected if voice training (p. 64) has been carried out.
- **Synthetic voice speed** - The reading speed for the system's dynamic (not pre-recorded) text-to-speech voice can be changed in the normal view for MY CAR by pressing **OK/MENU** and then selecting **Settings** → **Voice control settings** → **Read out speed**. Select between **Fast**, **Medium** and **Slow**.
- **Voice recognition volume** - System voice volume can be changed by pressing the **SOUND** button, turning **TUNE** to **Voice control volume** and pressing **OK/MENU**. Adjust the voice volume by turning **TUNE** and save the setting with **OK/MENU**.

Voice recognition - voice commands

It is possible to voice control (p. 63) certain functions in the multimedia system and in a Bluetooth®-connected mobile phone with predefined voice commands.

The driver initiates a dialogue with voice commands by pressing the button for voice recognition (p. 63).

Once a dialogue has been started, commonly used commands will be shown in the screen.

When the driver becomes accustomed to the system, he/she can speed up the command dialogue and skip the prompts from the system, by briefly pressing the button for voice recognition.

Commands can be given in several ways

The command for searching for an audio track in the media player can be given in several stages or as a short command:

- Say "**Media search**", wait for the system to respond, and then go on to say e.g. "**Track**".

or

- Say "**Search for a track**" in a sequence.

Related information

- Voice recognition - quick commands (p. 66)
- Voice recognition - mobile phone (p. 66)

- Voice recognition - radio (p. 67)
- Voice recognition - multimedia (p. 68)

Voice recognition - quick commands

Voice recognition (p. 63) can be carried out using a number of predefined quick commands.

Quick commands for the multimedia system and the phone can be found in the normal view for MY CAR (p. 14) by pressing **OK/MENU** and then selecting **Settings → Voice control settings → Command list → Global commands, Phone commands, Media commands, Radio commands and Navigation commands***.

The help text for each command tells whether the command can be used in all sources or if it can only be used in one source.

Voice recognition - mobile phone

Voice control (p. 63) a Bluetooth®-connected mobile phone to e.g. call a contact or dial a number.

The following dialogues are only examples; the system's response may vary depending on the situation.

Dial a number

The system understands the numbers **0** (zero) to **9** (nine). These numbers can be pronounced individually, in groups of several numbers at a time or whole numbers all at once. Numbers greater than **9** (nine) cannot be handled by the system; for example, it is not possible to use **10** (ten) or **11** (eleven).

The following dialogue with voice commands dials a number.

1. The user starts the dialogue by saying: "**Dial number**".
 - > The system responds with: "**Say the number**".
2. Start saying the numbers (as individual units, i.e. "**Six-eight-seven**" etc.) in the phone number.
 - > At the pause, the system will repeat the last spoken group of numbers.

3. Continue to say the numbers. When the whole number has been spoken, end by saying: "**OK**".
 - > The system dials the number.

The number can be changed the number by saying "**Correct**" (which deletes the last spoken group of numbers) or "**Erase**" (which deletes the whole spoken phone number). By saying "**Repeat**" the system will read out the whole spoken number.

Call a contact

The following dialogue with voice commands calls a contact in the phone book.

1. The user starts the dialogue by saying: "**Call contact**".
 - > The system responds with: "**Say the name**".
2. Say the name of the contact.
 - > If only one contact is found then the system calls the contact, otherwise the system continues to give instructions for finding the right contact.

If a contact has multiple numbers entered in the phone book then it is possible to say, for example, "**Mobile**" or "**Work**" after the name in order to help the system.

More commands

More commands for voice recognition control of a mobile phone can be found in the normal view

for MY CAR (p. 14) by pressing **OK/MENU** and then selecting **Settings → Voice control settings → Command list → Phone commands**.

Related information

- Bluetooth® handsfree phone (p. 57)

Voice recognition - radio

Voice control (p. 63) the radio to e.g. change station.

The following dialogues are only examples; the system's response may vary depending on the situation.

Change station

The following dialogue with voice commands changes the radio station.

1. The user starts the dialogue by saying: **"Select station"**.
 - > The system responds with: **"Say the station's name"**.
2. Say the name of the radio station.
 - > The system changes to the radio station's broadcast.

Change frequency

The system understands numbers between **87.5** (eighty-seven-point-five) and **108.0** (hundred eight-point-zero).

The following dialogue with voice commands changes the radio frequency.

1. The user starts the dialogue by saying: **"Frequency"**.
 - > The system responds with: **"Say the frequency"**.

2. Say a frequency between 87.5 and 108.0 megahertz.
 - > The system changes to the radio frequency.

More commands

More commands for voice recognition control of the radio can be found in the normal view for MY CAR (p. 14) by pressing **OK/MENU** and then selecting **Settings → Voice control settings → Command list → Radio commands**.

Related information

- Radio (p. 36)

Voice recognition - multimedia

Voice control (p. 63) the multimedia system to e.g. change source or change track.

The following dialogues are only examples; the system's response may vary depending on the situation.

Change source

The following dialogue with voice commands changes the media source.

- The user starts the dialogue by saying: **"Disc"**.
 - > The system changes to the CD/DVD player.

Other sources are accessed by instead saying e.g. **"Bluetooth"**, **"TV"** or **"USB"**. The sources it is possible to change to depend on what is connected at the time, and whether there is any playable media in the source. If a media source is not available then the system explains why.

Change track

The system understands the numbers **0** (zero) to **99** (ninety-nine). Numbers higher than **99** (ninety-nine) cannot be handled by the system, e.g. **100** (hundred) or **101** (hundred-and-one) are not possible.

The following dialogue with voice commands changes the track.

1. The user starts the dialogue by saying: **"Select track"**.
 - > The system responds with: **"Say the track number"**.
2. Say the track number (as a single number, i.e. **"Twenty-three"** and not **"Two-three"**).
 - > The system changes to the track number for the active media source.

Search media

The following dialogue with voice commands searches for media.

1. The user starts the dialogue by saying: **"Media search"**.
 - > The system shows a numbered list of possible search categories and responds with: **"Select a line number, or say a category for media search"**.
2. Say a line number or a search category.
 - > The system gives further instructions for finding the right media.

More commands

More commands for voice recognition control of the multimedia system can be found in the normal view for MY CAR (p. 14) by pressing

OK/MENU and then selecting **Settings** →

Voice control settings → **Command list** → **Media commands**.

Related information

- Media player (p. 43)

Internet-connected car

Connecting the car to the Internet gives the opportunity to use, for example, the car's built-in web browser (p. 75), navigation services, web radio and music services via application programs (apps)(p. 73).



The apps can be used when the car is connected to the Internet. The apps that are available may vary, but app type can include navigation services, social media, Internet radio and music services, for example. The car has a simple web browser to search and display information from the Internet.

If the Internet connection is via the mobile phone it also possible to use the other mobile phone functions, such as reading text messages and calling, see Bluetooth® handsfree phone (p. 57).

Mobile phone and network operator must support tethering (sharing the Internet connection) and the subscription must include data traffic.

i NOTE

Data is transferred when using the internet (data traffic), which can have a cost.

Activation of data roaming can result in further charges.

Contact your network operator about the cost for data traffic.

For basic operation, read how the system is operated and menu navigation (p. 28).

Connect the car to the Internet

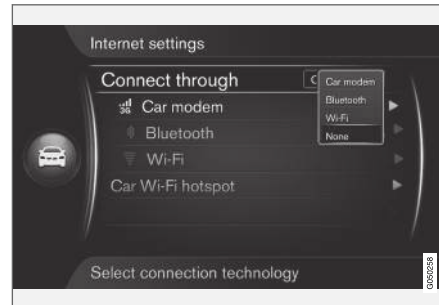

Settings for Internet connection.

The Internet connection's default setting is to not connect to the Internet. After a connection option has been selected, the selected option will be retained and the car will automatically connect when the network is available. To change the Internet connection method, choose another connection option. In order to not automatically connect to the Internet, choose to cancel the network connection.

Select connection option: Bluetooth®, Wi-Fi or car modem*:

Car modem*²⁶

When connecting to the Internet using the car modem, the Volvo On Call services will use the connection.

To connect with the car modem, see Car modem* (p. 71).

²⁶ Only cars with Volvo On Call

Bluetooth®

1. The mobile phone must first be registered and connected to the car (p. 54).
2. Activate tethering (sharing the Internet connection (portable/personal hotspot)) in the mobile phone.
3. Press **MY CAR** in order to reach the normal view for the source. Then press **OK/MENU** and select **Settings → Internet settings → Connect through → Bluetooth**.
 - > The car is now connected.

In the future, the car will automatically connect via Bluetooth® to an available network.

A symbol in the screen (p. 32) shows the current connection status.

To cancel the network connection, see Cancel network connection.

The car can remember a maximum of 10 Bluetooth® networks. If one more is added then the oldest network and password are removed from the list of remembered networks.

Wi-Fi



1. Activate tethering (sharing the Internet connection (portable/personal hotspot)) in the mobile phone.
2. Press **MY CAR** in order to reach the normal view for the source. Then press **OK/MENU** and select **Settings → Internet settings → Connect through → Wi-Fi**.
 - > The search for available Wi-Fi networks is started.
3. Select your network.
4. Select **Connect**.
5. Enter the network password.
 - > The car now attempts to connect to the network.

In the future, the car will automatically connect via Wi-Fi to an available network. Note that certain phones switch off tethering after the contact with the car has been disconnected, e.g. when leaving the car and until the next time it is used. The tethering in the phone therefore needs to be reactivated the next time it is used.

A symbol in the screen (p. 32) shows the current connection status.

To cancel the network connection, see Cancel network connection.

The car can remember a maximum of 10 Wi-Fi networks. If one more is added then the oldest network and password are removed from the list of remembered networks.

Remove saved Wi-Fi network

1. Press **MY CAR** in order to reach the normal view for the source.
2. Then press **OK/MENU** and select **Settings → Internet settings**.
3. Select **Wi-Fi**.
 - > A list of available networks is shown.
4. Select the network to be removed.
5. Select **Forget**.
 - > The car will no longer connect to the network automatically.

Remove all networks

All networks can be removed simultaneously. Please note that all user data and all system settings are reset to original factory settings.

To restore factory settings press **MY CAR** in the centre console, then **OK/MENU** and select

Settings → Reset to factory settings.

Technology and security for Wi-Fi

It is only possible to connect to the following types of network:

- Frequency - 2.4 GHz.
- Standards - 802.11 b/g/n.
- Security type - WPA2-AES-CCMP.

If several devices operate on the frequency at the same time then it may result in reduced performance.

Cancel network connection

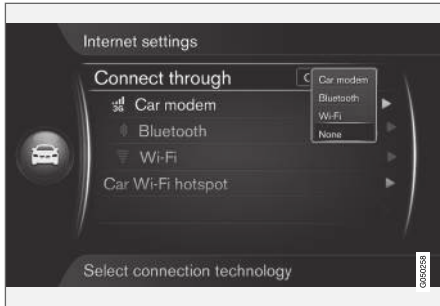

Press **OK/MENU** and select **Settings** → **Internet settings** → **Connect through** → **None**. The car will not connect to the Internet.

No or poor Internet connection

The amount of data transferred is dependent on the services or apps that are used in the car. For example streaming audio can require large amounts of data which requires a good connection and good signal strength.

Mobile phone to car

The speed of the connection may vary depending on the location of the mobile phone in the car. Move the mobile phone closer to the car's audio and media system in order to increase the signal strength. Ensure that there is no interference in between.

Mobile phone to network

The speed of the mobile network varies depending on the coverage in the present location. Poor network coverage may occur, for example in tunnels, behind mountains, in deep valleys or indoors. The speed also depends on the agreement you have with your network.

i NOTE

In the event of problems with data traffic, contact your network operator.

Related information

- Symbols in the screen (p. 32)
- Change of ownership (p. 10)

Car modem*27

The car is equipped with a modem that can be used to connect the car to the Internet. It is also possible to distribute the Internet connection via Wi-Fi.

Internet connection

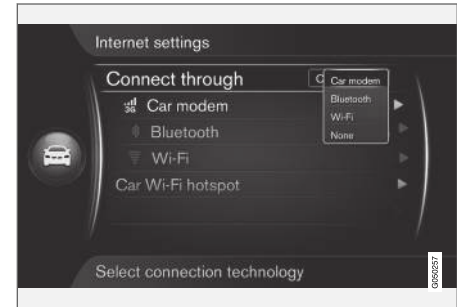

²⁷ Only cars with Volvo On Call.

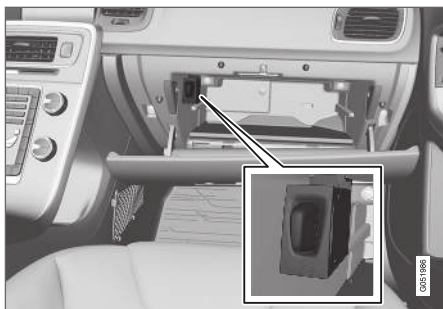

Holder for SIM card in the glove box.

1. Fit your personal SIM card in the holder which is located in the glovebox.
2. Press **MY CAR** in order to reach the normal view for the source. Then press **OK/MENU** and select **Settings** → **Internet settings** → **Car modem**.
3. Enter the SIM card's PIN code.
 - > The car connects to the Internet and it is possible to use its Internet functions, see Internet-connected car (p. 69).

i NOTE

To avoid having to enter the PIN code every time the car is restarted it is recommended to switch off the PIN code lock. Press **MY CAR** to reach the normal view for the source. Then press **OK/MENU** and select **Settings** → **Internet settings** → **Car modem**. Deselect the check box **Lock SIM card**.

i NOTE

Data is transferred when using the internet (data traffic), which can have a cost.

Activation of data roaming can result in further charges.

Contact your network operator about the cost for data traffic.

To deactivate the Internet connection, press **MY CAR** in order to reach the normal view for the source. Then press **OK/MENU** and select **Settings** → **Internet settings** → **None**.

Share Wi-Fi-hotspot



When the car is connected to the Internet via car modem it is possible to distribute the Internet connection (Wi-Fi-hotspot) so that other devices can use the car modem.

The network operator (SIM card) must support tethering (distribution of Internet connection).

1. Press **MY CAR** in order to reach the normal view for the source. Then press **OK/MENU** and select **Settings** → **Internet settings** → **Car Wi-Fi hotspot**
2. Enter the name of the Wi-Fi network (SSID) and enter a password. The name should contain 6-32 characters, and the password 10-63 characters. It is possible to change the name and password later on.

3. Activate the car's Wi-Fi hotspot by marking the check box.
 - > It is now possible for external devices to connect to the car's Wi-Fi-hotspot.

To deactivate distribution of Internet connection - uncheck the box.

i NOTE

Activation of Wi-Fi-hotspot can result in further charges from your network operator.

Contact your network operator about the cost for data traffic.

Up to 8 devices can be connected to the car's Wi-Fi hotspot.

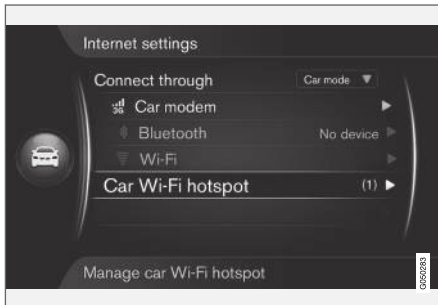

The number of devices connected to the car's Wi-Fi hotspot.

To show the number of devices connected to the car's Wi-Fi-hotspot:

- Press **MY CAR** in order to reach the normal view for the source. Then press **OK/MENU** and select **Settings** → **Internet settings**

Select **Car Wi-Fi hotspot** to show which devices are connected to the car's Wi-Fi hotspot.

Technology and security for the Wi-Fi hotspot

The 2.4GHz frequency is used for allocating the Wi-Fi hotspot. If multiple devices are operating on the frequency at the same time then it can result in impaired performance.

- Frequency - 2.4 GHz.
- Standards - 802.11 b/g/n.
- Security type - WPA2-AES-CCMP.
- The antenna for the car's modem is fitted on the car's roof.

No or poor Internet connection

See Internet-connected car (p. 69).

Related information

- Internet-connected car (p. 69)
- Symbols in the screen (p. 32)

Apps

Applications (apps) are applications that can be used if the car is connected to the Internet. App types can, for example, be navigation services, social media, Internet radio and music services.

For basic use and navigation, read how the system is operated and menu navigation (p. 28).

To use the apps, the car must first be connected to the Internet (p. 69).

A symbol (p. 32) is shown in the upper right-hand corner of the screen when the car is connected to the Internet. If no Internet connection is available then this will be advised in the screen.

i NOTE

Data is transferred when using the internet (data traffic), which can have a cost.

Activation of data roaming can result in further charges.

Contact your network operator about the cost for data traffic.

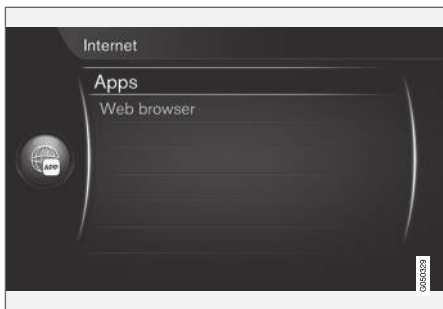

Press  in the centre console and select **Apps** to display available apps²⁸. Select an app in the list and start with **OK/MENU**.

The apps are downloaded from the Internet to the car and are run from there. The apps load (are updated) each time that they are started, which means that an Internet connection is required each time an app is used.

The apps share the car's location information

Some apps require location information. The apps use GNSS (Global Navigation Satellite System) to locate the car.

The position of the car may also be sent to Volvo's service providers. The service providers work on behalf of Volvo and may only process location

information to the extent required in order to provide the service.

All subcontractors are bound by agreements requiring them to observe confidentiality and to treat location information in accordance with legislation in force.

Login

Some apps/services require a login. There are two types:

- Certain apps may require registration with the app/service provider. When the app starts you are informed about any need to log in. Follow the onscreen instructions to register or use an existing account to log in.
- Certain apps/services require a login with a personal Volvo ID. Register or use an existing account and get access to a number of beneficial services, e.g. send an address from a map service on the Internet directly to a navigation app or Volvo's navigation system*²⁹. For more information and how you create an account, see Volvo ID (p. 11).

Navigation services

Navigation services give road information which leads to a preset destination. However, not all of the recommended guidance is always guaranteed as reliable, since situations may arise that lie

outside the capacity and judgement of the system, such as sudden changes in the weather.

⚠ WARNING

Observe the following.

- Direct all your attention to the road and make sure that all your concentration is on driving.
- Follow applicable traffic legislation and drive with good judgment.
- Due to weather conditions or time of year affecting the road conditions, some recommendations may be less reliable.

i NOTE

It is possible to upgrade to Sensus Navigation which includes more functions and map data updates. Contact your dealer.

Related information

- Symbols in the screen (p. 32)
- Change of ownership (p. 10)

²⁸ The apps available may vary over time and vary depending on equipment level and market.

²⁹ Sensus Navigation.

Web browser³⁰

The car has a built-in web browser that makes it possible to search and display information from the Internet.

For basic operation, read how the system is operated and menu navigation (p. 28).

The web browser is a simple type and supports the HTML 4 standard in text and images. The web browser does not support moving images, video and audio. It is not possible to download and save files.

To use the web browser, the car must first be connected to the Internet (p. 69).

i NOTE

Data is transferred when using the internet (data traffic), which can have a cost.

Activation of data roaming can result in further charges.

Contact your network operator about the cost for data traffic.

i NOTE

The web browser is not available while driving.

Press the Connect button in the centre console  and select **Web browser**.

When connected to the Internet using Bluetooth® the Bluetooth® symbol (p. 32) is shown in the top right hand corner of the screen.

If no Internet connection is available then this will be advised in the screen.

Search function

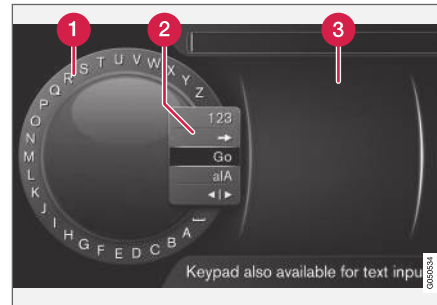

Searching using the character wheel.

- 1** Character list.
- 2** Changing the input mode (see following table).
- 3** Recently visited web pages (history).

Use the character wheel to enter a web address URL, e.g. www.volvocars.com.

1. Turn **TUNE** to the desired letter, press **OK/MENU** to confirm. The number and letter buttons on the control panel in the centre console can also be used.
2. Continue with the next letter.
3. To change the input mode to numbers or special characters, load the address entered or to go to the history, turn **TUNE** to one of the options (see explanation in the following table) in the list for changing the input mode (2), press **OK/MENU**.

123/A BC	Change between letters and numbers with OK/MENU .
=>	Leads to history (3). Turn TUNE to select a web address URL, press OK/MENU to go to the address.
Go	Loads the entered web address URL with OK/MENU .

³⁰ Applies to certain markets

◀▶	<p>a A Changes between lowercase and uppercase letters with OK/MENU.</p>
◀▶	<p>Changes from the character wheel to the Address: field. Move the cursor with TUNE. Delete any misspelling with EXIT. To return to the character wheel, press OK/MENU. Note that the digit and letter buttons on the control panel can be used for editing in the Address: field.</p>

A short press on **EXIT** deletes an input character. A long press on **EXIT** will clear all entered characters.

Enter with the numerical keyboard



Numerical keyboard.

Another way of entering characters is to use the centre console's buttons **0-9**, * and #.

When e.g. **9** is pressed, a bar appears with all characters³¹ under the buttons, e.g. **W, x, y, z** and **9**. Quick presses on the button move cursor through these characters.

- Stop with the cursor on the desired character in order to select it - the character is shown on the enter line.
- Delete/change using **EXIT**.

To enter a number, hold in the corresponding number key.

Navigating in the web browser

Turn **TUNE** to navigate between links or scroll on the web page. Press **OK/MENU** to activate the selection/highlighted link.

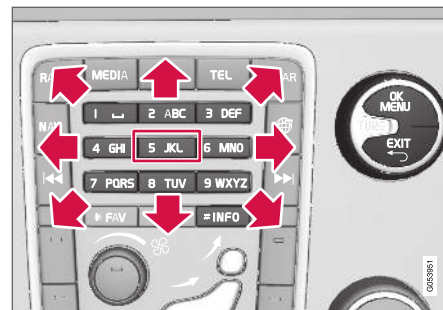

Moving the cursor on a web page.

The cursor can be moved freely across the page with the keypad in the centre console. Press the **INFO** button in order to change to the menu bar at the top of the page.

The pop-up menu is accessed with button number **5** in the centre console. Alternatively, move the cursor to a non-clickable area and press **OK/MENU**.

Functions

Available functions are accessed via pop-up menu button number **5** in the centre console. Alternatively, move the cursor to a non-clickable area and press **OK/MENU**.

- **Back** - Backs out to the previous page.
- **Forward** - If you have gone back out it is possible to go forward to the page again.

³¹ The character for each button may vary depending on market/country/language.

- **Reload** - Updates the page.
- **Stop** - Stops loading the page and goes back.
- **New tab** - Create a new tab/page. Up to four tabs can be open at the same time.
- **Close tab** - Closes tab/page.
- **Zoom in/Zoom out** - Zooms in/out on the page.
- **Add bookmark/Delete bookmark** - Instead of typing in a web page address each time it is visited, it is possible to store a quick link (bookmark) to the page. Max. 20 bookmarks can be saved.
- **Settings** - Adapting the web browser display and information management, see below for more information.

Settings

- **Bookmarks - Rename, Reorder or Delete.**
- **Content filtering** - It is possible to make certain adaptations so that the web pages are shown in the desired way. The following functions can be activated/deactivated: **Show images, Block pop-ups** and **Enable JavaScript**.
- **Accept cookies** - Cookies are small text files that are stored. They make it possible to use certain functions on web pages and for the website owner to track statistics, for

example over which pages visitors navigate to.

- **Text size** - Select the character size to be used: **Large, Medium** or **Small**.
- **Clear browsing data – Cookies, browsing history and cache will be cleared.**
- **FAV key options** -It is possible to link certain functions to the **FAV** button. A linked function is then activated simply by pressing the **FAV** button, see Favourites (p. 33).

Related information

- Symbols in the screen (p. 32)
- Change of ownership (p. 10)
- Menu overview - web browser (p. 90)

TV*

The TV picture is only shown when the car is stationary. There will be no picture when the car is moving, but the audio continues to be played back. The picture reappears when the car has stopped.



TV functions, control overview.

For basic information on playback and navigation, read how the system is operated and menu navigation (p. 28). See below for a more detailed description.

It is possible to link certain functions to the **FAV** button. A linked function is then activated simply by pressing the **FAV** button, see Favourites (p. 33).



i NOTE

This system only supports TV broadcasts in the countries that broadcast in MPEG-2 or MPEG-4 format and follow the DVB-T standard. The system does not support analogue broadcasts.

i NOTE

The TV picture is only shown when the car is stationary. There will be no picture when the car is moving, but the audio continues to be played back. The picture reappears when the car has stopped.

i NOTE

The reception is dependent both on how good the signal strength and signal quality are. The transmission may be disturbed by various factors such as tall buildings or the TV transmitter being far away. Coverage level can also vary depending on where in the country you are located.

! IMPORTANT



A TV licence is required for this product in some countries.

Watch TV

- In the normal view for the media source, press **MEDIA**, turn **TUNE** to **TV** and then press **OK/MENU**.
 - > A search starts and after a short while the most recently used channel is shown.

Changing channel

It is possible to change channel as follows:

- Turn **TUNE**, a list of all available channels in the area is shown. If any of these channels is already saved as a preset (p. 79) then its preset number is shown to the right of the channel name. Turn **TUNE** to the required channel and press **OK/MENU**.
- By pressing the preset buttons (0-9).
- Via a short press on the  /  buttons the next available channel in the area is shown.

i NOTE

If no reception is available when a channel is selected from the preset buttons, it may be because the car is in a different location than when the last channel search was performed and the channel list was stored.

Related information

- Teletext* (p. 80)
- Picture settings (p. 48)

- Reception of TV* channel is lost. (p. 80)
- Menu overview - TV* (p. 91)

TV* channels/preset list

Searching of TV channels takes place automatically and continuously from the car. The available channels are saved in a channel list. The channel list search criteria can be changed, but not the order. There is also a preset list in which the order of the presets can be changed.

Change in the preset list

You can change the order of the channels that are shown in the preset list. A TV channel can have more than one place in the preset list. The TV channel positions can also vary in the preset list.

1. To change the order in the preset list, in the normal view for the TV source, press **OK/MENU** and select **Presets**.
2. Turn **TUNE** to the channel you want to move in the list and confirm with **OK/MENU**.
> The selected channel is highlighted.
3. Turn **TUNE** to the new location in the list and confirm with **OK/MENU**.
> The channels change places with each other.

After the preset channels (max. 30) come all the other channels available in the area. It is possible to move a channel up to a place in the preset list.

Related information

- Audio and media - operating the system (p. 28)

TV* - playback options

Functions in the TV can be edited.

Change subtitles

1. To change subtitling, in the normal view for the TV source, press **OK/MENU** and select **Subtitles**.
2. Turn **TUNE** to the subtitling you want and press **OK/MENU**.
> The selected subtitling will now be used.

Changing the audio language

1. To change audio language, in the normal view for the TV source, press **OK/MENU** and select **Audio tracks**.
2. Turn **TUNE** to the audio track you want and press **OK/MENU**.
> The selected audio track will now be used.

Related information

- Audio and media - operating the system (p. 28)
- Favourites (p. 33)

Information about the current TV* programme

Press the **INFO** button (p. 28) in order to display information about the current programme, the next programme and its start time.

Press the **INFO** button again to show more information about the current programme. In some cases, additional information may be available, such as start and finish times as well as a brief description of the current programme.

To return to the TV picture, wait several seconds or press **EXIT**.

Related information

- Audio and media - operating the system (p. 28)

Teletext*

It is possible to look at Teletext.

Proceed as follows:

1. To watch Teletext, in TV mode go to **TV menu** → **Teletext**.
2. Enter the page number (3 digits) with the number keys (0-9) to select page.
 - > The page is shown automatically.

Enter a new page number or turn **TUNE** to go to the next page.

Return to TV screen with **EXIT**.

Related information

- Audio and media - operating the system (p. 28)
- TV* (p. 77)
- Remote control* (p. 80)

Reception of TV* channel is lost.

If the reception for the TV channel that is being shown disappears then the picture will freeze. When the reception returns the display starts again.

If the reception for the TV channel that is being shown disappears then the picture will freeze. Shortly after this a message appears informing that the reception has been lost for the current TV channel, and a new search for the channel continues. When the reception returns the display of the TV channel starts immediately. It is possible to change channel at any time when the message is shown.

If the message **No reception** is shown then this is because the system has detected that there is not full reception for all TV channels.

Related information

- Audio and media - operating the system (p. 28)
- TV* (p. 77)
- TV* channels/preset list (p. 79)

Remote control*

The remote control can be used for all functions in the audio and media system. The remote control's buttons have the same functions as the buttons in the centre console or steering wheel keypad.



1 Corresponds to **TUNE** in the centre console.

When using the remote control, first press the remote control's button **L F R** to position **F**. Then

aim the remote control at the IR receiver, which is located to the right of the **INFO** button (p. 28) in the centre console.

WARNING

Keep loose objects such as mobile phones, cameras, remote controls for accessories, etc. in the glove compartment or other compartments. Otherwise they may injure people in the car in the event of sudden braking or a collision.

NOTE

Do not expose the remote control to direct sunlight (e.g. on the instrument panel) - otherwise problems may arise with the batteries.

Related information

- Audio and media - operating the system (p. 28)

Remote control* - functions

Possible functions to be controlled using the remote control.

Key	Function
L F R	F = Front display screen L and R = Not possible options.
NAV	Change to navigation*
RADIO	Change to radio source (e.g. AM)
MEDIA	Change to media source (e.g. Disc , TV*)
TEL	Change to Bluetooth® handsfree
	Scroll/fast rewind, change track/song
	Play/pause
	Stop
	Scroll/fast forward, change track/song
DVD MENU	Menu
EXIT	To previous, cancels function, deletes input characters



Key	Function
	Navigate up/down
	Navigate right/left
OK MENU	Confirm selection or go to the menu system for the selected source
	Volume, decrease
	Volume, increase
0-9	Preset channels, number and letter input
FAV *	Shortcuts for favourite setting
INFO #	Information about the current programme, song, etc. Also used when there is more information available than can be shown in the display screen
	Selection of language for sound-track
	Subtitles, selection of language for text
	Teletext*, On/Off

Related information

- Audio and media - operating the system (p. 28)

Remote control* - battery replacement

How to replace the batteries in the remote control for the audio and media system.

NOTE

Battery life is normally 1-4 years and depends on how much the remote control is used.

The remote control is powered by four batteries of the AA/LR6 type. Take extra batteries with you for a long journey.

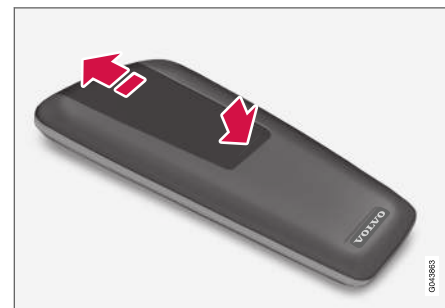

1. Push down the catch on the battery cover and slide the battery cover in the direction of the infrared lens.
2. Remove the used batteries, turn the new batteries in accordance with the symbols in the battery compartment and fit them.
3. Refit the cover.

 NOTE

Be sure to dispose of the exhausted batteries in an environmentally safe manner.

Audio and media - menu overview

Overview of possible options and settings in the audio and media system menus.

If the text in a menu bar is light grey then it is not possible to select this option. This may be because the function is not available in the car, that the source is not active or connected, or does not contain anything.

RADIO

- AM (p. 84)³²
- FM (p. 84)
- DAB *(p. 85)

MEDIA

- CD/DVD Audio (p. 85)
- DVD Video (p. 86)
- Hard disk drive (HDD) (p. 87)
- iPod (p. 87)
- USB (p. 88)
- Media Bluetooth® (p. 88)
- AUX (p. 89)³³
- TV* (p. 91)

TEL

- Bluetooth® handsfree (p. 89)



- Web browser (p. 90)

Related information

- Audio and media - operating the system (p. 28)

³² Does not apply to the V60 Twin Engine and S60L Twin Engine.

³³ Only applies to certain models.

Menu overview - AM

Overview of possible options and settings for AM radio.

AM menu ^A	See
Show presets	(p. 38)
FAV key options	(p. 33)
No function	
Show presets	(p. 38)

^A Does not apply to the V60 Twin Engine and S60L Twin Engine.

Related information

- Audio and media - operating the system (p. 28)

Menu overview - FM

Overview of possible options and settings for FM radio.

FM menu	See
TP	(p. 40)
Alternative frequency	
Show	
Radio text	(p. 41)
Presets	(p. 38)
None	
Tune station by	(p. 37)
Station list	(p. 38)
Manual tuning	(p. 38)
FAV key options	(p. 33)
No function	
Toggle radio text or presets	(p. 41) and (p. 38)

Related information

- Audio and media - operating the system (p. 28)

Menu overview - Digital radio (DAB)*

Overview of possible options and settings for DAB radio.

DAB menu*	See
Programme type (PTY) filtering	(p. 41)
Show	
Artist/Title	
Radio text	(p. 41)
Presets	(p. 38)
None	
DAB-DAB linking	(p. 43)
FAV key options	(p. 33)
No function	
Toggle show information	

Related information

- Audio and media - operating the system (p. 28)

Menu overview - CD/DVD Audio

Overview of possible options and settings for CD/DVD Audio.

Disc menu	See
Play/Pause	(p. 44)
Stop A	
Media search	(p. 45)
Shuffle	(p. 45)
Gracenote® options	
Gracenote® database	
Gracenote® results	
FAV key options	(p. 33)
No function	
Play/Pause	(p. 44)
Shuffle	(p. 45)

A Only applies to DVD discs.



◀◀ **Related information**

- Audio and media - operating the system (p. 28)

Menu overview - DVD Video

Overview of possible options and settings for DVD Video.

DVD video menu	See
Play/Pause	(p. 47)
DVD disc menu	(p. 47)
Stop	(p. 47)
Subtitles	(p. 47)
Audio tracks	(p. 47)
Advanced settings	
Angles	(p. 48)
Screen ratios	
FAV key options	(p. 33)
No function	
Play/Pause	(p. 47)

Next subtitle	(p. 47)
Next audio track	(p. 47)

Pop-up menu, DVD Video

Press **OK/MENU** when a video file is being played back in order to access the pop-up menu.

Image settings	(p. 48)
Video DVD menu	(p. 28)
DVD disc menu	(p. 47)

Related information

- Audio and media - operating the system (p. 28)

Menu overview - hard disk drive (HDD)

Overview of possible options and settings for hard disk drive (HDD).

HDD menu	See page
Play/Pause	(p. 48)
Media search	(p. 45)
Shuffle	(p. 45)
Import music	(p. 48)
From disc	
From USB	
A	
Rename/delete files	(p. 48)
Enter	
Rename	
Delete	

Delete all	
Storage information	(p. 48)
Used space:	
Free space:	
Capacity:	
Tracks:	
Folders:	
FAV key options	(p. 48)
No function	
Play/Pause	(p. 48)
Shuffle	(p. 45)

A Depending on market.

Related information

- Audio and media - operating the system (p. 28)

Menu overview - iPod®

Overview of possible options and settings for iPod®.

iPod menu	See
Play/Pause	(p. 50)
Shuffle	(p. 45)
FAV key options	(p. 33)
No function	
Play/Pause	(p. 50)
Shuffle	(p. 45)

Related information

- Audio and media - operating the system (p. 28)

Menu overview - USB

Overview of possible options and settings for USB.

USB menu	See
Play/Pause	(p. 50)
Media search	(p. 45)
Shuffle	(p. 45)
Select USB partition	
FAV key options	(p. 33)
No function	
Play/Pause	(p. 50)
Shuffle	(p. 45)

Related information

- Audio and media - operating the system (p. 28)

Menu overview - Media Bluetooth®

Overview of possible options and settings for Media Bluetooth®.

Bluetooth menu	See
Play/Pause	(p. 53)
Shuffle	(p. 45)
Change device	(p. 56)
Search new device	
Make car discoverable	
FAV key options	(p. 33)
No function	
Play/Pause	(p. 53)
Shuffle	(p. 45)
Device 1 Device 2 etc.	

Connect for media	(p. 53)
Delete device	(p. 57)

Related information

- Audio and media - operating the system (p. 28)

Menu overview - AUX

Overview of possible options and settings for AUX³⁴.

AUX menu	See
AUX input	(p. 52)
Standard	
Boost	

Related information

- Audio and media - operating the system (p. 28)

Menu overview - Bluetooth® handsfree

Overview of possible options and settings for Bluetooth® handsfree.

Phone menu	See
Call list	(p. 59)
Contacts	(p. 60)
Messages	(p. 57)
Message notifications	(p. 57)
Change phone	(p. 56)
Search new phone	
Make car discoverable	
Device 1 Device 2 etc.	

Connect for phone	(p. 57)
Delete device	(p. 57)

Related information

- Audio and media - operating the system (p. 28)

³⁴ AUX only applies to certain models.

Menu overview - web browser³⁵

Overview of possible options and settings for web browser.

Web browser The menu is shown in normal view for web browser if no tab is open.	See
Enter address	(p. 75)
Settings Shows "Settings menu, web browser", see below.	
Bookmark 1 Bookmark 2 etc.	(p. 75)
Pop-up menu, web browser Press on button number 5 in the centre console when a page is shown in the web browser in order to access the pop-up menu.	See
Back	(p. 75)
Forward	(p. 75)

Reload	(p. 75)
Stop	(p. 75)
New tab	(p. 75)
Close tab	(p. 75)
Zoom in or Zoom out	(p. 75)
Add bookmark or Delete bookmark	(p. 75)
Settings Shows "Settings menu, web browser", see below.	
Settings menu, web browser Press Settings in one of the two above menus to access the settings menu.	See
Bookmarks	(p. 75)

Bookmark 1 Bookmark 2 etc.	
Rename	
Reorder	
Delete	
Content filtering	(p. 75)
Accept cookies	(p. 75)
Show images	
Block pop-ups	
Enable JavaScript	
Text size	(p. 75)
Large	

³⁵ Applies to certain markets

Medium	
Small	
Clear browsing data	(p. 75)
FAV key options	(p. 33)
No function	
Add/delete bookmark	(p. 75)
New tab	(p. 75)
Close tab	(p. 75)

Related information

- Audio and media - operating the system (p. 28)
- Audio and media - menu overview (p. 83)

Menu overview - TV*

Overview of possible options and settings for TV.

TV menu	See
Presets	(p. 79)
Audio tracks	(p. 79)
Subtitles	(p. 79)
Teletext	(p. 80)
FAV key options	(p. 79)
No function Teletext	

Pop-up menu TV	See
Press OK/MENU when the TV is being shown in order to access the pop-up menu.	
Image settings	(p. 48)

Brightness:	
Contrast:	
Colour:	
TV menu	
Shows "TV menu", see above.	

Related information

- Audio and media - operating the system (p. 28)

Licenses - audio and media

A license is an agreement for the right to operate a certain activity or the right to use someone else's entitlement according to the terms and conditions in the agreement. The following texts are Volvo's agreements with manufacturers/ developers.

Sensus software

This software uses parts of sources from clib2 and Prex Embedded Real-time OS - Source (Copyright (c) 1982, 1986, 1991, 1993, 1994), and Quercus Robusta (Copyright (c) 1990, 1993), The Regents of the University of California. All or some portions are derived from material licensed to the University of California by American Telephone and Telegraph Co. or Unix System Laboratories, Inc. and are reproduced herein with the permission of UNIX System Laboratories, Inc. Redistribution and use in source and binary forms, with or without modification, are permitted provided that the following conditions are met: Redistributions of source code must retain the above copyright notice, this list of conditions and the following disclaimer. Redistributions in binary form must reproduce the above copyright notice, this list of conditions and the following disclaimer in the documentation and/or other materials provided with the distribution. Neither the name of the <ORGANIZATION> nor the names of its contributors may be used to endorse or promote

products derived from this software without specific prior written permission. THIS SOFTWARE IS PROVIDED BY THE COPYRIGHT HOLDERS AND CONTRIBUTORS "AS IS" AND ANY EXPRESS OR IMPLIED WARRANTIES, INCLUDING, BUT NOT LIMITED TO, THE IMPLIED WARRANTIES OF MERCHANTABILITY AND FITNESS FOR A PARTICULAR PURPOSE ARE DISCLAIMED. IN NO EVENT SHALL THE COPYRIGHT OWNER OR CONTRIBUTORS BE LIABLE FOR ANY DIRECT, INDIRECT, INCIDENTAL, SPECIAL, EXEMPLARY, OR CONSEQUENTIAL DAMAGES (INCLUDING, BUT NOT LIMITED TO, PROCUREMENT OF SUBSTITUTE GOODS OR SERVICES; LOSS OF USE, DATA, OR PROFITS; OR BUSINESS INTERRUPTION) HOWEVER CAUSED AND ON ANY THEORY OF LIABILITY, WHETHER IN CONTRACT, STRICT LIABILITY, OR TORT (INCLUDING NEGLIGENCE OR OTHERWISE) ARISING IN ANY WAY OUT OF THE USE OF THIS SOFTWARE, EVEN IF ADVISED OF THE POSSIBILITY OF SUCH DAMAGE.

This software is based in part on the work of the Independent JPEG Group.

This software uses parts of sources from "libtess". The Original Code is: OpenGL Sample Implementation, Version 1.2.1, released January 26, 2000, developed by Silicon Graphics, Inc. The Original Code is Copyright (c) 1991-2000 Silicon Graphics, Inc. Copyright in any portions created by third parties is as indicated elsewhere herein.

All Rights Reserved. Copyright (C) [1991-2000] Silicon Graphics, Inc. All Rights Reserved. Permission is hereby granted, free of charge, to any person obtaining a copy of this software and associated documentation files (the "Software"), to deal in the Software without restriction, including without limitation the rights to use, copy, modify, merge, publish, distribute, sublicense, and/or sell copies of the Software, and to permit persons to whom the Software is furnished to do so, subject to the following conditions: The above copyright notice including the dates of first publication and either this permission notice or a reference to <http://oss.sgi.com/projects/FreeB/> shall be included in all copies or substantial portions of the Software. THE SOFTWARE IS PROVIDED "AS IS", WITHOUT WARRANTY OF ANY KIND, EXPRESS OR IMPLIED, INCLUDING BUT NOT LIMITED TO THE WARRANTIES OF MERCHANTABILITY, FITNESS FOR A PARTICULAR PURPOSE AND NONINFRINGEMENT. IN NO EVENT SHALL SILICON GRAPHICS, INC. BE LIABLE FOR ANY CLAIM, DAMAGES OR OTHER LIABILITY, WHETHER IN AN ACTION OF CONTRACT, TORT OR OTHERWISE, ARISING FROM, OUT OF OR IN CONNECTION WITH THE SOFTWARE OR THE USE OR OTHER DEALINGS IN THE SOFTWARE. Except as contained in this notice, the name of Silicon Graphics, Inc. shall not be used in advertising or otherwise to promote the sale, use or other dealings in this Software

without prior written authorization from Silicon Graphics, Inc.

This software is based in parts on the work of the FreeType Team.

This software uses parts of SSLeay Library: Copyright (C) 1995-1998 Eric Young (eay@cryptsoft.com). All rights reserved

Linux software

This product contains software licensed under GNU General Public License (GPL) or GNU Lesser General Public License (LGPL), etc.

You have the right of acquisition, modification, and distribution of the source code of the GPL/LGPL software.

You may download Source Code from the following website at no charge: http://www.embedded-carmultimedia.jp/linux/oss/download/TVM_8351_013

The website provides the Source Code "As Is" and without warranty of any kind.

By downloading Source Code, you expressly assume all risk and liability associated with downloading and using the Source Code and complying with the user agreements that accompany each Source Code.

Please note that we cannot respond to any inquiries regarding the source code.

Gracenote® End User License Agreement

This program or device contains software from Gracenote, Inc. of Emeryville, California, USA ("Gracenote"). The software from Gracenote ("Gracenote software") activates this program to perform disc and/or file identification and obtain music-related information, including name, artist, track and title ("Gracenote data") from online servers or embedded databases (together called "Gracenote servers") and in order to perform other actions. You may only use Gracenote data in accordance with the intended end-user functions for this program or this device.

You agree to only use Gracenote data, Gracenote software and Gracenote servers for your own personal non-commercial use. You agree not to assign, copy, transfer or transmit this Gracenote software or any Gracenote data to any third party. **YOU AGREE NOT TO USE OR EXPLOIT GRACENOTE DATA, GRACENOTE SOFTWARE OR GRACENOTE SERVERS, EXCEPT AS EXPRESSLY PERMITTED IN THIS AGREEMENT.**

You agree that your non-exclusive right to use Gracenote data, Gracenote software and Gracenote servers will be terminated if you violate these restrictions. If your license is terminated you agree to cease all use of Gracenote data, Gracenote software and Gracenote servers. Gracenote holds exclusive rights to all Gracenote data, all Gracenote software and all Gracenote servers, including all ownership rights. Gracenote

will under no circumstances have any obligation to pay you for any information you provide. You agree that Gracenote, Inc. may enforce the company's rights under this agreement against you directly in its own name.

The Gracenote service uses a unique identifier to track enquiries for statistical purposes. The purpose of a randomly assigned numeric identifier is to enable the Gracenote service to count enquiries without knowing anything about who you are. Additional information is available on the web page for Gracenote's privacy policy for the Gracenote service.

The Gracenote software and everything included in Gracenote data are licensed to you "as is". Gracenote provides no undertakings or warranties, express or implied, as to the accuracy of the Gracenote data contained in the Gracenote servers. Gracenote reserves the right to delete data from the Gracenote servers or to change data categories for any reason that Gracenote deems sufficient. No warranty is provided that the Gracenote software or Gracenote servers are fault-free or that the Gracenote software or Gracenote servers will operate without interruption. Gracenote has no obligation to provide you with new, improved or additional data types or categories that Gracenote may provide in the future, and the company reserves the right to discontinue its services at any time.



◀◀ GRACENOTE DISCLAIMS ALL WARRANTIES, EITHER EXPRESS OR IMPLIED, INCLUDING, BUT NOT LIMITED TO, THE IMPLIED WARRANTIES OF MERCHANTABILITY, FITNESS FOR A PARTICULAR PURPOSE, TITLE AND NON-INFRINGEMENT OF INTELLECTUAL PROPERTY RIGHTS. GRACENOTE DOES NOT GUARANTEE THE RESULTS OBTAINED THROUGH YOUR USE OF THE GRACENOTE SOFTWARE OR A GRACENOTE SERVER. GRACENOTE WILL IN NO EVENT BE LIABLE FOR ANY CONSEQUENTIAL DAMAGE OR FOR ANY LOST PROFITS OR REVENUES.

© Gracernote, Inc. 2009

camellia:1.2.0

Copyright (c) 2006, 2007

NTT (Nippon Telegraph and Telephone Corporation). All rights reserved.

Redistribution and use in source and binary forms, with or without modification, are permitted provided that the following conditions are met:

1. Redistributions of source code must retain the above copyright notice, this list of conditions and the following disclaimer as the first lines of this file unmodified.
2. Redistributions in binary form must reproduce the above copyright notice, this list of conditions and the following disclaimer in the documentation and/or other materials provided with the distribution.

THIS SOFTWARE IS PROVIDED BY NTT "AS IS" AND ANY EXPRESS OR IMPLIED WARRANTIES, INCLUDING, BUT NOT LIMITED TO, THE IMPLIED WARRANTIES OF MERCHANTABILITY AND FITNESS FOR A PARTICULAR PURPOSE ARE DISCLAIMED. IN NO EVENT SHALL NTT BE LIABLE FOR ANY DIRECT, INDIRECT, INCIDENTAL, SPECIAL, EXEMPLARY, OR CONSEQUENTIAL DAMAGES (INCLUDING, BUT NOT LIMITED TO, PROCUREMENT OF SUBSTITUTE GOODS OR SERVICES; LOSS OF USE, DATA, OR PROFITS; OR BUSINESS INTERRUPTION) HOWEVER CAUSED AND ON ANY THEORY OF LIABILITY, WHETHER IN CONTRACT, STRICT LIABILITY, OR TORT (INCLUDING NEGLIGENCE OR OTHERWISE) ARISING IN ANY WAY OUT OF THE USE OF THIS SOFTWARE, EVEN IF ADVISED OF THE POSSIBILITY OF SUCH DAMAGE.

Unicode: 5.1.0

COPYRIGHT AND PERMISSION NOTICE

Copyright c 1991-2013 Unicode, Inc. All rights reserved. Distributed under the Terms of Use in <http://www.unicode.org/copyright.html>.

Permission is hereby granted, free of charge, to any person obtaining a copy of the Unicode data files and any associated documentation (the "Data Files") or Unicode software and any associated documentation (the "Software") to deal in the Data Files or Software without

restriction, including without limitation the rights to use, copy, modify, merge, publish, distribute, and/or sell copies of the Data Files or Software, and to permit persons to whom the Data Files or Software are furnished to do so, provided that (a) the above copyright notice(s) and this permission notice appear with all copies of the Data Files or Software, (b) both the above copyright notice(s) and this permission notice appear in associated documentation, and (c) there is clear notice in each modified Data File or in the Software as well as in the documentation associated with the Data File(s) or Software that the data or software has been modified.

THE DATA FILES AND SOFTWARE ARE PROVIDED "AS IS", WITHOUT WARRANTY OF ANY KIND, EXPRESS OR IMPLIED, INCLUDING BUT NOT LIMITED TO THE WARRANTIES OF MERCHANTABILITY, FITNESS FOR A PARTICULAR PURPOSE AND NON-INFRINGEMENT OF THIRD PARTY RIGHTS. IN NO EVENT SHALL THE COPYRIGHT HOLDER OR HOLDERS INCLUDED IN THIS NOTICE BE LIABLE FOR ANY CLAIM, OR ANY SPECIAL INDIRECT OR CONSEQUENTIAL DAMAGES, OR ANY DAMAGES WHATSOEVER RESULTING FROM LOSS OF USE, DATA OR PROFITS, WHETHER IN AN ACTION OF CONTRACT, NEGLIGENCE OR OTHER TORTIOUS ACTION, ARISING OUT OF OR IN CONNECTION WITH THE USE OR

PERFORMANCE OF THE DATA FILES OR SOFTWARE.

Except as contained in this notice, the name of a copyright holder shall not be used in advertising or otherwise to promote the sale, use or other dealings in these Data Files or Software without prior written authorization of the copyright holder.

Related information

- Volvo Sensus (p. 6)

Type approval - audio and media

Type approval for radio, telecom and computer equipment.

Wi-Fi



Declaration of Conformity for audio and navigation unit

Declaration of Conformity

Mitsubishi Electric Corporation Sanda Works
2-3-33, Miwa, Sanda-city, Hyogo, 669-1513 Japan

We declare, at our sole responsibility, that the following product conforms to the Essential Requirements of the Radio and Telecommunications Terminal Equipment Directive 1999/5/EC in accordance with the tests conducted to the appropriate requirements of the relevant standards, as listed herewith.

Product :	Audio Navigation Unit																
Model/Type Number :	NR-IV																
Directive and Standards used :	<table border="0"> <tr> <td><u>Radio:</u></td> <td>EN 300 328 V1.7.1 :2006-10</td> </tr> <tr> <td></td> <td>EN 300 449-1 V1.6.1 :2010-08</td> </tr> <tr> <td></td> <td>EN 300 449-2 V1.4.1 :2010-08</td> </tr> <tr> <td><u>EMC:</u></td> <td>EN 301 489-1 V1.9.2 :2011-09</td> </tr> <tr> <td></td> <td>EN 301 489-3 V1.4.1 :2002-08</td> </tr> <tr> <td></td> <td>EN 301 489-17 V2.1.1 :2009-05</td> </tr> <tr> <td><u>Safety:</u></td> <td>IEC 60950-1:2005 (Second Edition) + Am 1:2009</td> </tr> <tr> <td></td> <td>EN 60950-1 : 2006+A1:2010+A11:2009+A12:2011</td> </tr> </table>	<u>Radio:</u>	EN 300 328 V1.7.1 :2006-10		EN 300 449-1 V1.6.1 :2010-08		EN 300 449-2 V1.4.1 :2010-08	<u>EMC:</u>	EN 301 489-1 V1.9.2 :2011-09		EN 301 489-3 V1.4.1 :2002-08		EN 301 489-17 V2.1.1 :2009-05	<u>Safety:</u>	IEC 60950-1:2005 (Second Edition) + Am 1:2009		EN 60950-1 : 2006+A1:2010+A11:2009+A12:2011
<u>Radio:</u>	EN 300 328 V1.7.1 :2006-10																
	EN 300 449-1 V1.6.1 :2010-08																
	EN 300 449-2 V1.4.1 :2010-08																
<u>EMC:</u>	EN 301 489-1 V1.9.2 :2011-09																
	EN 301 489-3 V1.4.1 :2002-08																
	EN 301 489-17 V2.1.1 :2009-05																
<u>Safety:</u>	IEC 60950-1:2005 (Second Edition) + Am 1:2009																
	EN 60950-1 : 2006+A1:2010+A11:2009+A12:2011																

The authorized signatory to this declaration :

Date: 17th July 2013

Signature: [Signature]

Name: **Kazuhito Funao**

Title: **Manager,**

Address: **Mitsubishi Electric Corporation Sanda Works
2-3-33, Miwa, Sanda-city, Hyogo, 669-1513, Japan**

The responsible person based within the EC :

Date: 14th July 2013

Signature: [Signature]

Name: **Jan Jullig**

Title: **General Manager,**

Address: **Mitsubishi Electric Automotive Europe,B.V.
Swedish Branch, Technical Center
Ostra Eriksbergsgatan 38, SE41878 Gothenburg, Sweden**

0001300



◀◀ **Related information**

- [Audio and media \(p. 26\)](#)
- [Internet-connected car \(p. 69\)](#)

INTERNET MAP

Internet map¹

Internet map is a function that enables Internet-based map display.

The system can calculate a suitable route and indicate the position of the car in relation to the route on the map. In the event of a deviation from the planned route the system automatically adjusts the route and still guides to the destination. In addition to normal map data, the map also shows traffic information (p. 107) and symbols for selected points of interest (POI) (p. 104).

Route calculation will cease to function in the event of poor coverage or a weak signal in the Internet connection. Certain map scales may be missing depending on how much of the map data has been downloaded.

NOTE

Data is transferred when using the internet (data traffic), which can have a cost.

Activation of data roaming can result in further charges.

Contact your network operator about the cost for data traffic.

Volvo offers a full-scale navigation system (Sensus Navigation) which uses hard disk-based maps, voice guidance, advanced route calculation

¹ Applies to certain markets.

taking into account traffic information, Internet search and the option of several waypoints. Contact your dealer to upgrade to Sensus Navigation. The Internet map is replaced during upgrading.

The Internet map provides road information which leads to a pre-selected destination. However, not all recommended route directions are reliable because situations can arise that lie outside the capacity and judgement of the system, such as sudden changes in weather, for example.

WARNING

Observe the following.

- Direct all your attention to the road and make sure that all your concentration is on driving.
- Follow applicable traffic legislation and drive with good judgment.
- Due to weather conditions or time of year affecting the road conditions, some recommendations may be less reliable.

Related information

- Internet map - text and symbols on the screen (p. 100)

Internet map² - operation

Proceed as follows to start the Internet map to plan your trip in order to then be guided to the specified destination.

For basic operation, read how the system is operated and menu navigation (p. 28). More detailed descriptions are shown in each respective section.

In order to enter and search in the Internet map, use the character wheel and numerical keyboard (p. 99).

1. To use the Internet map, the car must first be connected to the Internet (p. 69).
2. Start the Internet map by pressing the **NAV** button in the centre console.
3. Accept sharing of the car's position.

NOTE

The Internet map does not work without acceptance.

To deactivate sharing, in the normal view for the source, press **OK/MENU**, select **Settings** and uncheck the option **Position sharing**.

4. Enter destination (p. 102).

5. Select route options (p. 106) (e.g. road type, tunnels, ferries).
6. Select map options (p. 107) (e.g. full screen, map type, position information).
 - > The position of the car is shown on the Internet map with traffic information and selected points of interest (POI).

Show route

Show the overview map of the route, in the normal view for the source, press **OK/MENU** and select **Route** → **Map of remaining route**.

Show detailed route information (p. 105).

Change destination

To change destination: enter destination (p. 102).

Cancel/resume guidance

In the normal view for the source, press **OK/MENU** and select **Cancel/Resume guidance**.

Change of car ownership

In the event of change of ownership it is important to reset all user data and system settings to the original factory settings, see Change of ownership (p. 10).

² Applies to certain markets.

³ Applies to certain markets.

Internet map³ - character wheel and keyboard

Use the character wheel or the centre console keypad for entering and selecting options. For example, enter information about an address or a facility.



Screen view with text field.

This system uses a "character wheel" to enter specific information, e.g. type of POI, city/town, area/country, address, street or postcode.

Activate an option

After highlighting a desired function/menu bar using the **thumbwheel** or the **TUNE** knob, press the **thumbwheel/OK** to see the next level of functions/options.

Entering text with the character wheel



the character wheel.

1. Highlight a text field.
2. Press **OK** to call up the character wheel.
3. Select the characters using the **thumbwheel/TUNE** knob and enter them by pressing **thumbwheel/OK** once.

◀ Enter with the numerical keyboard



Numerical keyboard.

Another way of entering characters is to use the centre console's buttons **0-9**, * and #.

When e.g. **9** is pressed, a bar appears with all characters⁴ under the buttons, e.g. **W**, **x**, **y**, **z** and **9**. Quick presses on the button move cursor through these characters.

- Stop with the cursor on the desired character in order to select it - the character is shown on the enter line.
- Delete/change using **EXIT**.

To enter a number, hold in the corresponding number key.

More options

Additional options that, amongst other things, provide more characters as well as numbers are available in the character wheel's inset menu:

- **123/ABC + OK** - the character wheel switches between numbers and characters.
- **MORE + OK** - alternative characters are shown in the wheel.
- **=> + OK** - moves the cursor to the list on the right-hand side of the screen where selections can be made with **OK**.

List with options



List that matches the entered characters.

When searching for countries, available options are listed based on the letters entered. No list is shown for other search fields but instead the search is performed when search is activated.

Internet map⁵ - text and symbols on the screen

Explanation of text and symbols that can be shown on the map.

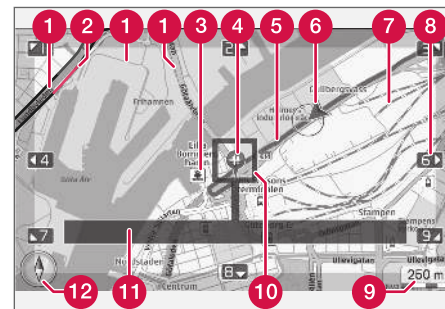

- 1 Road types - size and colour vary depending on the size of the road and the selected map scale and map colour
- 2 Traffic information (p. 107) - highlighted with a line in the edge of the road.
- 3 Points of interest (p. 104)
- 4 Symbol for destination/final destination
- 5 Planned route - blue
- 6 The car's current position

⁴ The character for each button may vary depending on market/country/language.

⁵ Applies to certain markets.

- 7 Railway
- 8 Scrolls/moves the map in the direction of the arrow using the corresponding number on the numerical keyboard (p. 99)
- 9 Map scale
- 10 Focus box with crosshair in the centre
- 11 Current road/street name or coordinates or information about point of interest (POI)
- 12 Compass (p. 107)

Internet map⁶ - scroll menu

In Scroll mode the map image is moved with the centre console (p. 98) numeric keys.

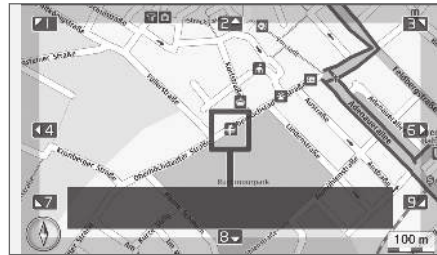

Scroll mode with crosshair⁷.

To activate Scroll mode in normal map mode

- Press one of the numeric keys 0-9.

To scroll

- Press one of the numeric number keys 1-2-3-4-6-7-8-9- a directional arrow is shown in the margins, combined with the number to be used to move the map in the desired direction.

To zoom

- Turn the TUNE knob.

Numeric key "5"

5 JKL

Pressing the number 5 in Scroll mode centres the map around the car's position.

To exit from Scroll mode

- Press EXIT or NAV.

Crosshair



Press OK once to show a menu for the point on the map, which the centre of the crosshair points to:

- **Set single destination** - Deletes any previous destinations in the itinerary and starts guidance on the map.
- **POI information** - shows name and address on the screen for the POI closest to the crosshair. For more information on POI, see (p. 104).

⁶ Applies to certain markets.

⁷ Select whether the position of the crosshair/cursor should be shown with name or GPS coordinates, see map options (p. 107).

- **Information** - Shows information available about the selected location.
- **Save** - Allows you to store the selected location in the memory.

Internet map⁸ - enter destination

Plan a trip by entering destination.

To access the following options, in the normal view for the source, press **OK/MENU** and select **Set destination**.

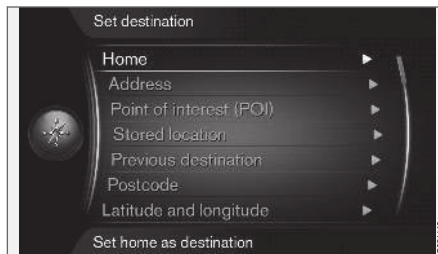

Home

The system can store any position under the **Home** menu option. The function is shown each time a position shall be saved:

- **Save location as home + OK.**

To activate guidance with destination **Home**:

- Highlight **Home + OK.**

Address

It is sufficient to only enter a city/town in order to obtain an itinerary with guidance - it guides to the centre of the city/town.

i NOTE

The definition of city or area may vary from country to country and even within the same country. In some cases, it refers to a municipality and in others it refers to a district.

The following search criteria can be used to search for a destination by address:

- **Country:** - Enter a country.
- **City:** - Enter the city/town.
- **Street:** - Enter the street address.
- **Number:** - Select one of the street's house numbers.

Points of interest (POI)

It is possible to search for POI options by entering any of the following menu options:

- **With name**
- **By category**
- **Around the car**
- **Near the destination**
- **Around point on map**

To avoid making the map image difficult to read, the number of POI options that can be viewed simultaneously on the screen is limited - zooming into an area gives the opportunity to view several POI options.

⁸ Applies to certain markets.

For information about display options regarding POI options, see map options (p. 107).

Examples of symbols for different POI options, see (p. 104).

Stored location

Collected here are destinations and locations that have been stored with the "**Save**" menu option.

Saved destination and location respectively can be adjusted:

- **Set single destination**
- **Edit**
- **Delete**
- **Delete all.**

Previous destinations

Previously used destinations are stored here. Highlight one of them + **OK** and then choose between:

- **Set single destination**
- **Information**
- **Save**
- **Delete**
- **Delete all.**

Post code

Search destination by post code.

 NOTE
Presentation of post code may differ between different markets/areas.

Latitude and longitude

Enter destination with GPS coordinates.

First decide which method to use to enter the GPS coordinates by highlighting **Format: + OK**. Then highlight one of the following options + **OK**:

- **DD°MM'SS"** - position with Degrees, Minutes and Seconds.
- **Decimal** - position with Decimals.

Following which, enter the GPS coordinates and then select one of the following options:

- **Set single destination**
- **Save**

Point on the map

Shows the map with current location indicated with a cursor.

Turn **TUNE** to change the map scale.

1. Move (scroll) the map with the numeric keys, see (p. 101).
2. When the desired location has been found - Press **OK**.



Cursor position is indicated with name.

Then choose between the following options and activate with **OK**:











- **Set single destination**
- **Save**













Related information











- Internet map - operation (p. 98)

Internet map⁹ - points of interest (POI) symbols

Shown here are examples of how symbols for different facilities may appear.

	Restaurant
	Drama
	Dancing Nightclub
	Cinema
	Casino
	Museum
	Tourist attraction
	Airport
	Railway station
	Ferry terminal
	Taxi stand

	Accommodation Hotel
	Shopping centre
	Business activities Services
	ATM Bank
	Police
	Post office
	Tourist information
	Petrol station
	Car hire
	Government building Civic/community centre
	Exhibition centre Convention
	Hospital Medical facility

	Library
	Parking
	Public toilets Rest room
	Sports facility Playing field
	Leisure activities Relaxation
	Swimming baths Beach
	Education University
	Bar Pub
	Mountain Mountain peak
	Pharmacy
	Camping

⁹ Applies to certain markets.

Related information

- Internet map - enter destination (p. 102)

Internet map¹⁰ - detailed route information

Shown here are the guidance point that each route section includes, for example, exits and intersections.

To view detailed route information, in the normal view for the source, press **OK/MENU** and select **Route** → **Route overview**.



Detailed route information.

The route to the destination consists of a number of subsections containing different guidance points, e.g. straight sections, exits, intersections, slip roads, etc. Scroll through the subsections with **Next/Previous**.

Position on the map, denomination, distance and points of interest are shown. The distance shown is the one between the two guidance points and is therefore not counted down as the vehicle approaches the guidance point.

Related information

- Internet map - route options (p. 106)
- Internet map - points of interest (POI) symbols (p. 104)

¹⁰ Applies to certain markets.

Internet map¹¹ - route overview

There is the option to look at the remaining route in an overview map.

To show the overview map of the route, in the normal view for the source, press **OK/MENU** and select **Route** → **Map of remaining route**.



Otherwise, the same functions as in the scroll menu (p. 101).

Related information

- Internet map - enter destination (p. 102)

¹¹ Applies to certain markets.

¹² Applies to certain markets.

Internet map¹² - route options

Route options contains settings for route type and options for adapting the route.

Route type

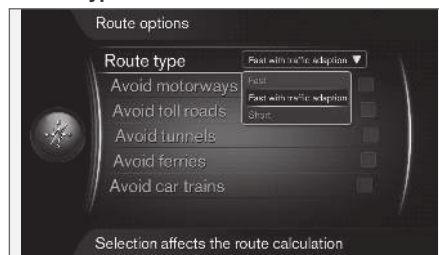

To access route type, in the normal view for the navigation source, press **OK/MENU** and select **Settings** → **Route options** → **Route type**.

Different types of route can be selected here. Activate the desired option with **OK**.

- **Fast with traffic adaption** - short travel time with minimal traffic queues.
- **Fast** - short travel time prioritised.
- **Short** - short route prioritised. The route can also be guided via minor roads.

Adapt the route

To adapt the route, in the normal view for the navigation source, press **OK/MENU** and select **Settings** → **Route options**.

In order to avoid one or more of the screen's listed elements along the route, highlight the element + **OK**.

- **Avoid motorways**
- **Avoid toll roads**
- **Avoid tunnels**
- **Avoid ferries**
- **Avoid car trains**

i NOTE

- If an itinerary is entered when these selections are made then there may be a certain delay after an option has been ticked/unticked since the itinerary must be recalculated.
- If tunnels, toll roads and motorways are not selected then these are avoided as far as possible and are only used if no other reasonable alternative is available.

Related information

- Internet map - enter destination (p. 102)

Internet map¹³ - map options

Settings for different map options.

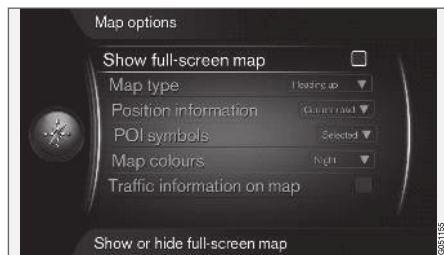

Full screen map

To show the map in full screen, in the normal view for the source, press **OK/MENU** and select **Settings → Map options → Show full-screen map**. Highlighted option + **OK** shows the map across the whole screen without other car-related information, such as passenger compartment temperature or active radio transmitter in the lower and upper edge of the screen.

Map mode compass direction

To set compass direction, in the normal view for the source, press **OK/MENU** and select **Settings → Map options → Map type**.

This is where to select how the map should be shown on the screen. Activate the desired option with **OK**.

- **North up** - the map is always shown with North at the top of the screen. The car symbol moves in the current compass direction on the screen.
- **Map heading up** - the car symbol is in the centre and is always pointing upwards on the screen. The map image rotates under the car symbol in relation to how the road turns.
- **3D Heading up** - same as **Map heading up** but 3D map. Display varies depending on zoom.

Information about current position

To set the information about current position, in the normal view for the source, press **OK/MENU** and select **Settings → Map options → Position information**.

Activate the desired option with **OK**.

- **Current road** - the screen shows the name of the road/street where the car/cursor is located.
- **Lat/Long** - the screen shows the coordinates of the location where the car/cursor is located.

- **None** - the screen shows no information for the location where the car/cursor is located.

Point of interest (POI) on the map

To set which POI options should be shown on the map, in the normal view for the source, press **OK/MENU** and select **Settings → Map options → POI symbols**.

This is where to specify which POI options should be shown on the map. Activate the desired option with **OK**.

- **Default** - POI options specified with the function **Selected** are shown.
- **Selected** - select with the **TUNE** knob + **OK** for each POI option required on the screen.
- **None** - no POI options are shown.

For examples of POI, see Internet map - points of interest (POI) symbols (p. 104).

Map colours

To set map colours, in the normal view for the source, press **OK/MENU** and select **Settings → Map options → Map colours**.

Activate the desired option with **OK**.

¹³ Applies to certain markets.

INTERNET MAP

- ◀ • **Automatic** - a light sensor detects whether it is day or night and adapts the screen automatically.
- **Day** - the colours and contrast of the screen become clear and sharp.
- **Night** - the colours and contrast of the screen are adapted to provide the driver with optimum night vision.

Traffic information on the map

Highlighted in green, yellow or red on the side of the roads on the map that have traffic information. Green means no disruptions, yellow means slow traffic and red means congestion/traffic jam/accident.

i NOTE

Traffic information is not available in all areas/countries.

The traffic information transmission areas are constantly being expanded.

To show traffic information, in the normal view for the source, press **OK/MENU** and select

Settings → **Map options** → **Traffic on map**.

Related information

- Internet map - text and symbols on the screen (p. 100)

ALPHABETICAL INDEX

A

Alarm for accidents and disasters	40
applications (apps)	73
Audio	
settings	33
surround	35
Audio and media	
introduction	26
manage the system	28
menu overview	83
menus	28
overview	27
Audio profile	35
Audio system	26
Audio volume	28
external audio source	52
phone	60
phone/media player	60
ring signal, phone	60
speed/noise compensation	36
AUX input	27, 50

B

Battery	
remote control	82
Bluetooth®	
handsfree	57
media	53
microphone off	59
streaming audio	53
transfer call to mobile	59

C

Calls	
incoming	57
operation	57
CD	44
Change of owner	10
Controls	
centre console, steering wheel	28

D

DAB Radio	36, 42
Destination	102
Digital radio (DAB)	42

DVD	44
-----	----

E

Equalizer	36
-----------	----

G

Guiding options	106
-----------------	-----

H

Hard disk drive (HDD)	48
-----------------------	----

I

Image settings	48
Infotainment system (Audio and media)	26
Internet-connected car	69
applications (apps)	73
car modem	71
Internet map	98
Internet settings	23
menu overview	90
web browser	75

ALPHABETICAL INDEX

Internet map	98
Internet radio	73
iPod®, connection	52

K

Keyboard	99
Keypad in the steering wheel	28

M

Making calls	57
Map (Internet map)	98
Map options	107
Media, Bluetooth®	53
Media player	43
compatible file formats	49
Media search	45
Menu navigation audio and media	28
Microphone	58
Mobile phone, see Phone	54
MY CAR	14
climate settings	22
driver support system	19
information	24

internet settings	23
menu Option	15
search paths	15
system settings	21
vehicle settings	17
voice settings	22

N

Normal view	28
-------------	----

P

Phone	
connect	54
handsfree	57
incoming call	57
making calls	57
phone book	60
phone book, shortcut	60
receiving a call	59
Points of Interest (POI)	104

R

Radio	36
DAB	36, 42
Radio programme types (PTY)	41
RDS	39
Remote control	80
battery replacement	82
Route	
detailed route information	105

S

Scroll (move map)	101
Scroll menu (map menu)	101
Sensus	6
Signal input, external	27, 50
Steering wheel	
keypad	28
Support	10
surround	35
Symbols	
in the screen	32

T

Traffic information (Internet map)	107
Traffic information (TP)	40
TV	77

U

USB, connection	52
USB input	50

V

Voice control	63
Volvo ID	11
Volvo Sensus	6

W

Web browser	75
Wi-Fi	71

V O L V O